



**STATE OF HAWAII | KA MOKU'ĀINA 'O HAWAI'I
DEPARTMENT OF TRANSPORTATION | KA 'OIHANA ALAKAU
AIRPORTS**

400 RODGERS BOULEVARD, SUITE 700
HONOLULU, HAWAII 96819-1880

IN REPLY REFER TO:

AIR-PM 24.0507

August 8, 2024

DOT Land Matters
State of Hawaii
Honolulu, Hawaii

ISSUANCE OF A REVOCABLE PERMIT FOR LAND TO PARK
REFUELING TRUCKS FOR FIXED-BASE OPERATIONS
SIGNATURE FLIGHT SUPPORT LLC
ELLISON ONIZUKA KONA INTERNATIONAL AIRPORT AT KEAHOLE
TAX MAP KEY: (3) 7-3-043: PORTION OF 003

HAWAII

APPLICANT:

Signature Flight Support LLC (SFS), whose mailing address is
98 Kapalulu Place, Honolulu, Hawaii 96819.

LEGAL REFERENCE:

Hawaii Revised Statutes (HRS), Sections 26-19 and 171, as amended.

LOCATION AND TAX MAP KEY:

Portion of Ellison Onizuka Kona International Airport at Keahole (KOA), Kailua-Kona,
Island of Hawaii, identified by Tax Map Key: 3rd Division, 7-3-043: Portion of 003.

AREAS:

Area/Space No. 630-177B, containing an area of approximately 765 square feet, and
Area/Space No. 630-177C, containing an area of approximately 765 square feet of
improved, paved land, as shown and delineated on the attached Exhibit A.

ZONING:

State Land Use District:	Urban & Conservation
County of Hawaii:	Industrial (MG-1a) and Open

ISSUANCE OF A REVOCABLE PERMIT FOR LAND TO PARK REFUELING TRUCKS
FOR FIXED-BASE OPERATIONS, SIGNATURE FLIGHT SUPPORT LLC
Page 2

LAND TITLE STATUS:

Section 5(a) lands of the Hawaii Admission Act: Ceded
DHHL 30% entitlement lands pursuant to Hawaii Admission Act YES ___ NO X

CURRENT USE STATUS:

Land presently encumbered by Governors Executive Order No. 3074, dated August 20, 1981, setting aside 4,204.10 acres designated as KOA under the control and management of the State of Hawaii, Department of Transportation (HDOT) for Airport Purposes.

CHARACTER OF USE:

SFS will use the spaces to park their refueling trucks to support its fixed-base operation.

COMMENCEMENT DATE:

To be determined by the Director of Transportation at a later date.

MONTHLY RENTAL:

\$437.32 (based on a rate of \$3.43 per square foot per annum for improved, paved land, as determined from the HDOT schedule of rates and charges established by appraisal of Airports property statewide).

SECURITY DEPOSIT:

\$1,311.96, or three times the monthly rental in effect.

DCCA VERIFICATION:

Place of business registration confirmed:	YES <u>X</u>	NO ___
Registered business name confirmed:	YES <u>X</u>	NO ___
Good standing confirmed:	YES <u>X</u>	NO ___

CHAPTER 343, HRS - ENVIRONMENTAL ASSESSMENT:

The HDOT has determined that the subject land areas are covered by the Kona International Airport at Keahole Master Plan Update Final Environmental Assessment (EA) and Finding of No Significant Impact (FONSI), dated December 18, 2000, and published by the Office of Environmental Quality Control in the January 8, 2001, issue of The Environmental Notice. Accordingly, all relevant mitigation from the EA and best management practices will be implemented to address the minimum impacts of this action.

ISSUANCE OF A REVOCABLE PERMIT FOR LAND TO PARK REFUELING TRUCKS
FOR FIXED-BASE OPERATIONS, SIGNATURE FLIGHT SUPPORT LLC

Page 3

REMARKS:

The HDOT proposes to issue a month-to-month revocable permit to SFS for space to park their refueling trucks in support of its fixed-base operation.

RECOMMENDATION:

Based on this submittal, and testimony and facts presented, the HDOT recommends the Director of Transportation finds that approving the issuance of a month-to-month Revocable Permit to SFS including its conditions and rent, will serve the best interests of the State.

Respectfully submitted,



CURT T. OTAGURO
Deputy Director of Transportation for Airports

Attachment

Pacific Ocean

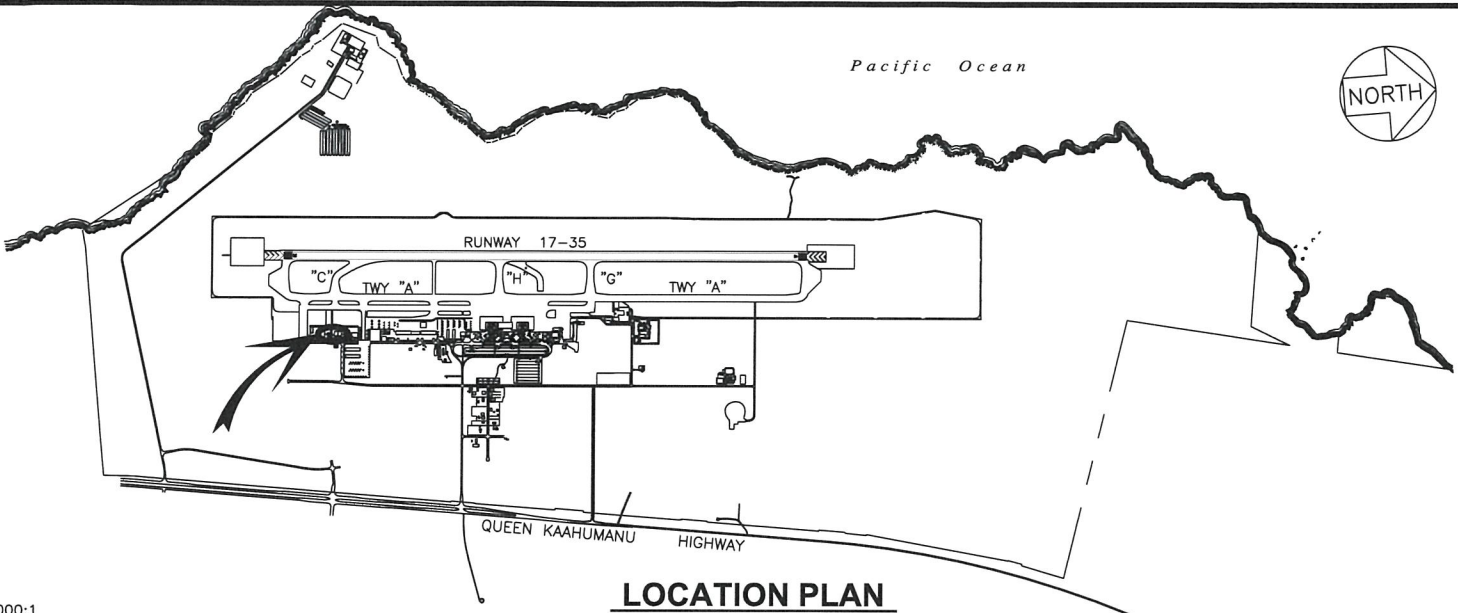

LOCATION PLAN

4000:1

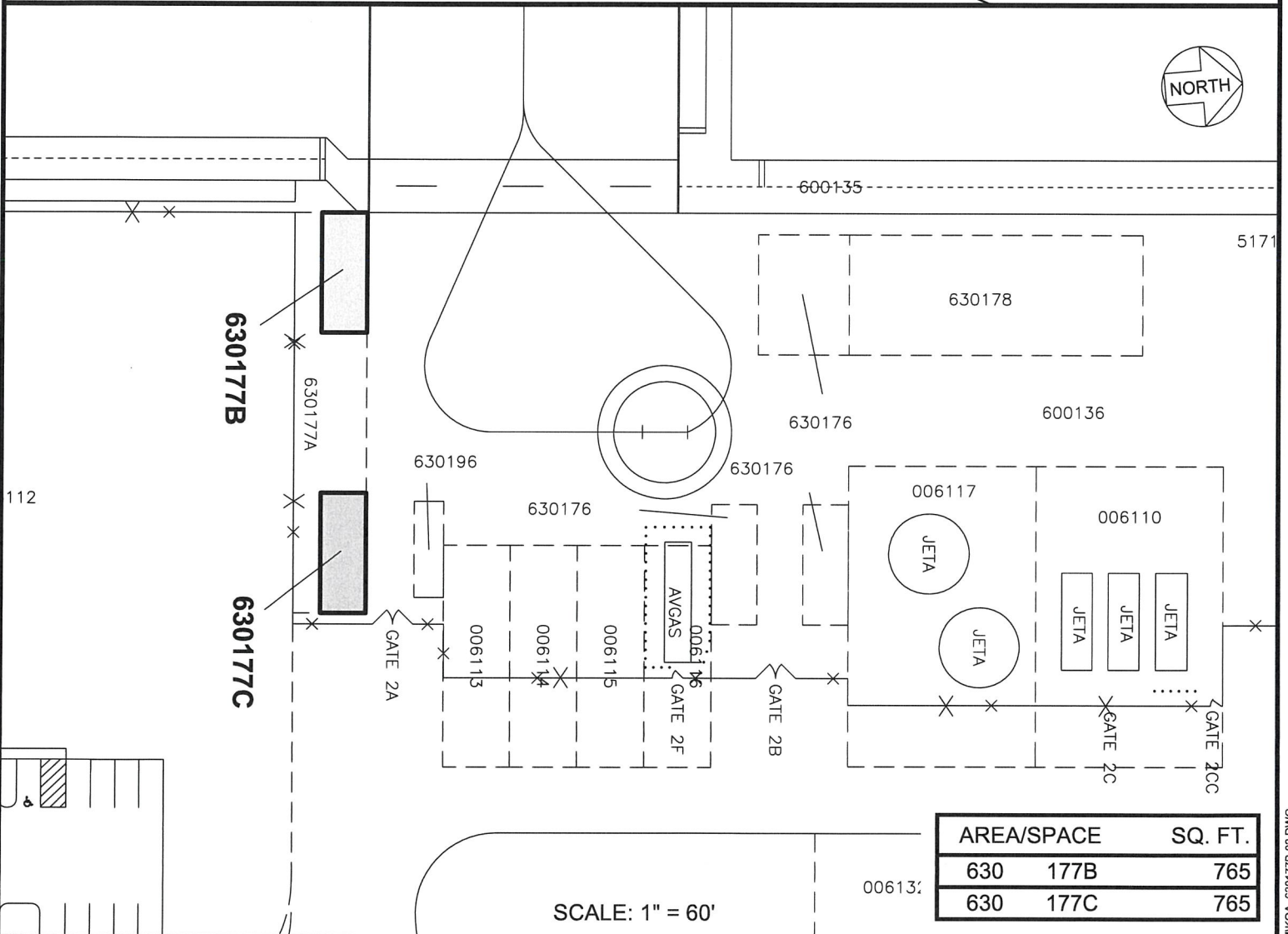

AREA/SPACE	SQ. FT.
630 177B	765
630 177C	765

SCALE: 1" = 60'

RP-9538

DATE : JANUARY 2024

EXHIBIT: **A**



AIRPORTS

SIGNATURE FLIGHT
SUPPORT LLC

PAVED AREAS

630177B
630177C

ELLISON ONIZUKA KONA INTERNATIONAL AIRPORT AT KEAHOLE

N:\AIRPORTS\KOA_KONACAD\PIK\KOA_630177B-02.DWG