

JOSH GREEN, M.D.
GOVERNOR
KE KIA'ĀINA



EDWIN H. SNIFFEN
DIRECTOR
KA LUNA HO'OKELE

Deputy Directors
Nā Hope Luna Ho'okele
DREANALEE K. KALILI
TAMMY L. LEE
CURT T. OTAGURO
ROBIN K. SHISHIDO

**STATE OF HAWAII | KA MOKU'ĀINA 'O HAWAI'I
DEPARTMENT OF TRANSPORTATION | KA 'OIHANA ALAKAU
AIRPORTS**
400 RODGERS BOULEVARD, SUITE 700
HONOLULU, HAWAII 96819-1880

IN REPLY REFER TO:

AIR-PM 24.0573

September 12, 2024

DOT Land Matters
State of Hawaii
Honolulu, Hawaii

ISSUANCE OF A REVOCABLE PERMIT FOR USE OF A T-HANGAR FOR
STORAGE AND MAINTENANCE OF A PERSONAL AIRCRAFT
PETER KELLEY
KAWAIHAPAI AIRFIELD, WAIALUA, HAWAII
TAX MAP KEY: (1) 6-8-014:017 (PORTION)

OAHU

APPLICANT:

Peter Kelley, whose mailing address is 95-330 Waioni Street, #D,
Mililani, Hawaii 96789.

LEGAL REFERENCE:

Hawaii Revised Statutes (HRS), Section 26-19 and 171-2, as amended.

LOCATION AND TAX MAP KEY:

A portion of Kawaihapai Airfield, Waialua, Island of Oahu, State of Hawaii, identified by
Tax Map Key: 1st Division, 6-8-014:017 (portion).

AREA:

Bldg/Room No. 402-108, containing an area of approximately 1,107 square feet,
as shown and delineated on the attached map labeled Exhibit A.

ZONING:

State Land Use District: Agriculture
City and County of Honolulu LUO: AG-2

ISSUANCE OF A REVOCABLE PERMIT FOR USE OF A T-HANGAR FOR STORAGE AND
MAINTENANCE OF A PERSONAL AIRCRAFT
PETER KELLEY
Page 2

LAND TITLE STATUS:

Ceded land, which the State of Hawaii is currently leasing the land from the United States of America.

CHARACTER OF USE:

T-Hangar for storage and maintenance of a personal aircraft (1984 Beechcraft Skipper, Tail No. N-992MB).

COMMENCEMENT DATE:

To be determined by the Director of Transportation at a later date.

MONTHLY RENTAL:

\$310.00 (\$255.00, as determined from the State of Hawaii, Department of Transportation (HDOT) Schedule of Rates and Charges, established by appraisal of Airports property statewide plus \$55.00 utilities).

SECURITY DEPOSIT:

\$930.00, or three times the monthly rental in effect.

CHAPTER 343, HRS - ENVIRONMENTAL ASSESSMENT:

The subject land area is covered by the revised and updated Environmental Assessment for the Dillingham Airfield Master Plan and FAR Part 150 Noise Compatibility Program project, referenced as State Contract No. 26985, State Project No. AO2011-01. This Environmental Assessment evaluated the environmental effects of the recommended Dillingham Airfield Master Plan to meet existing and forecast general aviation demands and was prepared for the HDOT, Airports Division.

REMARKS:

HDOT proposes to issue a month-to-month revocable permit to Peter Kelley for use of a T-Hangar for the storage and maintenance of a personal aircraft, situated at Kawaihapai Airfield.

ISSUANCE OF A REVOCABLE PERMIT FOR USE OF A T-HANGAR FOR STORAGE AND
MAINTENANCE OF A PERSONAL AIRCRAFT
PETER KELLEY
Page 3

RECOMMENDATION:

Based on this submittal, and testimony and facts presented, the HDOT recommends the Director of Transportation finds that approving the issuance of a month-to-month Revocable Permit to Peter Kelley, including its conditions and rent, will serve the best interests of the State.

Respectfully submitted,



CURT T. OTAGURO
Deputy Director of Transportation for Airports

Attachment

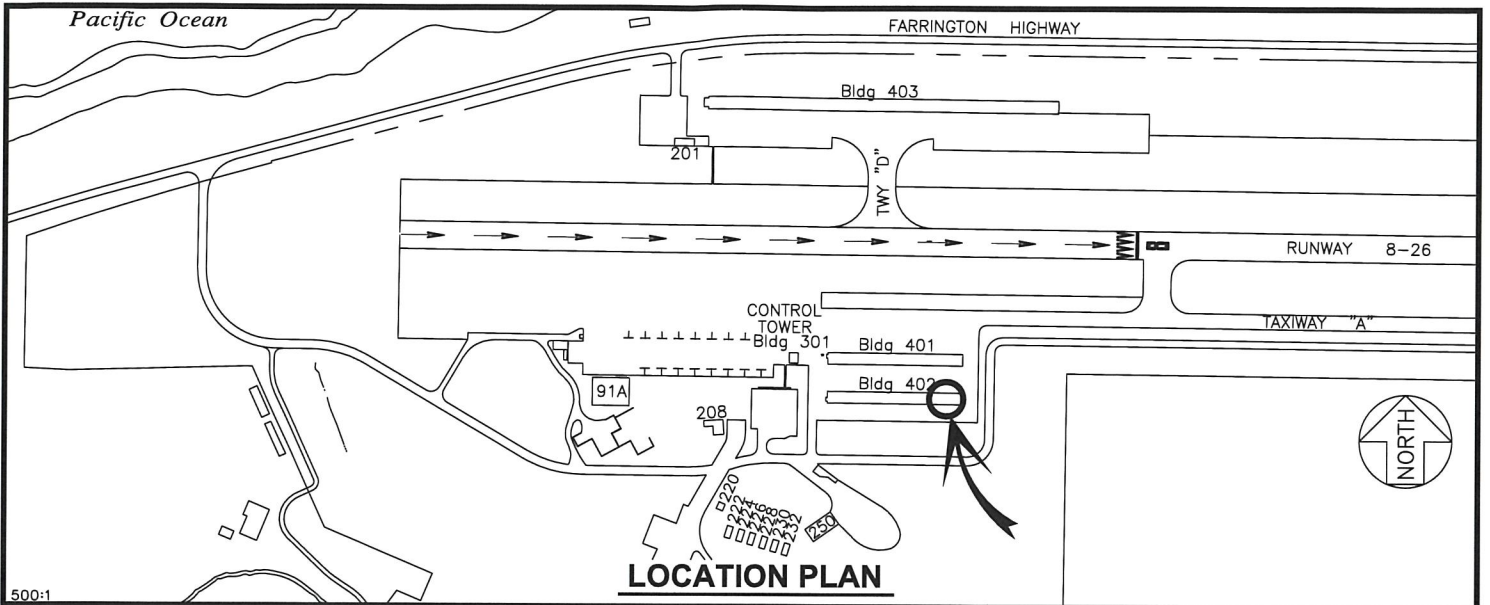

500:1

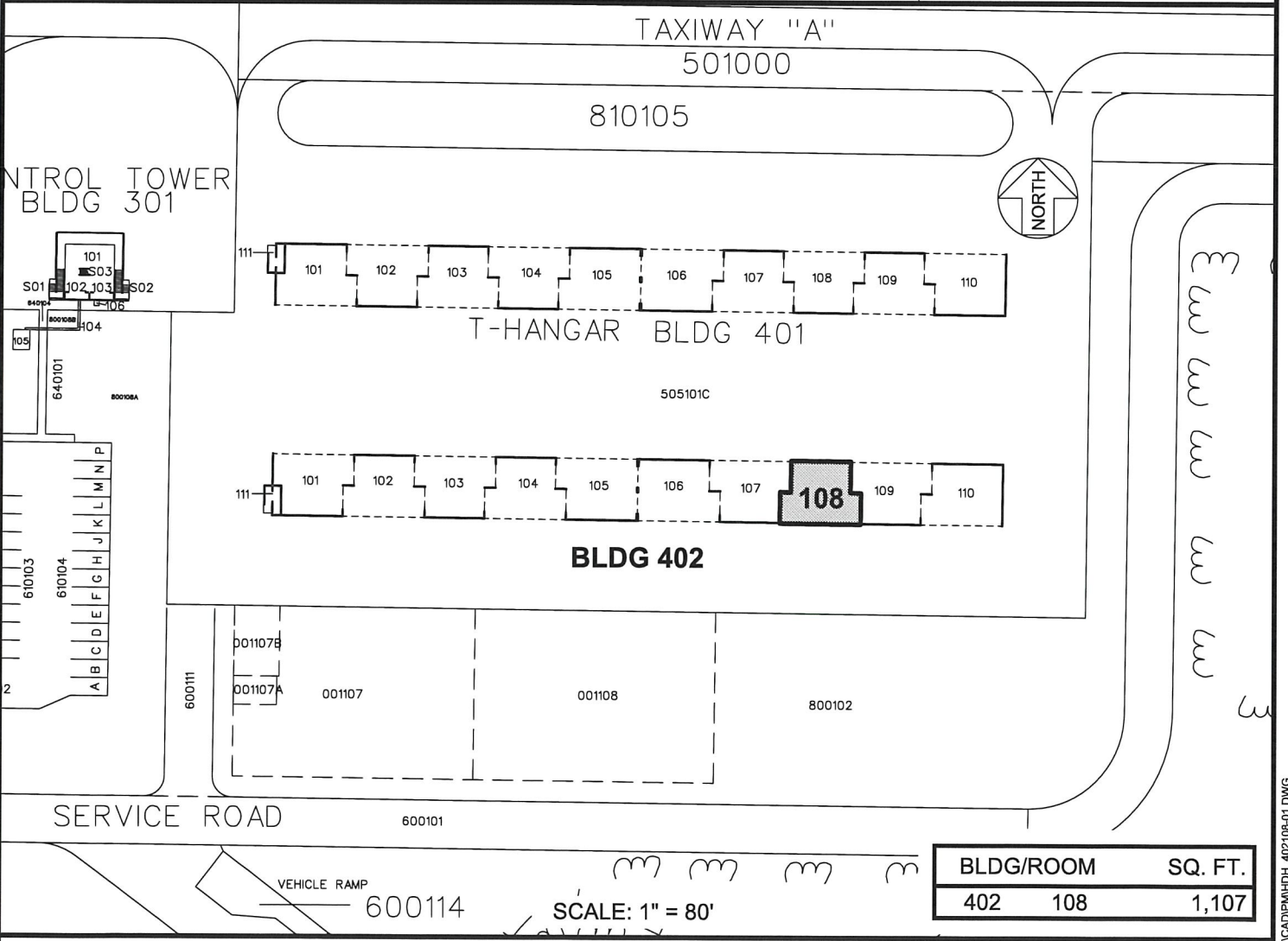

BLDG/ROOM	SQ. FT.
402 108	1,107

DATE : AUGUST 2024

EXHIBIT: **A**



KELLEY, PETER

BUILDING 402
T-HANGAR

402108

DILLINGHAM AIRFIELD

N:\AIRPORTS\SHDH_DILLINGHAM\CAD\FM\H01_402108-01.DWG