

JOSH GREEN, M.D.
GOVERNOR
KE KIA'ĀINA



EDWIN H. SNIFFEN
DIRECTOR
KA LUNA HO'ŌKELE

Deputy Directors
Nā Hope Luna Ho'okele
DREANALEE K. KALILI
TAMMY L. LEE
CURT T. OTAGURO
ROBIN K. SHISHIDO

STATE OF HAWAII | KA MOKU'ĀINA 'O HAWAII
DEPARTMENT OF TRANSPORTATION | KA 'OIHANA ALAKAU
AIRPORTS
400 RODGERS BOULEVARD, SUITE 700
HONOLULU, HAWAII 96819-1880

IN REPLY REFER TO:

AIR-PM 24.0714

October 24, 2024

DOT Land Matters
State of Hawaii
Honolulu, Hawaii

ISSUANCE OF A REVOCABLE PERMIT FOR
TWO TIE-DOWNS FOR AIRCRAFT PARKING
PFISTER'S FLYING WAHINE LLC
KAWAIHAPAI AIRFIELD, WAIALUA, HAWAII
TAX MAP KEY: (1) 6-8-014:001 (PORTION)

OAHU

REQUEST:

Issuance of a revocable permit for Aircraft Parking (Parking Permit) to Pfister's Flying Wahine LLC, situated at Kawaihapai Airfield.

APPLICANT:

Pfister's Flying Wahine LLC, whose mailing address is 68-077D Akule Street, Waialua, Hawaii 96791.

LEGAL REFERENCE:

Hawaii Revised Statutes (HRS), Section 26-19 and 171-2, as amended.

LOCATION AND TAX MAP KEY:

A portion of Kawaihapai Airfield, Waialua, Island of Oahu, State of Hawaii, identified by Tax Map Key: 1st Division, 6-8-014:001 (portion).

AREA:

Area/Space No. 404-116, containing an area of approximately 1,350 square feet; and
Area/Space No. 405-107, containing an area of approximately 1,890 square feet,
as shown and delineated on the attached map labeled Exhibit A and Exhibit A-1.

ISSUANCE OF A REVOCABLE PERMIT FOR TWO TIE-DOWNS FOR AIRCRAFT PARKING
PFISTER'S FLYING WAHINE LLC

Page 2

ZONING:

State Land Use District: Agriculture
City and County of Honolulu LUO: AG-2

LAND TITLE STATUS:

Ceded land, which the State of Hawaii is currently leasing the land from the United States of America.

CHARACTER OF USE:

Two tie-downs for aircraft parking (1973 Schweitzer 2-32 / N-17948 and 1969 Beechcraft 19A/ N-6123N).

COMMENCEMENT DATE:

To be determined by the Director of Transportation at a later date.

MONTHLY RENTAL:

\$110.00 (as determined from the State of Hawaii, Department of Transportation (HDOT) Schedule of Rates and Charges, established by appraisal of Airports property statewide).

SECURITY DEPOSIT:

\$330.00, or three times the monthly rental in effect.

DCCA VERIFICATION:

Place of business registration confirmed:	YES <u>X</u>	NO _____
Registered business name confirmed:	YES <u>X</u>	NO _____
Good standing confirmed:	YES <u>X</u>	NO _____

CHAPTER 343, HRS - ENVIRONMENTAL ASSESSMENT:

The subject land area is covered by the revised and updated Environmental Assessment for the Dillingham Airfield Master Plan and FAR Part 150 Noise Compatibility Program project, referenced as State Contract No. 26985, State Project No. AO2011-01. This Environmental Assessment evaluated the environmental effects of the recommended Dillingham Airfield Master Plan to meet existing and forecast general aviation demands and was prepared for the HDOT.

ISSUANCE OF A REVOCABLE PERMIT FOR TWO TIE-DOWNS FOR AIRCRAFT PARKING
PFISTER'S FLYING WAHINE LLC

Page 3

REMARKS:

HDOT proposes to issue a month-to-month Parking Permit to Pfister's Flying Wahine LLC for two tie-downs for aircraft parking, situated at Kawaihapai Airfield.

RECOMMENDATION:

Based on this submittal, and testimony and facts presented, the HDOT recommends the Director of Transportation finds that approving the issuance of a month-to-month Parking Permit to Pfister's Flying Wahine LLC, including its conditions and rent, will serve the best interests of the State.

Respectfully submitted,



CURT T. OTAGURO
Deputy Director of Transportation for Airports

Attachment

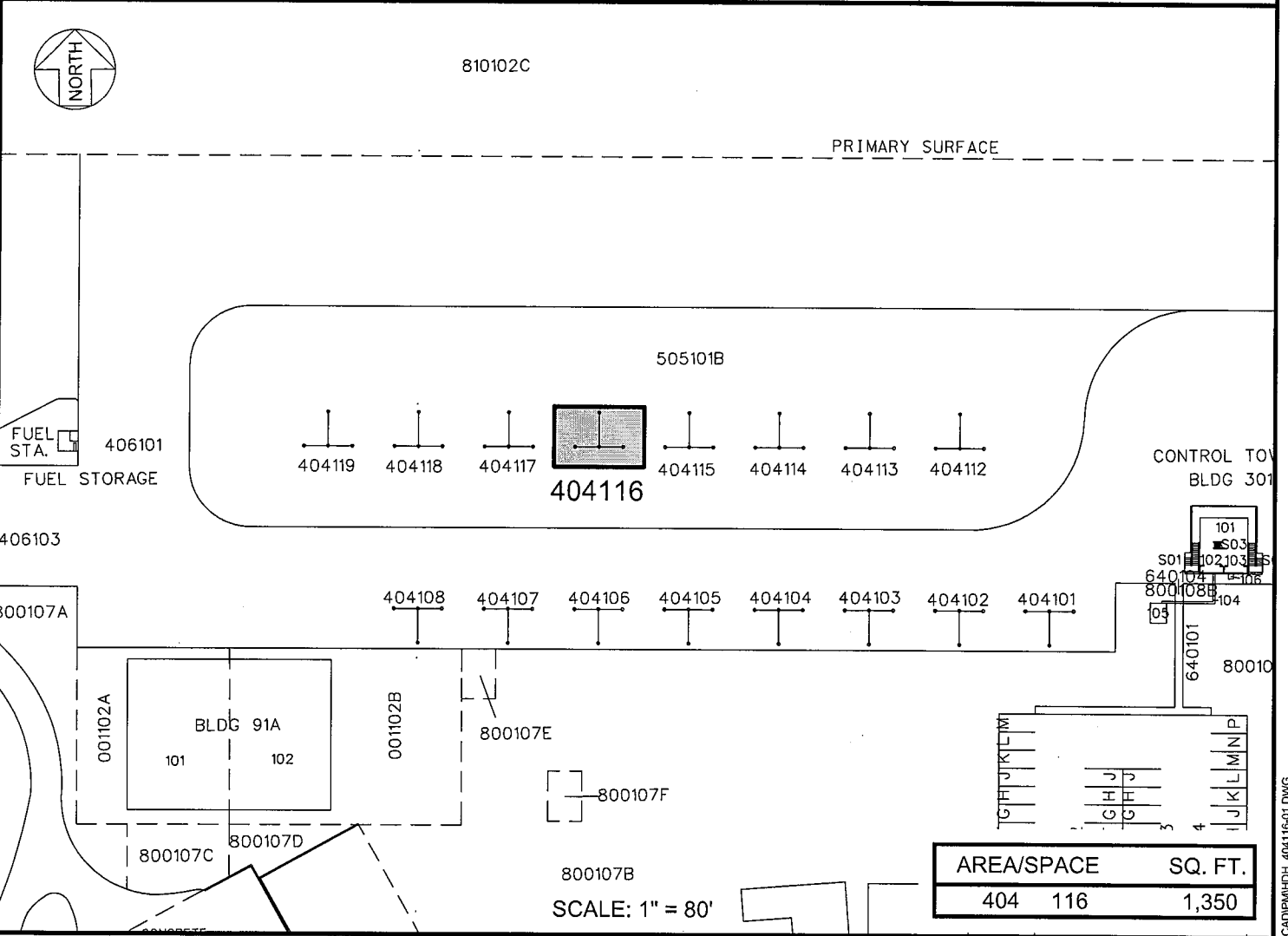
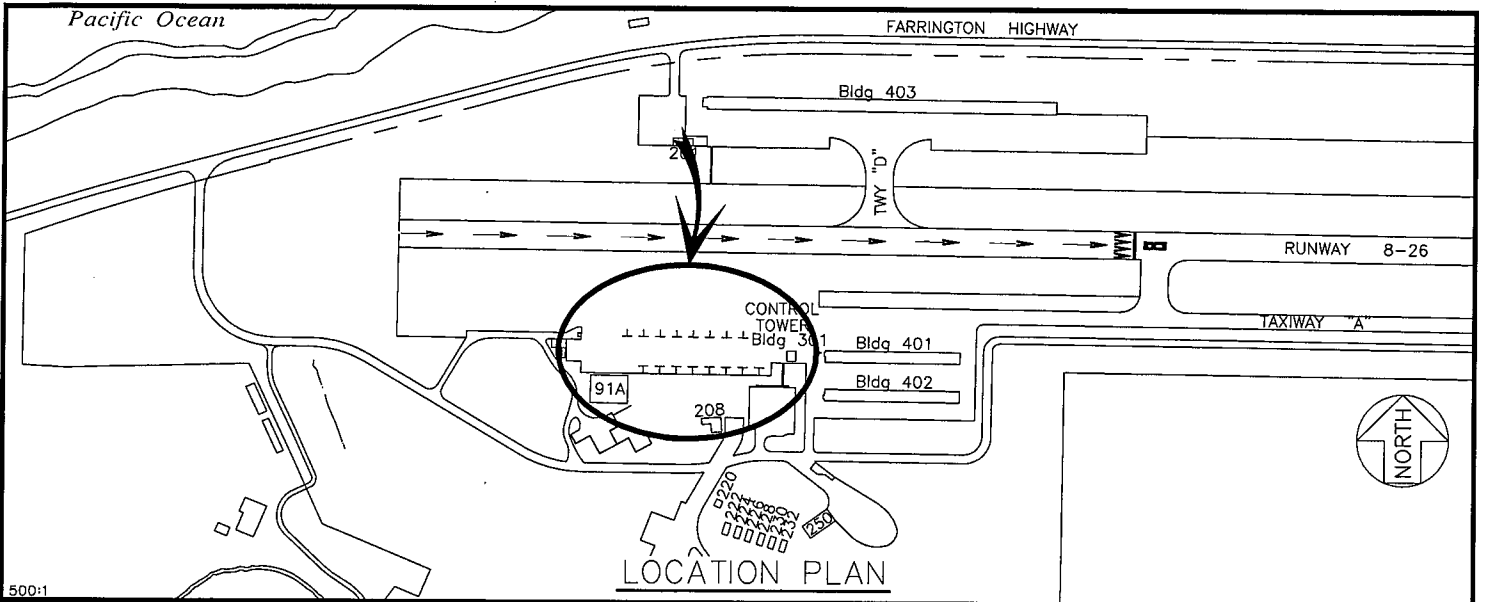

PP-24-007 DATE: AUGUST 2024 EXHIBIT: A



PFISTER'S FLYING WAHINE LLC

TIE-DOWN

404116

DILLINGHAM AIRFIELD

N:\AIRPORTS\SHDL_DILLINGHAM\CAD\PM\HDL_404116-01.DWG

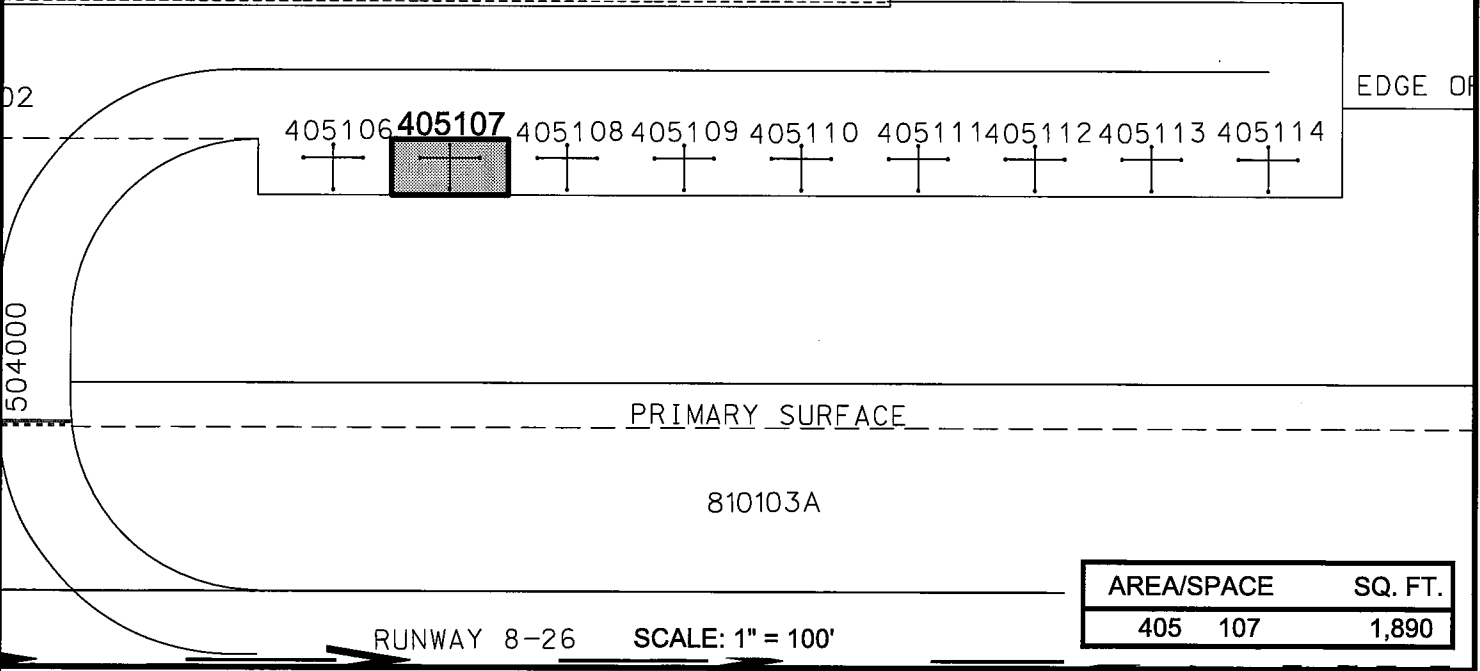
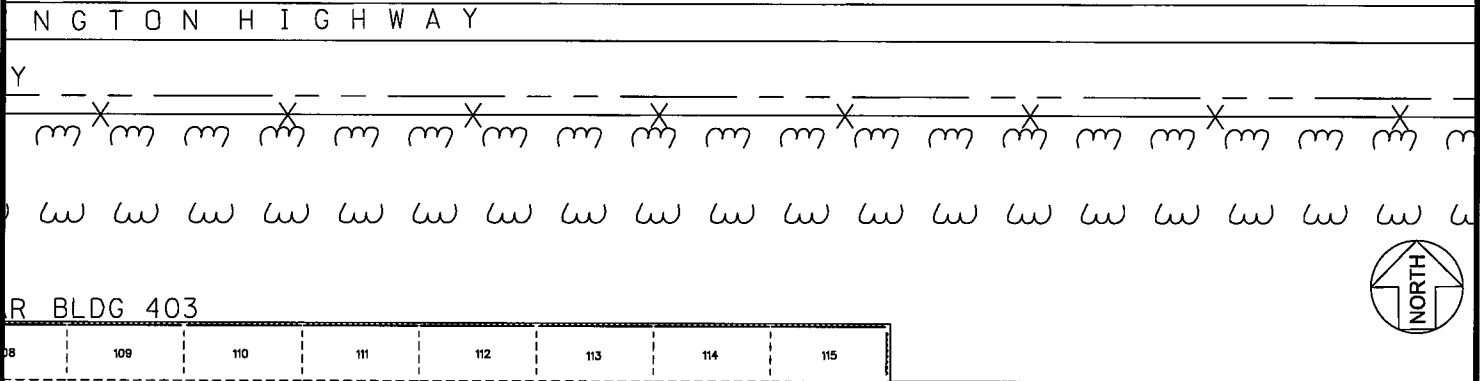
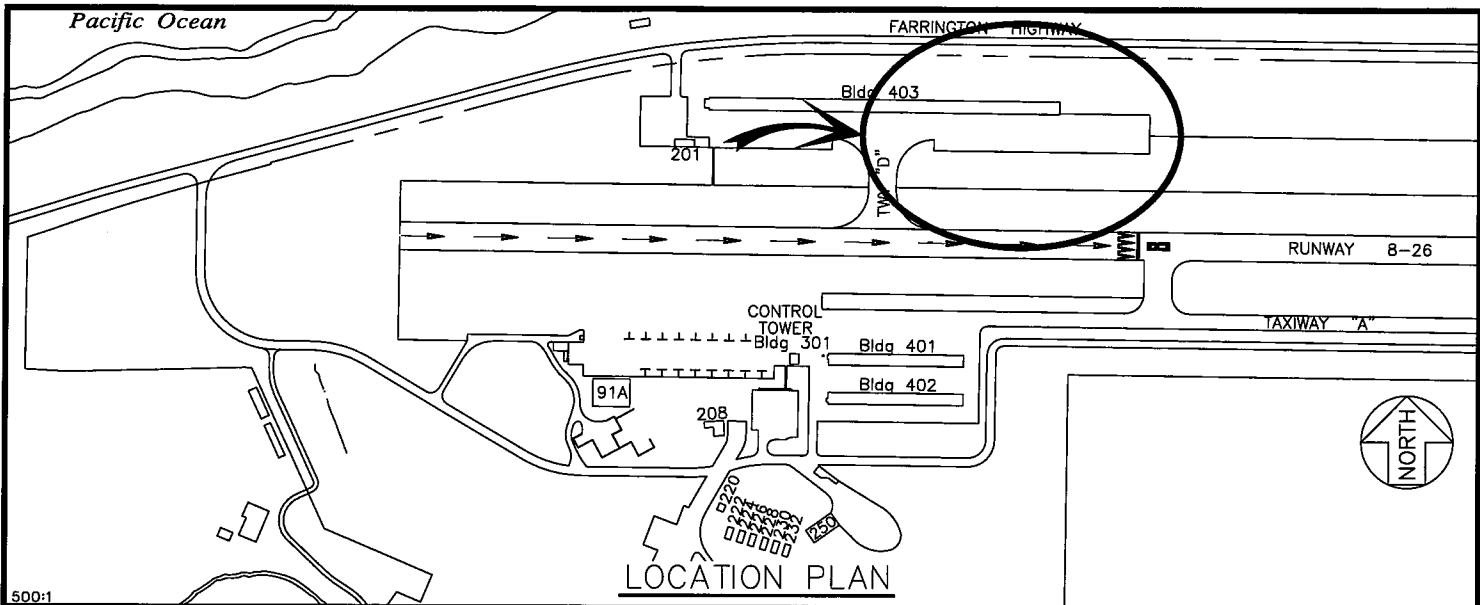

PP-24-007	DATE: AUGUST 2024	EXHIBIT: A-1
	PFISTER'S FLYING WAHINE LLC	TIE-DOWN
		405107

DILLINGHAM AIRFIELD

N:\AIRPORTS\SHDH_DILLINGHAM\CADD\PM\SHDH_405107-01.DWG