



**STATE OF HAWAI'I | KA MOKU'ĀINA 'O HAWAI'I
DEPARTMENT OF TRANSPORTATION | KA 'OIHANA ALAKAU
AIRPORTS**

400 RODGERS BOULEVARD, SUITE 700
HONOLULU, HAWAII 96819-1880

AIR-PM 24.0731

November 7, 2024

DOT Land Matters
State of Hawaii
Honolulu, Hawaii

ISSUANCE OF A REVOCABLE PERMIT FOR THE
INSTALLATION OF A SATELLITE DISH
CITY AND COUNTY OF HONOLULU POLICE DEPARTMENT
DANIEL K. INOUE INTERNATIONAL AIRPORT
TAX MAP KEY: (1) 1-1-003: 001 (PORTION)

OAHU

APPLICANT:

City and County of Honolulu Police Department (HPD), whose business address is
801 S. Beretania Street, Honolulu, Hawaii 96813.

LEGAL REFERENCE:

Hawaii Revised Statutes (HRS), Sections 26-19 and 171-2, as amended.

LOCATION AND TAX MAP KEY:

Portion of Building 363, Diamond Head Connecting Link, Third Level, at
Daniel K. Inouye International Airport (Airport), Island of Oahu, State of Hawaii,
identified by Tax Map Key: 1st Division, 1-1-003: 001 (Portion).

AREA:

Building/Room No. 363-301, containing an area of 1 square foot; as shown and
delineated on the attached map labeled Exhibit A.

ZONING:

State Land Use District: Urban
City and County of Honolulu LUO: Industrial (I-2)

ISSUANCE OF A REVOCABLE PERMIT FOR THE INSTALLATION OF A SATELLITE
DISH, CITY AND COUNTY OF HONOLULU POLICE DEPARTMENT
Page 2

LAND TITLE STATUS:

Section 5(a) lands of the Hawaii Admissions Act: Non-ceded
DHHL 30% entitlement lands pursuant to the Hawaii State Constitution: YES ___ NO X

CURRENT USE STATUS:

Land presently encumbered by Governor's Executive Order No. 3201, dated
June 8, 1983, setting aside 3,152.177 acres designated as the Airport under the control
and management of the State of Hawaii, Department of Transportation (HDOT) for
Airport purposes.

CHARACTER OF USE:

HPD will use the space to install a satellite dish required to support its Narcotics and
Vice Division operations in their offices under RP-4633 at the Airport.

COMMENCEMENT DATE:

Upon execution of the revocable permit.

MONTHLY RENTAL:

No charge.

DCCA VERIFICATION:

Place of business registration confirmed:	YES <u>X</u>	NO ___
Registered business name confirmed:	YES <u>X</u>	NO ___
Good standing confirmed:	YES <u>X</u>	NO ___

CHAPTER 343, HRS - ENVIRONMENTAL ASSESSMENT:

The environmental impacts of the proposed action to the subject land area is covered by
the Honolulu International Airport, Airport Modernization Program Environmental
Assessment (EA), State Project No. AO1030-13. The EA is a joint State and Federal
document dated January 2013, and published in the February 8, 2013 issue of the OEQC
Bulletin. Accordingly, the actions have been determined to have little or no impact upon
the environment.

ISSUANCE OF A REVOCABLE PERMIT FOR THE INSTALLATION OF A SATELLITE
DISH, CITY AND COUNTY OF HONOLULU POLICE DEPARTMENT

Page 3

REMARKS:

In accordance with HRS, relating to Permits, HDOT proposes to issue a month-to-month revocable permit to HPD for space to install a satellite dish to support its Narcotics and Vice Division operations at the Airport.

RECOMMENDATION:

Based on this submittal, and testimony and facts presented, the HDOT recommends the Director of Transportation finds that approving the issuance of a month-to-month revocable permit to HPD, including its conditions and rent, will best serve the interests of the State.

Respectfully submitted,



CURT T. OTAGURO
Deputy Director of Transportation for Airports

Attachment

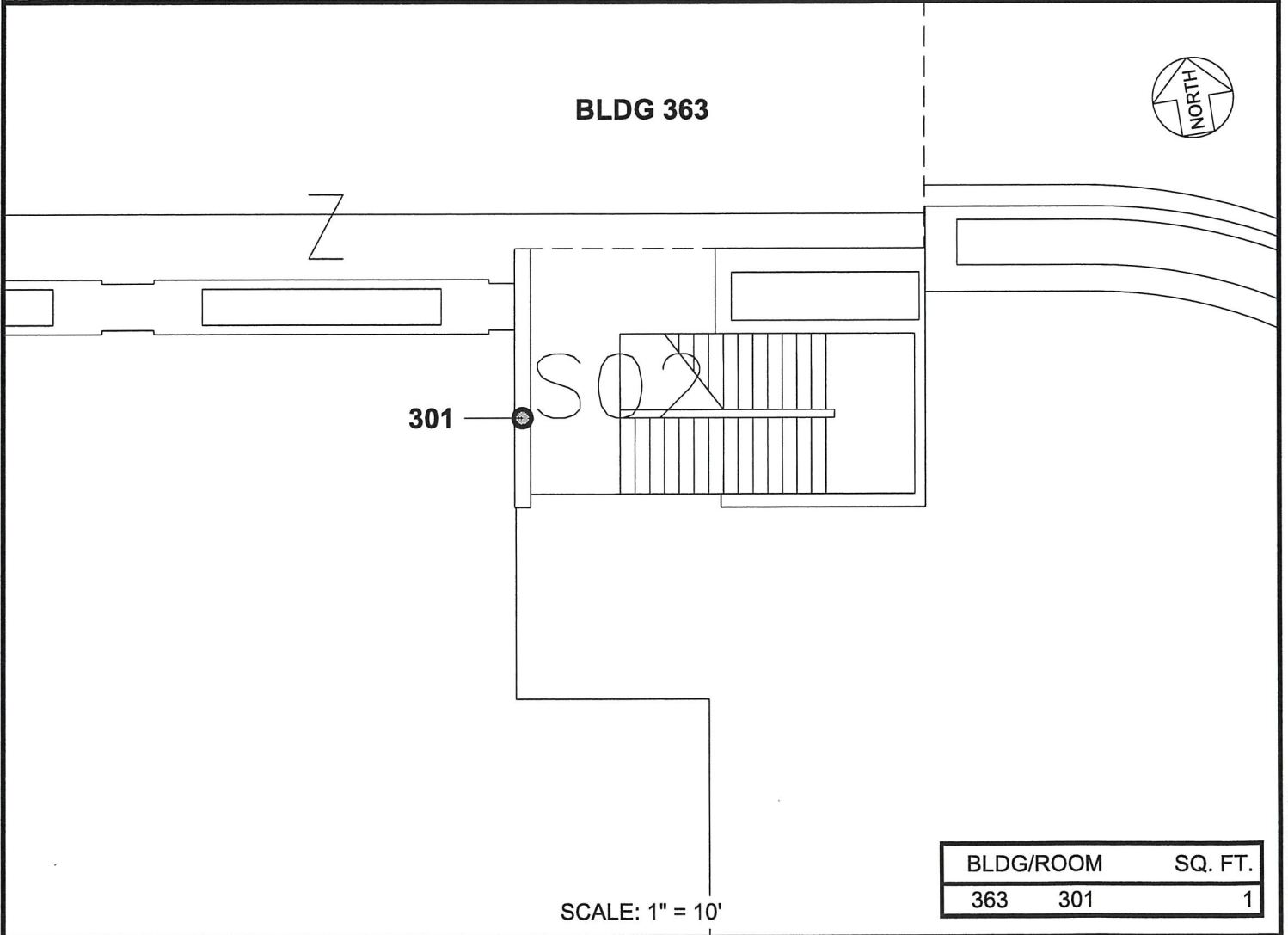
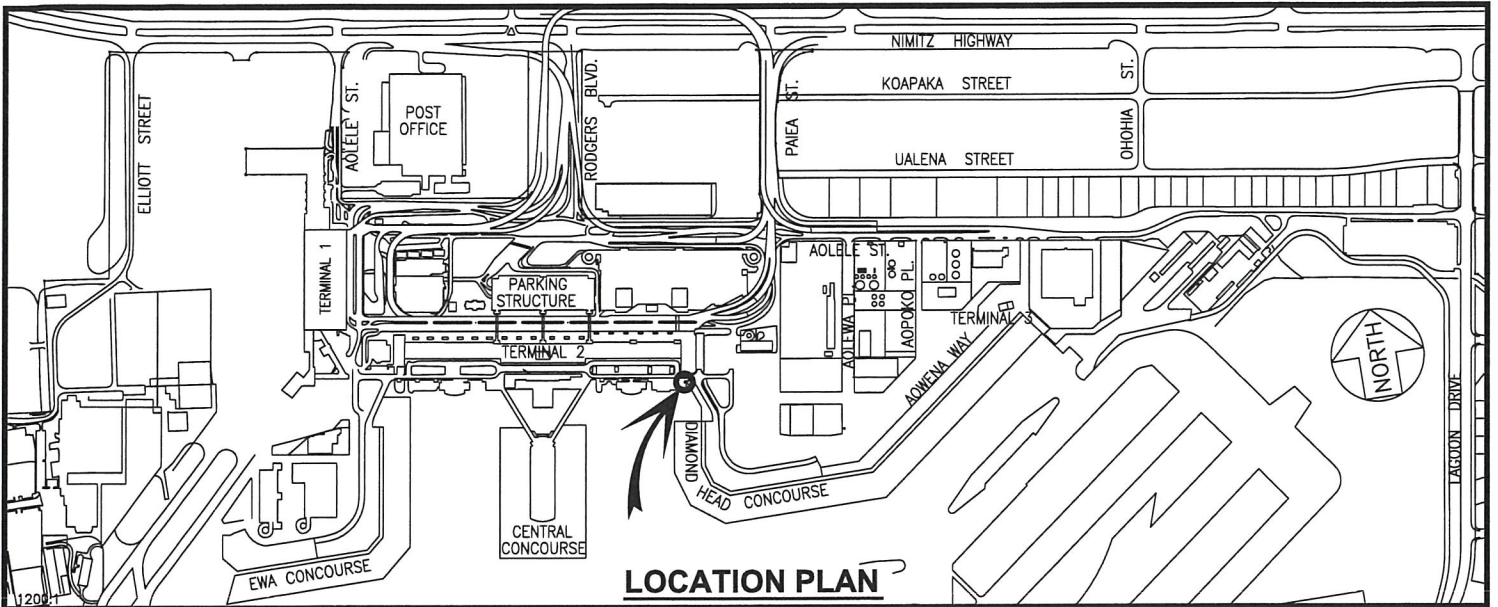

RP-9614	DATE : OCTOBER 2024	EXHIBIT: A
	HONOLULU POLICE DEPARTMENT	BUILDING 363 D.H. CONNECTING LINK THIRD LEVEL 363301

DANIEL K. INOUE INTERNATIONAL AIRPORT

N:\AIRPORTS\IHLH_HONOLULUCAD\IP\IHLH_363301-01.DWG