



**STATE OF HAWAI'I | KA MOKU'ĀINA 'O HAWAI'I
DEPARTMENT OF TRANSPORTATION | KA 'OIHANA ALAKAU
AIRPORTS**

400 RODGERS BOULEVARD, SUITE 700
HONOLULU, HAWAII 96819-1880

AIR-PM 24.0721

November 7, 2024

DOT Land Matters
State of Hawaii
Honolulu, Hawaii

ISSUANCE OF A REVOCABLE PERMIT FOR LAND FOR FIELD OFFICE, VEHICLE
PARKING, STAGING OF MATERIALS, AND OTHER PERMITTED USES
HAWAIIAN DREDGING CONSTRUCTION COMPANY, INC.
KAHULUI AIRPORT
TAX MAP KEY: (2) 3-8-001: PORTION OF 019

MAUI

APPLICANT:

Hawaiian Dredging Construction Company, Inc. (HDCC), whose mailing address is
605 Kapiolani Boulevard, Honolulu, Hawaii 96813.

LEGAL REFERENCE:

Hawaii Revised Statutes (HRS), Sections 26-19 and 171, as amended.

LOCATION AND TAX MAP KEY:

Portion of Kahului Airport (OGG), Kahului, Island of Maui, identified by
Tax Map Key: 2nd Division, 3-8-001: Portion of 019.

AREAS:

Area/Space No. 822-106B, containing an area of approximately 19,715 square feet of
improved, unpaved land, and Area/Space No. 822-107, containing an area of
approximately 75,697 square feet of improved, paved and unpaved land, as shown and
delineated on the attached map labeled Exhibit A.

ZONING:

State Land Use District:	Urban
County of Maui:	Airport

ISSUANCE OF A REVOCABLE PERMIT FOR LAND FOR FIELD OFFICE,
VEHICLE PARKING, STAGING OF MATERIALS, AND OTHER PERMITTED USES
HAWAIIAN DREDGING CONSTRUCTION COMPANY, INC.

Page 2

LAND TITLE STATUS:

Section 5(a) lands of the Hawaii Admission Act: Non-Ceded
DHHL 30% entitlement lands pursuant to Hawaii Admission Act YES ___ NO X

CURRENT USE STATUS:

Land presently encumbered by Governor's Executive Order No. 2427, dated February 12, 1969, setting aside 1,268.938 acres designated as Kahului Airport to be under the control and management of the State of Hawaii, Department of Transportation (HDOT) for Airport purposes.

CHARACTER OF USE:

HDCC will use the spaces for a mobile office, restrooms, water and ice storage, vehicle parking, gravel driveway and contractor laydown space for State Project No. AM1095-10, South TSA Checkpoint, Kahului Airport.

COMMENCEMENT DATE:

To be determined by the Director of Transportation at a later date.

MONTHLY RENTAL:

\$25.00 (as stated in Section 1.04 - Provisions for Field Office/Storage Space of Specifications and Proposal for State Project No. AM1095-10, South TSA Checkpoint, Kahului Airport).

SECURITY DEPOSIT:

\$75.00, or three times the monthly rental in effect.

DCCA VERIFICATION:

Place of business registration confirmed:	YES <u>X</u>	NO _____
Registered business name confirmed:	YES <u>X</u>	NO _____
Good standing confirmed:	YES <u>X</u>	NO _____

CHAPTER 343, HRS - ENVIRONMENTAL ASSESSMENT:

The HDOT deems the action as de minimis and exempts it from the preparation of an exemption notice in accordance with HAR, Section 11-200.1-16(b). Type 8, Part 1: HDOT administrative activities and operations that would not result in direct, indirect or cumulative adverse impacts to the environment, 8.h., Creation or extension of

ISSUANCE OF A REVOCABLE PERMIT FOR LAND FOR FIELD OFFICE,
VEHICLE PARKING, STAGING OF MATERIALS, AND OTHER PERMITTED USES
HAWAIIAN DREDGING CONSTRUCTION COMPANY, INC.

Page 3

leases, revocable permits or easements of property for continuing aeronautical or maritime uses or complementary purposes.

REMARKS:

The HDOT proposes to issue a month-to-month revocable permit to HDCC for land for a mobile office, restrooms, water and ice storage, vehicle parking, gravel driveway and contractor laydown space for State Project No. AM1095-10, South TSA Checkpoint, Kahului Airport.

RECOMMENDATION:

Based on this submittal, and testimony and facts presented, the HDOT recommends the Director of Transportation finds that approving the issuance of a month-to-month revocable permit to HDCC, including its conditions and rent, will serve the best interests of the State.

Respectfully submitted,



CURT T. OTAGURO
Deputy Director of Transportation for Airports

Attachment

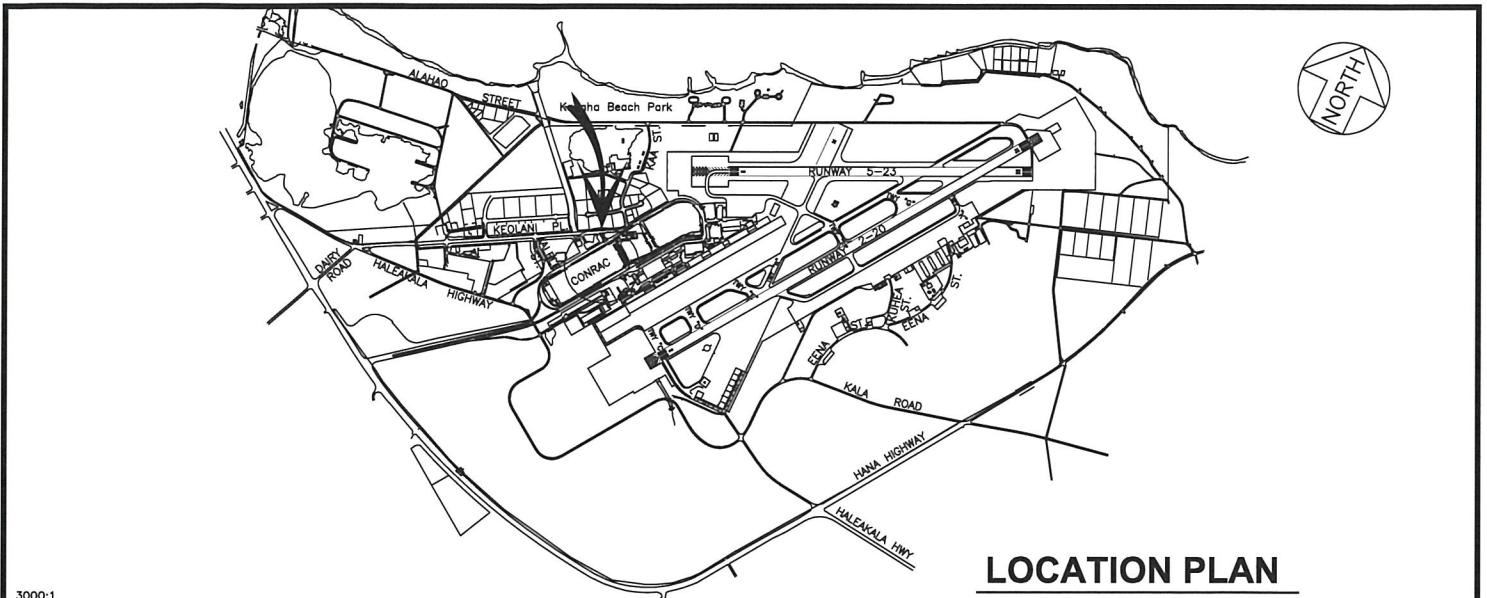

LOCATION PLAN

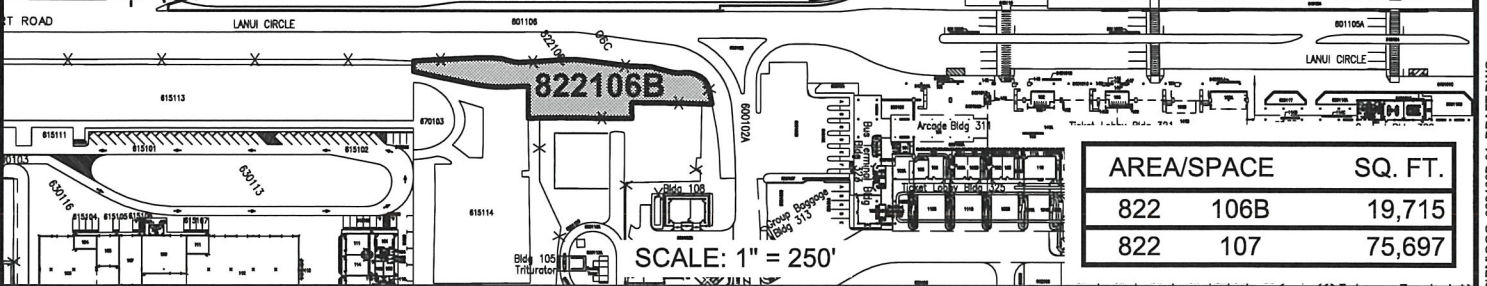
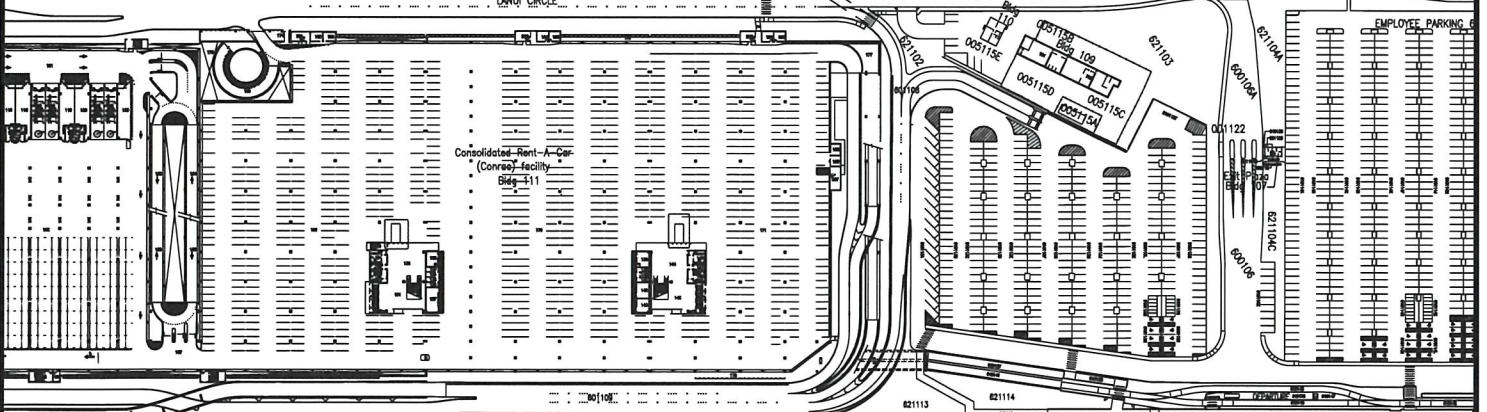
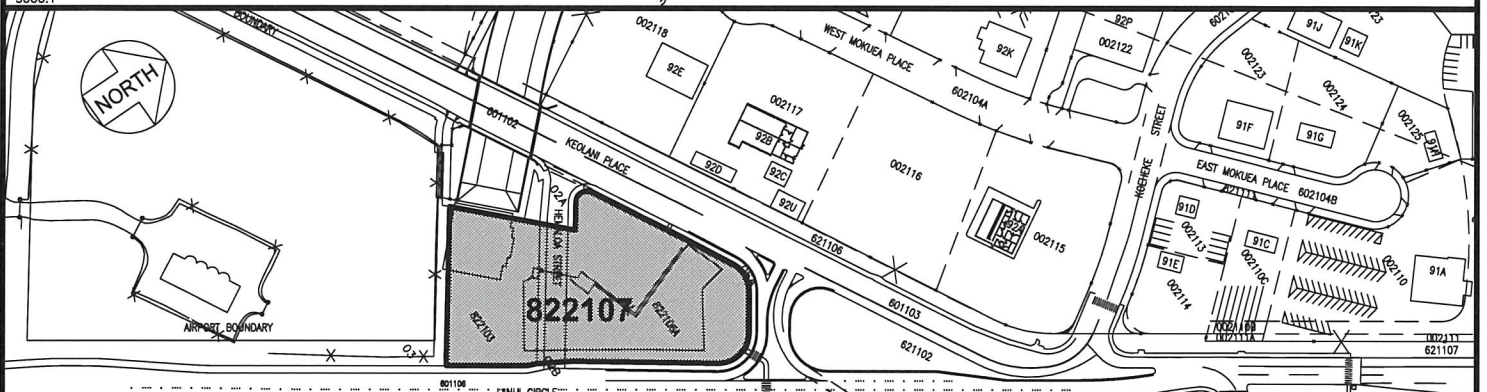

AREA/SPACE	SQ. FT.
822 106B	19,715
822 107	75,697

SCALE: 1" = 250'

DATE : AUGUST 2024

EXHIBIT: **A**



**HAWAIIAN DREDGING
CONSTRUCTION
COMPANY, INC.**

LOTS

**822106B
822107**

KAHULUI AIRPORT

N:\AIRPORTS\SI0GG_KAHULUI\CAD\PM\SI0GG_822106B-01_DRAFT.DWG