

JOSH GREEN, M.D.
GOVERNOR
KE KIA'ĀINA



EDWIN H. SNIFFEN
DIRECTOR
KA LUNA HO'OKELE

Deputy Directors
Nā Hope Luna Ho'okele
DREANALEE K. KALILI
TAMMY L. LEE
CURT T. OTAGURO
ROBIN K. SHISHIDO

**STATE OF HAWAII | KA MOKU'ĀINA 'O HAWAI'I
DEPARTMENT OF TRANSPORTATION | KA 'OIHANA ALAKAU
AIRPORTS
400 RODGERS BOULEVARD, SUITE 700
HONOLULU, HAWAII 96813-5097**

IN REPLY REFER TO:

AIR-PM 24.0921

December 26, 2024

DOT Land Matters
State of Hawaii
Honolulu, Hawaii

ISSUANCE OF A REVOCABLE PERMIT FOR OFFICE SPACE IN SUPPORT OF
HONOLULU (HNL) TRANSPORTATION AND LOGISTICS SERVICE OPERATION
DHL EXPRESS (USA), INC.
DANIEL K. INOUE INTERNATIONAL AIRPORT OAHU
TAX MAP KEY: (1) 1-1-003: 072: PORTION OF 069

APPLICANT:

DHL Express (USA), Inc., whose mailing address is 1210 South Pine Island Road,
2nd Floor, Plantation, Florida 33324.

LEGAL REFERENCE:

Hawaii Revised Statutes (HRS), Section 26-19 and 171-2, as amended.

LOCATION AND TAX MAP KEY:

90 Nakolo Place, Building No. 206, Second Level, at the Daniel K. Inouye
International Airport (Airport), Island of Oahu, State of Hawaii, identified by
Tax Map Key: 1st Division, 1-1-003: 072: Portion of 069.

AREA:

Building/Room No. 206-218, containing an area of approximately 252 square feet,
as shown and delineated on the attached map labeled Exhibit A.

ZONING:

State Land Use District: Urban
City and County of Honolulu LUO: Industrial (I-2)

ISSUANCE OF A REVOCABLE PERMIT FOR OFFICE SPACE IN SUPPORT OF
HONOLULU (HNL) TRANSPORTATION AND LOGISTICS SERVICE OPERATION
DHL EXPRESS (USA), INC.

Page 2

LAND TITLE STATUS:

Non-ceded - Section 5(a) lands of the Hawaii Admission Act
DHHL 30% entitlement lands pursuant to Hawaii Admission Act YES ___ NO X

CURRENT USE STATUS:

Land presently encumbered by Governor's Executive Order No. 3201, dated June 8, 1983, setting aside 3,152.177 acres designated as Daniel K. Inouye International Airport under the control and management of the State of Hawaii Department of Transportation (HDOT) for Airport purposes.

CHARACTER OF USE:

DHL Express (USA), Inc., will use the space as an office for the HNL transportation and logistics service operation at the Airport.

COMMENCEMENT DATE:

Upon execution of the revocable permit.

MONTHLY RENTAL:

\$428.40 (\$204.12, as determined from the HDOT Schedule of Rates and Charges, established by appraisal of Airports properties statewide plus \$63.00 for air conditioning, \$63.00 for maintenance, and \$98.28 for utilities).

SECURITY DEPOSIT:

\$1,285.20, or three times the monthly rental in effect.

DCCA VERIFICATION:

Place of business registration confirmed:	YES <u>X</u>	NO ___
Registered business name confirmed:	YES <u>X</u>	NO ___
Good standing confirmed:	YES <u>X</u>	NO ___

CHAPTER 343, HRS - ENVIRONMENTAL ASSESSMENT:

The environmental impacts of the proposed action to the subject land area are covered by the Honolulu International Airport Master Plan Update and Noise Compatibility Program Environmental Assessment (EA), State Project No. AO1011-03. The EA is a joint State and Federal document, dated September 1989 and published in the October 23, 1989

ISSUANCE OF A REVOCABLE PERMIT FOR OFFICE SPACE IN SUPPORT OF
HONOLULU (HNL) TRANSPORTATION AND LOGISTICS SERVICE OPERATION
DHL EXPRESS (USA), INC.

Page 3

issue of the OEQC Bulletin. Accordingly, relevant mitigation from the EA and HDOT environmental best management practice will address minimal impacts from this action.

REMARKS:

HDOT proposes to issue a month-to-month revocable permit to DHL Express (USA), Inc., for office space to support HNL transportation and logistics service operation, situated at the Airport.

RECOMMENDATION:

Based on this submittal, and testimony and facts presented, the HDOT recommends the Director of Transportation finds that approving the issuance of a month-to-month revocable permit to DHL Express (USA), Inc., including its conditions and rent, will serve the best interests of the State.

Respectfully submitted,



CURT T. OTAGURO

Deputy Director of Transportation for Airports

Attachment

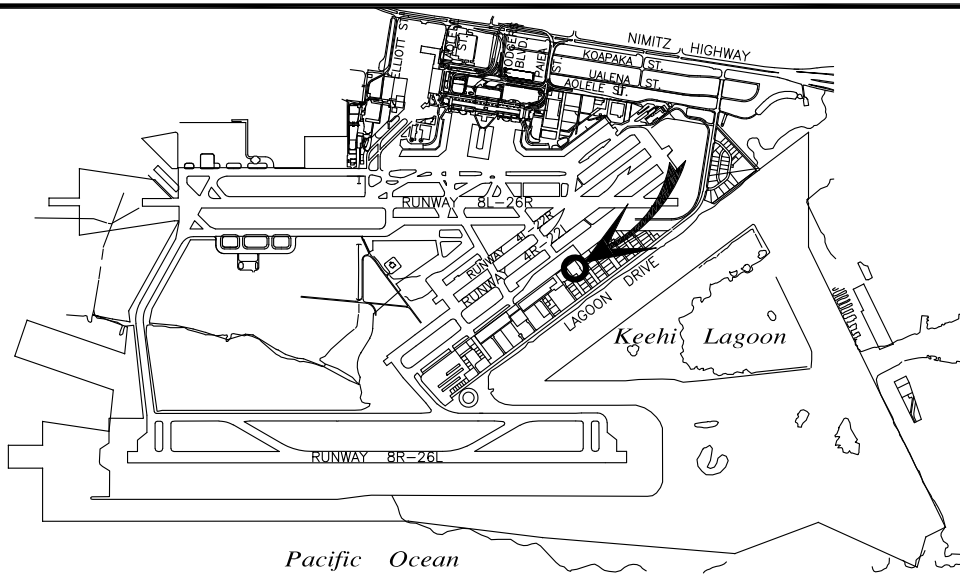

LOCATION PLAN

BLDG 206

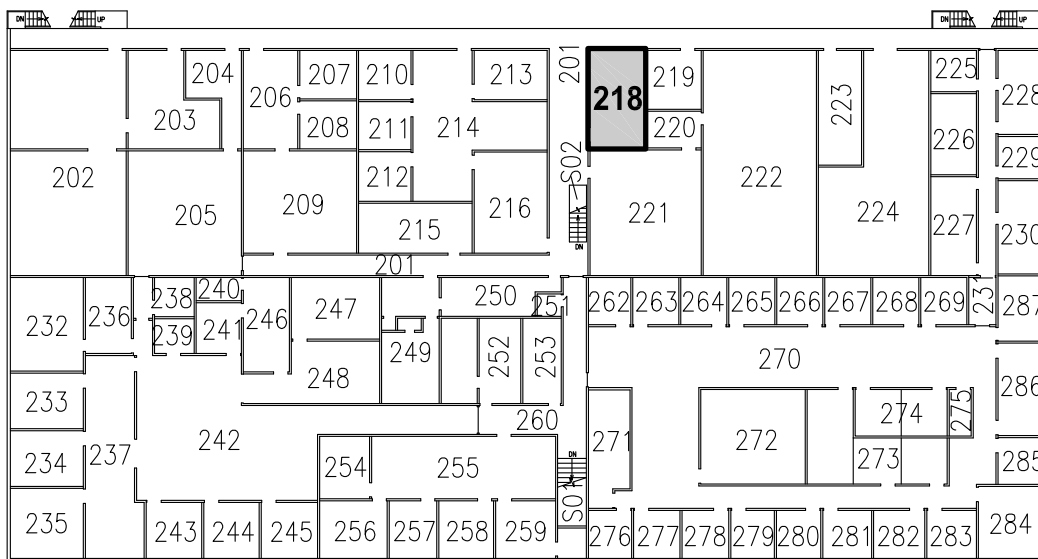

BLDG/ROOM	SQ. FT.
206 218	252

SCALE: 1" = 40'

DATE : NOVEMBER 2024

EXHIBIT: **A**



AIRPORTS

DHL EXPRESS (USA), INC.

**BUILDING 206
AIR SERVICE
CORPORATION
SECOND LEVEL**

206218

DANIEL K. INOUE INTERNATIONAL AIRPORT