



**STATE OF HAWAII | KA MOKU'ĀINA 'O HAWAII'**  
**DEPARTMENT OF TRANSPORTATION | KA 'OIHANA ALAKAU**  
**AIRPORTS**  
400 RODGERS BOULEVARD, SUITE 700  
HONOLULU, HAWAII 96819-1880

IN REPLY REFER TO:

**AIR-PM 24.0868**

December 12, 2024

DOT Land Matters  
State of Hawaii  
Honolulu, Hawaii

ISSUANCE OF A REVOCABLE PERMIT FOR USE OF A T-HANGAR  
FOR STORAGE AND MAINTENANCE OF A PERSONAL AIRCRAFT  
ERIC G. POPKO  
DANIEL K. INOUE INTERNATIONAL AIRPORT  
TAX MAP KEY: (1) 1-1-076: PORTION OF 21

OAHU

APPLICANT:

Eric G. Popko, whose mailing address is 91-1592 Wahane Street, Kapolei, Hawaii 96707.

LEGAL REFERENCE:

Hawaii Revised Statutes (HRS), Section 26-19 and 171-2, as amended.

LOCATION AND TAX MAP KEY:

A portion of Daniel K. Inouye International Airport (Airport), identified as South Ramp, Island of Oahu, State of Hawaii, identified by Tax Map Key: 1<sup>st</sup> Division, 1-1-076: Portion of 21.

AREA:

Building/Room No. 421-113, containing an area of approximately 1,247 square feet, as shown and delineated on the attached map labeled Exhibit A.

ZONING:

State Land Use District: Urban  
City and County of Honolulu LUO: Industrial (I-2)

ISSUANCE OF A REVOCABLE PERMIT FOR USE OF A T-HANGAR FOR STORAGE  
AND MAINTENANCE OF A PERSONAL AIRCRAFT  
ERIC G. POPKO  
PAGE 2

LAND TITLE STATUS:

Non-ceded - Section 5(a) lands of the Hawaii Admission Act  
DHHL 30% entitlement lands pursuant to Hawaii Admission Act YES \_\_\_ NO X

CURRENT USE STATUS:

Land presently encumbered by Governor's Executive Order No. 3201, dated June 8, 1983, setting aside 3,152.177 acres designated as the Airport under the control and management of the State of Hawaii, Department of Transportation (HDOT), for Airport Purposes.

CHARACTER OF USE:

T-Hangar for storage and maintenance of a personal aircraft (1976 Cessna 150M, Tail No. N704QH).

COMMENCEMENT DATE:

To be determined by the Director of Transportation at a later date.

MONTHLY RENTAL:

\$728.00 (\$673.00, as determined from the HDOT Schedule of Rates and Charges established by appraisal of Airports properties statewide plus \$55.00 for electricity).

SECURITY DEPOSIT:

\$2,184.00, or three times the monthly rental in effect.

CHAPTER 343, HRS - ENVIRONMENTAL ASSESSMENT:

The environmental impacts of the proposed action to the subject land area are covered by the Honolulu International Airport Master Plan Update and Noise Compatibility Program Environmental Assessment (EA), State Project No. AO1011-03. The EA is a joint State and Federal document, dated September 1989 and published in the October 23, 1989 issue of the OEQC Bulletin. Accordingly, relevant mitigation from the EA and HDOT environmental best management practice will address minimal impacts from this action.

REMARKS:

HDOT proposes to issue a month-to-month Revocable Permit to Eric G. Popko for use of a T-Hangar for the storage and maintenance of a personal aircraft, situated at the Airport.

ISSUANCE OF A REVOCABLE PERMIT FOR USE OF A T-HANGAR FOR STORAGE  
AND MAINTENANCE OF A PERSONAL AIRCRAFT  
ERIC G. POPKO  
PAGE 3

RECOMMENDATION:

Based on this submittal, and testimony and facts presented, the HDOT recommends the Director of Transportation finds that approving the issuance of a month-to-month Revocable Permit to Eric G. Popko, including its conditions and rent, will serve the best interests of the State.

Respectfully submitted,



CURT T. OTAGURO  
Deputy Director of Transportation for Airports

Attachment

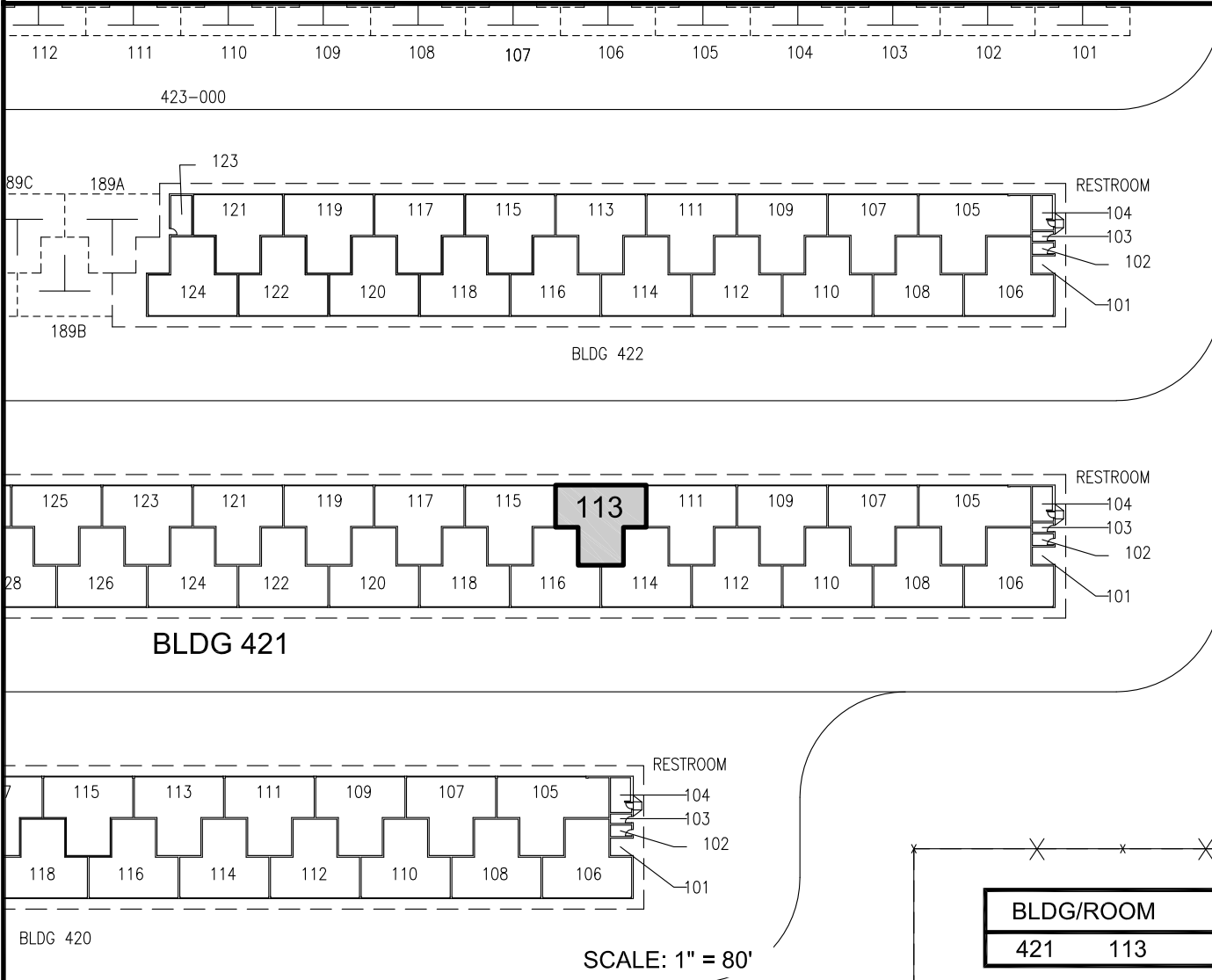
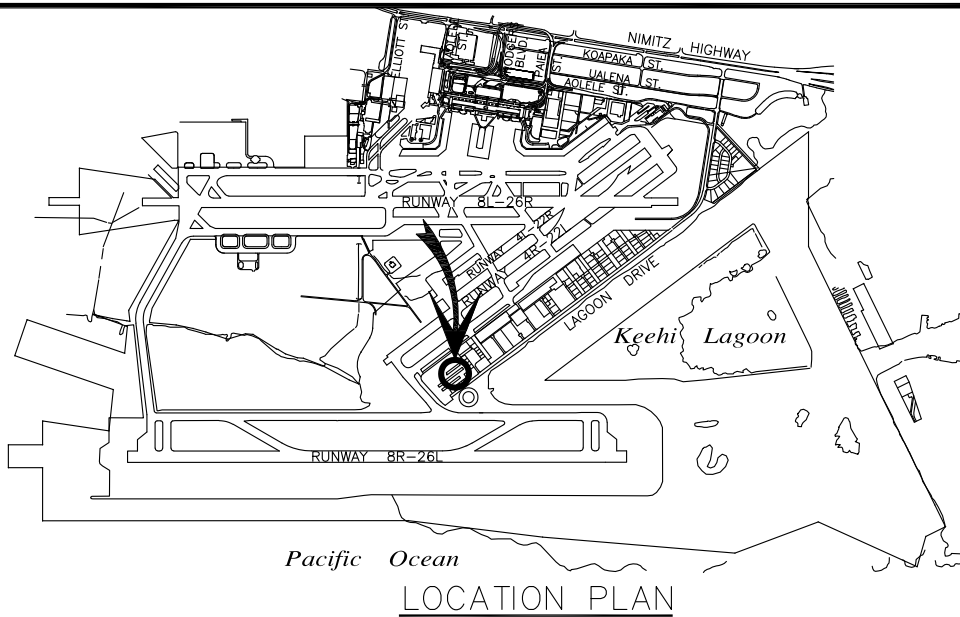

BLDG/ROOM	SQ. FT.
421 113	1,247

RP-9628

DATE : NOVEMBER 2024

EXHIBIT: **A**



ERIC G. POPKO

T-HANGAR

421113

**DANIEL K. INOUE INTERNATIONAL AIRPORT**

N:\AIRPORTS\HNL\_HONOLULUCAD\PM\HNL\_421113-01.DWG