

JOSH GREEN, M.D.
GOVERNOR
KE KIA'ĀINA



STATE OF HAWAII | KA MOKU'ĀINA 'O HAWAII'
DEPARTMENT OF TRANSPORTATION | KA 'OIHANA ALAKAU
AIRPORTS
400 RODGERS BOULEVARD, SUITE 700
HONOLULU, HAWAII 96819-1880

EDWIN H. SNIFFEN
DIRECTOR
KA LUNA HO'OKELE

Deputy Directors
Nā Hope Luna Ho'okele
DREANALEE K. KALILI
TAMMY L. LEE
CURT T. OTAGURO
ROBIN K. SHISHIDO

IN REPLY REFER TO:

AIR-PM 24.0871

DOT Land Matters
State of Hawaii
Honolulu, Hawaii

ISSUANCE OF A REVOCABLE PERMIT FOR COMMERCIAL USE OF A
T-HANGAR FOR STORAGE OF AIRCRAFT AND A MAINTENANCE HANGAR
GO FLY MAUI LLC
KAHULUI AIRPORT
TAX MAP KEY: (2) 3-8-001: PORTION OF 195

MAUI

APPLICANT:

Go Fly Maui LLC (GFM), whose mailing address is P.O. Box 790081,
Paia, Hawaii 96779.

LEGAL REFERENCE:

Hawaii Revised Statutes (HRS), Sections 26-19 and 171, as amended.

LOCATION AND TAX MAP KEY:

Portion of Kahului Airport (OGG), Kahului, Island of Maui, identified by
Tax Map Key: 2nd Division, 3-8-001: Portion of 195.

AREA:

Building/Room No. 409-106, containing an area of approximately 1,488 square feet, as
shown and delineated on the attached Exhibit A.

ZONING:

State Land Use District:	Urban
County of Maui:	Airport

ISSUANCE OF A REVOCABLE PERMIT FOR COMMERCIAL USE OF A
T-HANGAR FOR STORAGE OF AIRCRAFT AND A MAINTENANCE HANGAR
GO FLY MAUI LLC

Page 2

LAND TITLE STATUS:

Section 5(a) lands of the Hawaii Admission Act: Non-Ceded
DHHL 30% entitlement lands pursuant to Hawaii Admission Act YES ___ NO X

CURRENT USE STATUS:

Land presently encumbered by Governor's Executive Order No. 2427, dated February 12, 1969, setting aside 1,268.938 acres designated as Kahului Airport to be under the control and management of the State of Hawaii, Department of Transportation (HDOT) for Airport purposes.

CHARACTER OF USE:

Storage of aircraft (Robinson Helicopter, R44, Tail No. N-23HH) and a maintenance hangar as part of its flight school operations.

COMMENCEMENT DATE:

To be determined by the Director of Transportation at a later date.

MONTHLY RENTAL:

\$2,321.28 (\$1,740.96 as determined from the HDOT Schedule of Rates and Charges established by appraisal of Airports property statewide plus \$580.32 for utilities).

SECURITY DEPOSIT:

\$6,963.84, or three times the monthly rental in effect.

DCCA VERIFICATION:

Place of business registration confirmed:	YES <u>X</u>	NO ___
Registered business name confirmed:	YES <u>X</u>	NO ___
Good standing confirmed:	YES <u>X</u>	NO ___

CHAPTER 343, HRS - ENVIRONMENTAL ASSESSMENT:

The HDOT has determined that the subject area and use is covered by the Kahului Airport Terminal Complex Expansion Negative Declaration, published by the Environmental Quality Commission (EQC) in the September 8, 1981, issue of the EQC Bulletin. Accordingly, all relevant mitigation from the Negative Declaration and best management practices will be implemented to address the minimum impacts of this action.

ISSUANCE OF A REVOCABLE PERMIT FOR COMMERCIAL USE OF A
T-HANGAR FOR STORAGE OF AIRCRAFT AND A MAINTENANCE HANGAR
GO FLY MAUI LLC

Page 3

REMARKS:

The HDOT proposes to issue a month-to-month revocable permit to GFM for storage of aircraft and a maintenance hangar as part of its flight school operations.

RECOMMENDATION:

Based on this submittal, and testimony and facts presented, the HDOT recommends the Director of Transportation finds that approving the issuance of a month-to-month revocable permit to GFL, including its conditions and rent, will serve the best interests of the State.

Respectfully submitted,



CURT T. OTAGURO
Deputy Director of Transportation for Airports

Attachment

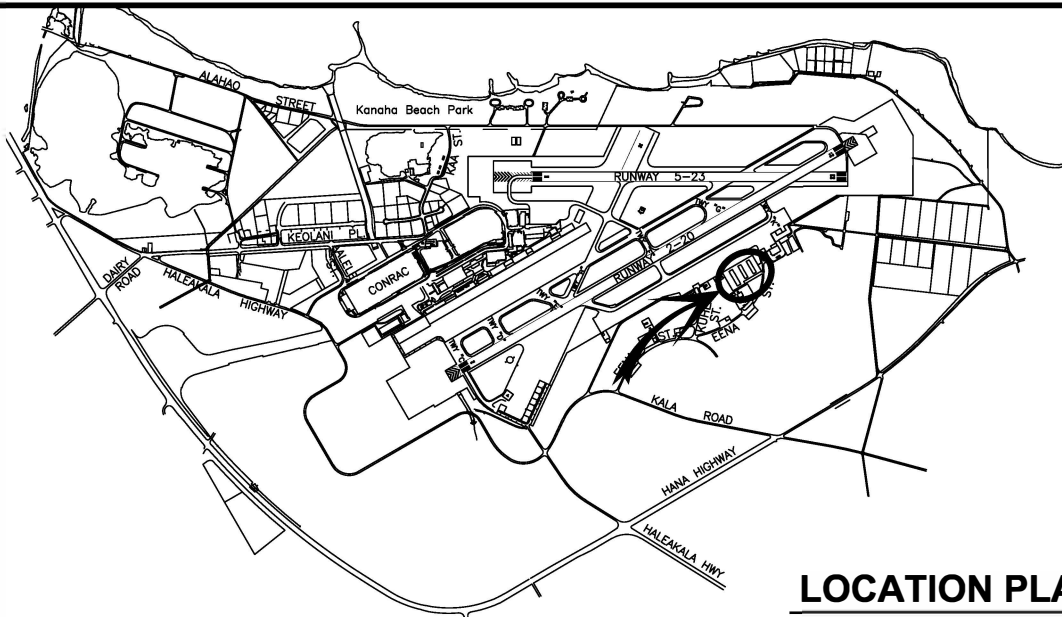

LOCATION PLAN

3000:1

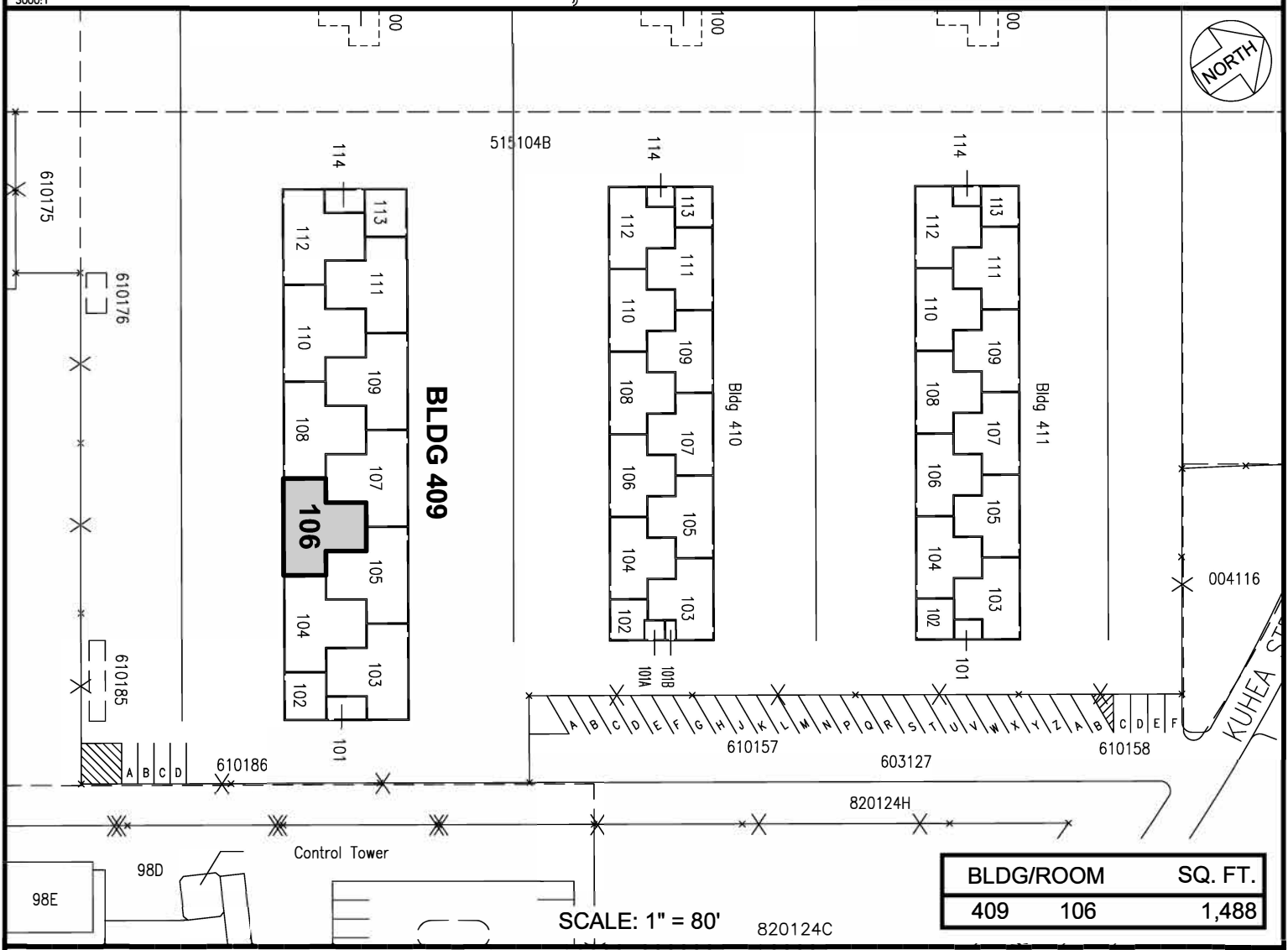

BLDG/ROOM	SQ. FT.
409 106	1,488

SCALE: 1" = 80'

DATE : NOVEMBER 2023

EXHIBIT: **A**

	<p>GO FLY MAUI LLC</p>	<p>T-HANGAR</p>	<p>409106</p>
--	------------------------	-----------------	---------------

KAHULUI AIRPORT

N:\AIRPORTS\IOGG_KAHULUI\CADD\PM\IOGG_409106-01.DWG