



STATE OF HAWAII | KA MOKU'ĀINA 'O HAWAII'
DEPARTMENT OF TRANSPORTATION | KA 'OIHANA ALAKAU
AIRPORTS
400 RODGERS BOULEVARD, SUITE 700
HONOLULU, HAWAII 96819-1880

AIR-PM 25.0103

February 27, 2025

DOT Land Matters
State of Hawaii
Honolulu, Hawaii

ISSUANCE OF A REVOCABLE PERMIT FOR AIRCRAFT PARKING
NORMAN KAUFMAN
KAHULUI AIRPORT
TAX MAP KEY: (2) 3-8-001: PORTION OF 019

MAUI

REQUEST:

Issuance of a Revocable Permit for Aircraft Parking (Parking Permit)
to Norman Kaufman, situated at Kahului Airport.

APPLICANT:

Norman Kaufman, whose mailing address is 1050 Anapuni Place,
Lahaina, Hawaii 96761.

LEGAL REFERENCE:

Hawaii Revised Statutes (HRS), Sections 26-19 and 171-2, as amended.

LOCATION AND TAX MAP KEY:

Portion of Kahului Airport (OGG), Kahului, Island of Maui, identified by
Tax Map Key: 2nd Division, 3-8-001: Portion of 019.

AREA:

Area/Space No. 408-123, containing an area of approximately 900 square feet, as shown
and delineated on the attached Exhibit A.

ITEM C-1

ISSUANCE OF A REVOCABLE PERMIT FOR AIRCRAFT PARKING
NORMAN KAUFMAN
Page 2

ZONING:

State Land Use District: Urban
County of Maui: Airport

LAND TITLE STATUS:

Section 5(a) lands of the Hawaii Admission Act: Non-Ceded
DHHL 30% entitlement lands pursuant to Hawaii Admission Act YES___ NO X

CURRENT USE STATUS:

Land presently encumbered by Governor's Executive Order No. 2427, dated February 12, 1969, setting aside 1,268.938 acres designated as Kahului Airport to be under the control and management of the State of Hawaii Department of Transportation (HDOT) for Airport purposes.

CHARACTER OF USE:

Aircraft (Piper Arrow IV, N81626) tie-down.

COMMENCEMENT DATE:

To be determined by the Director of Transportation at a later date.

MONTHLY RENTAL:

\$130.00 (as determined from the HDOT Schedule of Rates and Charges established by appraisal of Airports property statewide).

SECURITY DEPOSIT:

\$390.00, or three times the monthly rental in effect.

CHAPTER 343, HRS - ENVIRONMENTAL ASSESSMENT:

The HDOT has determined that the subject area and use is covered by the Kahului Airport Terminal Complex Expansion Negative Declaration, published by the Environmental Quality Commission (EQC) in the September 8, 1981, issue of the EQC Bulletin. Accordingly, all relevant mitigation from the Negative Declaration and best management practices will be implemented to address the minimum impacts of this action.

ISSUANCE OF A REVOCABLE PERMIT FOR AIRCRAFT PARKING
NORMAN KAUFMAN
Page 3

REMARKS:

The HDOT proposes to issue a month-to-month Parking Permit to Norman Kaufman for aircraft parking.

RECOMMENDATION:

Based on this submittal, and testimony and facts presented, the HDOT recommends the Director of Transportation finds that approving the issuance of a month-to-month Parking Permit to Norman Kaufman, including its conditions and rent, will serve the best interests of the State.

Respectfully submitted,



CURT T. OTAGURO
Deputy Director of Transportation for Airports

Attachment

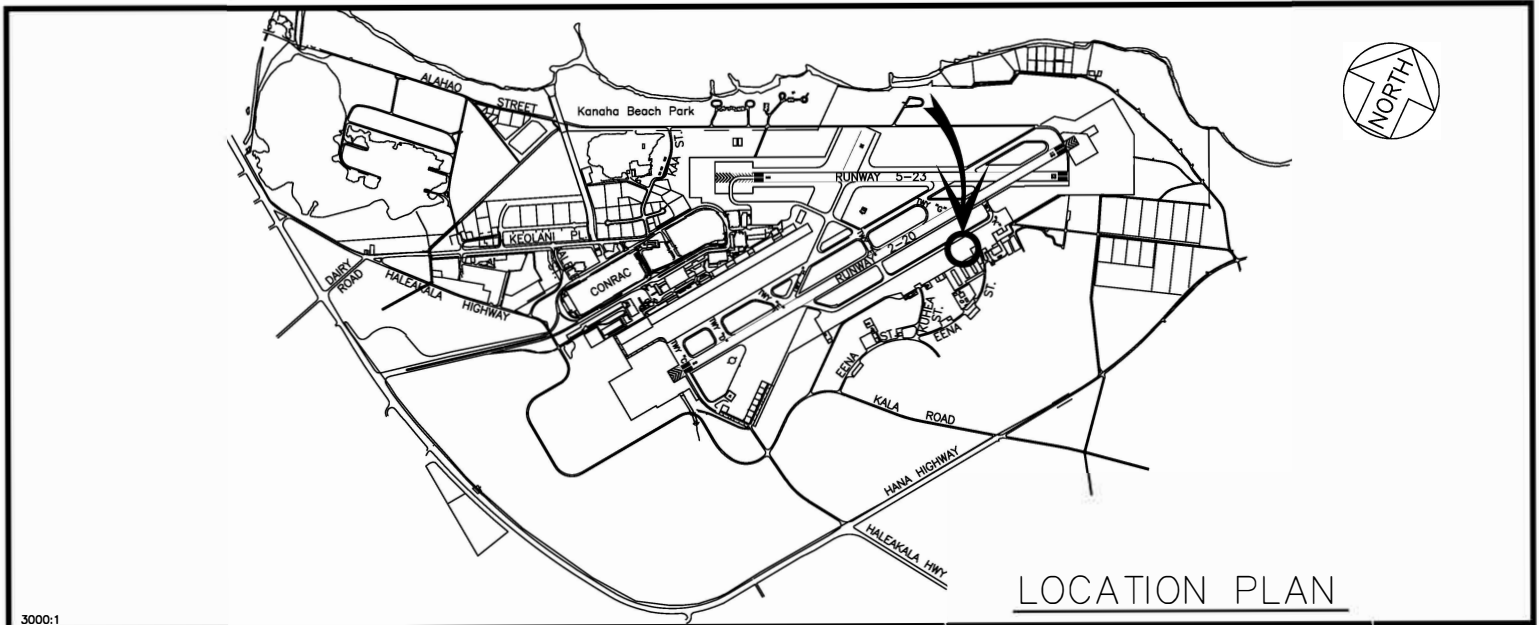

3000:1

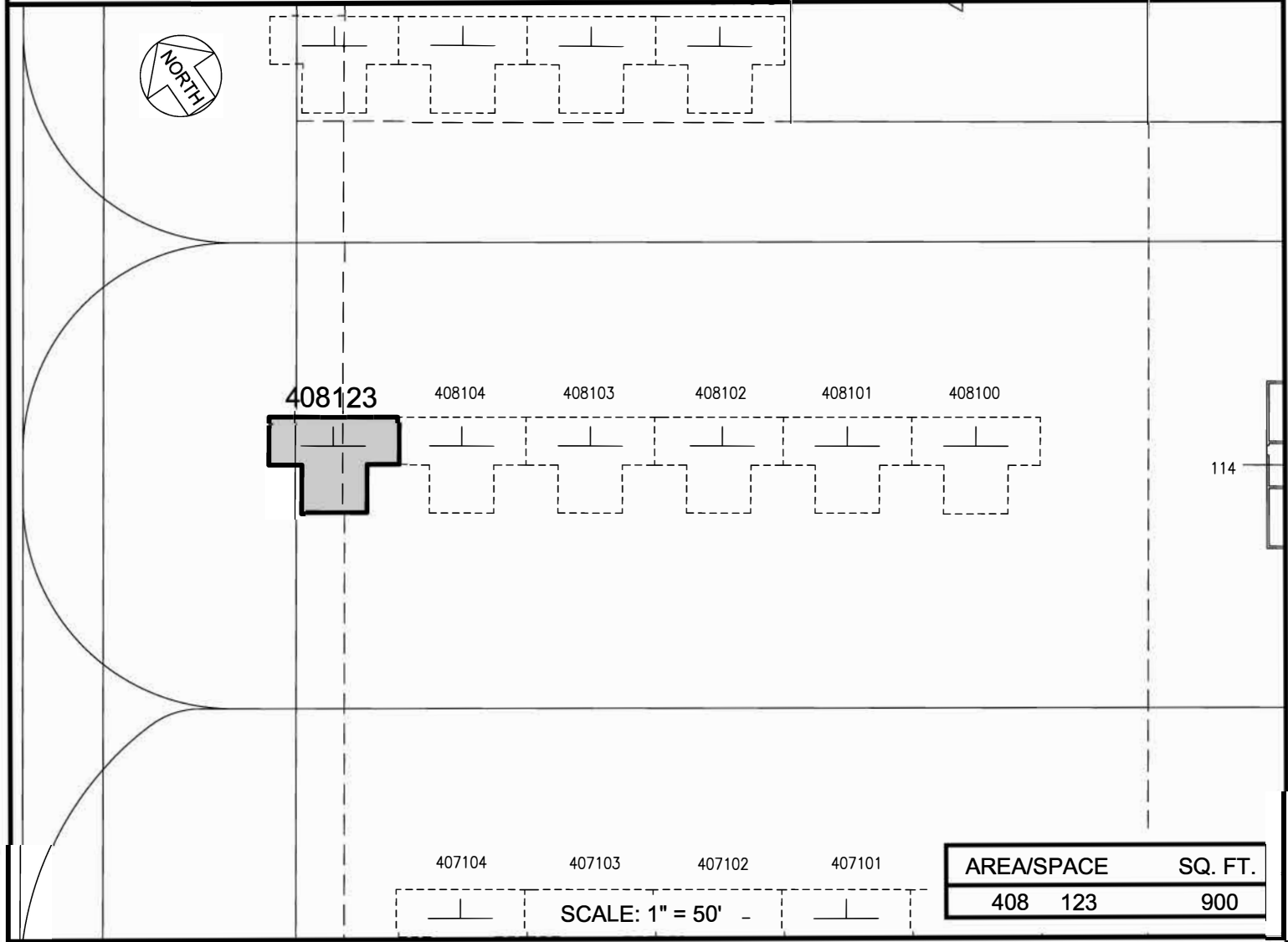

| AREA/SPACE | SQ. FT. |
|------------|---------|
| 408 123 | 900 |

SCALE: 1" = 50'

PP-25-M001

DATE : OCTOBER 2024

EXHIBIT: **A**

| | | | |
|---|-----------------------|-----------------|---------------|
|  <p>AIRPORTS</p> | <p>NORMAN KAUFMAN</p> | <p>TIE-DOWN</p> | <p>408123</p> |
|---|-----------------------|-----------------|---------------|

KAHULUI AIRPORT

N:\AIRPORTS\IOGG_KAHULUI\CAD\PM\IOGG_408123-01.DWG