

JOSH GREEN, M.D.
GOVERNOR
KE KIA'ĀINA



**STATE OF HAWAI'I | KA MOKU'ĀINA 'O HAWAI'I
DEPARTMENT OF TRANSPORTATION | KA 'OIHANA ALAKAU
AIRPORTS
400 RODGERS BOULEVARD, SUITE 700
HONOLULU, HAWAII 96819-1880**

EDWIN H. SNIFFEN
DIRECTOR
KA LUNA HO'OKELE

Deputy Directors
Nā Hope Luna Ho'okele
DREANALEE K. KALILI
TAMMY L. LEE
CURT T. OTAGURO
ROBIN K. SHISHIDO

IN REPLY REFER TO:

AIR-PM 25.0261

April 10, 2025

DOT Land Matters
State of Hawaii
Honolulu, Hawaii

ISSUANCE OF A REVOCABLE PERMIT FOR AIRCRAFT PARKING
HONOLULU SOARING INC.
KAWAIHAPAI AIRFIELD, WAIALUA, HAWAII
TAX MAP KEY: (1) 6-8-014:001 (PORTION)

OAHU

REQUEST:

Issuance of a revocable permit for Aircraft Parking (Parking Permit) to
Honolulu Soaring Inc., situated at Kawaihapai Airfield.

APPLICANT:

Honolulu Soaring Inc., whose mailing address is 94-1059 Meahale Place,
Waipahu, Hawaii 96797.

LEGAL REFERENCE:

Hawaii Revised Statutes (HRS), Section 26-19 and 171-2, as amended.

LOCATION AND TAX MAP KEY:

A portion of Kawaihapai Airfield, Waialua, Island of Oahu, State of Hawaii, identified by
Tax Map Key: 1st Division, 6-8-014:001 (portion).

AREA:

Area/Space No. 405-103, containing an area of approximately 1,890 square feet, as
shown and delineated on the attached map labeled Exhibit A.

ISSUANCE OF A REVOCABLE PERMIT FOR AIRCRAFT PARKING
HONOLULU SOARING INC.
Page 2

ZONING:

State Land Use District: Agriculture
City and County of Honolulu LUO: AG-2

LAND TITLE STATUS:

Ceded land, which the State of Hawaii is currently leasing the land from the United States of America.

CHARACTER OF USE:

Aircraft tie-down (1973 Schweizer SGS 2-33A/Tail No. N-17902).

COMMENCEMENT DATE:

To be determined by the Director of Transportation at a later date.

MONTHLY RENTAL:

\$55.00, as determined from the State of Hawaii Department of Transportation (HDOT) Schedule of Rates and Charges, established by appraisal of Airports property statewide.

SECURITY DEPOSIT:

\$165.00, or three times the monthly rental in effect.

DCCA VERIFICATION:

Place of business registration confirmed:	YES <u>X</u>	NO ____
Registered business name confirmed:	YES <u>X</u>	NO ____
Good standing confirmed:	YES <u>X</u>	NO ____

CHAPTER 343, HRS - ENVIRONMENTAL ASSESSMENT:

The subject land area is covered by the revised and updated Environmental Assessment for the Dillingham Airfield Master Plan and FAR Part 150 Noise Compatibility Program project, referenced as State Contract No. 26985, State Project No. AO2011-01. This Environmental Assessment evaluated the environmental effects of the recommended Dillingham Airfield Master Plan to meet existing and forecast general aviation demands and was prepared for the HDOT.

ISSUANCE OF A REVOCABLE PERMIT FOR AIRCRAFT PARKING
HONOLULU SOARING INC.
Page 3

REMARKS:

HDOT proposes to issue a month-to-month Parking Permit to Honolulu Soaring Inc., for aircraft parking situated at Kawaihapai Airfield.

RECOMMENDATION:

Based on this submittal, and testimony and facts presented, the HDOT recommends the Director of Transportation finds that approving the issuance of a month-to-month Parking Permit to Honolulu Soaring Inc., including its conditions and rent, will serve the best interests of the State.

Respectfully submitted,



CURT T. OTAGURO
Deputy Director of Transportation for Airports

Attachment

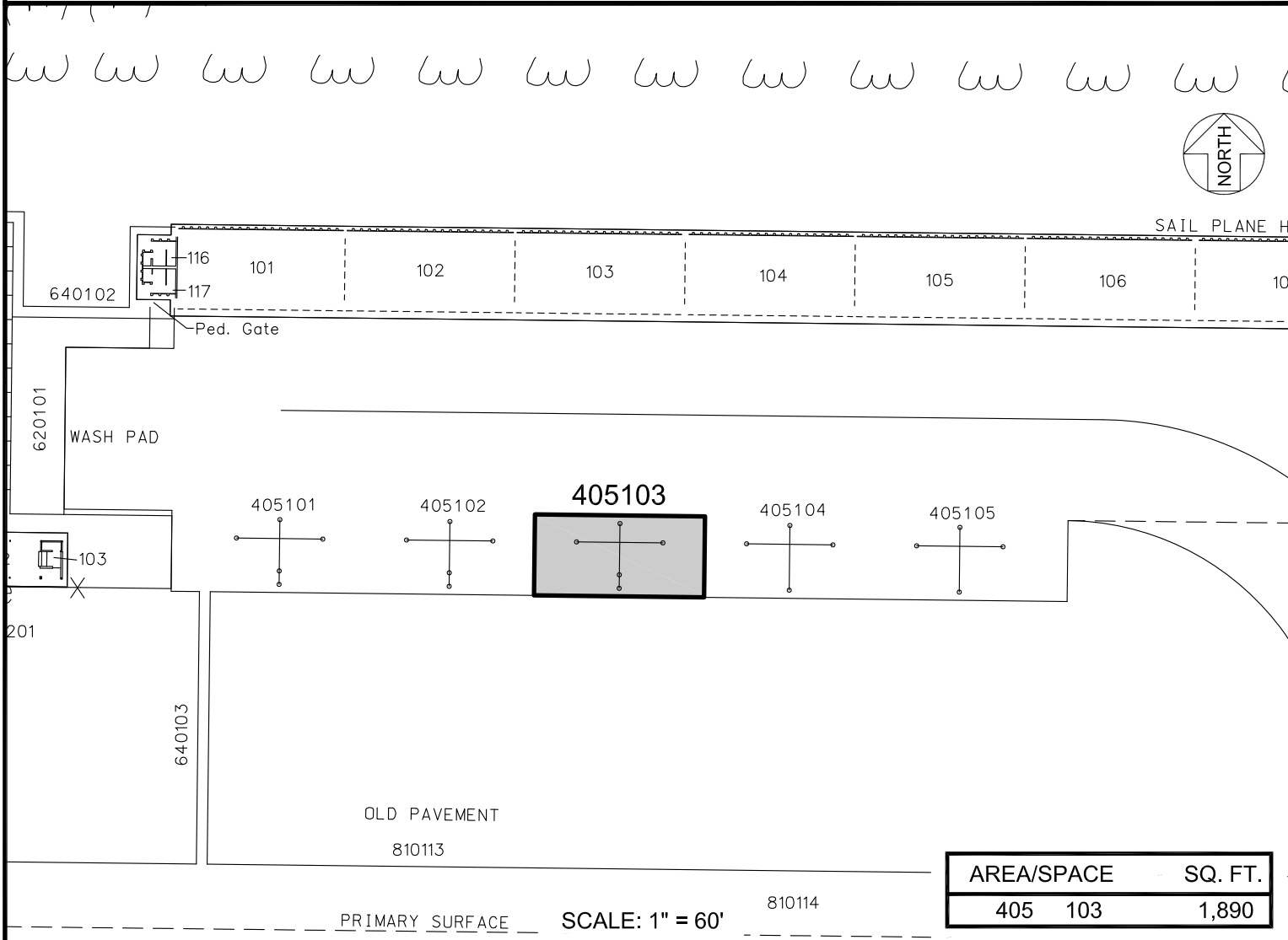
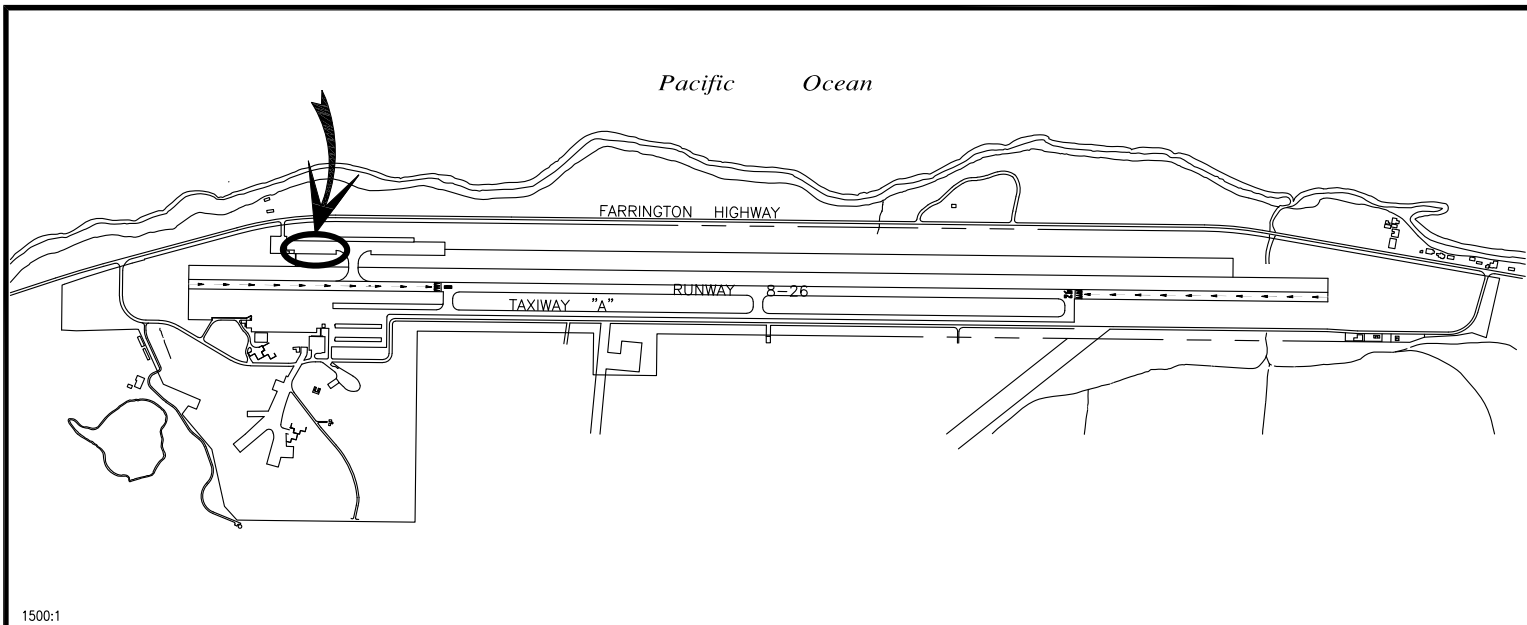

AREA/SPACE		SQ. FT.
405	103	1,890

PP-25-0006		DATE : MARCH 2025		EXHIBIT: A	
		AIRPORTS		HONOLULU SOARING INC.	
				TIE-DOWN	
				405103	

DILLINGHAM AIRFIELD

N:\AIRPORTS\HDL_DILLINGHAM\CAD\PP\HDLH_405103-01.DWG