

JOSH GREEN, M.D.
GOVERNOR
KE KIA'ĀINA



STATE OF HAWAII | KA MOKU'ĀINA 'O HAWAII'
DEPARTMENT OF TRANSPORTATION | KA 'OIHANA ALAKAU
AIRPORTS
400 RODGERS BOULEVARD, SUITE 700
HONOLULU, HAWAII 96819-1880

EDWIN H. SNIFFEN
DIRECTOR
KA LUNA HO'OKELE

Deputy Directors
Nā Hope Luna Ho'okele
DREANALEE K. KALILI
TAMMY L. LEE
CURT T. OTAGURO
ROBIN K. SHISHIDO

IN REPLY REFER TO:

AIR-PM 25.0283

April 24, 2025

DOT Land Matters
State of Hawaii
Honolulu, Hawaii

ISSUANCE OF A REVOCABLE PERMIT FOR TERMINAL SPACE
MOLOKAI OUTDOOR ACTIVITIES LLC
MOLOKAI AIRPORT
TAX MAP KEY: (2) 5-2-004: PORTION OF 106

MAUI

APPLICANT:

Molokai Outdoor Activities LLC (MOA), whose business address is
1300 Kamehameha V Highway #1066, Kaunakakai, Hawaii 96748.

LEGAL REFERENCE:

Hawaii Revised Statutes (HRS), Sections 26-19 and 171-2, as amended.

LOCATION AND TAX MAP KEY:

Portion of Molokai Airport (MKK), Hoolehua, Island of Molokai, County of Maui,
identified by Tax Map Key: 2nd Division, 5-2-004: Portion of 106.

AREA:

Building/Room No. 301-137, each containing an area of approximately 98 square feet, as
shown and delineated on the attached Exhibit A.

ZONING:

State Land Use District: Agricultural
County of Maui: Interim Zoning Provisions of the Maui County Zoning Code

ISSUANCE OF A REVOCABLE PERMIT FOR TERMINAL SPACE
MOLOKAI OUTDOOR ACTIVITIES LLC

Page 2

LAND TITLE STATUS:

Section 5(a) lands of the Hawaii Admission Act: Ceded

DHHL 30% entitlement lands pursuant to Hawaii Admission Act YES___ NO X

CURRENT USE STATUS:

Land presently encumbered by Governor's Executive Order No. 1611, dated February 1, 1954, setting aside 10.321 acres, being a portion of MKK under the control and management of the Hawaii Aeronautics Commission [subsequently transferred to the State of Hawaii Department of Transportation (HDOT)] for Public purposes.

CHARACTER OF USE:

Customer service and information counter for visitor activities and rental operations.

COMMENCEMENT DATE:

To be determined by the Director of Transportation at a later date.

MONTHLY RENTAL:

\$182.28 (based on a rate of \$15.84 per square foot per annum, as determined from the HDOT Schedule of Rates and Charges established by appraisal of Airports property statewide, plus \$38.22 for utilities and \$14.70 for maintenance).

SECURITY DEPOSIT:

\$546.84, or three times the monthly rental in effect.

DCCA VERIFICATION:

Place of business registration confirmed:	YES <u>X</u>	NO ___
Registered business name confirmed:	YES <u>X</u>	NO ___
Good standing confirmed:	YES <u>X</u>	NO ___

CHAPTER 343, HRS - ENVIRONMENTAL ASSESSMENT:

The HDOT has determined that the subject areas are covered by the Molokai Airport Improvements Environmental Assessment (EA), published by the Environmental Quality Commission (EQC) in the December 23, 1981 issue of the EQC Bulletin. Accordingly,

ISSUANCE OF A REVOCABLE PERMIT FOR TERMINAL SPACE
MOLOKAI OUTDOOR ACTIVITIES LLC

Page 3

all relevant mitigation from the EA and best management practices will be implemented to address the minimum impacts of this action.

REMARKS:

The HDOT proposes to issue a month-to-month revocable permit to MOA for terminal space for a customer service and information counter for visitor activities and rental operations.

RECOMMENDATION:

Based on this submittal, and testimony and facts presented, the HDOT recommends the Director of Transportation finds that approving the issuance of a month-to-month revocable permit to MOA including its conditions and rent, will serve the best interests of the State.

Respectfully submitted,



CURT T. OTAGURO

Deputy Director of Transportation for Airports

Attachment

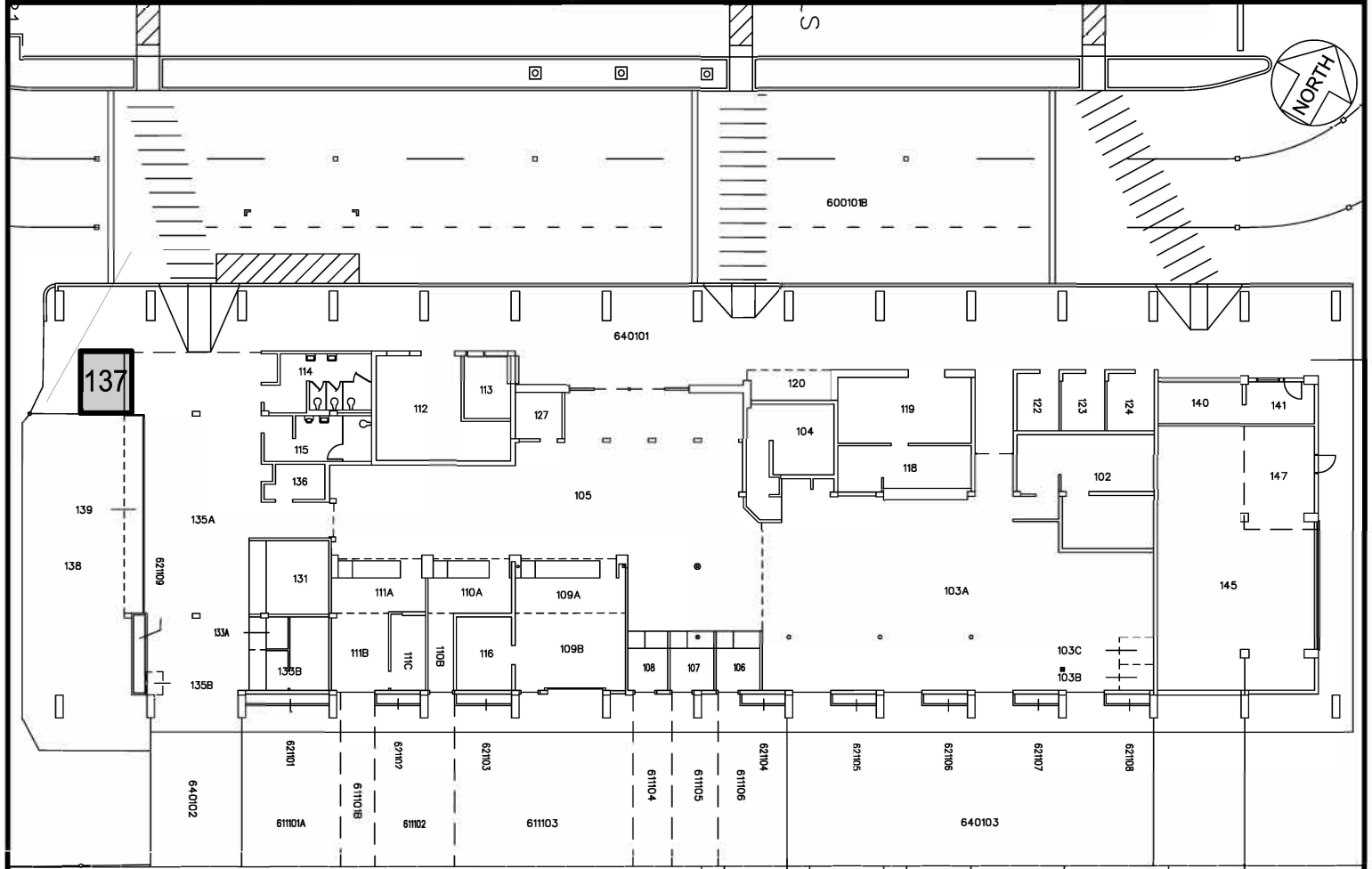
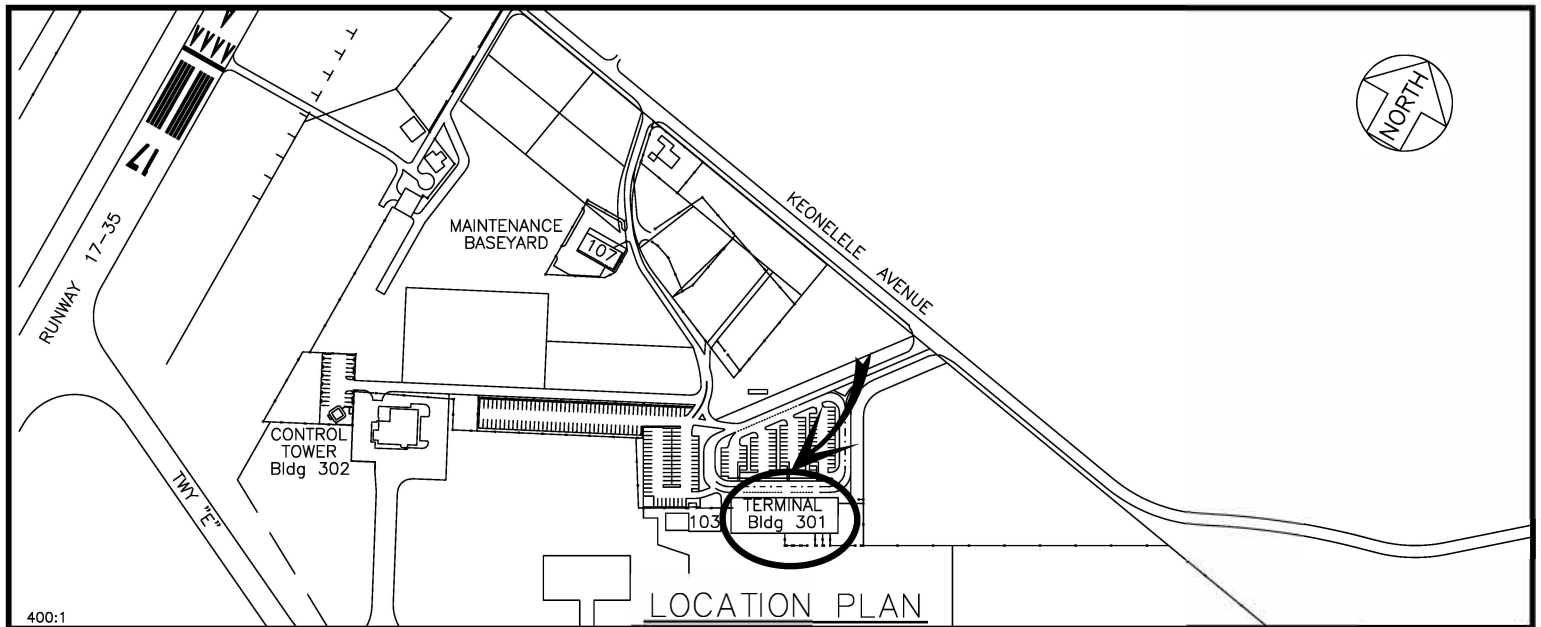

Terminal BLDG 301

SCALE: 1" = 30'

BLDG/ROOM	SQ. FT.
301 137	98

RP-9641

DATE : NOVEMBER 2024

EXHIBIT: A



AIRPORTS

MOLOKAI OUTDOOR
ACTIVITIES LLC

BUILDING 301
TERMINAL BLDG
GROUND LEVEL

301137

MOLOKAI AIRPORT

N:\AIRPORTS\MOLOKAI\CA\DWG\301137-01.DWG