

JOSH GREEN, M.D.
GOVERNOR
KE KIA'ĀINA



**STATE OF HAWAII | KA MOKU'ĀINA 'O HAWAI'I
DEPARTMENT OF TRANSPORTATION | KA 'OIHANA ALAKAU
AIRPORTS
400 RODGERS BOULEVARD, SUITE 700
HONOLULU, HAWAII 96819-1880**

EDWIN H. SNIFFEN
DIRECTOR
KA LUNA HO'OKELE

Deputy Directors
Nā Hope Luna Ho'okele
DREANALEE K. KALILI
TAMMY L. LEE
CURT T. OTAGURO
ROBIN K. SHISHIDO

IN REPLY REFER TO:

AIR-PM 25.0355

May 8, 2025

DOT Land Matters
State of Hawaii
Honolulu, Hawaii

ISSUANCE OF A REVOCABLE PERMIT FOR AIRCRAFT PARKING
PACIFIC PUMP & POWER, INC.
KAHULUI AIRPORT
TAX MAP KEY: (2) 3-8-001: PORTION OF 019

MAUI

REQUEST:

Issuance of a Revocable Permit for Aircraft Parking (Parking Permit)
to Pacific Pump & Power, Inc, situated at Kahului Airport.

APPLICANT:

Pacific Pump & Power, Inc. (PPP), whose mailing address is 91-503 Nukuawa Street,
Kapolei, Hawaii 96707.

LEGAL REFERENCE:

Hawaii Revised Statutes (HRS), Sections 26-19 and 171-2, as amended.

LOCATION AND TAX MAP KEY:

Portion of Kahului Airport (OGG), Kahului, Island of Maui, identified by
Tax Map Key: 2nd Division, 3-8-001: Portion of 019.

AREA:

404-105

Area/Space No. ~~407-101~~, containing an area of approximately 900 square feet, as shown
and delineated on the attached Exhibit A.

ZONING:

State Land Use District:
County of Maui:

Urban
Airport

ISSUANCE OF A REVOCABLE PERMIT FOR AIRCRAFT PARKING
PACIFIC PUMP & POWER, INC.
Page 2

LAND TITLE STATUS:

Section 5(a) lands of the Hawaii Admission Act: Non-Ceded
DHHL 30% entitlement lands pursuant to Hawaii Admission Act YES ___ NO X

CURRENT USE STATUS:

Land presently encumbered by Governor's Executive Order No. 2427, dated February 12, 1969, setting aside 1,268.938 acres designated as Kahului Airport to be under the control and management of the State of Hawaii Department of Transportation (HDOT) for Airport purposes.

CHARACTER OF USE:

Aircraft tie-down (Cirrus SR22T, N808HH).

COMMENCEMENT DATE:

To be determined by the Director of Transportation at a later date.

MONTHLY RENTAL:

\$130.00 (as determined from the HDOT Schedule of Rates and Charges established by appraisal of Airports property statewide).

SECURITY DEPOSIT:

\$390.00, or three times the monthly rental in effect.

DCCA VERIFICATION:

| | | |
|---|--------------|--------|
| Place of business registration confirmed: | YES <u>X</u> | NO ___ |
| Registered business name confirmed: | YES <u>X</u> | NO ___ |
| Good standing confirmed: | YES <u>X</u> | NO ___ |

CHAPTER 343, HRS - ENVIRONMENTAL ASSESSMENT:

The HDOT has determined that the subject area and use is covered by the Kahului Airport Terminal Complex Expansion Negative Declaration, published by the Environmental Quality Commission (EQC) in the September 8, 1981, issue of the EQC Bulletin. Accordingly, all relevant mitigation from the Negative Declaration and best management practices will be implemented to address the minimum impacts of this action.

ISSUANCE OF A REVOCABLE PERMIT FOR AIRCRAFT PARKING
PACIFIC PUMP & POWER, INC.

Page 3

REMARKS:

The HDOT proposes to issue a month-to-month Parking Permit to PPP for aircraft parking.

RECOMMENDATION:

Based on this submittal, and testimony and facts presented, the HDOT recommends the Director of Transportation finds that approving the issuance of a month-to-month Parking Permit to PPP, including its conditions and rent, will serve the best interests of the State.

Respectfully submitted,



CURT T. OTAGURO

Deputy Director of Transportation for Airports

Attachment

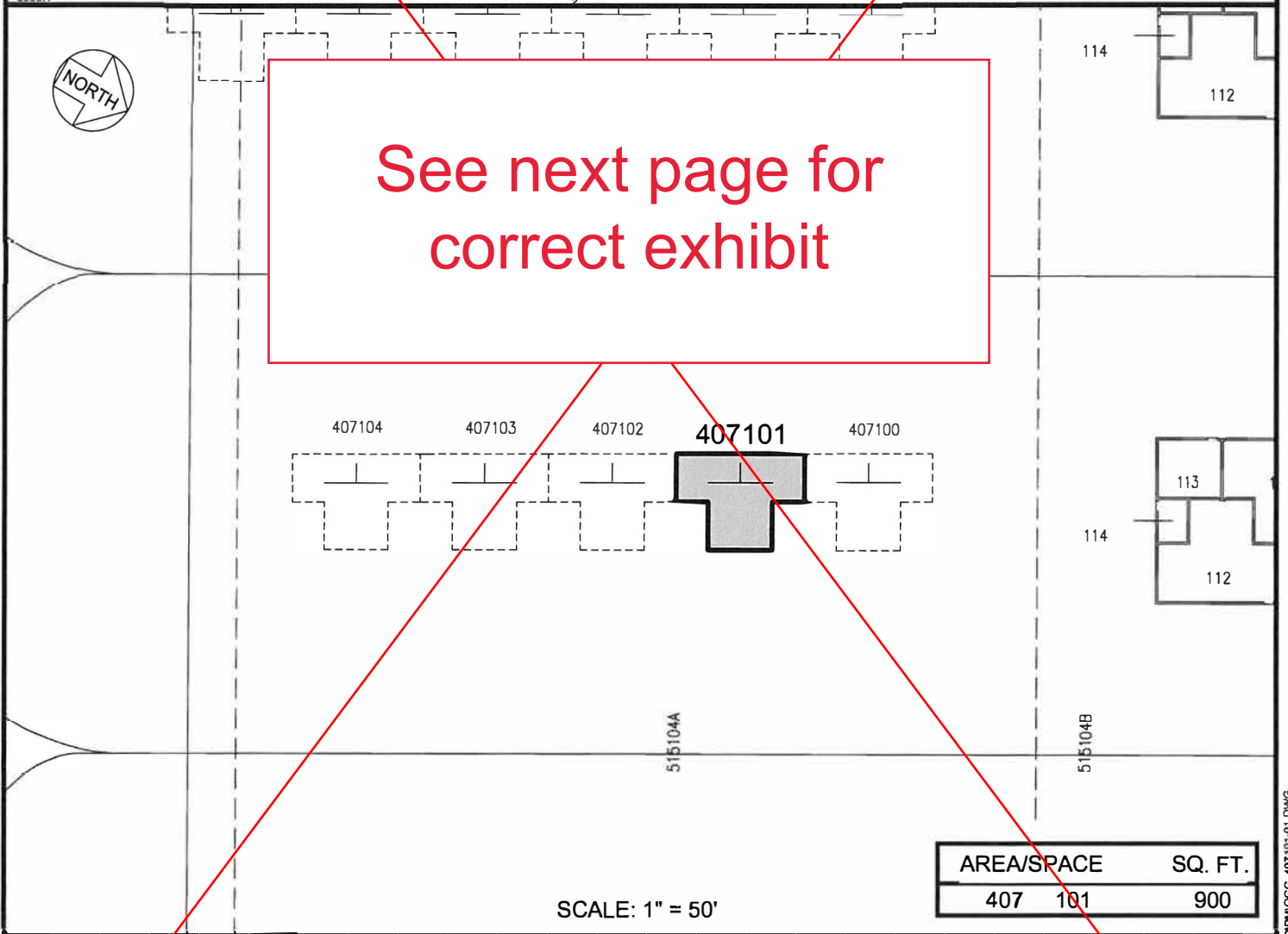
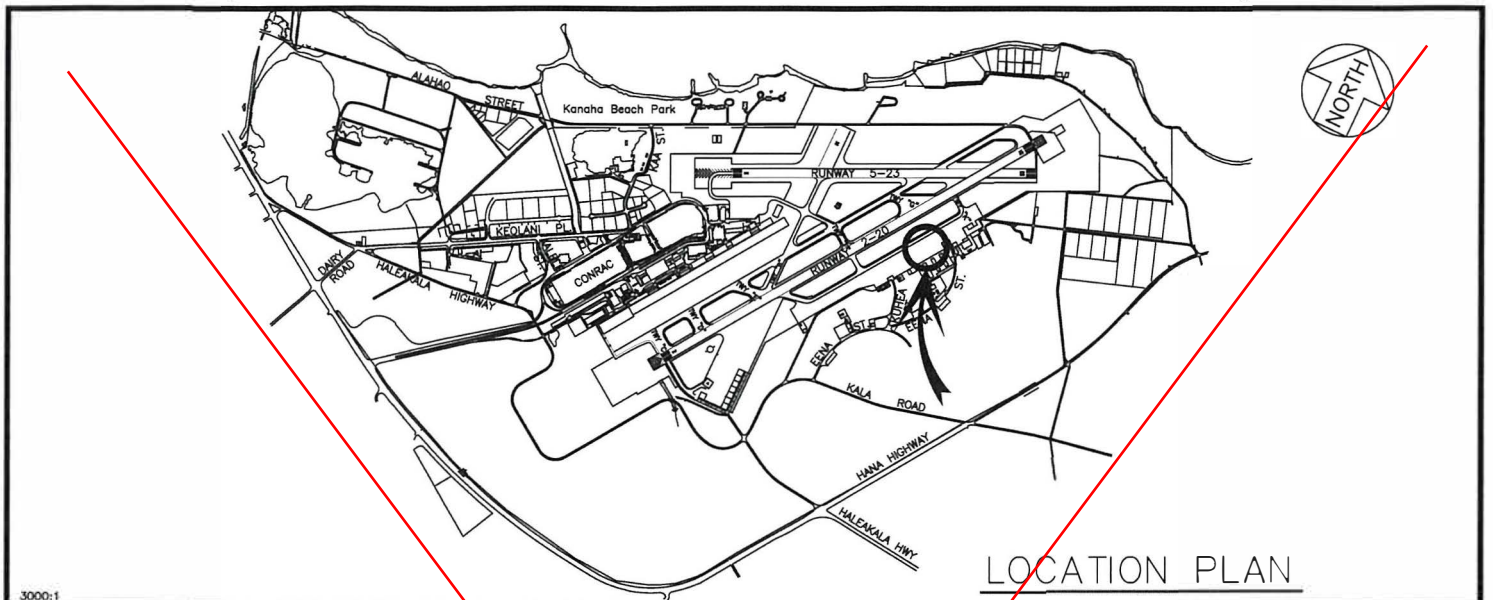

| | | |
|--|----------------------------|------------|
| PP-25-M006 | DATE : FEBRUARY 2025 | EXHIBIT: A |
|  AIRPORTS | PACIFIC PUMP & POWER, INC. | TIE-DOWN |
| | | 407101 |

KAHULUI AIRPORT

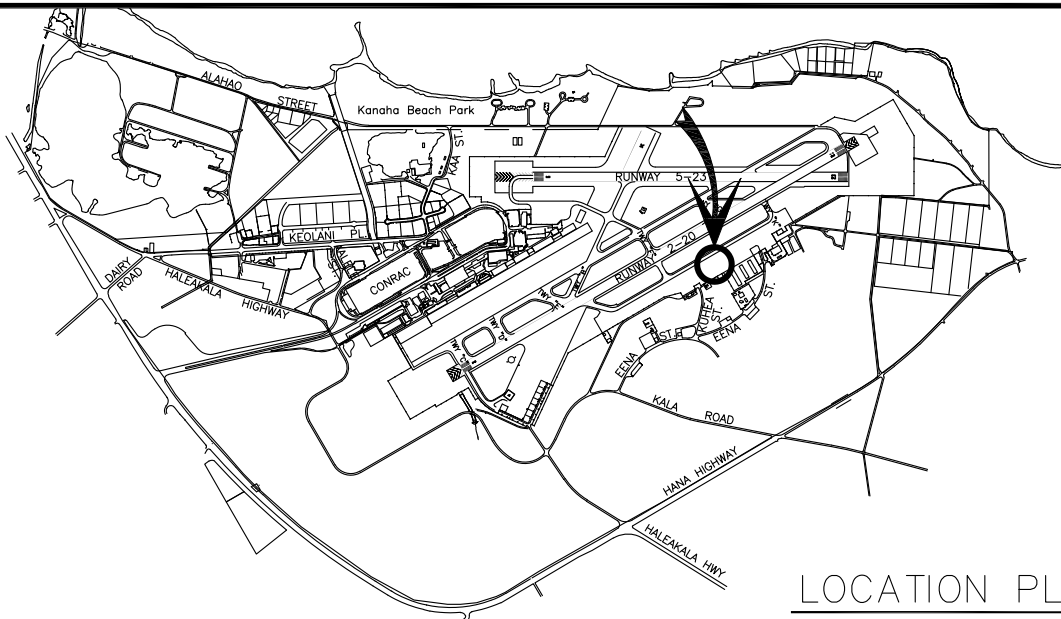

3000:1

LOCATION PLAN

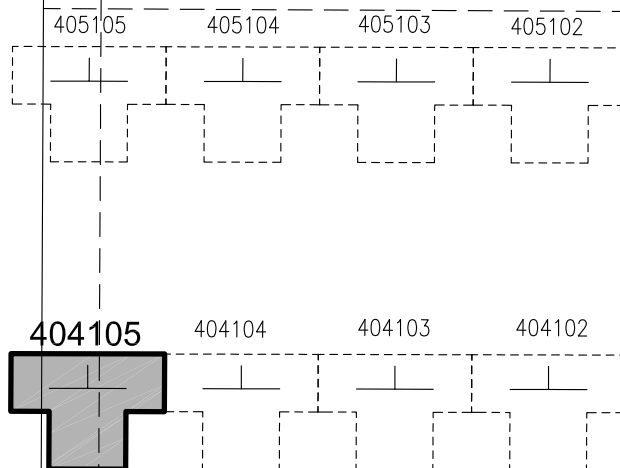

SCALE: 1" = 60'

| AREA/SPACE | | SQ. FT. |
|------------|-----|---------|
| 404 | 105 | 900 |

DATE : FEBRUARY 2025

EXHIBIT: **A**



AIRPORTS

TIE-DOWNS

404105

KAHULUI AIRPORT

N:\AIRPORTS\IOGG_KAHULUI\CAD\PM\IOGG_404105-01.DWG