

JOSH GREEN, M.D.
GOVERNOR
KE KIA'ĀINA



STATE OF HAWAII | KA MOKU'ĀINA 'O HAWAII'
DEPARTMENT OF TRANSPORTATION | KA 'OIHANA ALAKAU
AIRPORTS
400 RODGERS BOULEVARD, SUITE 700
HONOLULU, HAWAII 96819-1880

EDWIN H. SNIFFEN
DIRECTOR
KA LUNA HO'OKELE

Deputy Directors
Nā Hope Luna Ho'okele
DREANALEE K. KALILI
TAMMY L. LEE
CURT T. OTAGURO
ROBIN K. SHISHIDO

IN REPLY REFER TO:

AIR-PM 25.0409

May 22, 2025

DOT Land Matters
State of Hawaii
Honolulu, Hawaii

ISSUANCE OF A REVOCABLE PERMIT FOR STORAGE SPACE FOR
PRE-ARRANGED TRANSPORTATION SERVICE OPERATIONS
PRIMOVIP, INCORPORATED
KAHULUI AIRPORT
TAX MAP KEY: (2) 3-8-01: PORTION OF 220

MAUI

APPLICANT:

Primovip, Incorporated (Primo), whose mailing address is P.O. Box 330958,
Kahului, Hawaii 96733.

LEGAL REFERENCE:

Hawaii Revised Statutes (HRS), Sections 26-19 and 171-2, as amended.

LOCATION AND TAX MAP KEY:

Portion of Kahului Airport, Kahului, Island of Maui, identified by
Tax Map Key: 2nd Division, 3-8-01: Portion of 220.

AREA:

Building/Room No. 309-107, containing an area of approximately 54 square feet, as shown
and delineated on the attached Exhibit A.

ZONING:

State Land Use District:	Urban
County of Maui:	Airport

ISSUANCE OF A REVOCABLE PERMIT FOR STORAGE SPACE FOR PRE-ARRANGED
TRANSPORTATION SERVICE OPERATIONS
PRIMOVIP, INCORPORATED
Page 2

LAND TITLE STATUS:

Section 5(a) lands of the Hawaii Admission Act: Non-Ceded
DHHL 30% entitlement lands pursuant to Hawaii Admission Act YES___ NO X

CURRENT USE STATUS:

Land presently encumbered by Governor's Executive Order No. 2427, dated February 12, 1969, setting aside 1,268.938 acres designated as Kahului Airport to be under the control and management of the State of Hawaii Department of Transportation (HDOT) for public purposes.

CHARACTER OF USE:

Primo will use the space for storage to support its pre-arranged transportation service operations.

COMMENCEMENT DATE:

To be determined by the Director of Transportation at a later date.

MONTHLY RENTAL:

\$147.96 (\$118.80, based on a rate of \$26.40 per square foot per annum, as determined from the HDOT Schedule of Rates and Charges established by appraisal of Airports property statewide, plus \$21.06 for utilities and \$8.10 for maintenance).

SECURITY DEPOSIT:

\$443.88, or three times the monthly rental in effect.

DCCA VERIFICATION:

Place of business registration confirmed:	YES <u>X</u>	NO ____
Registered business name confirmed:	YES <u>X</u>	NO ____
Good standing confirmed:	YES <u>X</u>	NO ____

CHAPTER 343, HRS – ENVIRONMENTAL ASSESSMENT:

The HDOT has determined that the impacts of this action are de minimis and exempt, pursuant to Department of Transportation, Comprehensive Exemption List, Type 8, Part 1, 8(h), concurred to by the Environmental Advisory Council on February 1, 2022.

ISSUANCE OF A REVOCABLE PERMIT FOR STORAGE SPACE FOR PRE-ARRANGED
TRANSPORTATION SERVICE OPERATIONS
PRIMOVIP, INCORPORATED
Page 3

REMARKS:

The HDOT proposes to issue a month-to-month revocable permit to Primo for storage space to support its pre-arranged transportation service operations.

RECOMMENDATION:

Based on this submittal, and testimony and facts presented, the HDOT recommends the Director of Transportation finds that approving the issuance of a month-to-month revocable permit to Primo including its conditions and rent, will serve the best interests of the State.

Respectfully submitted,



CURT T. OTAGURO
Deputy Director of Transportation for Airports

Attachment

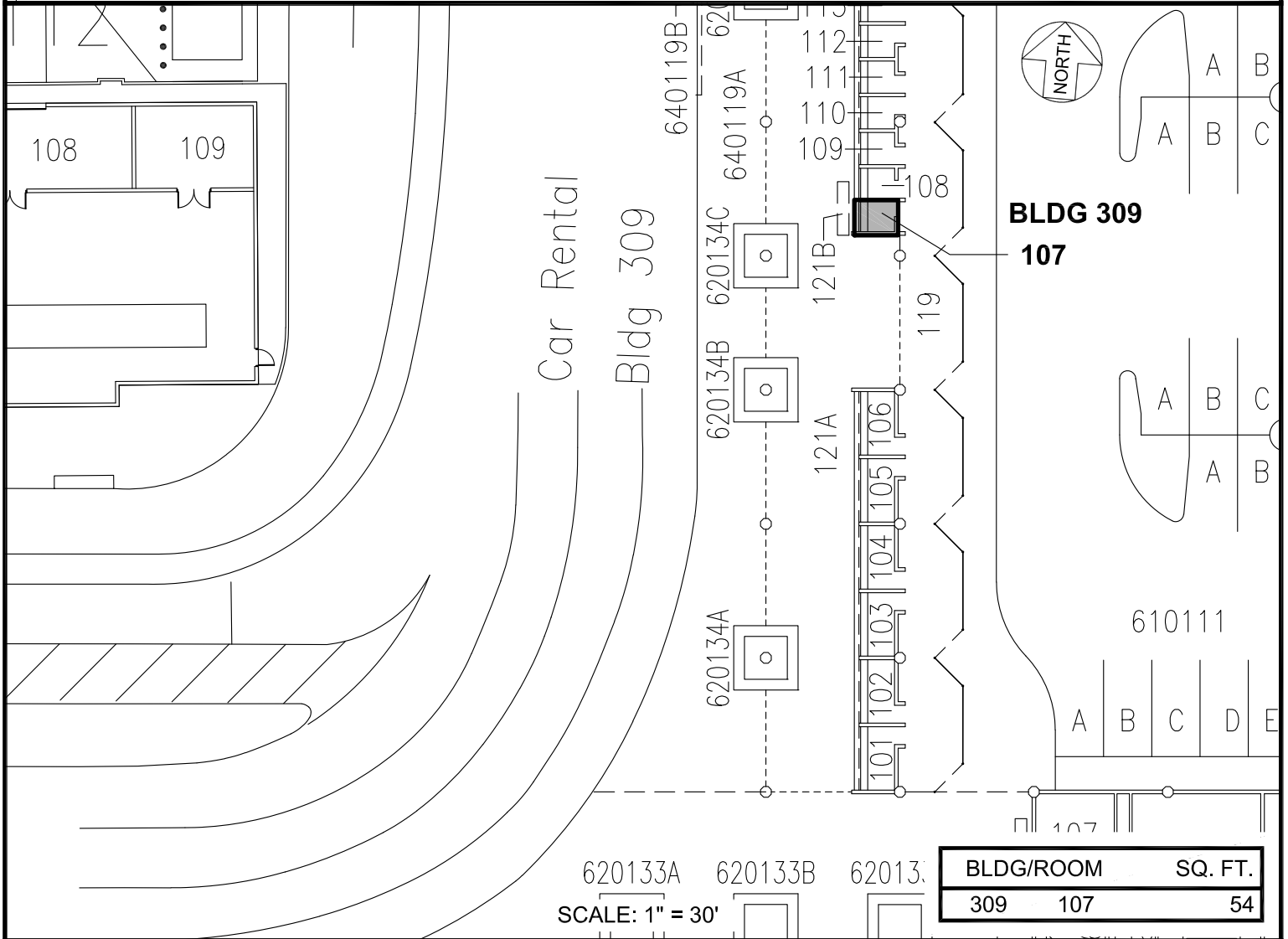
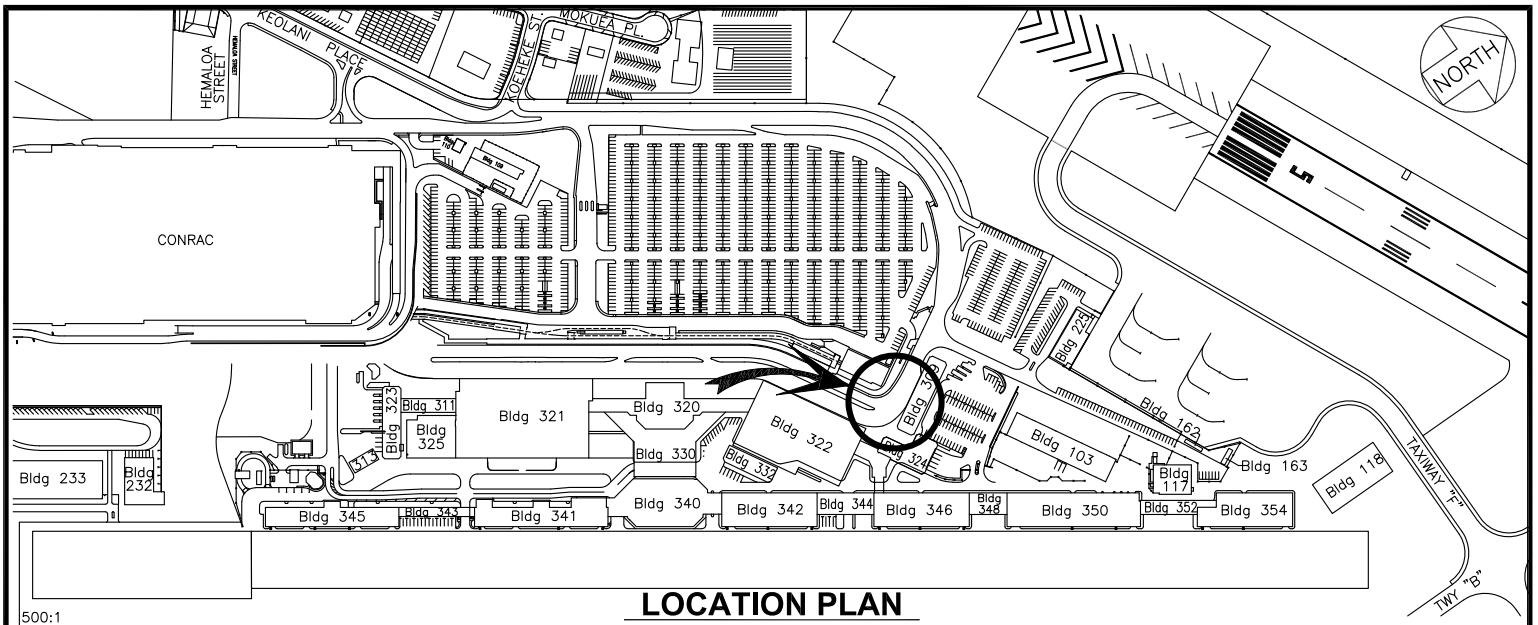

RP-9679

DATE : APRIL 2025

EXHIBIT: **A**



AIRPORTS

PRIMOVIP,
INCORPORATED

BUILDING 309
CAR RENTAL
GROUND LEVEL

309107

KAHULUI AIRPORT

N:\AIRPORTS\IOGG_KAHULUI\CAD\PMO\G_309107-01.DWG