

JOSH GREEN, M.D.  
GOVERNOR  
KE KIA'ĀINA



**STATE OF HAWAII | KA MOKU'ĀINA 'O HAWAI'**  
**DEPARTMENT OF TRANSPORTATION | KA 'OIHANA ALAKAU**  
**AIRPORTS**  
400 RODGERS BOULEVARD, SUITE 700  
HONOLULU, HAWAII 96819-1880

EDWIN H. SNIFFEN  
DIRECTOR  
KA LUNA HO'OKELE

Deputy Directors  
Nā Hope Luna Ho'okele  
DREANALEE K. KALILI  
TAMMY L. LEE  
CURT T. OTAGURO  
ROBIN K. SHISHIDO

IN REPLY REFER TO:

**AIR-PM 25.0322**

May 8, 2025

DOT Land Matters  
State of Hawaii  
Honolulu, Hawaii

ISSUANCE OF A REVOCABLE PERMIT FOR COMMERCIAL USE OF A  
T-HANGAR FOR STORAGE OF AIRCRAFT AND A MAINTENANCE HANGAR  
MAUNA LOA HELICOPTER TOURS LLC  
LIHUE AIRPORT  
TAX MAP KEY: (4) 3-5-001: PORTION OF 008

**KAUAI**

**APPLICANT:**

Mauna Loa Helicopter Tours LLC (Mauna Loa), whose mailing address is  
73-310 Uu Street, Kailua-Kona, Hawaii 96740.

**LEGAL REFERENCE:**

Hawaii Revised Statutes (HRS), Sections 26-19 and 171-2, as amended.

**LOCATION AND TAX MAP KEY:**

Portion of Lihue Airport (LIH), Lihue, Island of Kauai, identified by  
Tax Map Key: 4th Division, 3-5-001: portion of 008.

**AREA:**

Building/Room No. 410-102, containing an area of approximately 1,610 square feet, as  
shown and delineated on the attached Exhibit A.

**ZONING:**

|                          |   |
|--------------------------|---|
| State Land Use District: | Urban   |
| County of Kauai          | Industrial General/Special Treatment-Public Use (IG/ST-P) |

ISSUANCE OF A REVOCABLE PERMIT FOR COMMERCIAL USE OF A  
T-HANGAR FOR STORAGE OF AIRCRAFT AND A MAINTENANCE HANGAR  
MAUNA LOA HELICOPTER TOURS LLC

Page 2

LAND TITLE STATUS:

Section 5(a) lands of the Hawaii Admission Act: Non-Ceded  
DHHL 30% entitlement lands pursuant to Hawaii Admission Act YES      NO X

CURRENT USE STATUS:

Land presently encumbered by Governor's Executive Order No. 4614, dated October 28, 2019, setting aside 883.583 acres designated as LIH to be under the control and management of the State of Hawaii Department of Transportation (HDOT) for Airport purposes.

CHARACTER OF USE:

Storage of aircraft (Robinson R44 II, Tail No. N-322AL) and a maintenance hangar to support helicopter tour operations.

COMMENCEMENT DATE:

To be determined by the Director of Transportation at a later date.

MONTHLY RENTAL:

\$1,787.10 (based on a rate of \$3.94 per square foot per annum, as determined from the HDOT Schedule of Rates and Charges established by appraisal of Airports property statewide, plus \$48.30 for utilities).

SECURITY DEPOSIT:

\$5,361.30, or three times the monthly rental in effect.

DCCA VERIFICATION:

|   |              |                |
|---|--------------|----------------|
| Place of business registration confirmed: | YES <u>X</u> | NO <u>    </u> |
| Registered business name confirmed:       | YES <u>X</u> | NO <u>    </u> |
| Good standing confirmed:                  | YES <u>X</u> | NO <u>    </u> |

CHAPTER 343, HRS - ENVIRONMENTAL ASSESSMENT:

The HDOT has determined that the environmental impacts for the subject land use is covered by the Lihue Airport Ahukini Road Realignment and General Aviation Subdivision Final Environmental Assessment (FEA), published by the Office of

ISSUANCE OF A REVOCABLE PERMIT FOR COMMERCIAL USE OF A  
T-HANGAR FOR STORAGE OF AIRCRAFT AND A MAINTENANCE HANGAR  
MAUNA LOA HELICOPTER TOURS LLC

Page 3

Environmental Quality Control (OEQC) in the April 23, 1997, issue of The Environmental Notice. Accordingly, all relevant mitigation from the FEA and best management practices will be implemented to address the minimum impacts of this action.

REMARKS:

The HDOT proposes to issue a month-to-month revocable permit to Mauna Loa for storage of aircraft and a maintenance hangar to support helicopter tour operations.

RECOMMENDATION:

Based on this submittal, and testimony and facts presented, the HDOT recommends the Director of Transportation finds that approving the issuance of a month-to-month revocable permit to Mauna Loa including its conditions and rent, will serve the best interests of the State.

Respectfully submitted,



CURT T. OTAGURO

Deputy Director of Transportation for Airports

Attachment

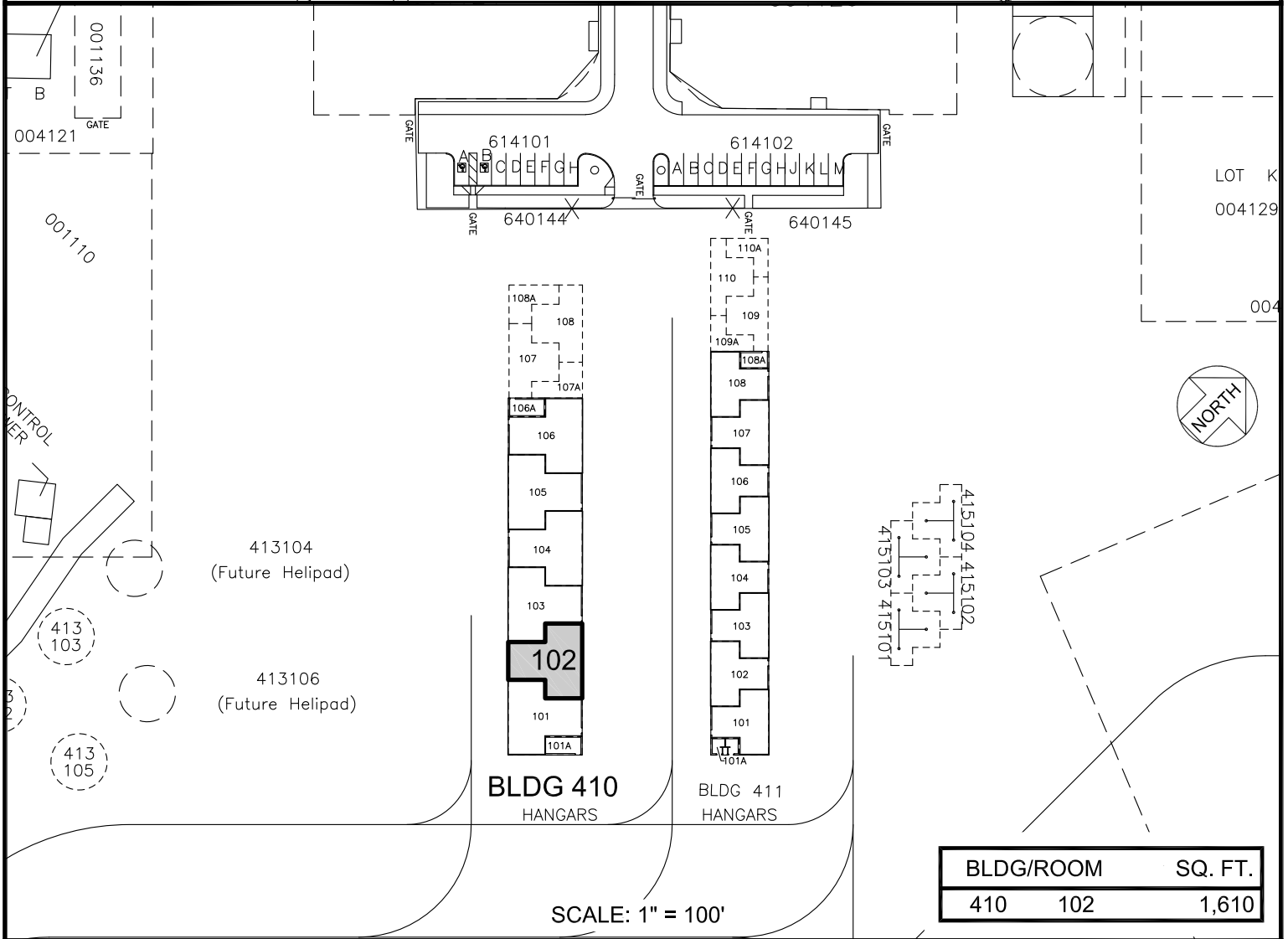
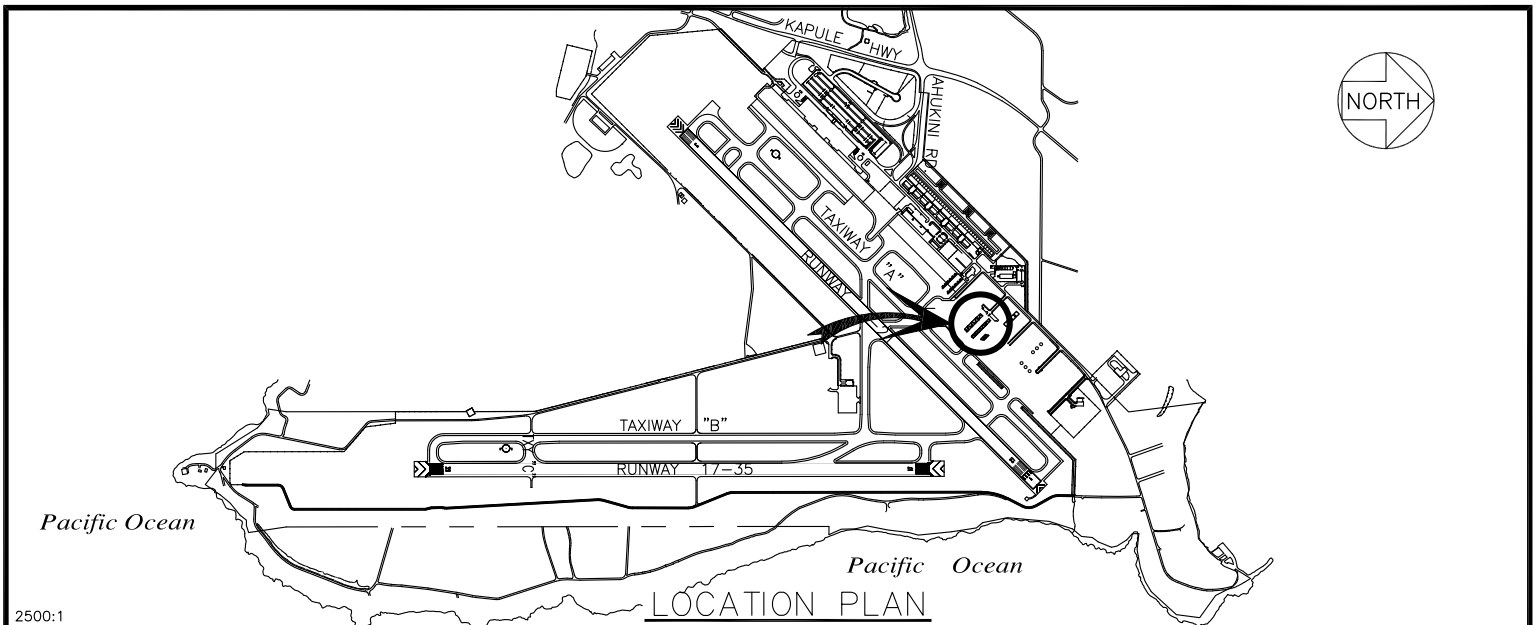

RP-9675

DATE : APRIL 2025

EXHIBIT: **A**



AIRPORTS

MAUNA LOA HELICOPTER  
TOURS LLC

T-HANGAR

410102

LIHUE AIRPORT

N:\AIRPORTS\LIHUE\CAD\PM\LIH\_410102-01.DWG