

JOSH GREEN, M.D.  
GOVERNOR  
KE KIA'ĀINA



**STATE OF HAWAII | KA MOKU'ĀINA 'O HAWAII**  
**DEPARTMENT OF TRANSPORTATION | KA 'OIHANA ALAKAU**  
**AIRPORTS**  
400 RODGERS BOULEVARD, SUITE 700  
HONOLULU, HAWAII 96819-1880

EDWIN H. SNIFFEN  
DIRECTOR  
KA LUNA HO'OKELE

Deputy Directors  
Nā Hope Luna Ho'okele  
DREANALEE K. KALILI  
TAMMY L. LEE  
CURT T. OTAGURO  
ROBIN K. SHISHIDO

IN REPLY REFER TO:

**AIR-PM 25.0370**

May 22, 2025

DOT Land Matters  
State of Hawaii  
Honolulu, Hawaii

ISSUANCE OF A REVOCABLE PERMIT FOR AIRCRAFT PARKING  
TERRY G. SMITH AND NATHAN FORSTER  
ELLISON ONIZUKA KONA INTERNATIONAL AIRPORT AT KEAHOLE  
TAX MAP KEY: (3) 7-3-043: PORTION OF 003

HAWAII

REQUEST:

Issuance of a Revocable Permit for Aircraft Parking (Parking Permit) to  
Terry G. Smith and Nathan Forster, for an aircraft tie-down space.

APPLICANT:

Terry G. Smith and Nathan Forster, whose mailing address is 64-736 Waikelehua Place,  
Kamuela, Hawaii 96743.

LEGAL REFERENCE:

Hawaii Revised Statutes (HRS), Sections 26-19 and 171-2, as amended.

LOCATION AND TAX MAP KEY:

Portion of Ellison Onizuka Kona International Airport at Keahole (KOA), Kailua-Kona,  
Island of Hawaii, identified by Tax Map Key: 3<sup>rd</sup> Division, 7-3-043: Portion of 003.

AREA:

Area/Space No. 424-103, containing an area of approximately 1,394 square feet,  
as shown and delineated on the attached map labeled Exhibit A.

ISSUANCE OF A REVOCABLE PERMIT FOR AIRCRAFT PARKING  
TERRY G. SMITH AND NATHAN FORSTER  
Page 2

ZONING:

State Land Use District:	Urban & Conservation
County of Hawaii:	Industrial (MG-1a) and Open

LAND TITLE STATUS:

Section 5(a) lands of the Hawaii Admission Act: Ceded  
DHHL 30% entitlement lands pursuant to Hawaii Admission Act YES\_\_\_ NO X

CURRENT USE STATUS:

Land presently encumbered by Governors Executive Order No. 3074, dated August 20, 1981, setting aside 4,204.10 acres designated as KOA under the control and management of the State of Hawaii Department of Transportation (HDOT) for Airport purposes.

CHARACTER OF USE:

Aircraft tie-down (1972 Piper PA-28R-200, Tail No. N-4802T).

COMMENCEMENT DATE:

To be determined by the Director of Transportation at a later date.

MONTHLY RENTAL:

\$130.00 (as determined from the HDOT Schedule of Rates and Charges established by appraisal of Airports property statewide).

SECURITY DEPOSIT:

\$390.00, or three times the monthly rental in effect.

CHAPTER 343, HRS - ENVIRONMENTAL ASSESSMENT:

The HDOT has determined the subject land areas are covered by the Final Environmental Assessment (EA)/Finding of No Significant Impact, Airfield, Terminal, and Facility Improvements for the KOA, published by the Office of Environmental Quality Control in the March 23, 2013, issue of The Environmental Notice. Accordingly, all relevant mitigation from the EA and best management practices will be implemented to address the minimum impacts of this action.

ISSUANCE OF A REVOCABLE PERMIT FOR AIRCRAFT PARKING  
TERRY G. SMITH AND NATHAN FORSTER  
Page 3

REMARKS:

HDOT proposes to issue a month-to-month Parking Permit to Terry G. Smith and Nathan Forster, for an aircraft tie-down space.

RECOMMENDATION:

Based on this submittal, and testimony and facts presented, the HDOT recommends the Director of Transportation finds that approving the issuance of a month-to-month Parking Permit to Terry G. Smith and Nathan Forster, including its conditions and rent, will serve the best interests of the State.

Respectfully submitted,

A handwritten signature in black ink, appearing to read "C. Otaguro", with a stylized flourish at the end.

CURT T. OTAGURO  
Deputy Director of Transportation for Airports

Attachment

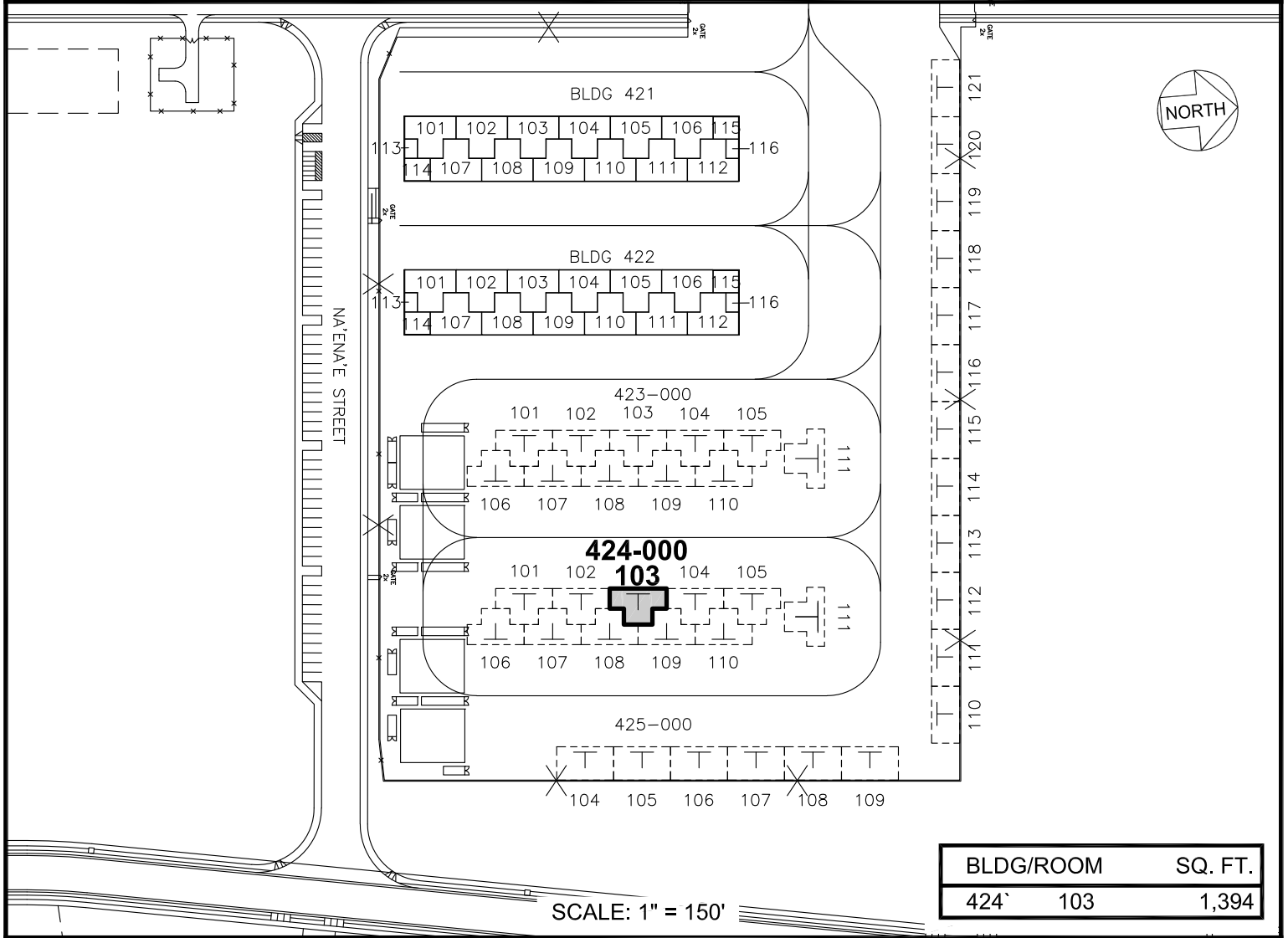
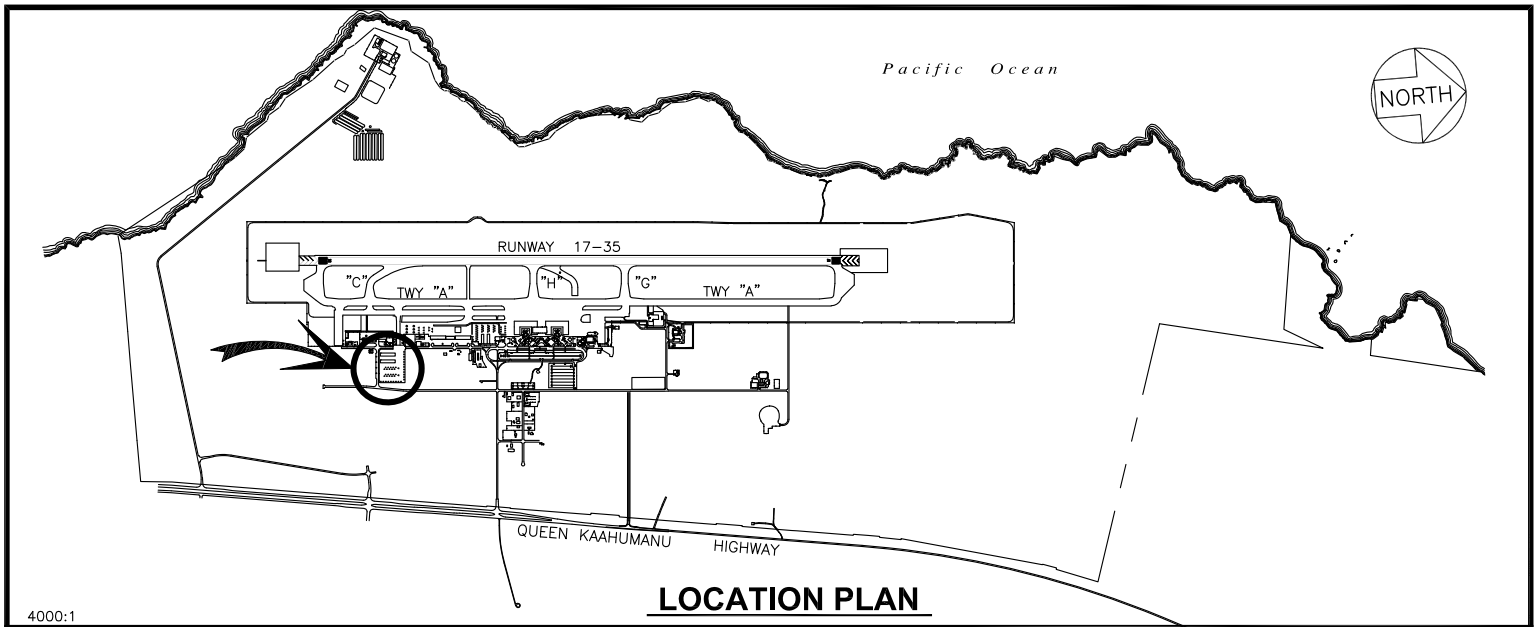

PP-24-N002

DATE : MARCH 2024

EXHIBIT: **A**



AIRPORTS

Terry G. Smith and  
Nathan Forster

T-HANGAR

424103

ELLISON ONIZUKA KONA INTERNATIONAL AIRPORT AT KEAHOLE

N:\AIRPORTS\KOA\_KONACAD\PIK\KOA\_424103-01.DWG