

JOSH GREEN, M.D.  
GOVERNOR  
KE KIA'ĀINA



**STATE OF HAWAI'I | KA MOKU'ĀINA 'O HAWAI'I  
DEPARTMENT OF TRANSPORTATION | KA 'OIHANA ALAKAU  
AIRPORTS  
400 RODGERS BOULEVARD, SUITE 700  
HONOLULU, HAWAII 96819-1880**

EDWIN H. SNIFFEN  
DIRECTOR  
KA LUNA HO'OKELE

Deputy Directors  
Nā Hope Luna Ho'okele  
DREANALEE K. KALILI  
TAMMY L. LEE  
CURT T. OTAGURO  
ROBIN K. SHISHIDO

IN REPLY REFER TO:

**AIR-PM 25.0501**

June 26, 2025

DOT Land Matters  
State of Hawaii  
Honolulu, Hawaii

ISSUANCE OF A REVOCABLE PERMIT FOR CARGO BUILDING STORAGE  
STATE OF HAWAII, DEPARTMENT OF AGRICULTURE  
HILO INTERNATIONAL AIRPORT  
TAX MAP KEY: (3) 2-1-012: PORTION OF 009

**HAWAII**

**APPLICANT:**

State of Hawaii, Department of Agriculture (DAG), whose mailing address is  
95 Akahana Street, Suite 104, Hilo, Hawaii 96720.

**LEGAL REFERENCE:**

Hawaii Revised Statutes (HRS), Sections 26-19 and 171-2, as amended.

**LOCATION AND TAX MAP KEY:**

Portion of Hilo International Airport (ITO), Hilo, Island of Hawaii,  
identified by Tax Map Key: 3rd Division, 2-1-012: Portion of 009.

**AREA:**

Building/Room No. 139-110B, containing an area of approximately 877 square feet,  
as shown and delineated on the attached map labeled Exhibit A.

**ZONING:**

State Land Use District:	Urban
County of Hawaii:	Industrial (ML-20)

ISSUANCE OF A REVOCABLE PERMIT FOR CARGO BUILDING STORAGE  
STATE OF HAWAII, DEPARTMENT OF AGRICULTURE  
Page 2

LAND TITLE STATUS:

Section 5(a) lands of the Hawaii Admission Act: Ceded  
DHHL 30% entitlement lands pursuant to Hawaii Admission Act YES\_\_\_ NO X

CURRENT USE STATUS:

Land presently encumbered by Governor's Executive Order No. 1519, dated July 17, 1952, setting aside 550.881 acres being a portion of General Lyman Field under the control and management of the Hawaii Aeronautics Commission [subsequently transferred to the State of Hawaii Department of Transportation (HDOT)] as a site for the Hilo Airport, now known as ITO.

CHARACTER OF USE:

DAG will use the Cargo Building loft space for storage of animal traps, rapid response equipment, office supplies and chest freezers for distribution.

COMMENCEMENT DATE:

To be determined by the Director of Transportation at a later date.

MONTHLY RENTAL:

\$824.38 (\$350.80, based on the rate of \$4.80 per square foot per annum for Cargo Building loft space as determined from the HDOT Schedule of Rates and Charges established by appraisal of Airports properties statewide plus \$342.03 for utilities and \$131.55 for maintenance).

SECURITY DEPOSIT:

\$2,473.14, or three times the monthly rental in effect.

DCCA VERIFICATION:

Place of business registration confirmed: N/A  
Registered business name confirmed: N/A  
Good standing confirmed: N/A

ISSUANCE OF A REVOCABLE PERMIT FOR CARGO BUILDING STORAGE  
STATE OF HAWAII, DEPARTMENT OF AGRICULTURE  
Page 3

CHAPTER 343, HRS - ENVIRONMENTAL ASSESSMENT:

The HDOT has determined that the subject areas are covered by the Hilo International Airport Final Environmental Assessment (FEA), dated April 15, 2003, and published by the Office of Environmental Quality Control in the May 8, 2003 issue of The Environmental Notice. Accordingly, all relevant mitigation from the FEA and best management practices will be implemented to address the minimum impacts of this action.

REMARKS:

HDOT proposes to issue a month-to-month revocable permit to DAG for Cargo Building loft space for storage of animal traps, rapid response equipment, office supplies and chest freezers for distribution.

RECOMMENDATION:

Based on this submittal, and testimony and facts presented, the HDOT recommends the Director of Transportation finds that approving the issuance of a month-to-month revocable permit to DAG, including its conditions and rent, will serve the best interests of the State.

Respectfully submitted,



CURT T. OTAGURO  
Deputy Director of Transportation for Airports

Attachment

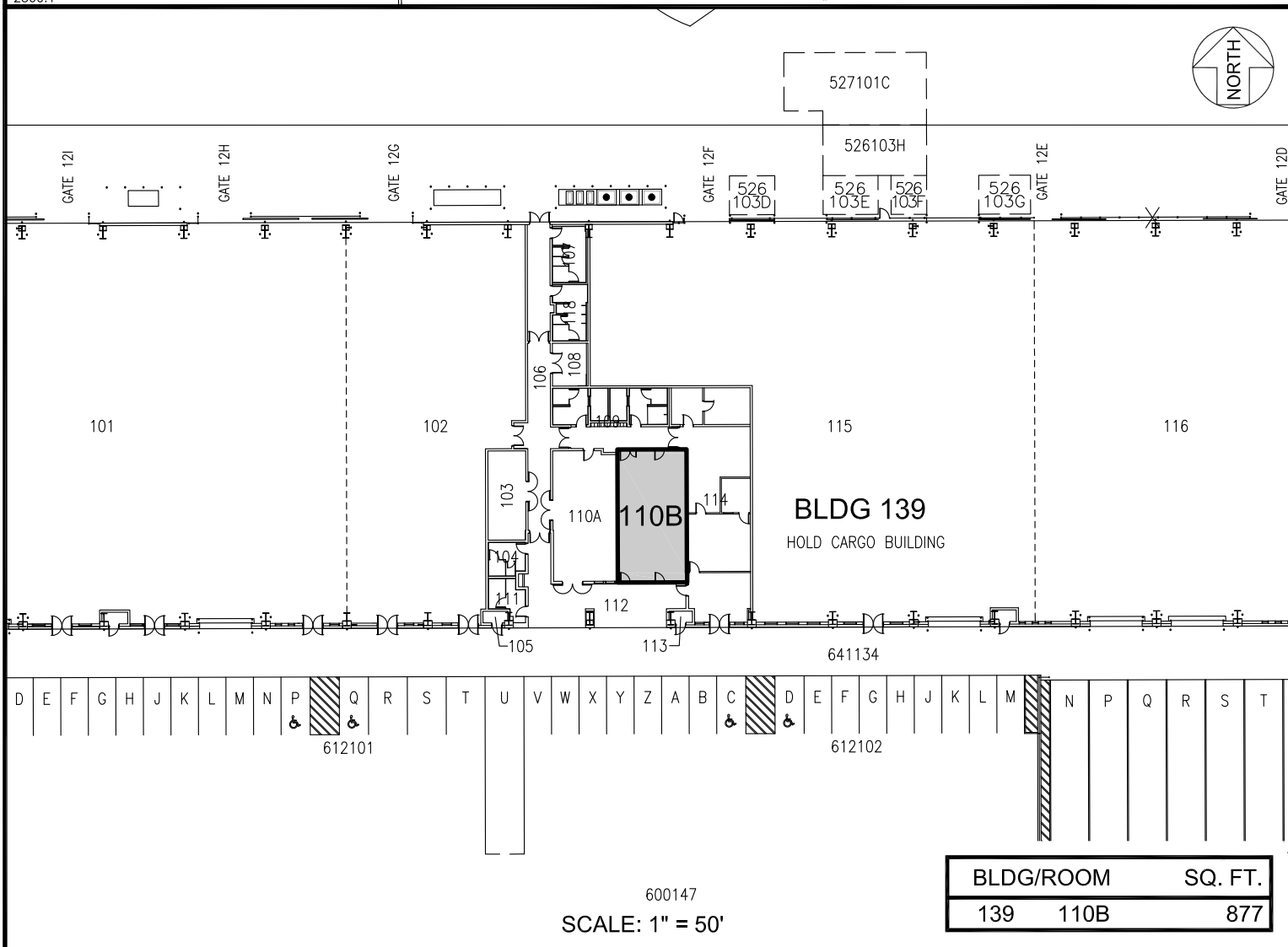
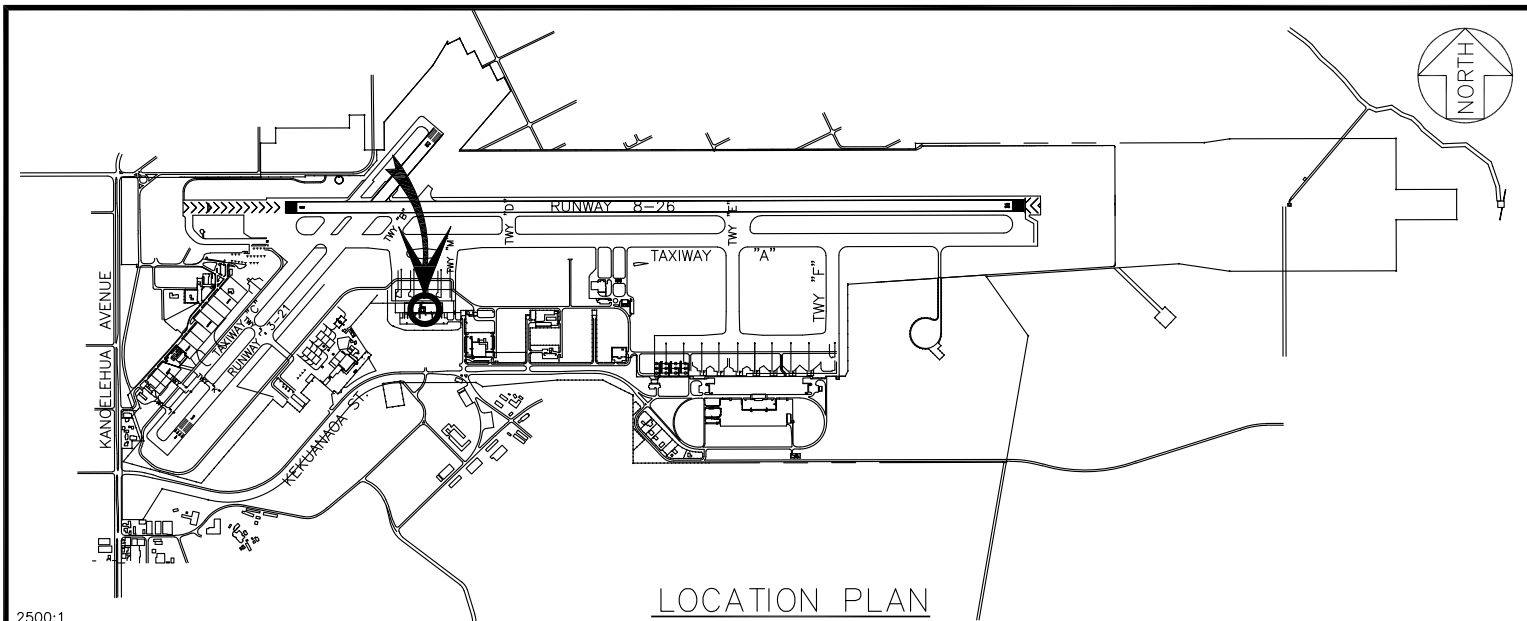

RP-9689

DATE : DECEMBER 2024

EXHIBIT: **A**



AIRPORTS

STATE OF HAWAII  
DEPARTMENT OF  
AGRICULTURE; PLANT  
QUARANTINE

BUILDING 139  
HOLD CARGO BUILDING  
GROUND LEVEL

139110B

HILO INTERNATIONAL AIRPORT