

JOSH GREEN, M.D.
GOVERNOR
KE KIA'ĀINA



**STATE OF HAWAII | KA MOKU'ĀINA 'O HAWAII'
DEPARTMENT OF TRANSPORTATION | KA 'OIHANA ALAKAU
AIRPORTS
400 RODGERS BOULEVARD, SUITE 700
HONOLULU, HAWAII 96819-1880**

EDWIN H. SNIFFEN
DIRECTOR
KA LUNA HO'OKELE

Deputy Directors
Nā Hope Luna Ho'okele
DREANALEE K. KALILI
TAMMY L. LEE
CURT T. OTAGURO
ROBIN K. SHISHIDO

IN REPLY REFER TO:

AIR-PM 25.0525

July 10, 2025

DOT Land Matters
State of Hawaii
Honolulu, Hawaii

ISSUANCE OF A REVOCABLE PERMIT FOR TERMINAL SPACE FOR
BREAKROOM, STORAGE AND OFFICE
DELTA AIR LINES, INC.
KAHULUI AIRPORT
TAX MAP KEY: (2) 3-8-001: PORTION OF 246

MAUI

APPLICANT:

Delta Air Lines, Inc. (Delta), whose mailing address is 1 Kahului Airport Road #2,
Kahului, Hawaii 96732.

LEGAL REFERENCE:

Hawaii Revised Statutes (HRS), Sections 26-19 and 171-2, as amended.

LOCATION AND TAX MAP KEY:

Portion of Kahului Airport, Kahului, Island of Maui, identified by
Tax Map Key: 2nd Division, 3-8-001: Portion of 246.

AREA:

Building/Room No. 354-122, containing an area of approximately 656 square feet, and
Building/Room No. 354-127, containing an area of approximately 1,423 square feet, as
shown and delineated on the attached Exhibit A.

ZONING:

State Land Use District:	Urban
County of Maui:	Airport

ISSUANCE OF A REVOCABLE PERMIT FOR TERMINAL SPACE FOR BREAKROOM,
STORAGE AND OFFICE, DELTA AIR LINES, INC.

Page 2

LAND TITLE STATUS:

Section 5(a) lands of the Hawaii Admission Act: Non-Ceded

DHHL 30% entitlement lands pursuant to Hawaii Admission Act YES___ NO X

CURRENT USE STATUS:

Land presently encumbered by Governor's Executive Order No. 2427, dated February 12, 1969, setting aside 1,268.938 acres designated as Kahului Airport to be under the control and management of the State of Hawaii Department of Transportation (HDOT) for Airport purposes.

CHARACTER OF USE:

Delta will use Space No. 354-122 as a cabin cleaning crew breakroom and storage, and Space No. 354-127 for a line maintenance office and storage for its signatory airline carrier operation.

COMMENCEMENT DATE:

To be determined by the Director of Transportation at a later date.

MONTHLY RENTAL:

\$18,641.70 (\$107.60 per square foot per annum, as determined from the Airports Signatory Carriers Rates and Charges, Hawaii Airports System, effective July 1, 2024).

SECURITY DEPOSIT:

\$55,925.10, or three times the monthly rental in effect.

DCCA VERIFICATION:

Place of business registration confirmed:	YES <u>X</u>	NO ___
Registered business name confirmed:	YES <u>X</u>	NO ___
Good standing confirmed:	YES <u>X</u>	NO ___

CHAPTER 343, HRS - ENVIRONMENTAL ASSESSMENT:

The HDOT has determined that the subject land area and use is covered by the Kahului Airport Terminal Complex Expansion Negative Declaration, published by the Environmental Quality Commission (EQC) in the September 8, 1981, issue of the EQC

ISSUANCE OF A REVOCABLE PERMIT FOR TERMINAL SPACE FOR BREAKROOM,
STORAGE AND OFFICE, DELTA AIR LINES, INC.

Page 3

Bulletin. Accordingly, all relevant mitigation from the Negative Declaration and best management practices will be implemented to address the minimum impacts of this action.

REMARKS:

The HDOT proposes to issue a month-to-month revocable permit to Delta for terminal space for a cabin cleaning crew breakroom and storage, and a line maintenance office and storage for its signatory airline carrier operation.

RECOMMENDATION:

Based on this submittal, and testimony and facts presented, the HDOT recommends the Director of Transportation finds that approving the issuance of a month-to-month revocable permit to Delta including its conditions and rent, will serve the best interests of the State.

Respectfully submitted,



CURT T. OTAGURO

Deputy Director of Transportation for Airports

Attachment

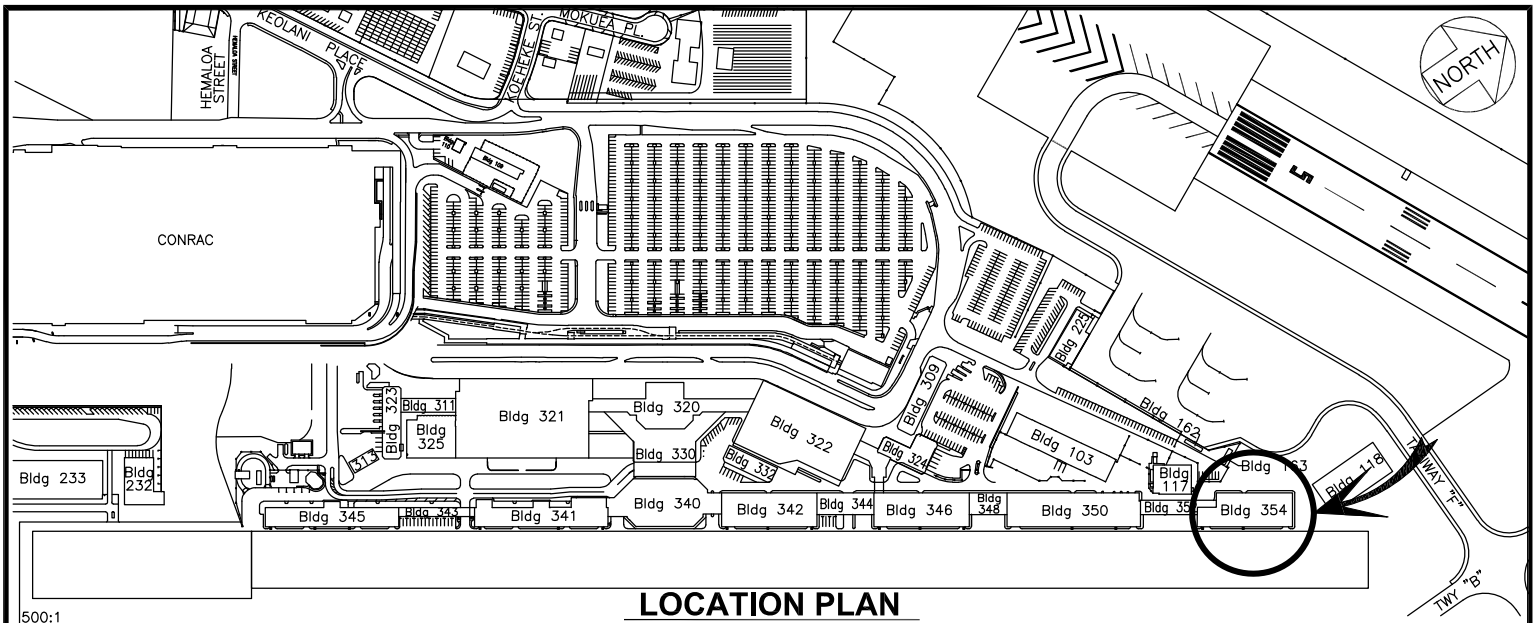

LOCATION PLAN

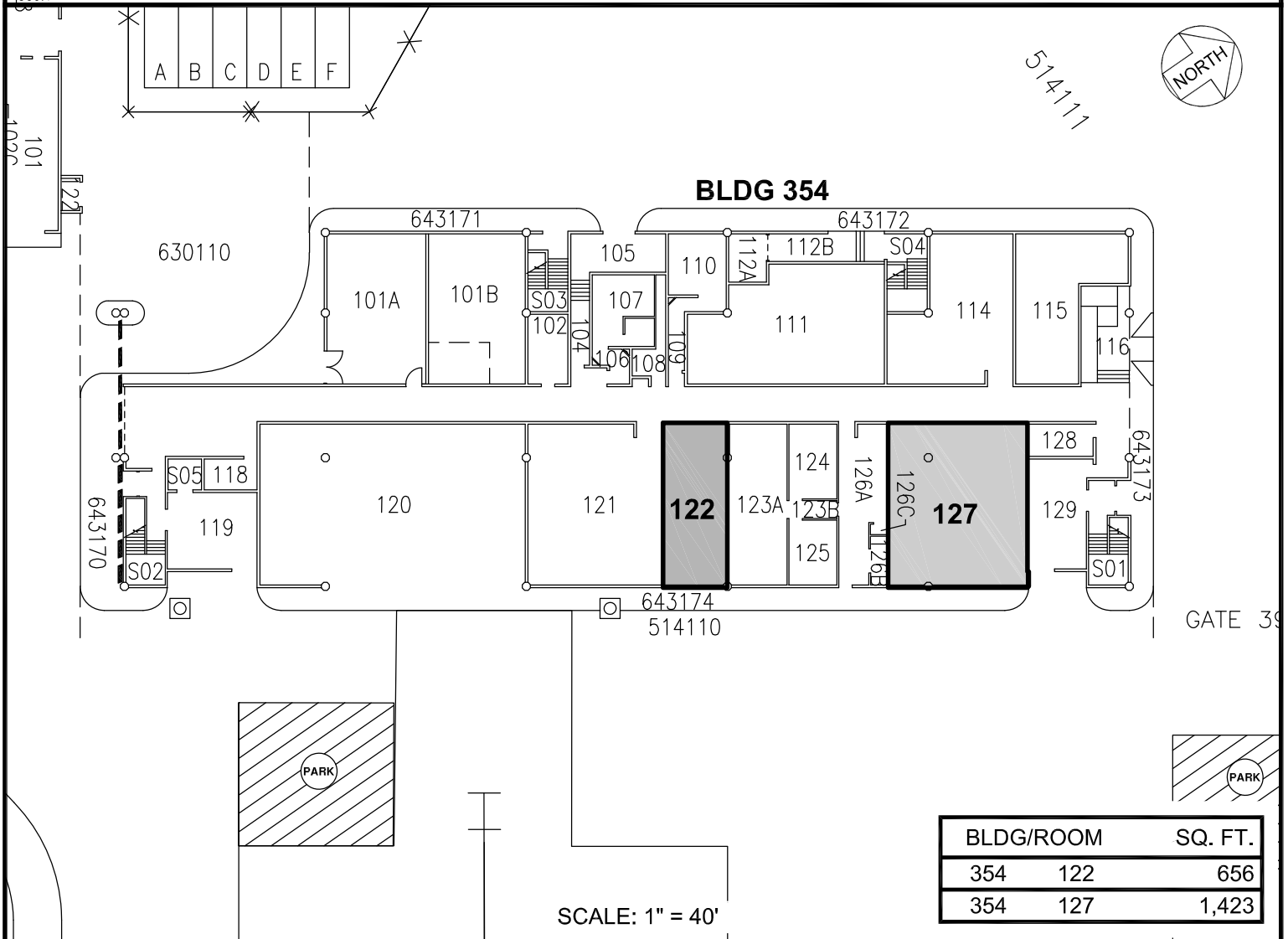

SCALE: 1" = 40'

RP-9521

DATE : NOVEMBER 2023

EXHIBIT: **A**



AIRPORTS

DELTA AIR LINES, INC.

**BLDG 345
HOLDING ROOMS F
GROUND LEVEL**

**354122
354127**

KAHULUI AIRPORT

N:\AIRPORTS\IOGC_KAHULUI\CADD\PMO\G_354122-01.DWG