

JOSH GREEN, M.D.
GOVERNOR
KE KIA'ĀINA



EDWIN H. SNIFFEN
DIRECTOR
KA LUNA HO'OKELE

Deputy Directors
Nā Hope Luna Ho'okele
DREANALEE K. KALILI
TAMMY L. LEE
CURT T. OTAGURO
ROBIN K. SHISHIDO

STATE OF HAWAII | KA MOKU'ĀINA 'O HAWAII
DEPARTMENT OF TRANSPORTATION | KA 'OIHANA ALAKAU
AIRPORTS
400 RODGERS BOULEVARD, SUITE 700
HONOLULU, HAWAII 96819-1880

IN REPLY REFER TO:

AIR-PM 25.0577

July 24, 2025

DOT Land Matters
State of Hawaii
Honolulu, Hawaii

ISSUANCE OF A REVOCABLE PERMIT FOR A T-HANGAR FOR THE
STORAGE AND MAINTENANCE OF AIRCRAFT IN SUPPORT OF A
COMMERCIAL MAINTENANCE BUSINESS
PMX AVIATION SERVICES LLC
DANIEL K. INOUE INTERNATIONAL AIRPORT
TAX MAP KEY: (1) 1-1-076: PORTION OF 020

OAHU

APPLICANT:

PMX Aviation Services LLC (PMX), whose mailing address is 73-1029 Ahulani Street,
Kailua-Kona, Hawaii 96740.

LEGAL REFERENCE:

Hawaii Revised Statutes (HRS), Sections 26-19 and 171-2, as amended.

LOCATION AND TAX MAP KEY:

A portion of Daniel K. Inouye International Airport (Airport), identified as South Ramp,
Island of Oahu, State of Hawaii, identified by Tax Map Key: 1st Division, 1-1-076:
Portion of 020.

AREA:

Building/Room No. 420-117, containing an area of approximately 1,247 square feet,
as shown and delineated on the attached map labeled Exhibit A.

ZONING:

State Land Use District: Urban
City and County of Honolulu LUO: Industrial (I-2)

ISSUANCE OF A REVOCABLE PERMIT FOR A T-HANGAR FOR THE STORAGE AND
MAINTENANCE OF AIRCRAFT IN SUPPORT OF A COMMERCIAL AIRCRAFT
MAINTENANCE BUSINESS, PMX AVIATION SERVICES LLC
PAGE 2

LAND TITLE STATUS:

Non-ceded - Section 5(a) lands of the Hawaii Admission Act
DHHL 30% entitlement lands pursuant to Hawaii Admission Act YES ____ NO X

CURRENT USE STATUS:

Land presently encumbered by Governor's Executive Order No. 3201, dated
June 8, 1983, setting aside 3,152.177 acres designated as the Airport under the control
and management of the State of Hawaii Department of Transportation (HDOT), for
Airport purposes.

CHARACTER OF USE:

PMX will use the T-Hangar for storage of aircraft (2003 Air Creation Twin,
Tail No. N-10084) and as a maintenance hangar to support its commercial aircraft
maintenance business at the Airport.

COMMENCEMENT DATE:

To be determined by the Director of Transportation at a later date.

MONTHLY RENTAL:

\$1,576.34 (\$1,521.34, as determined from the HDOT Schedule of Rates and Charges,
commercial rate for T-Hangar, established by appraisal of Airports properties statewide
plus \$55.00 for electricity).

SECURITY DEPOSIT:

\$4,729.02, or three times the monthly rental in effect.

DCCA VERIFICATION:

Place of business registration confirmed:	YES <u>X</u>	NO ____
Registered business name confirmed:	YES <u>X</u>	NO ____
Good standing confirmed:	YES <u>X</u>	NO ____

CHAPTER 343, HRS - ENVIRONMENTAL ASSESSMENT:

The environmental impacts of the proposed action to the subject land area are covered by
the Honolulu International Airport Master Plan Update and Noise Compatibility Program

ISSUANCE OF A REVOCABLE PERMIT FOR A T-HANGAR FOR THE STORAGE AND
MAINTENANCE OF AIRCRAFT IN SUPPORT OF A COMMERCIAL AIRCRAFT
MAINTENANCE BUSINESS, PMX AVIATION SERVICES LLC
PAGE 3

Environmental Assessment (EA), State Project No. AO1011-03. The EA is a joint State and Federal document, dated September 1989 and published in the October 23, 1989 issue of the OEQC Bulletin. Accordingly, relevant mitigation from the EA and HDOT environmental best management practice will address minimal impacts from this action.

REMARKS:

HDOT proposes to issue a month-to-month revocable permit to PMX for use of a T-Hangar for storage of aircraft and as a maintenance hangar to support its commercial aeronautical maintenance business at the Airport.

RECOMMENDATION:

Based on this submittal, and testimony and facts presented, the HDOT recommends the Director of Transportation finds that approving the issuance of a month-to-month revocable permit to PMX, including its conditions and rent, will serve the best interests of the State.

Respectfully submitted,



CURT T. OTAGURO
Deputy Director of Transportation for Airports

Attachment

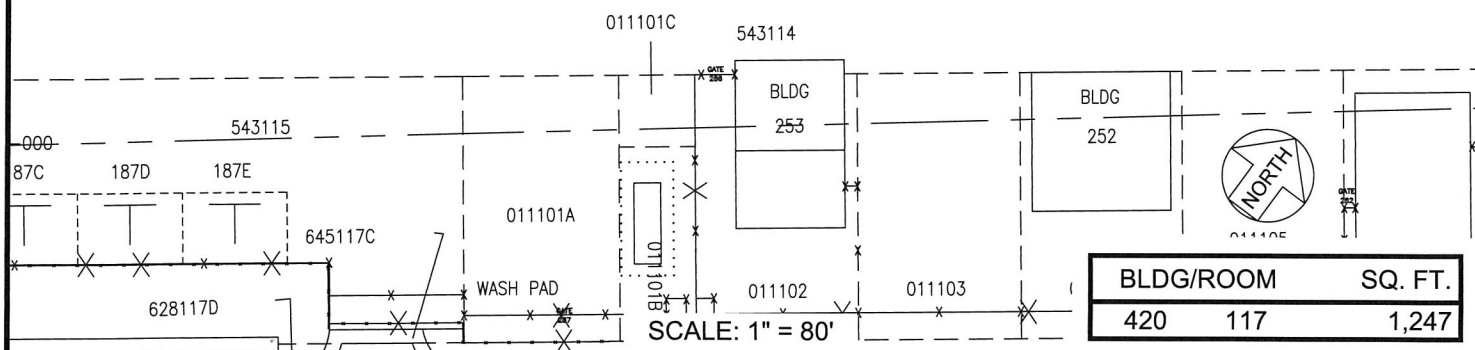
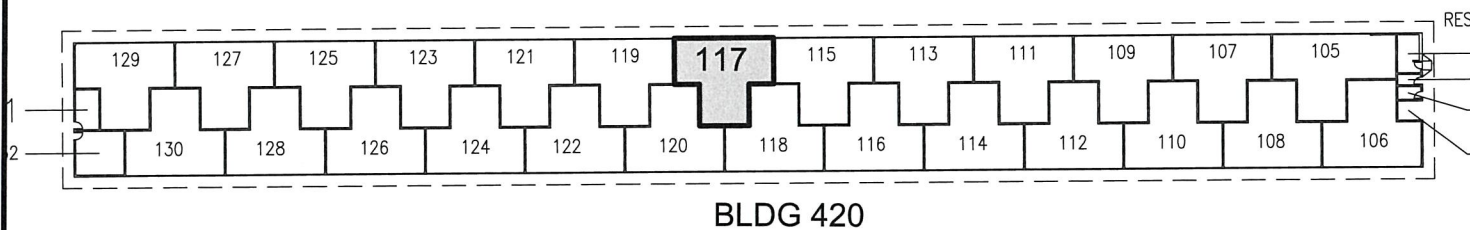
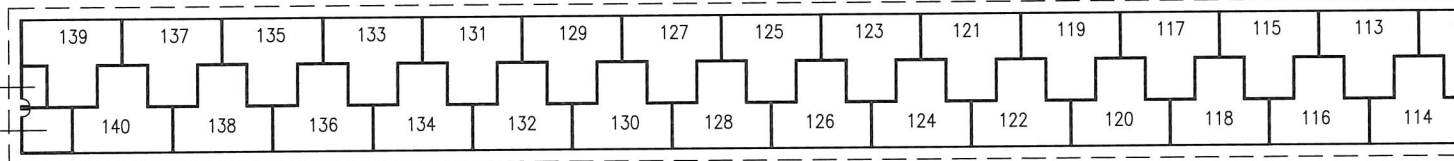
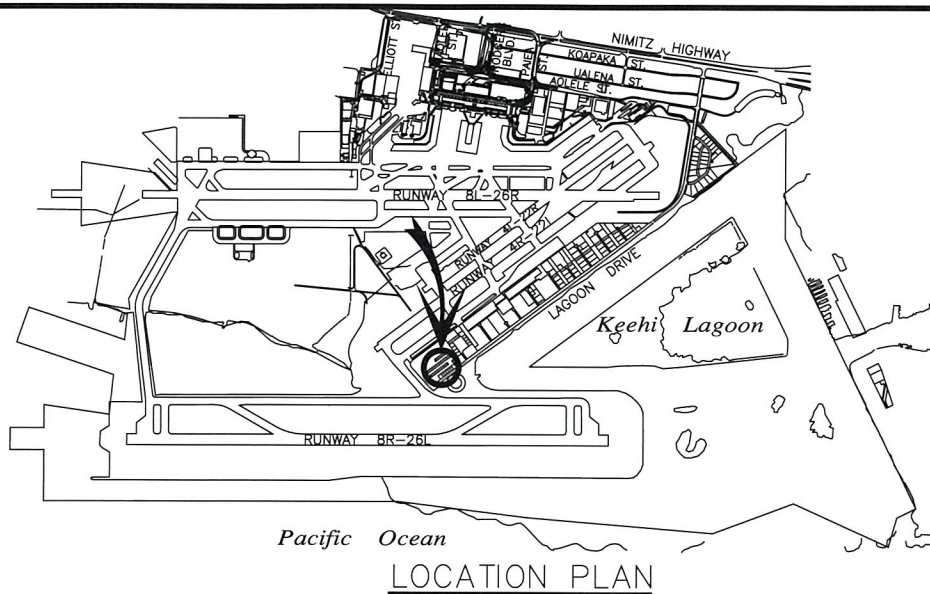

RP-9704

DATE : JUNE 2025

EXHIBIT: **A**



AIRPORTS

PMX AVIATION
SERVICES LLC

T-HANGAR

420117

DANIEL K. INOUE INTERNATIONAL AIRPORT

N:\AIRPORTS\HNL_HONOLULU\CAD\PM\HNL_420117-01.DWG