

JOSH GREEN, M.D.
GOVERNOR
KE KIA'ĀINA



EDWIN H. SNIFFEN
DIRECTOR
KA LUNA HO'OKELE

Deputy Directors
Nā Hope Luna Ho'okele
DREANALEE K. KALILI
TAMMY L. LEE
CURT T. OTAGURO
ROBIN K. SHISHIDO

**STATE OF HAWAI'I | KA MOKU'ĀINA 'O HAWAI'I
DEPARTMENT OF TRANSPORTATION | KA 'OIHANA ALAKAU
AIRPORTS
400 RODGERS BOULEVARD, SUITE 700
HONOLULU, HAWAII 96819-1880**

IN REPLY REFER TO:

AIR-PM 25.0552

July 24, 2025

DOT Land Matters
State of Hawaii
Honolulu, Hawaii

ISSUANCE OF A REVOCABLE PERMIT FOR STORAGE AND OFFICE SPACES
DAIFUKU SERVICES AMERICA CORPORATION
KAHULUI AIRPORT
TAX MAP KEY: (2) 3-8-001: PORTION OF 142 AND PORTION OF 246

MAUI

APPLICANT:

Daifuku Services America Corporation (Daifuku), whose business address is
30100 Cabot Drive, Novi, Michigan 48377-4000.

LEGAL REFERENCE:

Hawaii Revised Statutes (HRS), Sections 26-17 and 171-2, as amended.

LOCATION AND TAX MAP KEY:

Portion of Kahului Airport, Kahului, Island of Maui, identified by
Tax Map Key: 2nd Division, 3-8-001: Portion of 142 and Portion of 246.

AREA:

Building/Room No. 117-101, containing an area of approximately 757 square feet,
Building/Room No. 117-118, containing an area of approximately 546 square feet, and
Building/Room No. 103-103, containing an area of approximately 2,094 square feet, as
shown and delineated on the attached maps labeled Exhibit A and Exhibit B.

ZONING:

State Land Use District:	Urban
County of Maui:	Airport

ISSUANCE OF A REVOCABLE PERMIT FOR STORAGE AND OFFICE SPACES
DAIFUKU SERVICES AMERICA CORPORATION
Page 2

LAND TITLE STATUS:

Section 5(a) lands of the Hawaii Admission Act: Non-Ceded
DHHL 30% entitlement lands pursuant to Hawaii Admission Act YES___ NO X

CURRENT USE STATUS:

Land presently encumbered by Governor's Executive Order No. 2427, dated February 12, 1969, setting aside 1,268.938 acres designated as Kahului Airport to be under the control and management of the State of Hawaii Department of Transportation (HDOT) for public purposes.

CHARACTER OF USE:

Daifuku will use the spaces for offices and storage for jet bridge and baggage system maintenance operations.

COMMENCEMENT DATE:

Upon execution of the revocable permit.

MONTHLY RENTAL:

\$6,882.23 (\$5,047.85 as determined from the HDOT Schedule of Rates and Charges established by appraisal of Airports property statewide, plus \$1,324.83 for utilities and \$509.55 for maintenance).

SECURITY DEPOSIT:

\$20,646.69, or three times the monthly rental in effect.

DCCA VERIFICATION:

Place of business registration confirmed:	YES <u>X</u>	NO ___
Registered business name confirmed:	YES <u>X</u>	NO ___
Good standing confirmed:	YES <u>X</u>	NO ___

CHAPTER 343, HRS - ENVIRONMENTAL ASSESSMENT:

The HDOT has determined that the subject land area and use is covered by the Kahului Airport Terminal Complex Expansion Negative Declaration, published by the Environmental Quality Commission (EQC) in the September 8, 1981, issue of the EQC

ISSUANCE OF A REVOCABLE PERMIT FOR STORAGE AND OFFICE SPACES
DAIFUKU SERVICES AMERICA CORPORATION
Page 3

Bulletin. Accordingly, all relevant mitigation from the Negative Declaration and best management practices will be implemented to address the minimum impacts of this action.

REMARKS:

HDOT proposes to issue a month-to-month revocable permit to Daifuku for storage and office spaces for jet bridge and baggage system maintenance operations.

RECOMMENDATION:

Based on this submittal, and testimony and facts presented, the HDOT recommends the Director of Transportation finds that approving the issuance of a month-to-month revocable permit to Daifuku, including its conditions and rent, will serve the best interests of the State.

Respectfully submitted,



CURT T. OTAGURO
Deputy Director of Transportation for Airports

Attachment

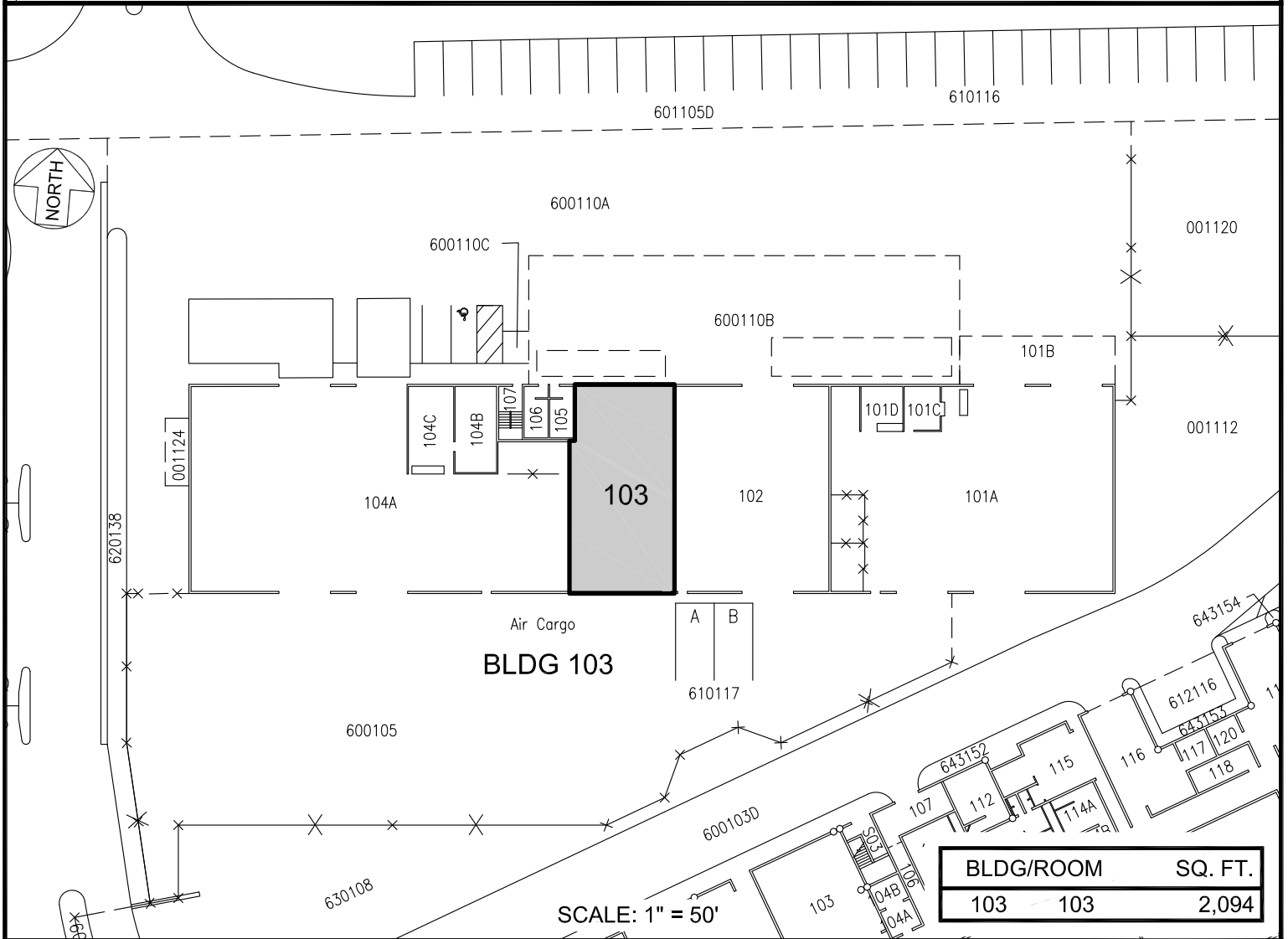
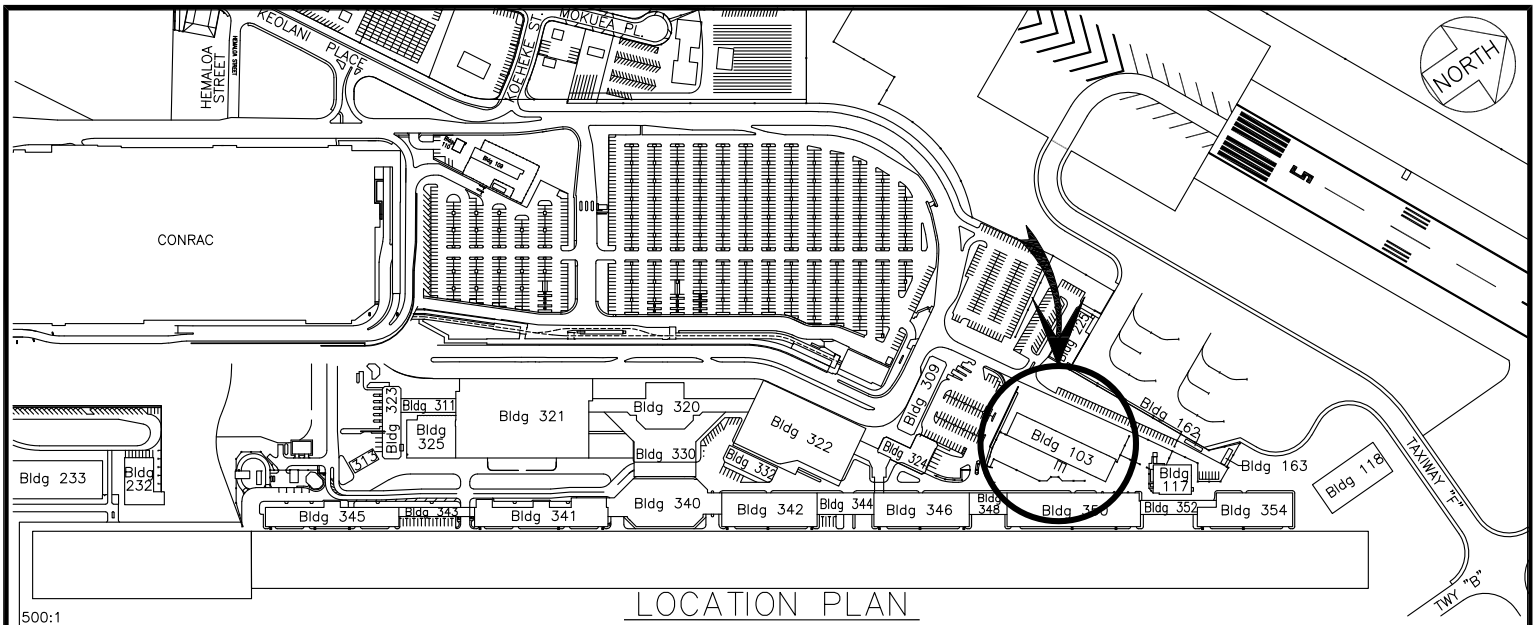

RP-9701

DATE : JUNE 2025

EXHIBIT: **A**



AIRPORTS

DAIFUKU SERVICES
AMERICA CORPORATION

BUILDING 103
AIR CARGO
GROUND LEVEL

103103

KAHULUI AIRPORT

N:\AIRPORTS\IOGG_KAHULUI\CAD\PMO\G_103103-01.DWG

