

JOSH GREEN, M.D.
GOVERNOR
KE KIA'ĀINA



STATE OF HAWAII | KA MOKU'ĀINA 'O HAWAI'I
DEPARTMENT OF TRANSPORTATION | KA 'OIHANA ALAKAU
AIRPORTS
400 RODGERS BOULEVARD, SUITE 700
HONOLULU, HAWAII 96819-1880

EDWIN H. SNIFFEN
DIRECTOR
KA LUNA HO'OKELE

Deputy Directors
Nā Hope Luna Ho'okele
DREANALEE K. KALILI
TAMMY L. LEE
CURT T. OTAGURO
ROBIN K. SHISHIDO

IN REPLY REFER TO:

AIR-PM 25.0664

August 14, 2025

DOT Land Matters
State of Hawaii
Honolulu, Hawaii

ISSUANCE OF A REVOCABLE PERMIT FOR LAND FOR
SIGNATORY AIRLINE CARGO OPERATIONS
FEDERAL EXPRESS CORPORATION
KAHULUI AIRPORT
TAX MAP KEY: (2) 3-8-001: PORTION OF 019

MAUI

APPLICANT:

Federal Express Corporation (Fedex), whose mailing address is 3680 Hacks Cross Road,
Building B, 3rd Floor, Memphis, Tennessee 38125.

LEGAL REFERENCE:

Hawaii Revised Statutes (HRS), Sections 26-17 and 171-2, as amended.

LOCATION AND TAX MAP KEY:

Portion of Kahului Airport, Kahului, Island of Maui, identified by
Tax Map Key: 2nd Division, 3-8-001: Portion of 019.

AREAS:

IMPROVED, PAVED LAND

Area/Space No. 630-134, containing an area of approximately 7,425 square feet,
Area/Space No. 630-135, containing an area of approximately 6,435 square feet, and
Area/Space No. 630-136, containing an area of approximately 1,800 square feet, as
shown and delineated on the attached map labeled Exhibit A.

IMPROVED, UNPAVED LAND

Area/Space No. 820-143, containing an area of approximately 7,225 square feet, as
shown and delineated on the attached map labeled Exhibit A.

ISSUANCE OF A REVOCABLE PERMIT FOR LAND FOR SIGNATORY AIRLINE CARGO
OPERATIONS, FEDERAL EXPRESS CORPORATION
Page 2

ZONING:

State Land Use District: Urban
County of Maui: Airport

LAND TITLE STATUS:

Section 5(a) lands of the Hawaii Admission Act: Non-Ceded
DHHL 30% entitlement lands pursuant to Hawaii Admission Act YES ___ NO X

CURRENT USE STATUS:

Land presently encumbered by Governor's Executive Order No. 2427, dated February 12, 1969, setting aside 1,268.938 acres designated as Kahului Airport to be under the control and management of the State of Hawaii Department of Transportation (HDOT) for public purposes.

CHARACTER OF USE:

Fedex will use the land for office/storage containers, ground service equipment maintenance/parking, and delivery truck parking to support its signatory airline cargo operations.

COMMENCEMENT DATE:

Upon execution of the revocable permit.

MONTHLY RENTAL:

\$7,926.64 (as determined from the HDOT Schedule of Rates and Charges established by appraisal of Airports property statewide).

SECURITY DEPOSIT:

\$23,779.92, or three times the monthly rental in effect.

DCCA VERIFICATION:

Place of business registration confirmed:	YES <u>X</u>	NO ___
Registered business name confirmed:	YES <u>X</u>	NO ___
Good standing confirmed:	YES <u>X</u>	NO ___

CHAPTER 343, HRS - ENVIRONMENTAL ASSESSMENT:

Pursuant to HAR 11-200.1-16(b), the HDOT has determined that the environmental impacts of the proposed land use for Space Nos. 630-134, 630-135, and 630-136 are exempted under DOT's Exemption List, reviewed and concurred to by the Environmental Advisory Council on February 1, 2022, under Type 8, Part 1, (8) h. Creation or extension of leases, revocable permits or easements of property for continuing aeronautical or maritime uses or complementary purposes.

Pursuant to HAR 11-200.1-16(b), the HDOT has determined that the environmental impacts of the proposed land use for Space No. 820-143 is exempted under DOT's Exemption List, reviewed and concurred to by the Environmental Advisory Council on February 1, 2022, under Type 3, Part 2. Construct and locate new structures including buildings, sheds, warehouses, personnel shelters, storage facilities and other similar structures if not in conjunction with the construction of two or more such structures serving the same purpose.

REMARKS:

HDOT proposes to issue a month-to-month revocable permit to Fedex for land for office/storage containers, ground service equipment maintenance/parking, and delivery truck parking to support its signatory airline cargo operations.

RECOMMENDATION:

Based on this submittal, and testimony and facts presented, the HDOT recommends the Director of Transportation finds that approving the issuance of a month-to-month revocable permit to Fedex, including its conditions and rent, will serve the best interests of the State.

Respectfully submitted,



CURT T. OTAGURO
Deputy Director of Transportation for Airports

Attachment

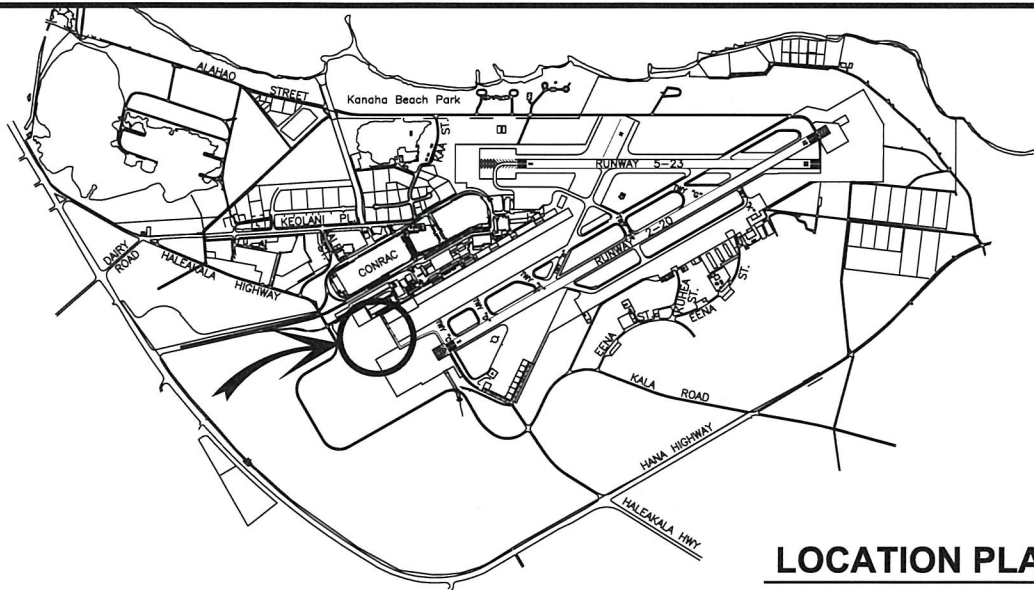

LOCATION PLAN

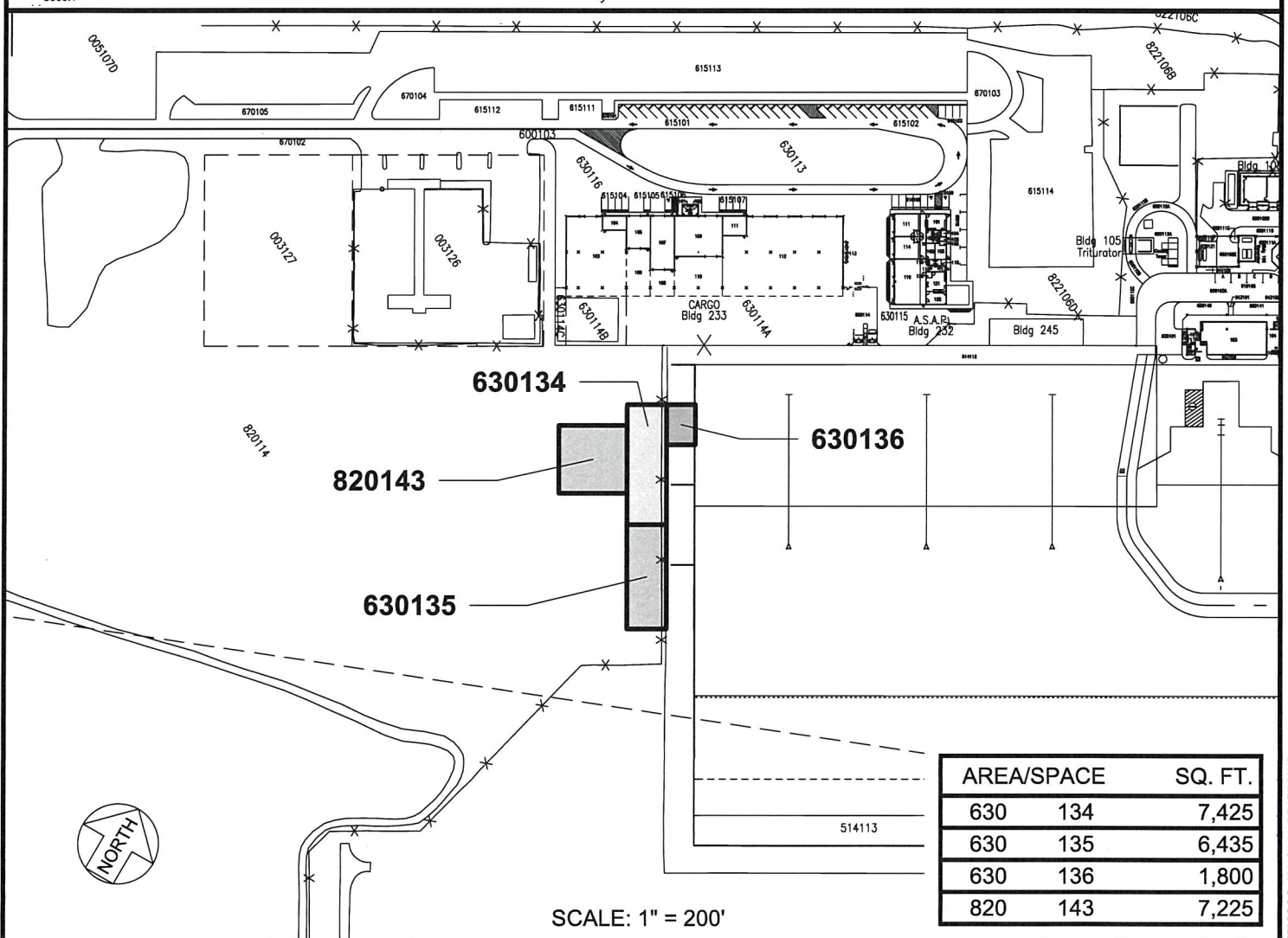

SCALE: 1" = 200'

AREA/SPACE		SQ. FT.
630	134	7,425
630	135	6,435
630	136	1,800
820	143	7,225

RP-9718

DATE : JULY 2025

EXHIBIT: **A**



AIRPORTS

FEDERAL EXPRESS
CORPORATION

LOTS

630134
630135
630136
820143

KAHULUI AIRPORT