

JOSH GREEN, M.D.
GOVERNOR
KE KIA'ĀINA



**STATE OF HAWAI'I | KA MOKU'ĀINA 'O HAWAI'I
DEPARTMENT OF TRANSPORTATION | KA 'OIHANA ALAKAU
AIRPORTS
400 RODGERS BOULEVARD, SUITE 700
HONOLULU, HAWAII 96819-1880**

EDWIN H. SNIFFEN
DIRECTOR
KA LUNA HO'OKELE

Deputy Directors
Nā Hope Luna Ho'okele
DREANALEE K. KALILI
TAMMY L. LEE
CURT T. OTAGURO
ROBIN K. SHISHIDO

IN REPLY REFER TO:

AIR-PM 25.0956

December 4, 2025

DOT Land Matters
State of Hawaii
Honolulu, Hawaii

ISSUANCE OF A REVOCABLE PERMIT FOR OFFICE SPACE AND IMPROVED,
UNPAVED LAND FOR FIELD OFFICE AND PARKING
WESLEY R. SEGAWA & ASSOCIATES, INC.
HILO INTERNATIONAL AIRPORT
TAX MAP KEY: (3) 2-1-012: PORTION OF 106

HAWAII

APPLICANT:

Wesley R. Segawa & Associates, Inc. (WRSA), whose mailing address is
101 Silva Street #201, Hilo, Hawaii 96720.

LEGAL REFERENCE:

Hawaii Revised Statutes (HRS), Sections 26-19 and 171-2, as amended.

LOCATION AND TAX MAP KEY:

Portion of Hilo International Airport (ITO), Hilo, Island of Hawaii,
identified by Tax Map Key: 3rd Division, 2-1-012: Portion of 106.

AREAS:

Building

Building/Room No. 207-101, containing an area of approximately 1,571 square feet, as
shown and delineated on the attached map labeled Exhibit A.

Improved, Unpaved Land

Area/Space No. 007-101C, containing an area of approximately 10,529 square feet,
as shown and delineated on the attached map labeled Exhibit A.

ISSUANCE OF A REVOCABLE PERMIT FOR OFFICE SPACE AND IMPROVED,
UNPAVED LAND FOR FIELD OFFICE AND PARKING
WESLEY R. SEGAWA & ASSOCIATES, INC.

Page 2

ZONING:

State Land Use District:	Urban
County of Hawaii:	Industrial (ML-20)

LAND TITLE STATUS:

Section 5(a) lands of the Hawaii Admission Act: Ceded
DHHL 30% entitlement lands pursuant to Hawaii Admission Act YES___ NO X

CURRENT USE STATUS:

Land presently encumbered by Governor's Executive Order No. 2653, dated March 5, 1973, setting aside 284.466 acres designated as General Lyman Field under the control and management of the State of Hawaii Department of Transportation (HDOT) for public purposes.

CHARACTER OF USE:

WRSA will use the spaces as a field office and vehicle parking for
State Project No. AH1021-19, Taxiway and Runway Lighting Replacement.

COMMENCEMENT DATE:

Upon execution of the revocable permit.

MONTHLY RENTAL:

\$25.00 per month as specifically stated in Contract No. 70898, State Project No. AH1021-19, Taxiway and Runway Lighting Replacement, Attachment S1, Section 1.4 Field Office, which states in part, "Pending the availability of space on airport property, the State may issue a Revocable Permit (RP) to the Contractor for the use of the space, assessed at a nominal monthly fee specified for the respective airport for each Revocable Permit issued. The space(s) shall be used only for a field office, and subject to the approval of the State, vehicle parking may be allowed."

SECURITY DEPOSIT:

\$75.00, or three times the monthly rental in effect.

ISSUANCE OF A REVOCABLE PERMIT FOR OFFICE SPACE AND IMPROVED,
UNPAVED LAND FOR FIELD OFFICE AND PARKING
WESLEY R. SEGAWA & ASSOCIATES, INC.

Page 3

DCCA VERIFICATION:

Place of business registration confirmed:	YES <u>X</u>	NO _____
Registered business name confirmed:	YES <u>X</u>	NO _____
Good standing confirmed:	YES <u>X</u>	NO _____

CHAPTER 343, HRS - ENVIRONMENTAL ASSESSMENT:

The HDOT has determined that the subject areas are covered by the Hilo International Airport Final Environmental Assessment (FEA), dated April 15, 2003, and published by the Office of Environmental Quality Control in the May 8, 2003 issue of The Environmental Notice. Accordingly, all relevant mitigation from the FEA and best management practices will be implemented to address the minimum impacts of this action.

REMARKS:

The HDOT proposes to issue a month-to-month revocable permit to WRSA for office space and vehicle parking for Contract No. 70898, State Project No. AH1021-19, Taxiway and Runway Lighting Replacement.

RECOMMENDATION:

Based on this submittal, and testimony and facts presented, the HDOT recommends the Director of Transportation finds that approving the issuance of a month-to-month revocable permit to WRSA, including its conditions and rent, will serve the best interests of the State.

Respectfully submitted,



CURT T. OTAGURO
Deputy Director of Transportation for Airports

Attachment

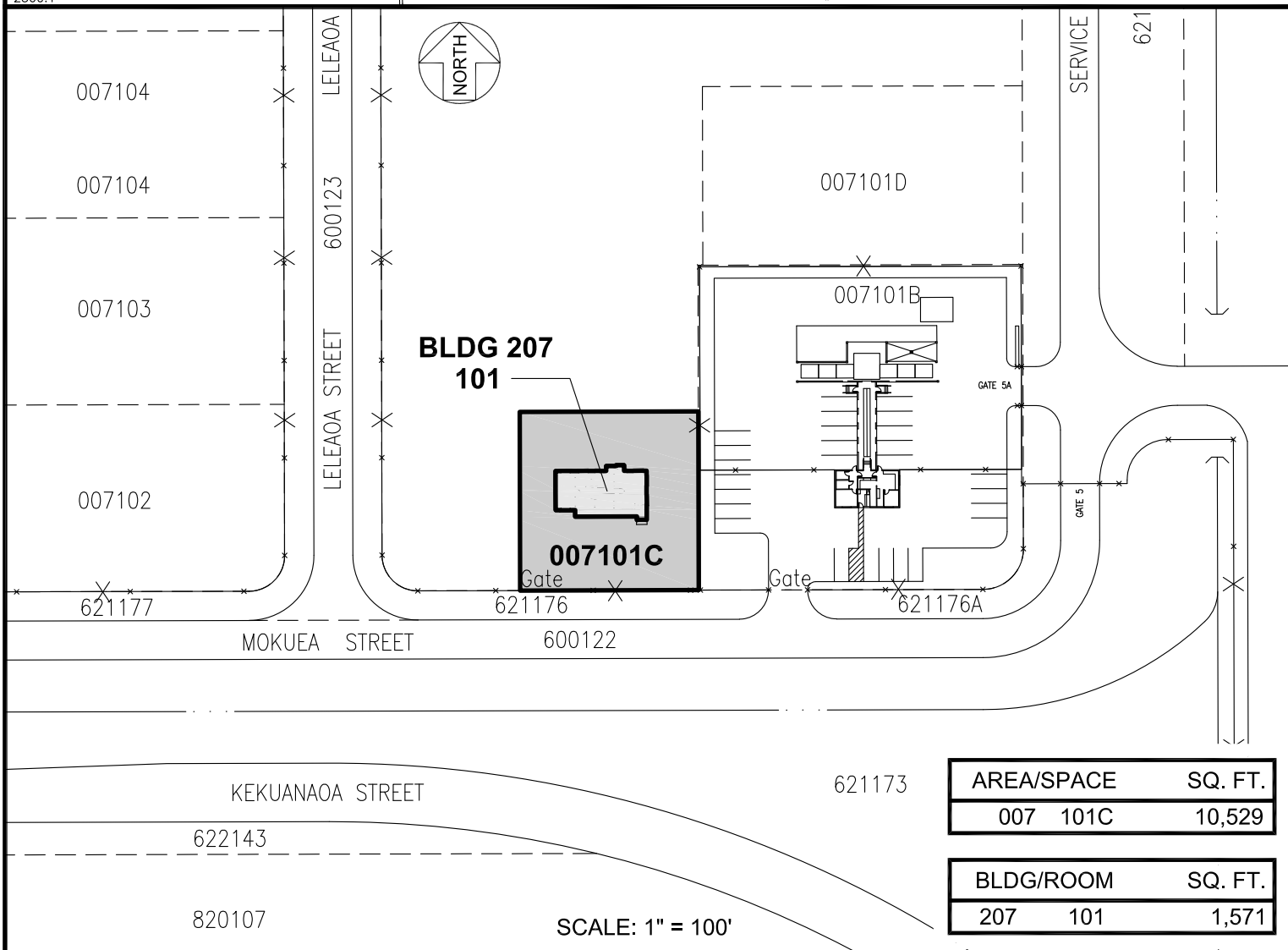
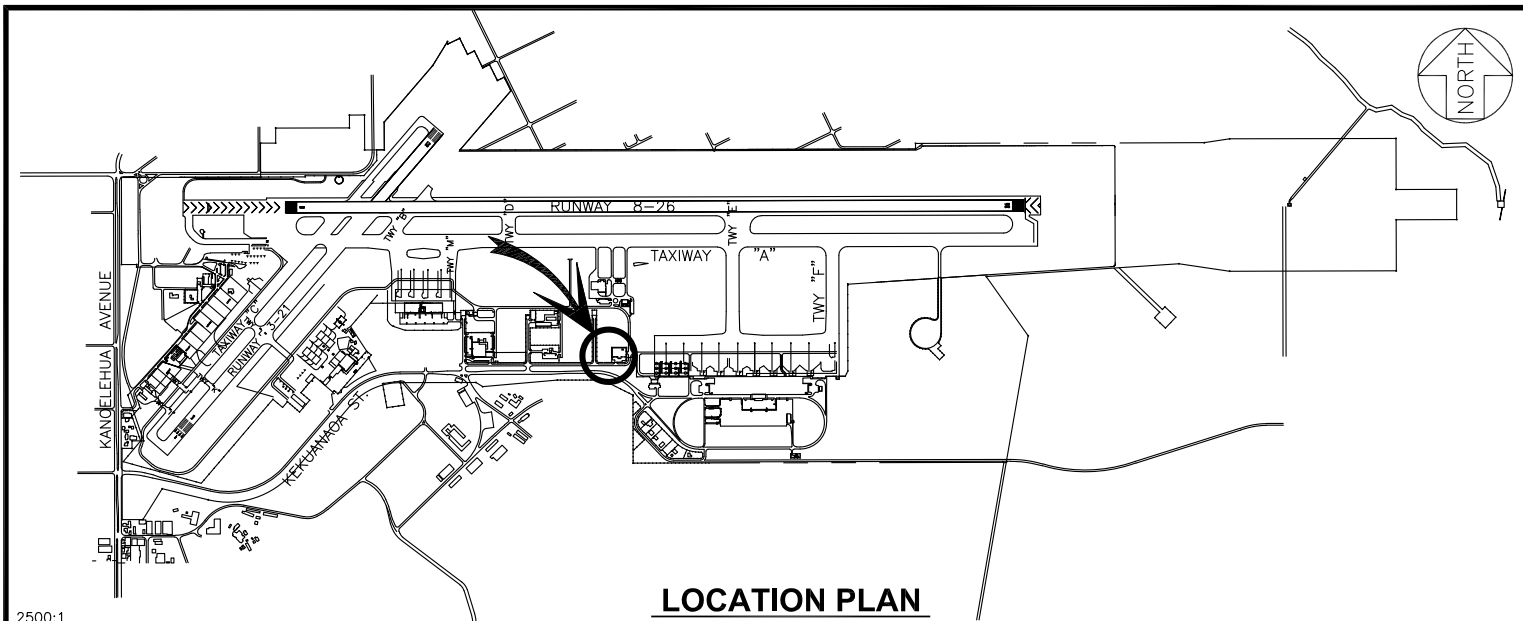

AREA/SPACE	SQ. FT.
007 101C	10,529

BLDG/ROOM	SQ. FT.
207 101	1,571

RP-9748

DATE : DECEMBER 2024

EXHIBIT: **A**



AIRPORTS

WESLEY R. SEGAWA &
ASSOCIATES, INC.

BLDG 207
FIELD OFFICE

007101C
207101

HILO INTERNATIONAL AIRPORT