

JOSH GREEN, M.D.
GOVERNOR
KE KIA'ĀINA



EDWIN H. SNIFFEN
DIRECTOR
KA LUNA HO'OKELE

Deputy Directors
Nā Hope Luna Ho'okele
DREANALEE K. KALILI
TAMMY L. LEE
CURT T. OTAGURO
ROBIN K. SHISHIDO

**STATE OF HAWAI'I | KA MOKU'ĀINA 'O HAWAI'I
DEPARTMENT OF TRANSPORTATION | KA 'OIHANA ALAKAU
AIRPORTS
400 RODGERS BOULEVARD, SUITE 700
HONOLULU, HAWAII 96819-1880**

IN REPLY REFER TO:

AIR-PM 25.1053

January 22, 2026

DOT Land Matters
State of Hawaii
Honolulu, Hawaii

ISSUANCE OF A REVOCABLE PERMIT FOR OFFICE SPACE
TO SUPPORT GROUP TOUR TRAVEL OPERATIONS
JTB HAWAII, INC.
DANIEL K. INOUE INTERNATIONAL AIRPORT
TAX MAP KEY: (1) 1-1-003: 053 (PORTION)

OAHU

APPLICANT:

JTB Hawaii, Inc. (JTB), whose business address is 818 Pine Street, 4th floor,
Honolulu, Hawaii 96817.

LEGAL REFERENCE:

Hawaii Revised Statutes (HRS), Sections 26-19 and 171-2, as amended.

LOCATION AND TAX MAP KEY:

Portion of Building 339, Diamond Head Domestic Building, Second Level, at
Daniel K. Inouye International Airport (Airport), Island of Oahu, State of Hawaii,
identified by Tax Map Key: 1st Division, 1-1-003: 053 (Portion).

AREA:

Building/Room No. 339-223, containing an area of approximately 786 square feet, as
shown and delineated on the attached map labeled Exhibit A.

ZONING:

State Land Use District: Urban
City and County of Honolulu LUO: Industrial (I-2)

ISSUANCE OF A REVOCABLE PERMIT FOR OFFICE SPACE TO SUPPORT GROUP
TOUR TRAVEL OPERATIONS, JTB HAWAII, INC.

Page 2

LAND TITLE STATUS:

Section 5(a) lands of the Hawaii Admissions Act: Non-ceded

DHHL 30% entitlement lands pursuant to the Hawaii State Constitution: YES ____ NO X

CURRENT USE STATUS:

Land presently encumbered by Governor's Executive Order No. 3201, dated June 8, 1983, setting aside 3,152.177 acres designated as the Airport under the control and management of the State of Hawaii Department of Transportation (HDOT) for Airport purposes.

CHARACTER OF USE:

JTB will use the space as an administrative office to support its group tour travel service operations at the Airport.

COMMENCEMENT DATE:

Upon execution of the revocable permit.

MONTHLY RENTAL:

\$1,721.34 (\$1,218.30, as determined from the HDOT Schedule of Rates and Charges established by appraisal of Airports property statewide plus \$306.54 for utilities and \$196.50 for air conditioning).

SECURITY DEPOSIT:

\$5,164.02, or three times the monthly rental in effect.

DCCA VERIFICATION:

Place of business registration confirmed:	YES <u>X</u>	NO ____
Registered business name confirmed:	YES <u>X</u>	NO ____
Good standing confirmed:	YES <u>X</u>	NO ____

CHAPTER 343, HRS - ENVIRONMENTAL ASSESSMENT:

The environmental impacts of the proposed action to the subject land area is covered by the Honolulu International Airport, Airport Modernization Program Environmental Assessment (EA), State Project No. AO1030-13. The EA is a joint State and Federal document dated January 2013, and published in the February 8, 2013 issue of the OEQC

ISSUANCE OF A REVOCABLE PERMIT FOR OFFICE SPACE TO SUPPORT GROUP
TOUR TRAVEL OPERATIONS, JTB HAWAII, INC.

Page 3

Bulletin. Accordingly, the actions have been determined to have little or no impact upon the environment.

REMARKS:

In accordance with HRS, relating to Permits, HDOT proposes to issue a month-to-month revocable permit to JTB for an administrative office to support its group tour service operations at the Airport.

RECOMMENDATION:

Based on this submittal, and testimony and facts presented, the HDOT recommends the Director of Transportation finds that approving the issuance of a month-to-month revocable permit to JTB including its conditions and rent, will best serve the interests of the State.

Respectfully submitted,



CURT T. OTAGURO

Deputy Director of Transportation for Airports

Attachment

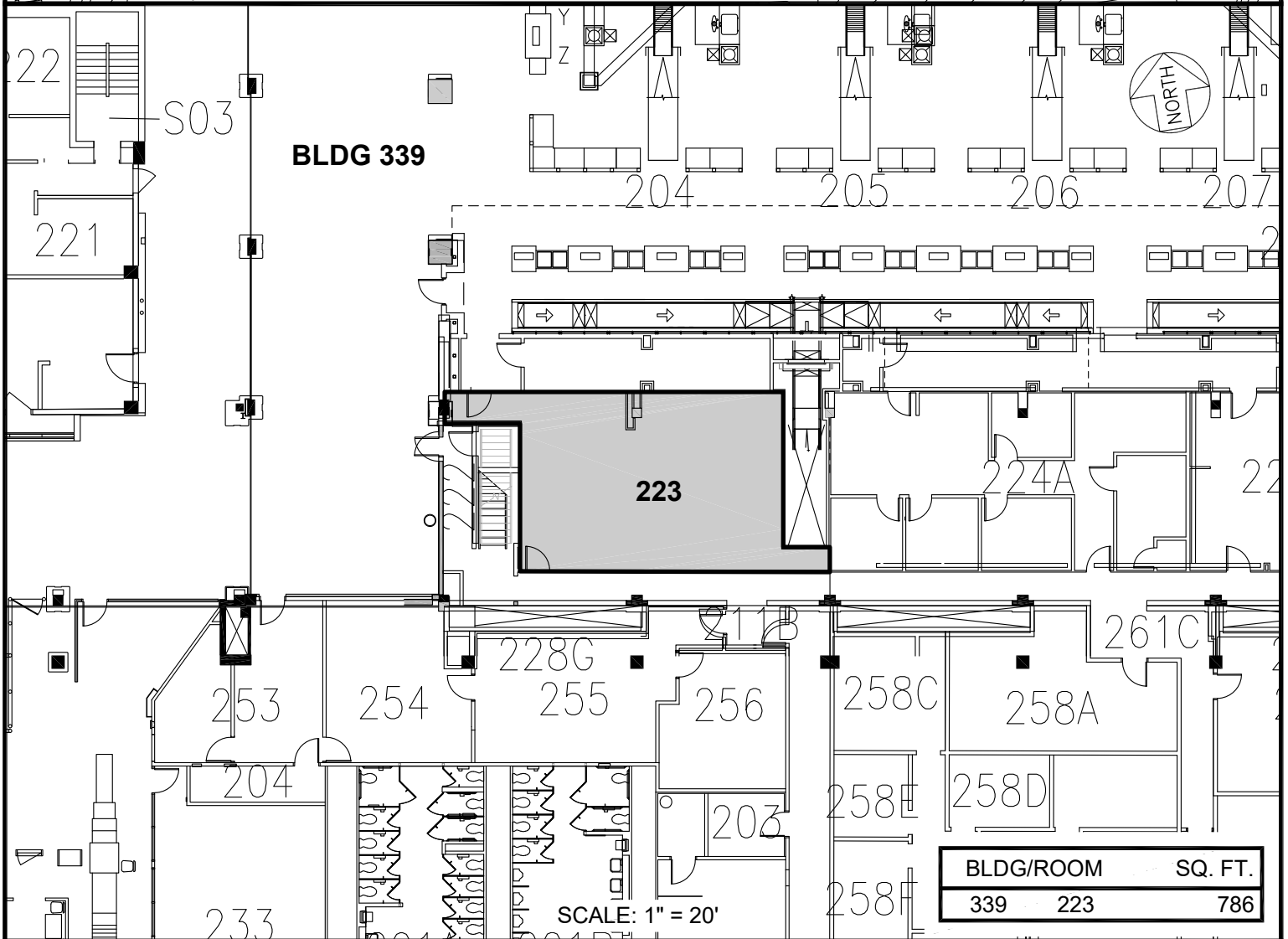
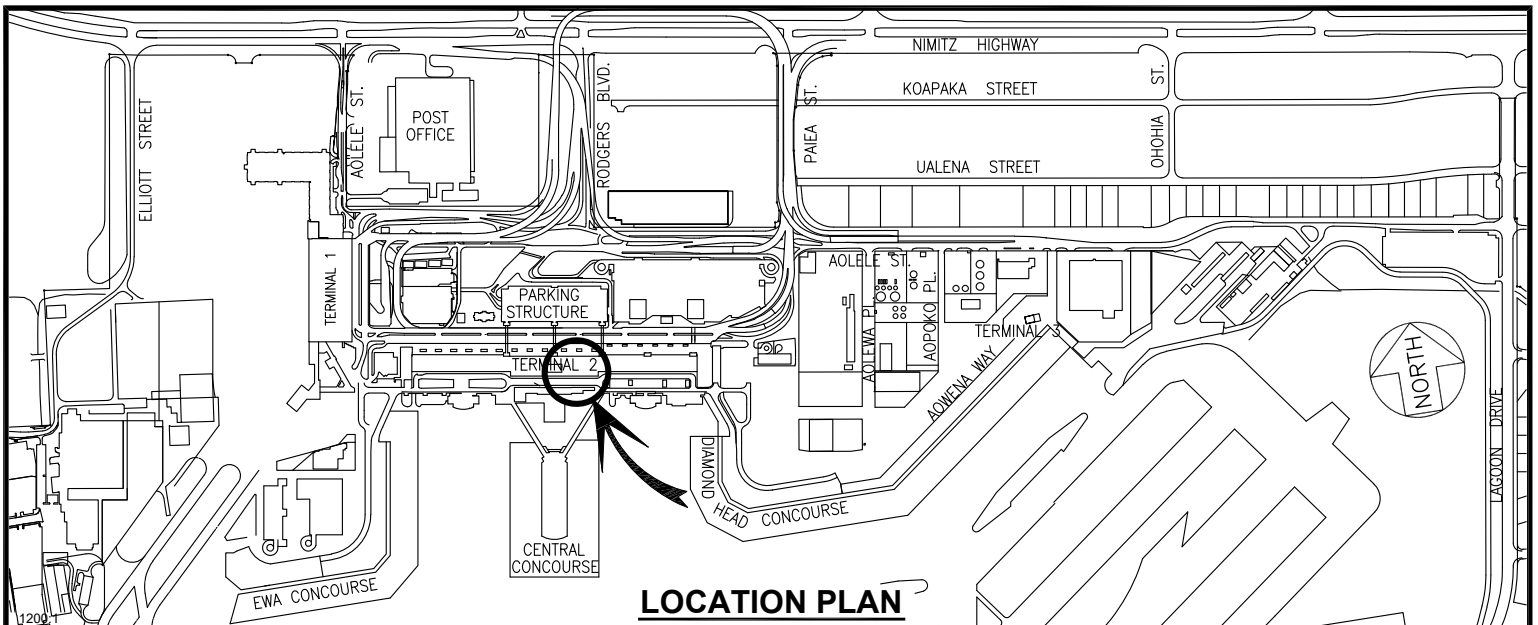

RP-9759

DATE : NOVEMBER 2025

EXHIBIT: **A**



AIRPORTS

JTB HAWAII, INC.

**BUILDING 339
D.H. DOMESTIC BLDG
SECOND LEVEL**

339223

DANIEL K. INOUE INTERNATIONAL AIRPORT

N:\AIRPORTS\HNL_HONOLULU\CAD\PM\HNL_339223-01.DWG