

JOSH GREEN, M.D.
GOVERNOR
KE KIA'ĀINA



STATE OF HAWAII | KA MOKU'ĀINA 'O HAWAII'
DEPARTMENT OF TRANSPORTATION | KA 'OIHANA ALAKAU
AIRPORTS
400 RODGERS BOULEVARD, SUITE 700
HONOLULU, HAWAII 96819 1880

EDWIN H. SNIFFEN
DIRECTOR
KA LUNA HO'OKELE

Deputy Directors
Nā Hope Luna Ho'okele
DREANALEE K. KALILI
TAMMY L. LEE
CURT T. OTAGURO
ROBIN K. SHISHIDO

IN REPLY REFER TO:

AIR-PM 26.0009

February 12, 2026

DOT Land Matters
State of Hawaii
Honolulu, Hawaii

ISSUANCE OF A REVOCABLE PERMIT FOR STORAGE
SPACE FOR GREETING SERVICE OPERATIONS
KULEA GREETING SERVICE, LLC
KAHULUI AIRPORT
TAX MAP KEY: (2) 3-8-01: PORTION OF 220

MAUI

APPLICANT:

Kulea Greeting Service, LLC (Kulea), whose mailing address is 1877 Launiupoko Place,
Wailuku, Hawaii 96793.

LEGAL REFERENCE

Hawaii Revised Statutes (HRS), Sections 26-19 and 171-2, as amended.

LOCATION AND TAX MAP KEY:

Portion of Kahului Airport, Kahului, Island of Maui, identified by
Tax Map Key: 2nd Division, 3-8-01: Portion of 220.

AREA:

Building/Room No. 309-102, containing an area of approximately 108 square feet, as
shown and delineated on the attached Exhibit A.

ZONING:

State Land Use District:	Urban
County of Maui:	Airport

ISSUANCE OF A REVOCABLE PERMIT FOR STORAGE SPACE FOR GREETING
SERVICE OPERATIONS, KULEA GREETING SERVICE, LLC

Page 2

LAND TITLE STATUS:

Section 5(a) lands of the Hawaii Admission Act: Non-Ceded

DHHL 30% entitlement lands pursuant to Hawaii Admission Act YES___ NO X

CURRENT USE STATUS:

Land presently encumbered by Governor's Executive Order No. 2427, dated February 12, 1969, setting aside 1,268.938 acres designated as Kahului Airport to be under the control and management of the State of Hawaii Department of Transportation (HDOT) for public purposes.

CHARACTER OF USE:

Kulea will use the space for storage to support its greeting service operation.

COMMENCEMENT DATE:

To be determined by the Director of Transportation at a later date.

MONTHLY RENTAL:

\$295.92 (\$237.60, based on a rate of \$26.40 per square foot per annum, as determined from the HDOT Schedule of Rates and Charges established by appraisal of Airports property statewide, plus \$42.12 for utilities and \$16.20 for maintenance).

SECURITY DEPOSIT:

\$887.76, or three times the monthly rental in effect.

DCCA VERIFICATION:

Place of business registration confirmed:	YES <u>X</u>	NO ___
Registered business name confirmed:	YES <u>X</u>	NO ___
Good standing confirmed:	YES <u>X</u>	NO ___

CHAPTER 343, HRS – ENVIRONMENTAL ASSESSMENT:

The HDOT has determined that the subject land area and use is covered by the Kahului Airport Terminal Complex Expansion Negative Declaration, published by the Environmental Quality Commission (EQC) in the November 8, 1977, issue of the EQC Bulletin. Accordingly, all relevant mitigation from the Negative Declaration and best management practices will be implemented to address the minimum impacts of this action.

ISSUANCE OF A REVOCABLE PERMIT FOR STORAGE SPACE FOR GREETING
SERVICE OPERATIONS, KULEA GREETING SERVICE, LLC

Page 3

REMARKS:

The HDOT proposes to issue a month-to-month revocable permit to Kulea for storage space to support its greeting service operation.

RECOMMENDATION:

Based on this submittal, and testimony and facts presented, the HDOT recommends the Director of Transportation finds that approving the issuance of a month-to-month revocable permit to Kulea including its conditions and rent, will serve the best interests of the State.

Respectfully submitted,

A handwritten signature in black ink, appearing to read 'C. Otaguro', is positioned above the printed name.

CURT T. OTAGURO
Deputy Director of Transportation for Airports

Attachment

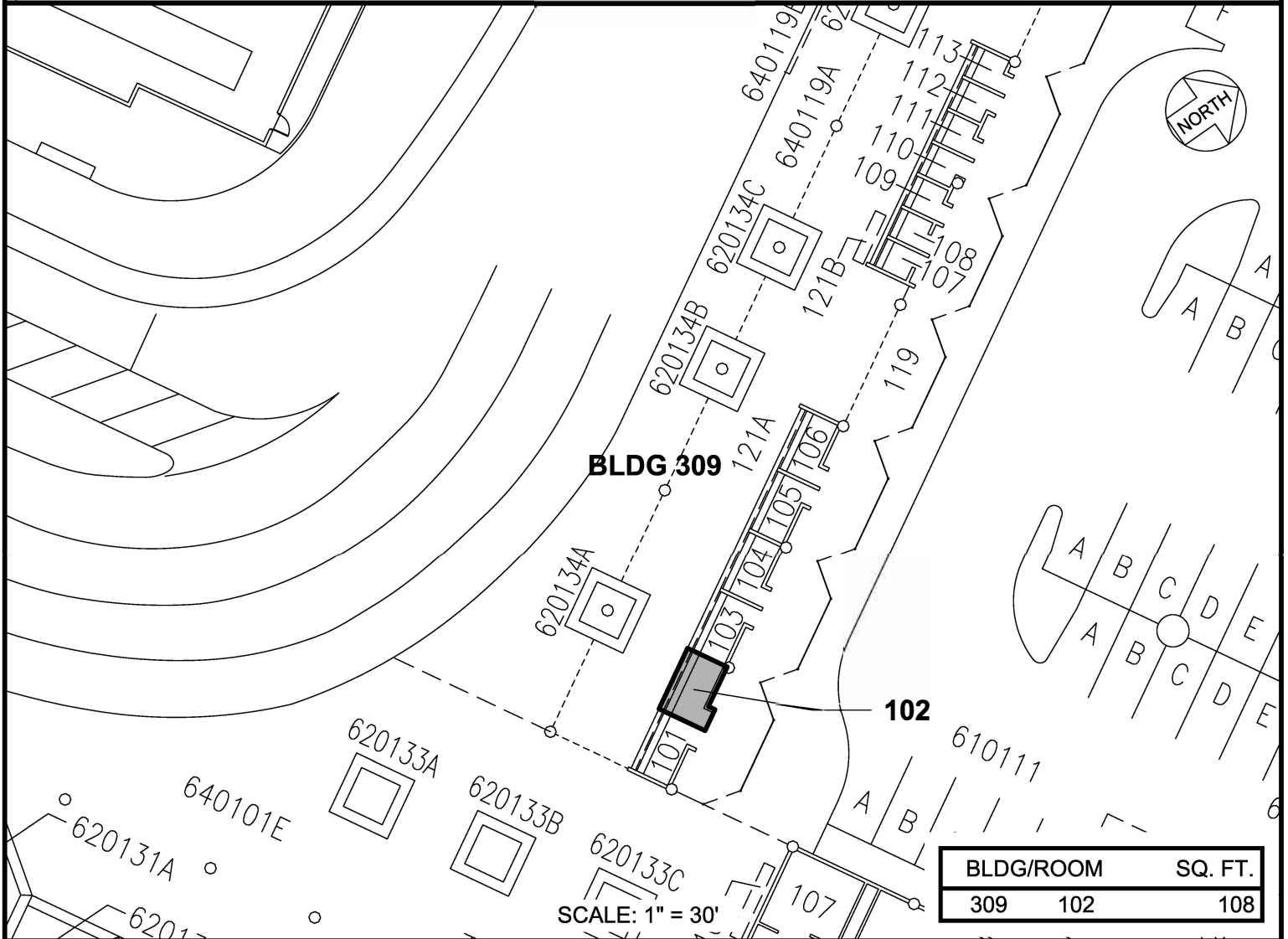
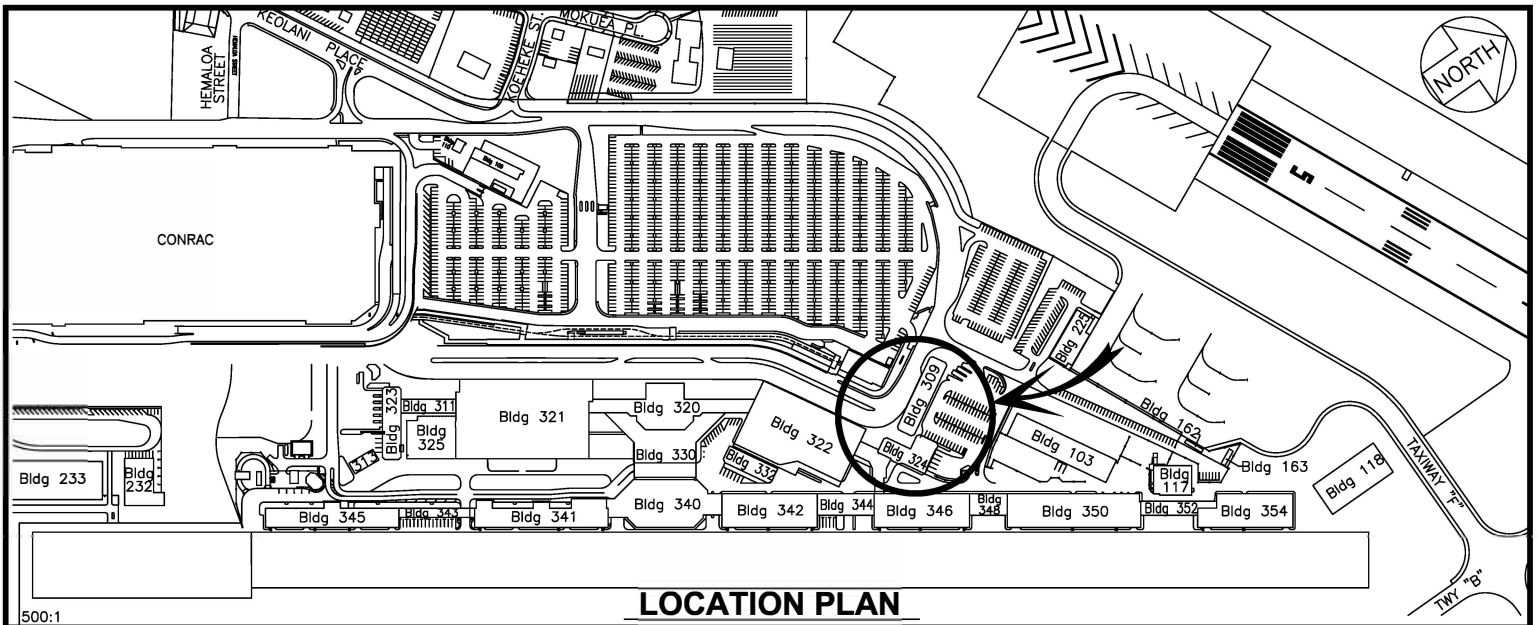

RP-9769

DATE : JUNE 2024

EXHIBIT: **A**



AIRPORTS

**KULEA GREETING
SERVICE, LLC**

**BLDG 309
CAR RENTAL BUILDING
GROUND LEVEL**

309102

KAHULUI AIRPORT

N:\AIRPORTS\IOGG_KAHULUI\CAD\PMO\IOGG_309102-01.DWG