

JOSH GREEN, M.D.
GOVERNOR
KE KIA'ĀINA



EDWIN H. SNIFFEN
DIRECTOR
KA LUNA HO'OKELE

Deputy Directors
Nā Hope Luna Ho'okele
DREANALEE K. KALILI
TAMMY L. LEE
CURT T. OTAGURO
ROBIN K. SHISHIDO

**STATE OF HAWAI'I | KA MOKU'ĀINA 'O HAWAI'I
DEPARTMENT OF TRANSPORTATION | KA 'OIHANA ALAKAU
AIRPORTS
400 RODGERS BOULEVARD, SUITE 700
HONOLULU, HAWAII 96819-1880**

IN REPLY REFER TO:

AIR-PM 26.0014

February 12, 2026

DOT Land Matters
State of Hawaii
Honolulu, Hawaii

ISSUANCE OF A REVOCABLE PERMIT FOR IMPROVED, PAVED LAND FOR
AIR AMBULANCE OPERATIONS
LIFE FLIGHT NETWORK, LLC
KAHULUI AIRPORT
TAX MAP KEY: (2) 3-8-001: PORTION OF 019

MAUI

APPLICANT:

Life Flight Network, LLC (LFN), whose mailing address is 22285 Yellow Gate Lane,
Suite 102, Aurora, Oregon 97002.

LEGAL REFERENCE:

Hawaii Revised Statutes (HRS), Sections 26-19 and 171-2, as amended.

LOCATION AND TAX MAP KEY:

Portion of Kahului Airport, Kahului, Island of Maui, identified by
Tax Map Key: 2nd Division, 3-8-001: Portion of 019.

AREA:

Area/Space No. 401-130, containing an area of approximately 1,073 square feet, and
Area/Space No. 630-139, containing an area of approximately 136 square feet, as shown
and delineated on the attached map labeled Exhibit A.

ZONING:

State Land Use District:	Urban
County of Maui:	Airport

ISSUANCE OF A REVOCABLE PERMIT FOR IMPROVED, PAVED LAND FOR AIR
AMBULANCE OPERATIONS, LIFE FLIGHT NETWORK, LLC

Page 2

LAND TITLE STATUS:

Section 5(a) lands of the Hawaii Admission Act: Non-Ceded

DHHL 30% entitlement lands pursuant to Hawaii Admission Act YES___ NO X

CURRENT USE STATUS:

Land presently encumbered by Governor's Executive Order No. 2427, dated February 12, 1969, setting aside 1,268.938 acres designated as Kahului Airport to be under the control and management of the State of Hawaii Department of Transportation (HDOT) for public purposes.

CHARACTER OF USE:

LFN will use the spaces for self-refueling area for rotorcraft and fuel tank storage to support its air ambulance operation.

COMMENCEMENT DATE:

Upon execution of the revocable permit.

MONTHLY RENTAL:

\$460.42 (as determined from the HDOT Schedule of Rates and Charges established by appraisal of Airports property statewide).

SECURITY DEPOSIT:

\$1,381.26, or three times the monthly rental in effect.

DCCA VERIFICATION:

Place of business registration confirmed:	YES <u>X</u>	NO ____
Registered business name confirmed:	YES <u>X</u>	NO ____
Good standing confirmed:	YES <u>X</u>	NO ____

CHAPTER 343, HRS - ENVIRONMENTAL ASSESSMENT:

The State of Hawaii Department of Transportation, has determined that the environmental impacts for the subject land use is covered by the Kahului Airport Improvements Final Environmental Impact Statement (EIS), published by the Office of Environmental Quality Control (OEQC) in the October 23, 1997, issue of The

ISSUANCE OF A REVOCABLE PERMIT FOR IMPROVED, PAVED LAND FOR AIR
AMBULANCE OPERATIONS, LIFE FLIGHT NETWORK, LLC

Page 3

Environmental Notice. The EIS was accepted by the Governor on February 18, 1998. Accordingly, all relevant mitigation from the EIS and best management practices will be implemented to address the minimum impacts of this action.

REMARKS:

HDOT proposes to issue a month-to-month revocable permit to LFN for self-refueling area for rotorcraft and fuel tank storage to support its air ambulance operation.

RECOMMENDATION:

Based on this submittal, and testimony and facts presented, the HDOT recommends the Director of Transportation finds that approving the issuance of a month-to-month revocable permit to LFN, including its conditions and rent, will serve the best interests of the State.

Respectfully submitted,



CURT T. OTAGURO

Deputy Director of Transportation for Airports

Attachment

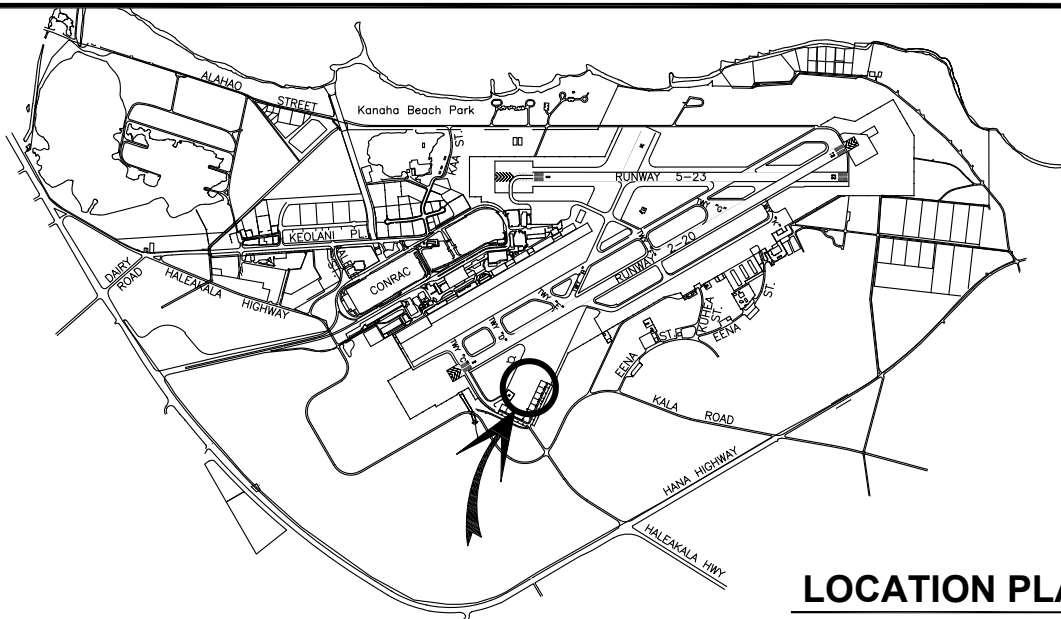

LOCATION PLAN

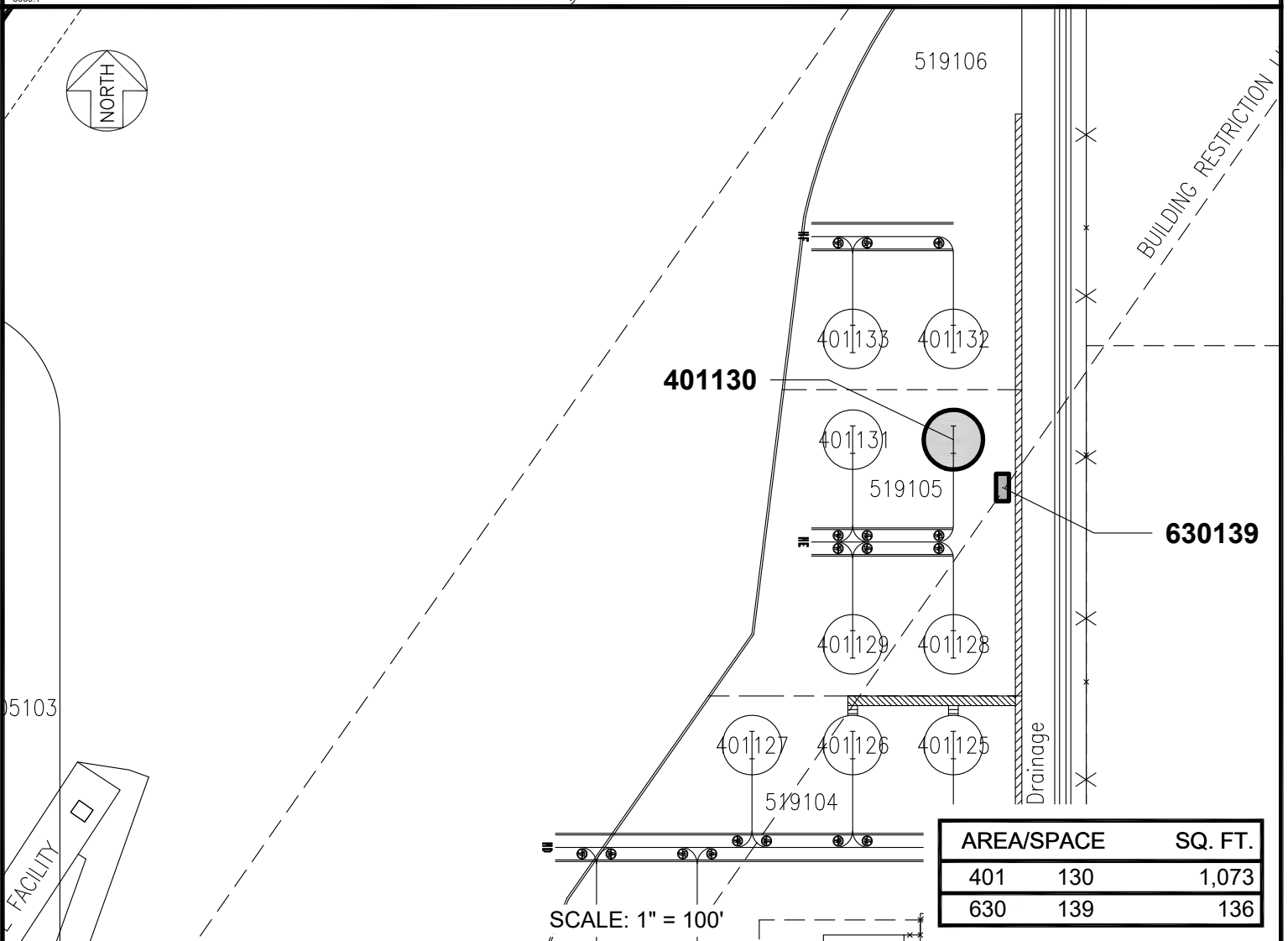

AREA/SPACE		SQ. FT.
401	130	1,073
630	139	136

RP-9770

DATE : JANUARY 2026

EXHIBIT: **A**



AIRPORTS

**LIFE FLIGHT NETWORK,
LLC**

HELIPAD AND FUEL TANK

**401130
630139**

KAHULUI AIRPORT