

JOSH GREEN, M.D.
GOVERNOR
KE KIA'ĀINA



STATE OF HAWAII | KA MOKU'ĀINA 'O HAWAII'
DEPARTMENT OF TRANSPORTATION | KA 'OIHANA ALAKAU
AIRPORTS
400 RODGERS BOULEVARD, SUITE 700
HONOLULU, HAWAII 96819-1880

EDWIN H. SNIFFEN
DIRECTOR
KA LUNA HO'OKELE

Deputy Directors
Nā Hope Luna Ho'okele
DREANALEE K. KALILI
TAMMY L. LEE
CURT T. OTAGURO
ROBIN K. SHISHIDO

IN REPLY REFER TO:

AIR-PM 26.0217

April 23, 2026

DOT Land Matters
State of Hawaii
Honolulu, Hawaii

ISSUANCE OF A REVOCABLE PERMIT FOR
FIXED-WING AIRCRAFT PARKING
GUARDIAN FLIGHT LLC
HILO INTERNATIONAL AIRPORT
TAX MAP KEY: (3) 2-1-012: PORTION OF 009

HAWAII

REQUEST:

Issuance of a Revocable Permit for Aircraft Parking (Parking Permit) to Guardian Flight LLC (Guardian), situated at Hilo International Airport.

APPLICANT:

Guardian, whose business address is 150 Lagoon Drive, Honolulu, Hawaii 96819.

LEGAL REFERENCE:

Hawaii Revised Statutes (HRS), Sections 26-19 and 171-2, as amended.

LOCATION AND TAX MAP KEY:

Portion of Hilo International Airport (ITO), Hilo, Island of Hawaii, identified by Tax Map Key: 3rd Division, 2-1-012: Portion of 009.

AREAS:

Area/Space No. 411-105, containing an area of approximately 990 square feet, and Area/Space No. 411-106, containing an area of approximately 990 square feet, as shown and delineated on the attached map labeled Exhibit A.

ISSUANCE OF A REVOCABLE PERMIT FOR FIXED-WING AIRCRAFT PARKING
GUARDIAN FLIGHT LLC

Page 2

ZONING:

State Land Use District: Urban
County of Hawaii: Industrial (ML-20)

LAND TITLE STATUS:

Section 5(a) lands of the Hawaii Admission Act: Ceded
DHHL 30% entitlement lands pursuant to Hawaii Admission Act YES___ NO X

CURRENT USE STATUS:

Land presently encumbered by Governor's Executive Order No. 1519, dated July 17, 1952, setting aside 550.881 acres being a portion of General Lyman Field under the control and management of the Hawaii Aeronautics Commission [subsequently transferred to the State of Hawaii Department of Transportation (HDOT)] as a site for the Hilo Airport, now known as ITO.

CHARACTER OF USE:

Fixed-wing aircraft (1996 Raytheon C90A, N-299RP and 1999 Raytheon C90A, N-3263N) tie-downs.

COMMENCEMENT DATE:

To be determined by the Director of Transportation at a later date.

MONTHLY RENTAL:

\$260.00 (as determined from the HDOT Schedule of Rates and Charges established by appraisal of Airports property statewide).

SECURITY DEPOSIT:

\$780.00, or three times the monthly rental in effect.

DCCA VERIFICATION:

Place of business registration confirmed: YES X NO _____
Registered business name confirmed: YES X NO _____
Good standing confirmed: YES X NO _____

ISSUANCE OF A REVOCABLE PERMIT FOR FIXED-WING AIRCRAFT PARKING
GUARDIAN FLIGHT LLC

Page 3

CHAPTER 343, HRS - ENVIRONMENTAL ASSESSMENT:

The HDOT has determined that the subject areas are covered by the Hilo International Airport Final Environmental Assessment (FEA), dated April 15, 2003, and published by the Office of Environmental Quality Control in the May 8, 2003 issue of The Environmental Notice. Accordingly, all relevant mitigation from the FEA and best management practices will be implemented to address the minimum impacts of this action.

REMARKS:

HDOT proposes to issue a month-to-month Parking Permit to Guardian for fixed-wing aircraft parking at ITO.

RECOMMENDATION:

Based on this submittal, and testimony and facts presented, the HDOT recommends the Director of Transportation finds that approving the issuance of a month-to-month Parking Permit to Guardian, including its conditions and rent, will serve the best interests of the State.

Respectfully submitted,



CURT T. OTAGURO

Deputy Director of Transportation for Airports

Attachment

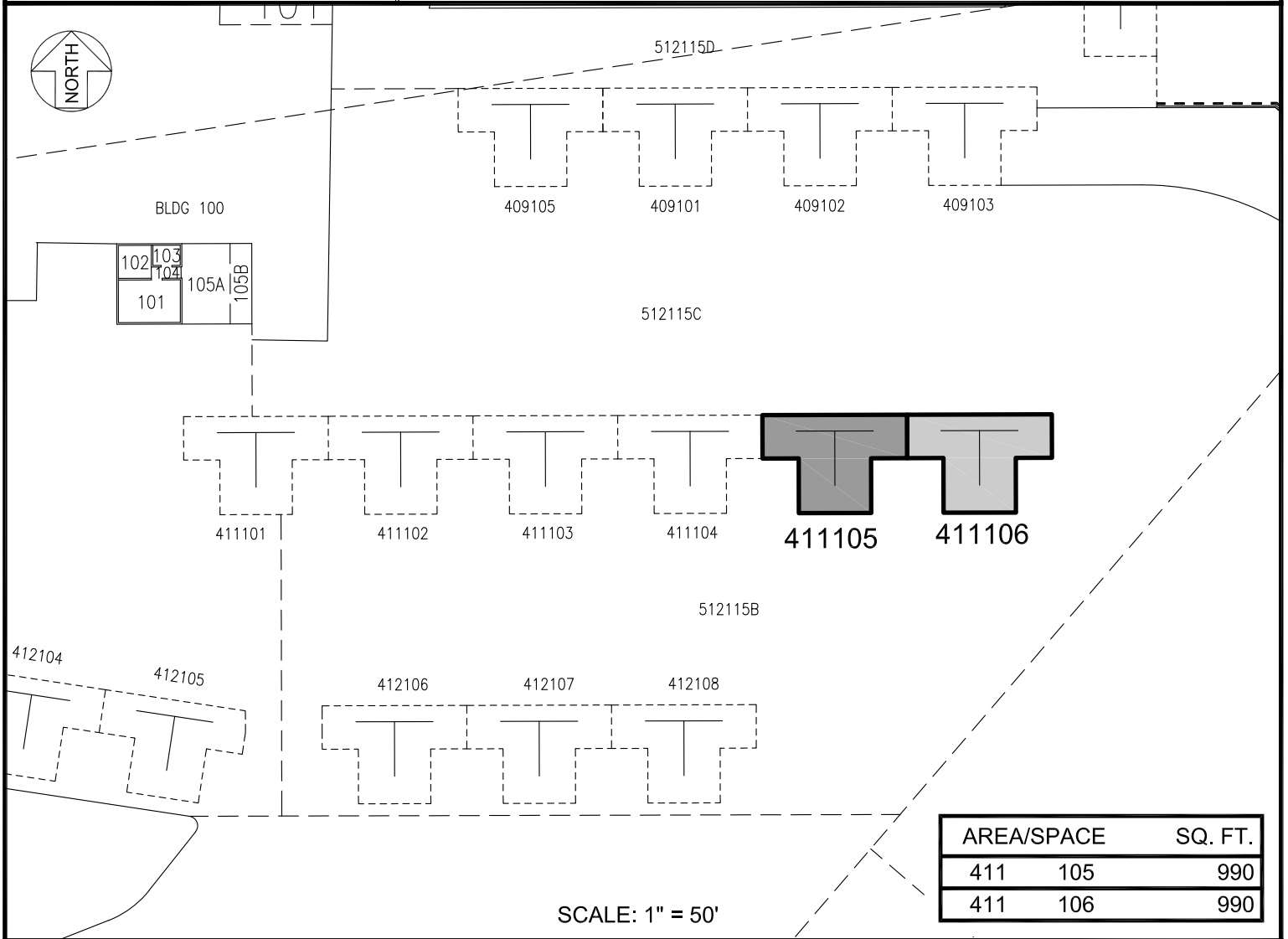
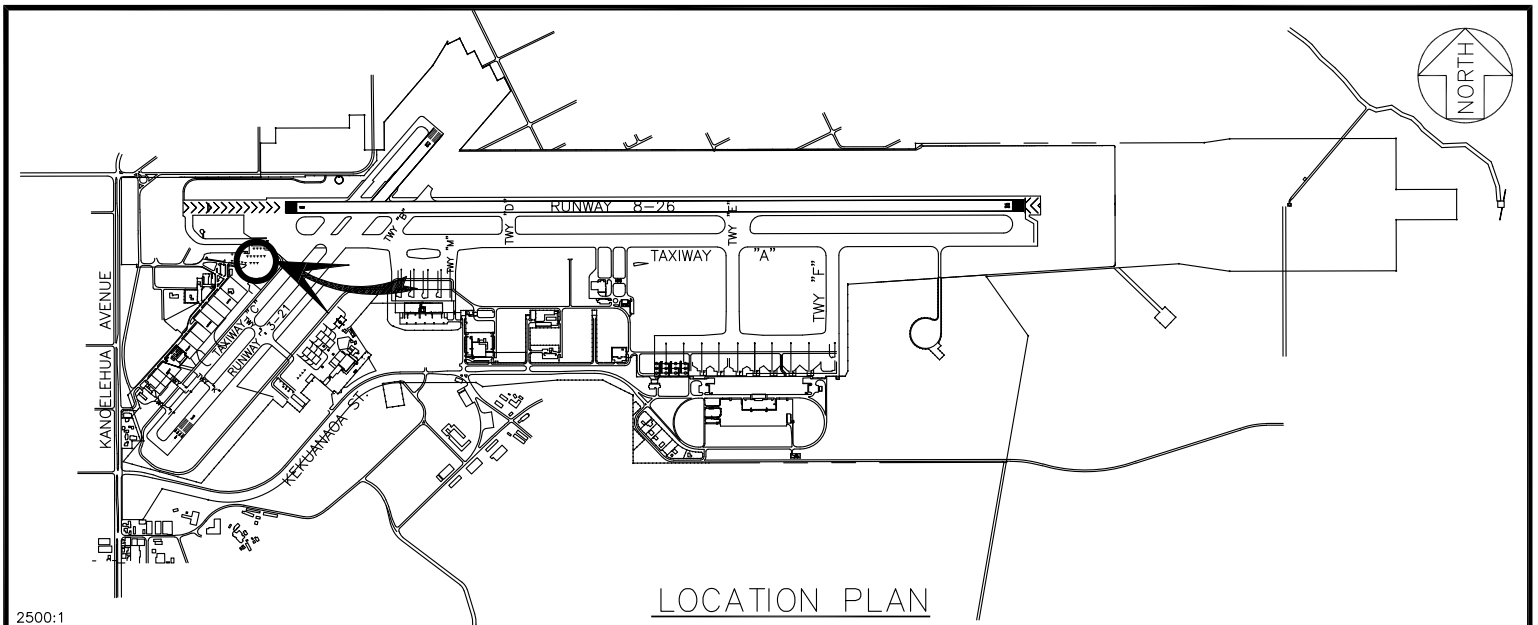

PP-25-S304

DATE : MAY 2025

EXHIBIT: **A**



AIRPORTS

GUARDIAN FLIGHT LLC

TIE-DOWN

411105
411106

HILO INTERNATIONAL AIRPORT

N:\AIRPORTS\ITO_HILO\CAD\IP\MITO_411105-01.DWG