

JOSH GREEN, M.D.
GOVERNOR
KE KIA'ĀINA



EDWIN H. SNIFFEN
DIRECTOR
KA LUNA HO'OKELE

Deputy Directors
Nā Hope Luna Ho'okele
DREANALEE K. KALILI
TAMMY L. LEE
CURT T. OTAGURO
ROBIN K. SHISHIDO

STATE OF HAWAII | KA MOKU'ĀINA 'O HAWAII'
DEPARTMENT OF TRANSPORTATION | KA 'OIHANA ALAKAU
AIRPORTS
400 RODGERS BOULEVARD, SUITE 700
HONOLULU, HAWAII 96819-1880

IN REPLY REFER TO:

AIR-PM 26.0420

July 2, 2026

DOT Land Matters
State of Hawaii
Honolulu, Hawaii

ISSUANCE OF A REVOCABLE PERMIT FOR
PASSENGER CHECK-IN COUNTERS
AIR NEW ZEALAND
DANIEL K. INOUE INTERNATIONAL AIRPORT
TAX MAP KEY: (1) 1-1-003: 053 (PORTION)

OAHU

APPLICANT:

Air New Zealand, whose business address is 300 Rodgers Boulevard #43,
Honolulu, Hawaii 96819.

LEGAL REFERENCE:

Hawaii Revised Statutes (HRS), Sections 26-19 and 171-2, as amended.

LOCATION AND TAX MAP KEY:

A portion of Daniel K. Inouye International Airport (Airport), Island of Oahu,
State of Hawaii, identified by Tax Map Key: 1st Division, 1-1-003: 053 (portion).

AREA:

Building/Room No. 339-215A, containing an area of approximately 33 square feet,
Building/Room No. 339-215B, containing an area of approximately 32 square feet,
Building/Room No. 339-215C, containing an area of approximately 53 square feet,
Building/Room No. 339-215D, containing an area of approximately 53 square feet,
Building/Room No. 339-215E, containing an area of approximately 53 square feet,
Building/Room No. 339-215F, containing an area of approximately 53 square feet,
Building/Room No. 339-215G, containing an area of approximately 53 square feet, and
Building/Room No. 339-215H, containing an area of approximately 56 square feet,
as shown and delineated on the attached map labeled Exhibit A.

ISSUANCE OF A REVOCABLE PERMIT FOR PASSENGER CHECK-IN COUNTERS
AIR NEW ZEALAND
Page 2

ZONING:

State Land Use District: Urban
City and County of Honolulu LUO: Industrial (I-2)

LAND TITLE STATUS:

Section 5(a) lands of the Hawaii Admissions Act: Non-ceded
DHHL 30% entitlement lands pursuant to Hawaii Admission Act YES ___ NO X

CURRENT USE STATUS:

Land presently encumbered by Governor's Executive Order No. 3201, dated June 8, 1983, setting aside 3,152.177 acres designated as the Airport under the control and management of the State of Hawaii Department of Transportation (HDOT), for Airport purposes.

CHARACTER OF USE:

Air New Zealand will use the space for passenger check-in counters, as part of their Signatory Airline Carrier Operations at the Airport.

COMMENCEMENT DATE:

Upon execution of the revocable permit.

MONTHLY RENTAL:

\$6,176.32, as determined from the HDOT Signatory Carrier Rates and Charges, Hawaii Airports System, effective July 1, 2026.

SECURITY DEPOSIT:

\$18,528.96, or three times the monthly rental in effect.

DCCA VERIFICATION:

Place of business registration confirmed:	YES <u>X</u>	NO ___
Registered business name confirmed:	YES <u>X</u>	NO ___
Good standing confirmed:	YES <u>X</u>	NO ___

CHAPTER 343, HRS - ENVIRONMENTAL ASSESSMENT:

The environmental impacts of the proposed action to the subject land area is covered by the Honolulu International Airport, Airport Modernization Program Environmental Assessment (EA), State Project No. AO1030-13. The EA is a joint State and Federal document dated January 2013, and published in the February 8, 2013 issue of the OEQC Bulletin. Accordingly, the actions have been determined to have little or no impact upon the environment.

REMARKS:

HDOT proposes to issue a month-to-month revocable permit to Air New Zealand, for passenger check-in counters as part of its Signatory Commercial Air Carrier Operations, situated at the Airport.

RECOMMENDATION:

Based on this submittal, and testimony and facts presented, the HDOT recommends the Director of Transportation finds that approving the issuance of a month-to-month revocable permit to Air New Zealand, including its conditions and rent, will serve the best interests of the State.

Respectfully submitted,



CURT T. OTAGURO
Deputy Director of Transportation for Airports

Attachment

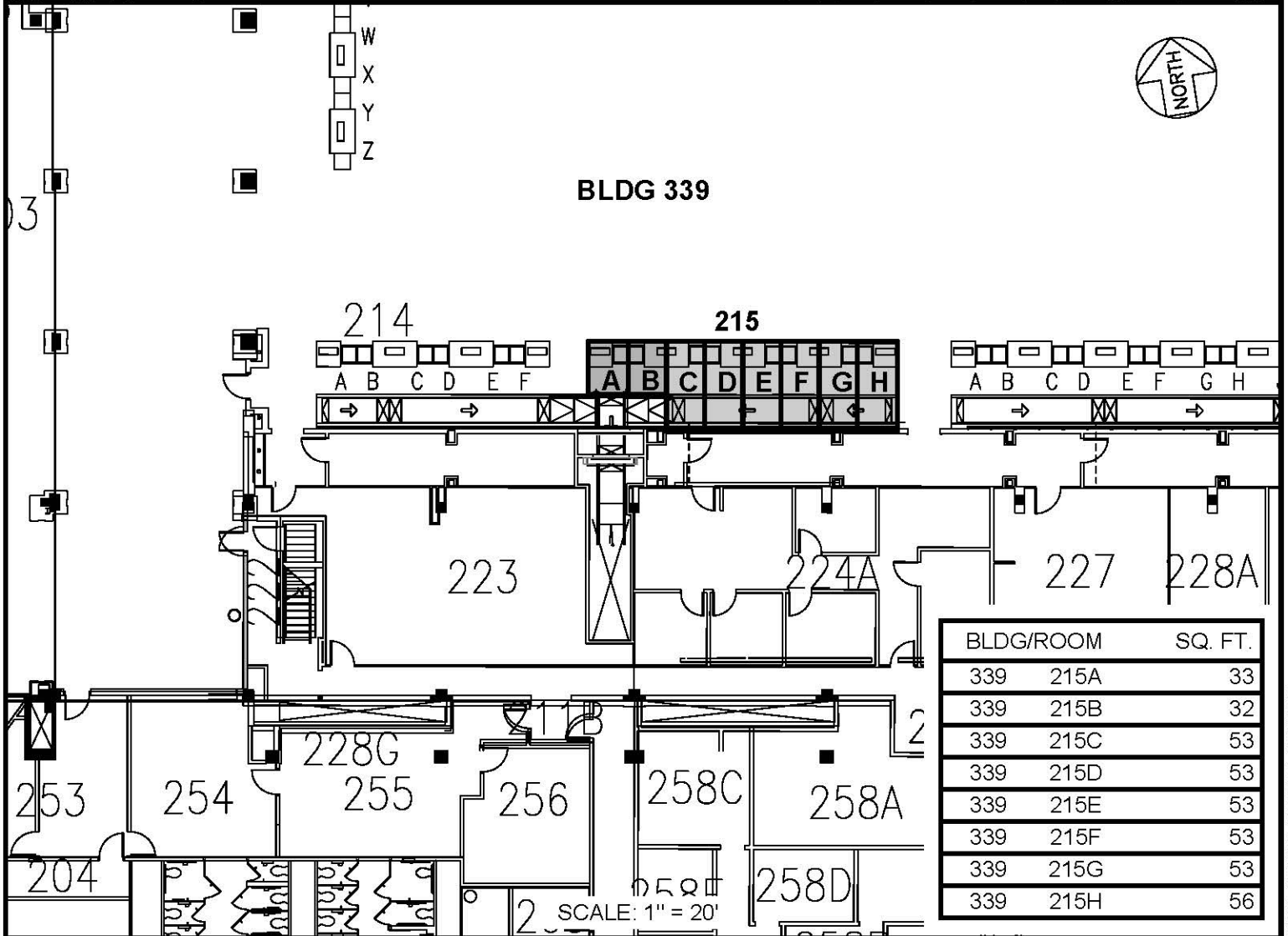
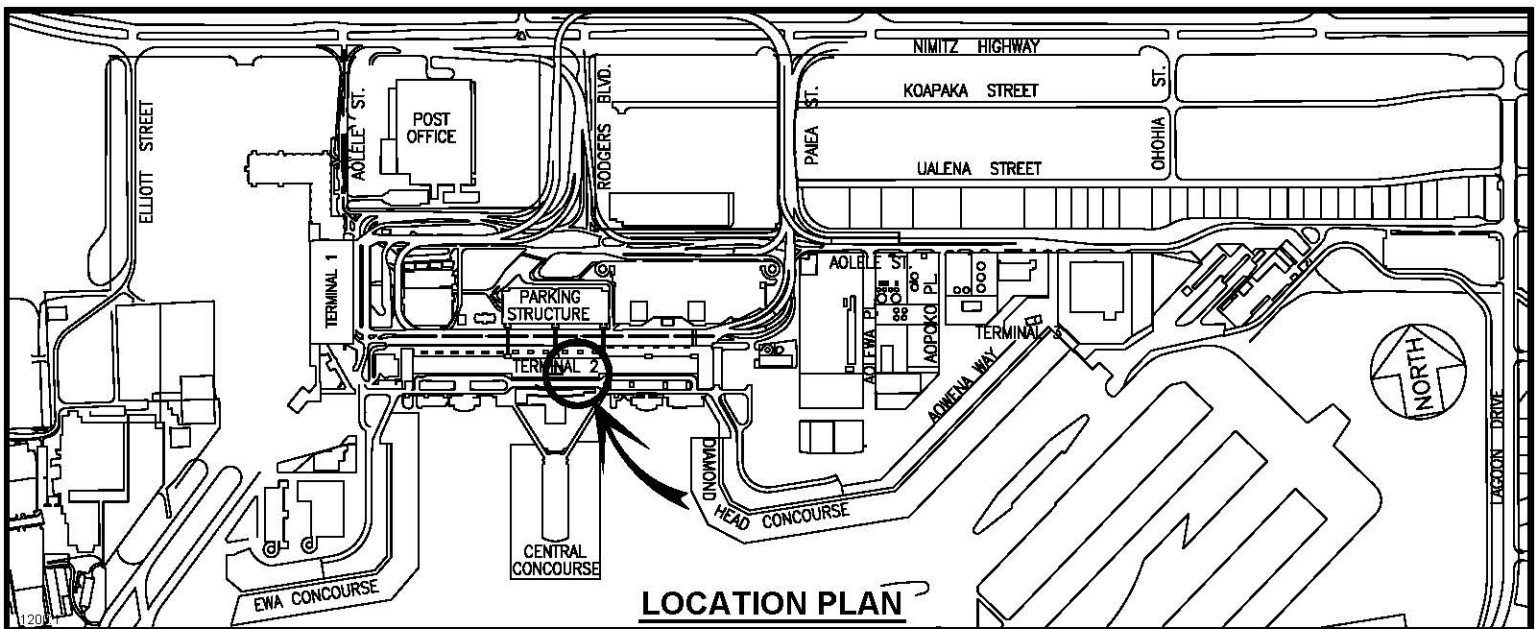

RP-9765

DATE : JUNE 2026

EXHIBIT: **A**



AIRPORTS

AIR NEW ZEALAND

**BUILDING 339
D.H. DOMESTIC BLDG
SECOND LEVEL**

339215A-H

DANIEL K. INOUE INTERNATIONAL AIRPORT

N:\AIRPORTS\HNL_HONOLULU\CAD\PM1_DRAFT\HNL_339215A-01_DRAFT.DWG