

JOSH GREEN, M.D.
GOVERNOR
KE KIA'ĀINA



EDWIN H. SNIFFEN
DIRECTOR
KA LUNA HO'OKELE

Deputy Directors
Nā Hope Luna Ho'okele
DREANALEE K. KALILI
TAMMY L. LEE
CURT T. OTAGURO
ROBIN K. SHISHIDO

STATE OF HAWAI'I | KA MOKU'ĀINA 'O HAWAI'I
DEPARTMENT OF TRANSPORTATION | KA 'OIHANA ALAKAU
AIRPORTS
400 RODGERS BOULEVARD, SUITE 700
HONOLULU, HAWAII 96819-1880

IN REPLY REFER TO:

AIR-PM 26.0385

July 2, 2026

DOT Land Matters
State of Hawaii
Honolulu, Hawaii

ISSUANCE OF A REVOCABLE PERMIT FOR COMMERCIAL USE OF
TWO T-HANGARS FOR STORAGE OF AIRCRAFT AND A MAINTENANCE
HANGAR TO SUPPORT A COMMERCIAL FLIGHT SCHOOL BUSINESS
GOFLY HAWAII LLC
KAWAIHAPAI AIRFIELD, WAIALUA, HAWAII
TAX MAP KEY: (1) 6-8-014:016 (PORTION)

OAHU

APPLICANT:

GOFLY Hawaii LLC, whose mailing address is 480 Airport Road,
Oceanside, California 96791.

LEGAL REFERENCE:

Hawaii Revised Statutes (HRS), Sections 26-19 and 171-2, as amended.

LOCATION AND TAX MAP KEY:

A portion of Kawaihapai Airfield, Waialua, Island of Oahu, State of Hawaii, identified by
Tax Map Key: 1st Division, 6-8-014:016 (portion).

AREA:

Building/Room No. 402-103, containing an area of approximately 1,107 square feet, and
Building/Room No. 402-105, containing an area of approximately 1,202 square feet, as
shown and delineated on the attached map labeled Exhibit A.

ZONING:

State Land Use District: Agriculture
City and County of Honolulu LUO: AG-2

ISSUANCE OF A REVOCABLE PERMIT FOR COMMERCIAL USE OF TWO T-HANGARS FOR STORAGE OF AIRCRAFT AND A MAINTENANCE HANGAR TO SUPPORT A COMMERCIAL FLIGHT SCHOOL BUSINESS

GOFLY HAWAII LLC

Page 2

LAND TITLE STATUS:

Ceded land, which the State of Hawaii is currently leasing the land from the United States of America.

CHARACTER OF USE:

GOFLY Hawaii LLC will use the two T-Hangars for storage of company aircraft (2021 Airborne XT-912 M4, Tail No. N321EZ and 2020 AutoGyro GMBH MTO Sport, Tail No. N808GH) and a maintenance hangar to support a commercial flight school business.

COMMENCEMENT DATE:

To be determined by the Director of Transportation at a later date.

MONTHLY RENTAL:

\$1,085.23 (as determined from the State of Hawaii Department of Transportation (HDOT) Schedule of Rates and Charges Commercial Rate for a T-Hangar, established by appraisal of Airports property statewide).

SECURITY DEPOSIT:

\$3,255.69, or three times the monthly rental in effect.

DCCA VERIFICATION:

Place of business registration confirmed:	YES <u>X</u>	NO ____
Registered business name confirmed:	YES <u>X</u>	NO ____
Good standing confirmed:	YES <u>X</u>	NO ____

CHAPTER 343, HRS - ENVIRONMENTAL ASSESSMENT:

The subject land area is covered by the revised and updated Environmental Assessment for the Dillingham Airfield Master Plan and FAR Part 150 Noise Compatibility Program project, referenced as State Contract No. 26985, State Project No. AO2011-01. This Environmental Assessment evaluated the environmental effects of the recommended Dillingham Airfield Master Plan to meet existing and forecast general aviation demands and was prepared for the HDOT.

ISSUANCE OF A REVOCABLE PERMIT FOR COMMERCIAL USE OF TWO T-HANGARS
FOR STORAGE OF AIRCRAFT AND A MAINTENANCE HANGAR TO SUPPORT A
COMMERCIAL FLIGHT SCHOOL BUSINESS

GOFLY HAWAII LLC

Page 3

REMARKS:

HDOT proposes to issue a month-to-month revocable permit to GOFLY Hawaii LLC, for commercial use of two T-Hangars for storage of company aircraft and a maintenance hangar to support a commercial flight school business.

RECOMMENDATION:

Based on this submittal, and testimony and facts presented, the HDOT recommends the Director of Transportation finds that approving the issuance of a month-to-month revocable permit to GOFLY Hawaii LLC, including its conditions and rent, will serve the best interests of the State.

Respectfully submitted,



CURT T. OTAGURO

Deputy Director of Transportation for Airports

Attachment

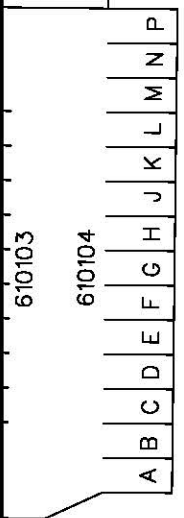
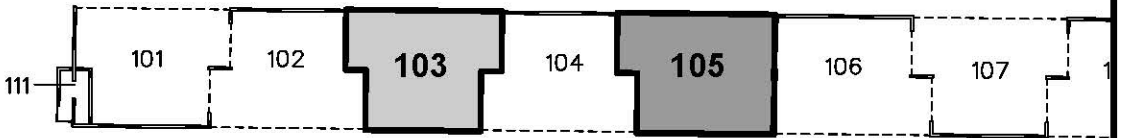
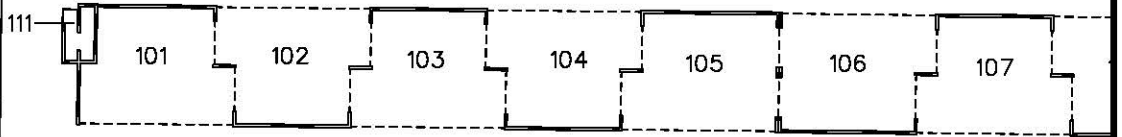
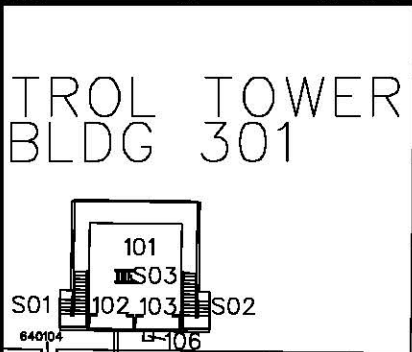
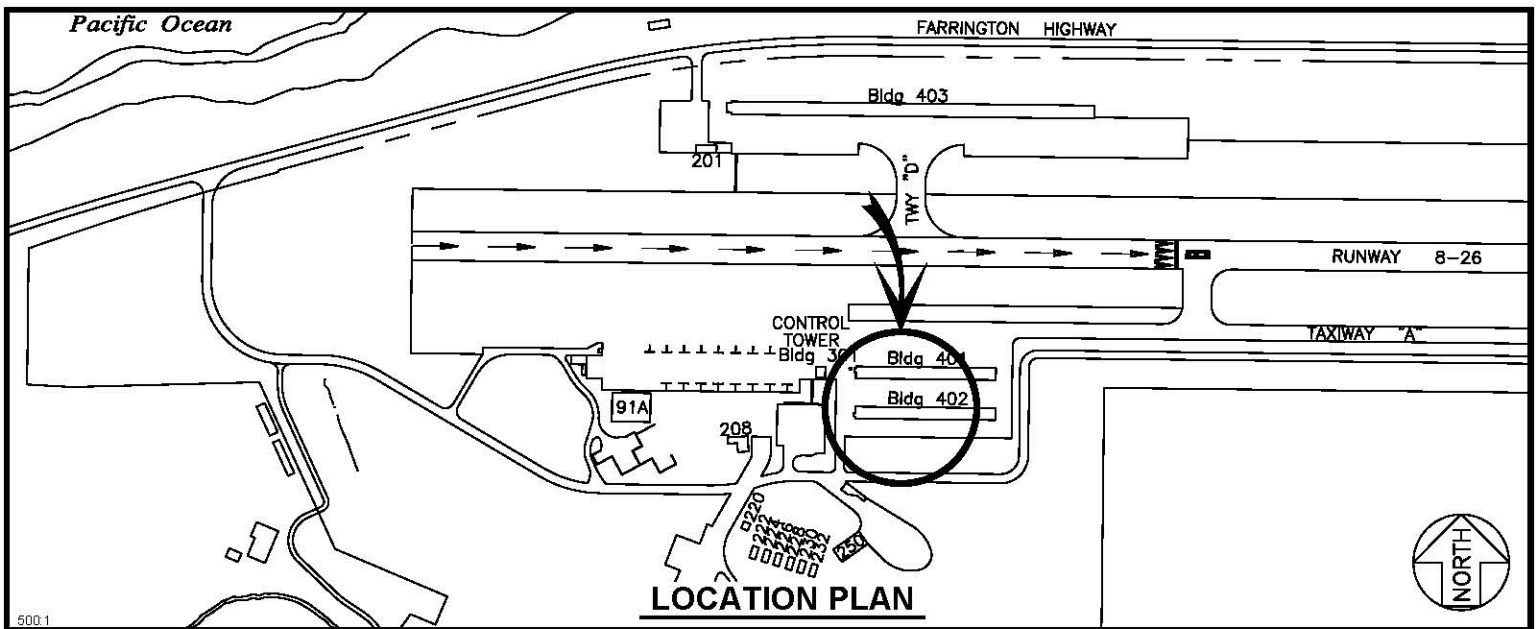

001107B
001107A

00111 SCALE: 1" = 50'

BLDG/ROOM	SQ. FT.
402 103	1,107
402 105	1,202

RP-9798

DATE : APRIL 2026

EXHIBIT: **A**



GOFly HAWAII LLC

BLDG 402
T-HANGAR

402103
402105