

JOSH GREEN, M.D.
GOVERNOR
KE KIA'ĀINA



STATE OF HAWAII | KA MOKU'ĀINA 'O HAWAI'I
DEPARTMENT OF TRANSPORTATION | KA 'OIHANA ALAKAU
AIRPORTS
400 RODGERS BOULEVARD, SUITE 700
HONOLULU, HAWAII 96819-1880

EDWIN H. SNIFFEN
DIRECTOR
KA LUNA HO'OKELE

Deputy Directors
Nā Hope Luna Ho'okele
DREANALEE K. KALILI
TAMMY L. LEE
CURT T. OTAGURO
ROBIN K. SHISHIDO

IN REPLY REFER TO:

AIR-PM 26.0395

July 2, 2026

DOT Land Matters
State of Hawaii
Honolulu, Hawaii

ISSUANCE OF A REVOCABLE PERMIT FOR MAIN TERMINAL
SPACE FOR SIGNATORY AIRLINE CARRIER OPERATIONS
UNITED AIRLINES, INC.
KAHULUI AIRPORT
TAX MAP KEY: (2) 3-8-001: PORTION OF 261

MAUI

APPLICANT:

United Airlines, Inc., P.O. Box 211788, Columbia, South Carolina 29221-6788.

LEGAL REFERENCE:

Hawaii Revised Statutes (HRS), Sections 261-7 and 171-2, as amended.

LOCATION AND TAX MAP KEY:

Portion of Kahului Airport (OGG), Kahului, Island of Maui, identified by
Tax Map Key: 2nd Division, 3-8-001: Portion of 261.

AREA:

Building/Room No. 348-103, containing an area of approximately 1,325 square feet, as
shown and delineated on the attached Exhibit A.

ZONING:

State Land Use District:	Urban
County of Maui:	Airport

ISSUANCE OF A REVOCABLE PERMIT FOR MAIN TERMINAL SPACE FOR
SIGNATORY AIRLINE CARRIER OPERATIONS, UNITED AIRLINES, INC.

Page 2

LAND TITLE STATUS:

Section 5(a) lands of the Hawaii Admission Act: Non-Ceded
DHHL 30% entitlement lands pursuant to Hawaii Admission Act YES ___ NO X

CURRENT USE STATUS:

Land presently encumbered by Governor's Executive Order No. 2427, dated February 12, 1969, setting aside 1,268.938 acres designated as OGG to be under the control and management of the State of Hawaii Department of Transportation (HDOT) for public purposes.

CHARACTER OF USE:

Tech Ops space to support signatory airline carrier operations at OGG.

COMMENCEMENT DATE:

To be determined by the Director of Transportation at a later date.

MONTHLY RENTAL:

\$13,290.85 (based on a rate of \$120.37 per square foot per annum, as determined from the Airports Signatory Rates and Charges, Hawaii Airports System).

SECURITY DEPOSIT:

\$39,872.55, or three times the monthly rental in effect.

DCCA VERIFICATION:

Place of business registration confirmed:	YES <u>X</u>	NO ___
Registered business name confirmed:	YES <u>X</u>	NO ___
Good standing confirmed:	YES <u>X</u>	NO ___

CHAPTER 343, HRS – ENVIRONMENTAL ASSESSMENT:

The HDOT has determined that the subject land area and use is covered by the Kahului Airport Terminal Complex Expansion Negative Declaration, published by the Environmental Quality Commission (EQC) in the September 8, 1981, issue of the EQC Bulletin. Accordingly, all relevant mitigation from the Negative Declaration and best management practices will be implemented to address the minimum impacts of this action.

ISSUANCE OF A REVOCABLE PERMIT FOR MAIN TERMINAL SPACE FOR
SIGNATORY AIRLINE CARRIER OPERATIONS, UNITED AIRLINES, INC.

Page 3

REMARKS:

The HDOT proposes to issue a month-to-month revocable permit to United Airlines, Inc., for tech ops space to support its signatory airline carrier operation at OGG.

RECOMMENDATION:

Based on this submittal, and testimony and facts presented, the HDOT recommends the Director of Transportation finds that approving the issuance of a month-to-month revocable permit to United Airlines, Inc., including its conditions and rent, will serve the best interests of the State.

Respectfully submitted,



CURT T. OTAGURO

Deputy Director of Transportation for Airports

Attachment

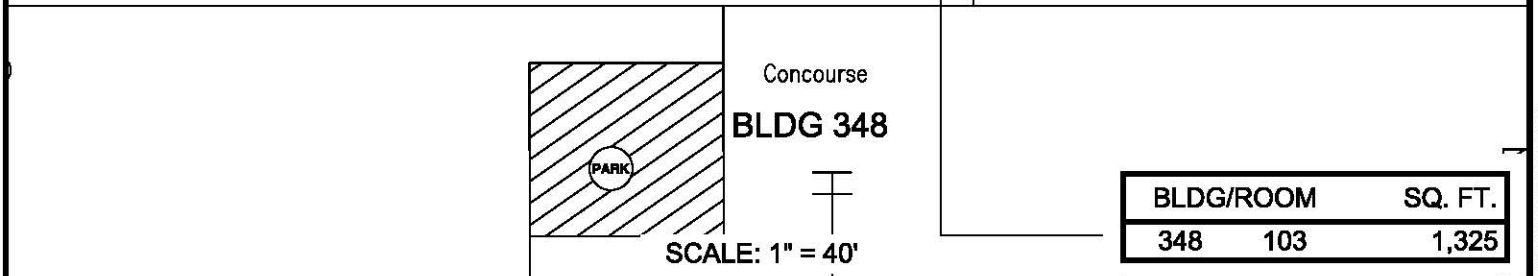
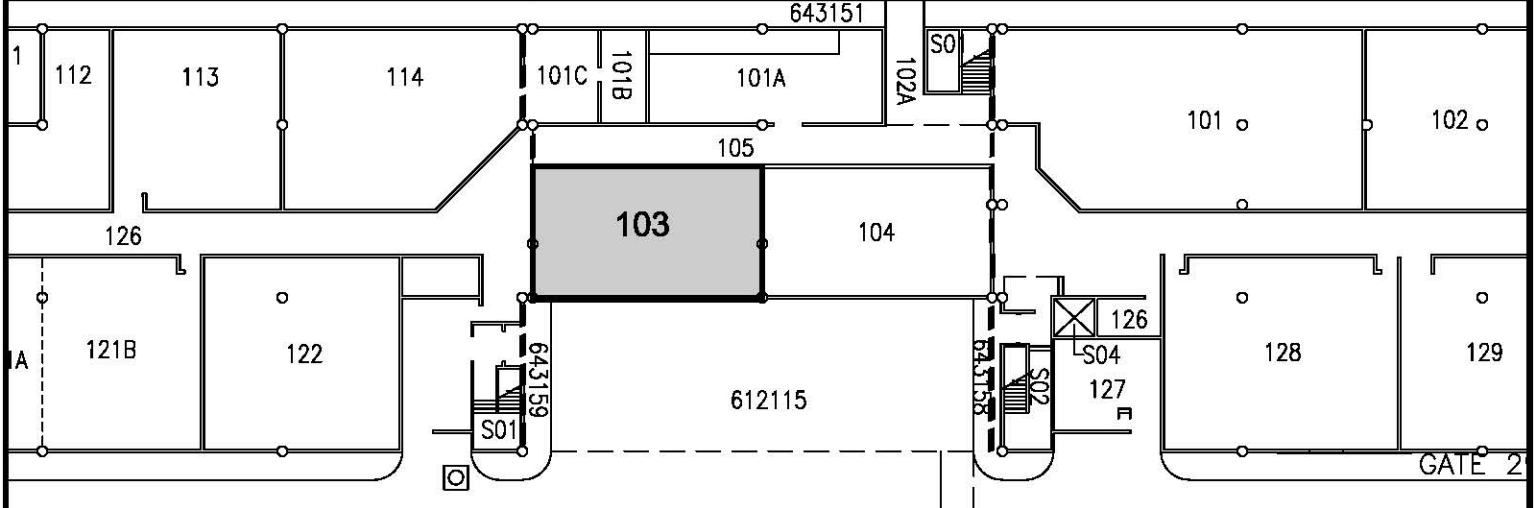
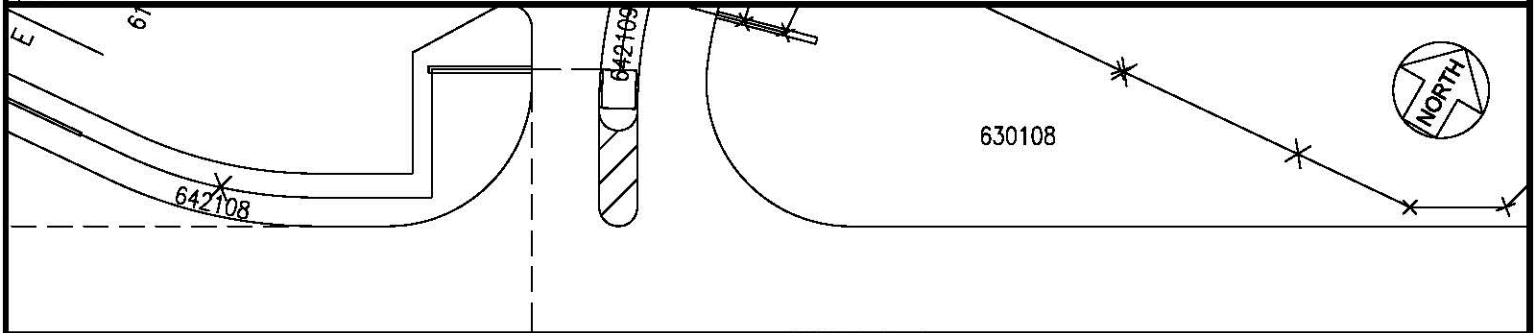
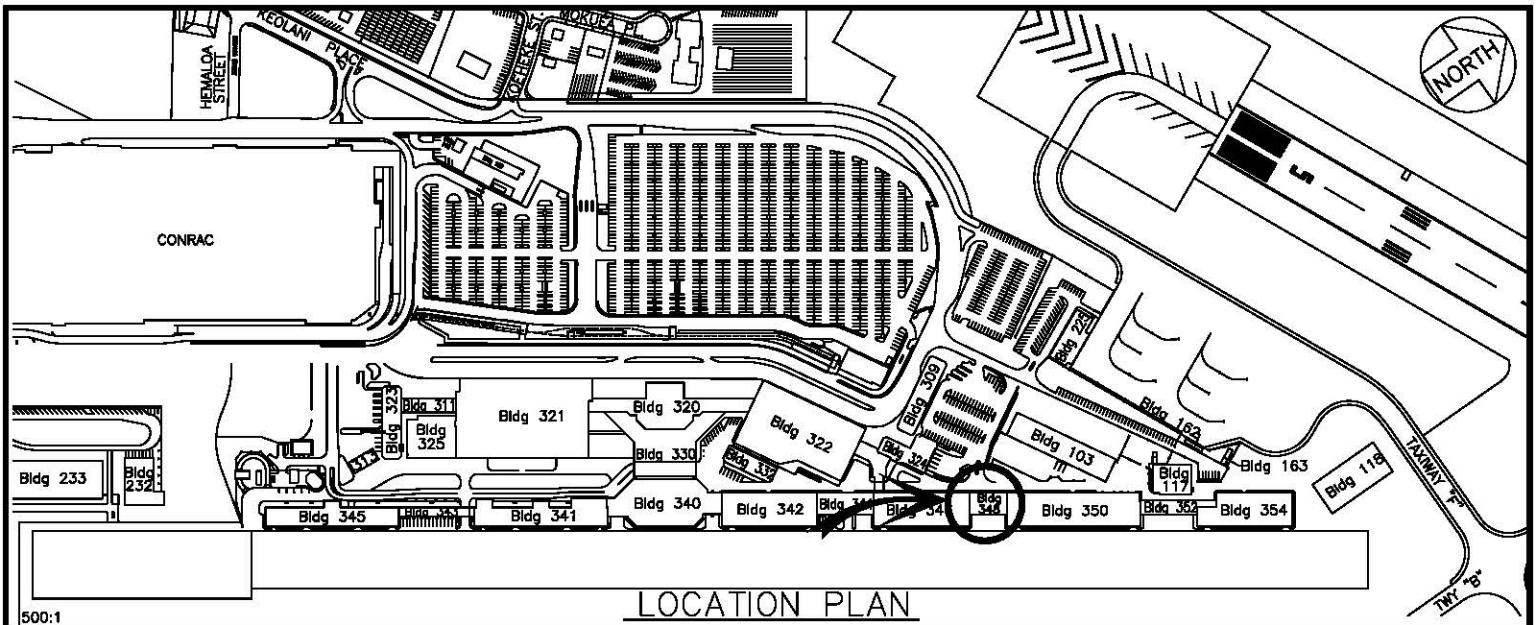

RP-9796

DATE : MARCH 2025

EXHIBIT: **A**



AIRPORTS

UNITED AIRLINES, INC.

**BUILDING 348
CONCOURSE
GROUND LEVEL**

348103

KAHULUI AIRPORT