

JOSH GREEN, M.D.  
GOVERNOR  
KE KIA'ĀINA



**STATE OF HAWAII | KA MOKU'ĀINA 'O HAWAII'**  
**DEPARTMENT OF TRANSPORTATION | KA 'OIHANA ALAKAU**  
**AIRPORTS**  
400 RODGERS BOULEVARD, SUITE 700  
HONOLULU, HAWAII 96819-1880

EDWIN H. SNIFFEN  
DIRECTOR  
KA LUNA HO'OKELE

Deputy Directors  
Nā Hope Luna Ho'okele  
DREANALEE K. KALILI  
TAMMY L. LEE  
CURT T. OTAGURO  
ROBIN K. SHISHIDO

IN REPLY REFER TO:

**AIR-PM 26.0400**

July 2, 2026

DOT Land Matters  
State of Hawaii  
Honolulu, Hawaii

ISSUANCE OF A REVOCABLE PERMIT FOR PARTS STORAGE  
FOR SIGNATORY AIRLINE CARRIER OPERATIONS  
UNITED AIRLINES, INC.  
KAHULUI AIRPORT  
TAX MAP KEY: (2) 3-8-001: PORTION OF 261

MAUI

APPLICANT:

United Airlines, Inc., P.O. Box 211788, Columbia, South Carolina 29221-6788.

LEGAL REFERENCE:

Hawaii Revised Statutes (HRS), Sections 261-7 and 171-2, as amended.

LOCATION AND TAX MAP KEY:

Portion of Kahului Airport (OGG), Kahului, Island of Maui, identified by  
Tax Map Key: 2nd Division, 3-8-001: Portion of 261.

AREA:

Building/Room No. 348-101A, containing an area of approximately 442 square feet, as  
shown and delineated on the attached Exhibit A.

ZONING:

State Land Use District:	Urban
County of Maui:	Airport

ISSUANCE OF A REVOCABLE PERMIT FOR PARTS STORAGE FOR SIGNATORY AIRLINE CARRIER OPERATIONS, UNITED AIRLINES, INC.

Page 2

LAND TITLE STATUS:

Section 5(a) lands of the Hawaii Admission Act: Non-Ceded  
DHHL 30% entitlement lands pursuant to Hawaii Admission Act YES \_\_\_ NO X

CURRENT USE STATUS:

Land presently encumbered by Governor's Executive Order No. 2427, dated February 12, 1969, setting aside 1,268.938 acres designated as OGG to be under the control and management of the State of Hawaii Department of Transportation (HDOT) for public purposes.

CHARACTER OF USE:

Parts storage to support signatory airline carrier operations at OGG.

COMMENCEMENT DATE:

To be determined by the Director of Transportation at a later date.

MONTHLY RENTAL:

\$4,433.63 (based on a rate of \$120.37 per square foot per annum, as determined from the Airports Signatory Rates and Charges, Hawaii Airports System).

SECURITY DEPOSIT:

\$13,300.89, or three times the monthly rental in effect.

DCCA VERIFICATION:

Place of business registration confirmed:	YES <u>X</u>	NO ___
Registered business name confirmed:	YES <u>X</u>	NO ___
Good standing confirmed:	YES <u>X</u>	NO ___

CHAPTER 343, HRS – ENVIRONMENTAL ASSESSMENT:

The HDOT has determined that the subject land area and use is covered by the Kahului Airport Terminal Complex Expansion Negative Declaration, published by the Environmental Quality Commission (EQC) in the September 8, 1981, issue of the EQC Bulletin. Accordingly, all relevant mitigation from the Negative Declaration and best management practices will be implemented to address the minimum impacts of this action.

ISSUANCE OF A REVOCABLE PERMIT FOR PARTS STORAGE FOR SIGNATORY  
AIRLINE CARRIER OPERATIONS, UNITED AIRLINES, INC.

Page 3

REMARKS:

The HDOT proposes to issue a month-to-month revocable permit to United Airlines, Inc., for parts storage to support its signatory airline carrier operation at OGG.

RECOMMENDATION:

Based on this submittal, and testimony and facts presented, the HDOT recommends the Director of Transportation finds that approving the issuance of a month-to-month revocable permit to United Airlines, Inc., including its conditions and rent, will serve the best interests of the State.

Respectfully submitted,



CURT T. OTAGURO  
Deputy Director of Transportation for Airports

Attachment

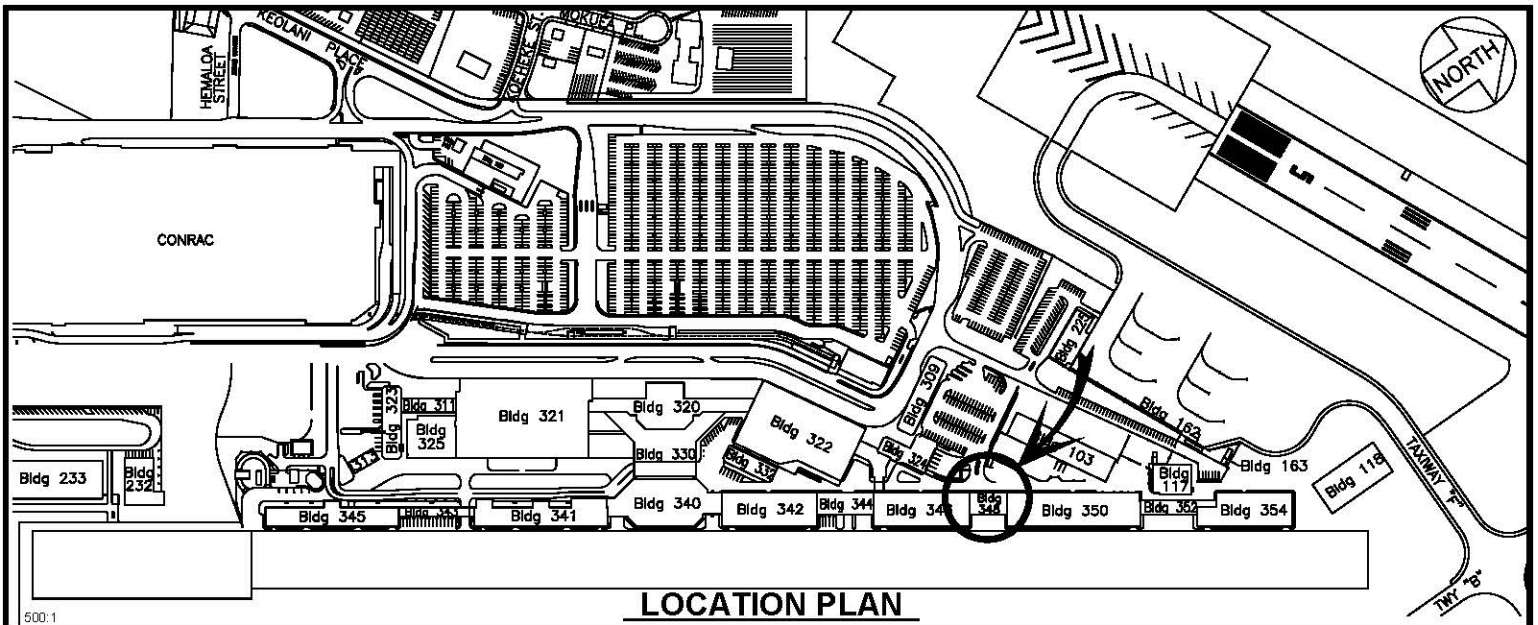

**LOCATION PLAN**

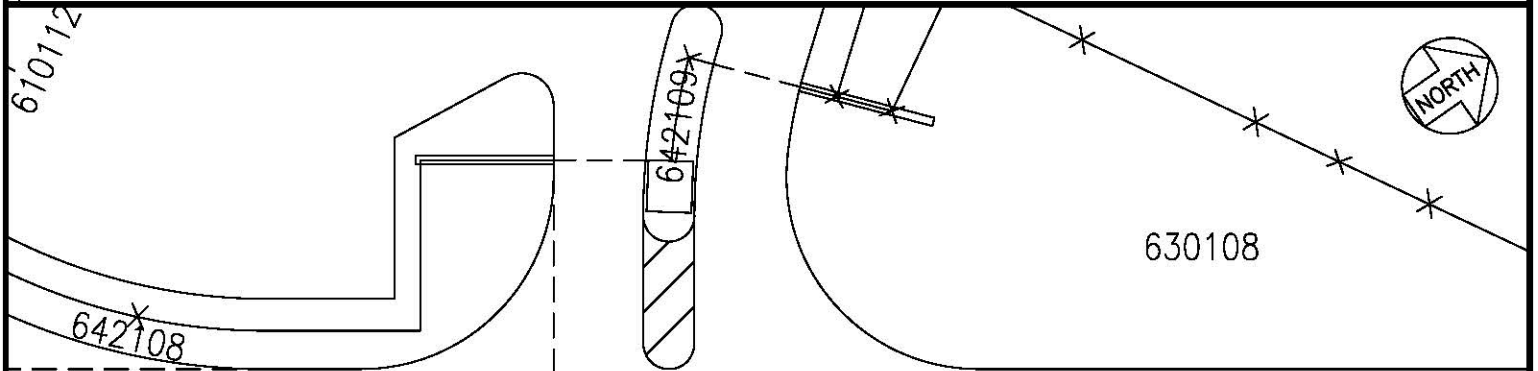

**BLDG 348**

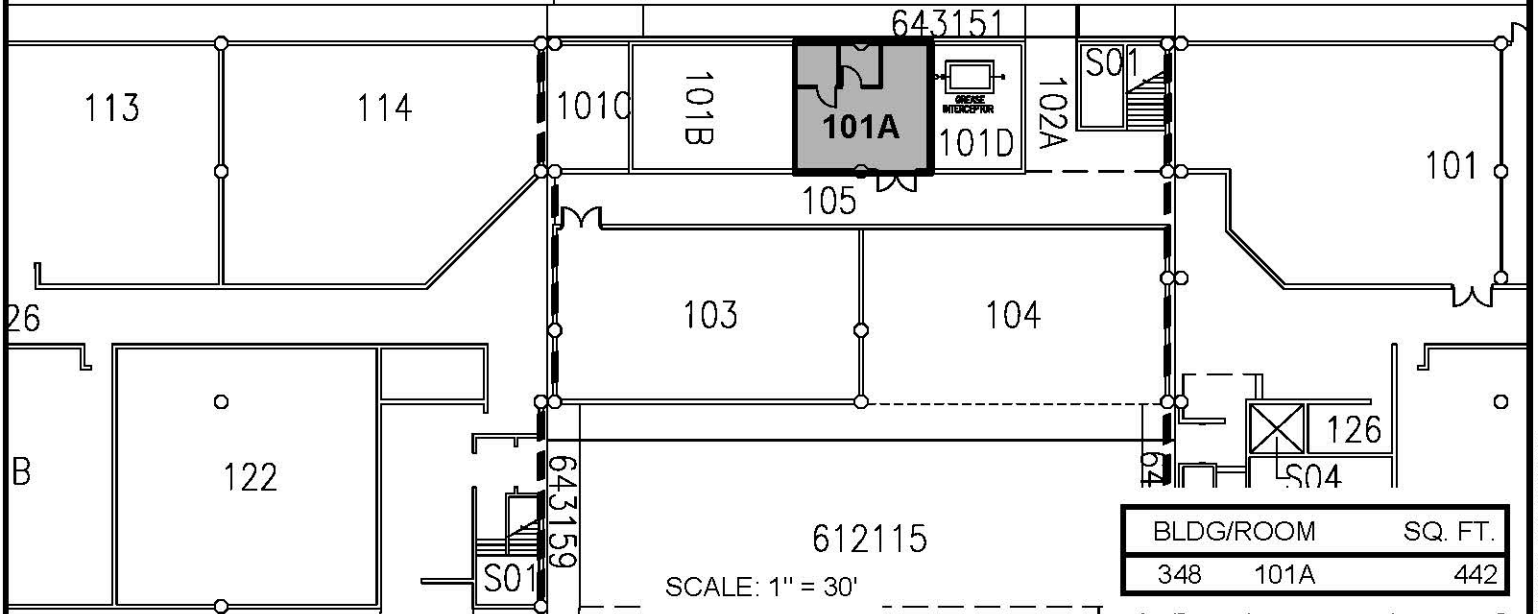

RP-9797

DATE : MARCH 2026

EXHIBIT: **A**



UNITED AIRLINES, INC.

BLDG 348  
COUNCOURSE  
GROUND LEVEL

348101A