

JOSH GREEN, M.D.
GOVERNOR
KE KIA'ĀINA



STATE OF HAWAII | KA MOKU'ĀINA 'O HAWAII'
DEPARTMENT OF TRANSPORTATION | KA 'OIHANA ALAKAU
AIRPORTS
400 RODGERS BOULEVARD, SUITE 700
HONOLULU, HAWAII 96819-1880

EDWIN H. SNIFFEN
DIRECTOR
KA LUNA HO'OKELE

Deputy Directors
Nā Hope Luna Ho'okele
DREANALEE K. KALILI
TAMMY L. LEE
CURT T. OTAGURO
ROBIN K. SHISHIDO

IN REPLY REFER TO:

AIR-PM 26.0369

July 2, 2026

DOT Land Matters
State of Hawaii
Honolulu, Hawaii

ISSUANCE OF A REVOCABLE PERMIT
FOR FIXED-WING AIRCRAFT PARKING
AIR VENTURES HAWAII, LLC
LIHUE AIRPORT
TAX MAP KEY: (4) 3-5-001: PORTION OF 008

KAUAI

REQUEST:

Issuance of a Revocable Permit for Aircraft Parking (Parking Permit) to Air Ventures Hawaii, LLC, situated at Lihue Airport.

APPLICANT:

Air Ventures Hawaii, LLC, whose mailing address is P.O. Box 71, Lihue, Hawaii 96753.

LEGAL REFERENCE:

Hawaii Revised Statutes (HRS), Sections 261-2 and 171-2, as amended.

LOCATION AND TAX MAP KEY:

Portion of Lihue Airport (LIH), Lihue, Island of Kauai, identified by Tax Map Key: 4th Division, 3-5-001: Portion of 008.

AREA:

Area/Space No. 408-109, containing an area of approximately 990 square feet, Area/Space No. 408-110, containing an area of approximately 990 square feet, and Area/Space No. 408-112, containing an area of approximately 990 square feet, as shown and delineated on the attached Exhibit A.

ISSUANCE OF A REVOCABLE PERMIT FOR FIXED-WING AIRCRAFT PARKING
AIR VENTURES HAWAII, LLC
Page 2

ZONING:

State Land Use District: Urban
County of Kauai: Airport

LAND TITLE STATUS:

Section 5(a) lands of the Hawaii Admission Act: Non-Ceded
DHHL 30% entitlement lands pursuant to Hawaii Admission Act YES ___ NO X

CURRENT USE STATUS:

Land presently encumbered by Governor's Executive Order No. 4614, dated October 28, 2019, setting aside 883.583 acres designated as LIH to be under the control and management of the State of Hawaii Department of Transportation (HDOT) for Airport purposes.

CHARACTER OF USE:

Fixed-wing aircraft (Gippsland Aeronautics GA 8, N588AV, N822AV, and N721AV) tie-downs.

COMMENCEMENT DATE:

To be determined by the Director of Transportation at a later date.

MONTHLY RENTAL:

\$390.00 (as determined from the HDOT Schedule of Rates and Charges established by appraisal of Airports property statewide).

SECURITY DEPOSIT:

\$1,170.00, or three times the monthly rental in effect.

CHAPTER 343, HRS - ENVIRONMENTAL ASSESSMENT:

The HDOT has determined that the environmental impacts of the proposed tenant use for the subject land use is covered by the Lihue Airport Master Plan Environmental Impact Statement (EIS), published by the Environmental Quality Commission (EQC) in the August 8, 1976 and August 23, 1976, issues of EQC Bulletin and accepted by the Governor on April 26, 1977. Accordingly, all relevant mitigation from the EIS and best management practices will be implemented to address the minimum impacts of this action.

ISSUANCE OF A REVOCABLE PERMIT FOR FIXED-WING AIRCRAFT PARKING
AIR VENTURES HAWAII, LLC

Page 3

REMARKS:

The HDOT proposes to issue a month-to-month Parking Permit to Air Ventures Hawaii, LLC for fixed-wing aircraft parking at LIH.

RECOMMENDATION:

Based on this submittal, and testimony and facts presented, the HDOT recommends the Director of Transportation finds that approving the issuance of a month-to-month Parking Permit to Air Ventures Hawaii, LLC, including its conditions and rent, will serve the best interests of the State.

Respectfully submitted,



CURT T. OTAGURO
Deputy Director of Transportation for Airports

Attachment

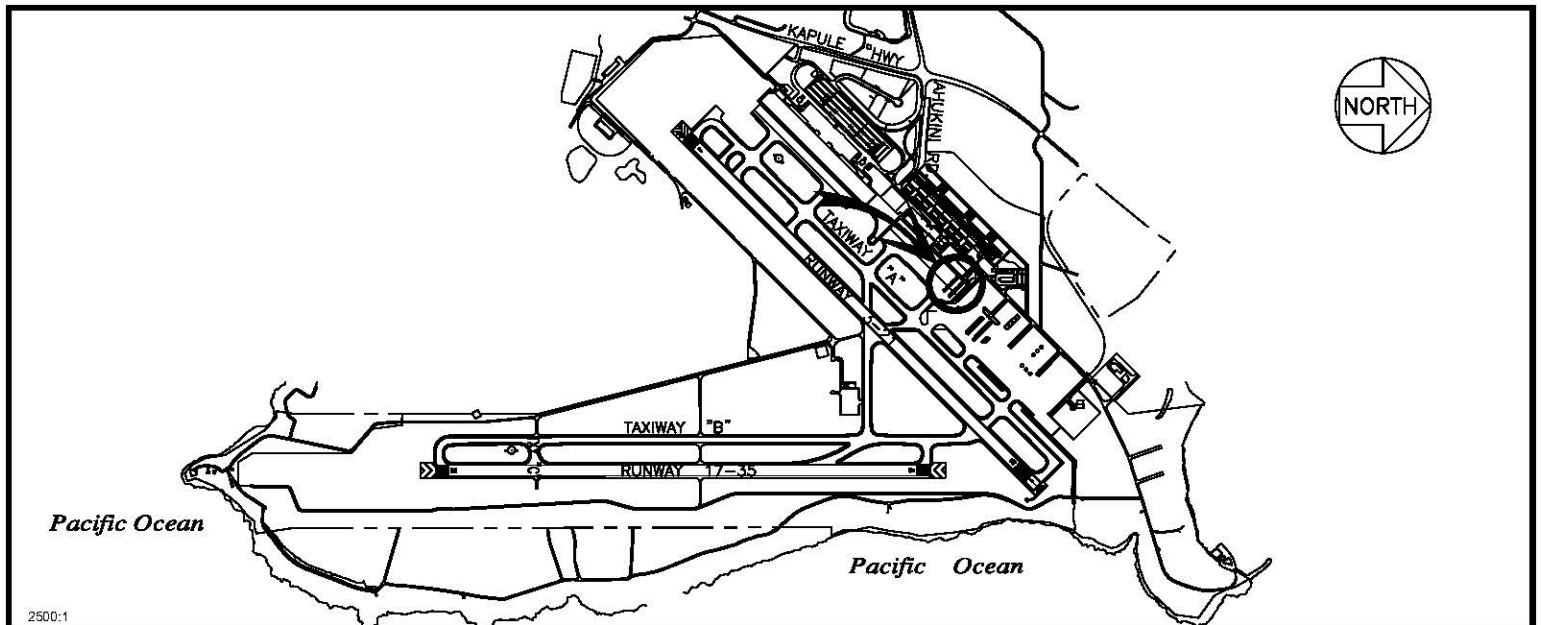

2500:1

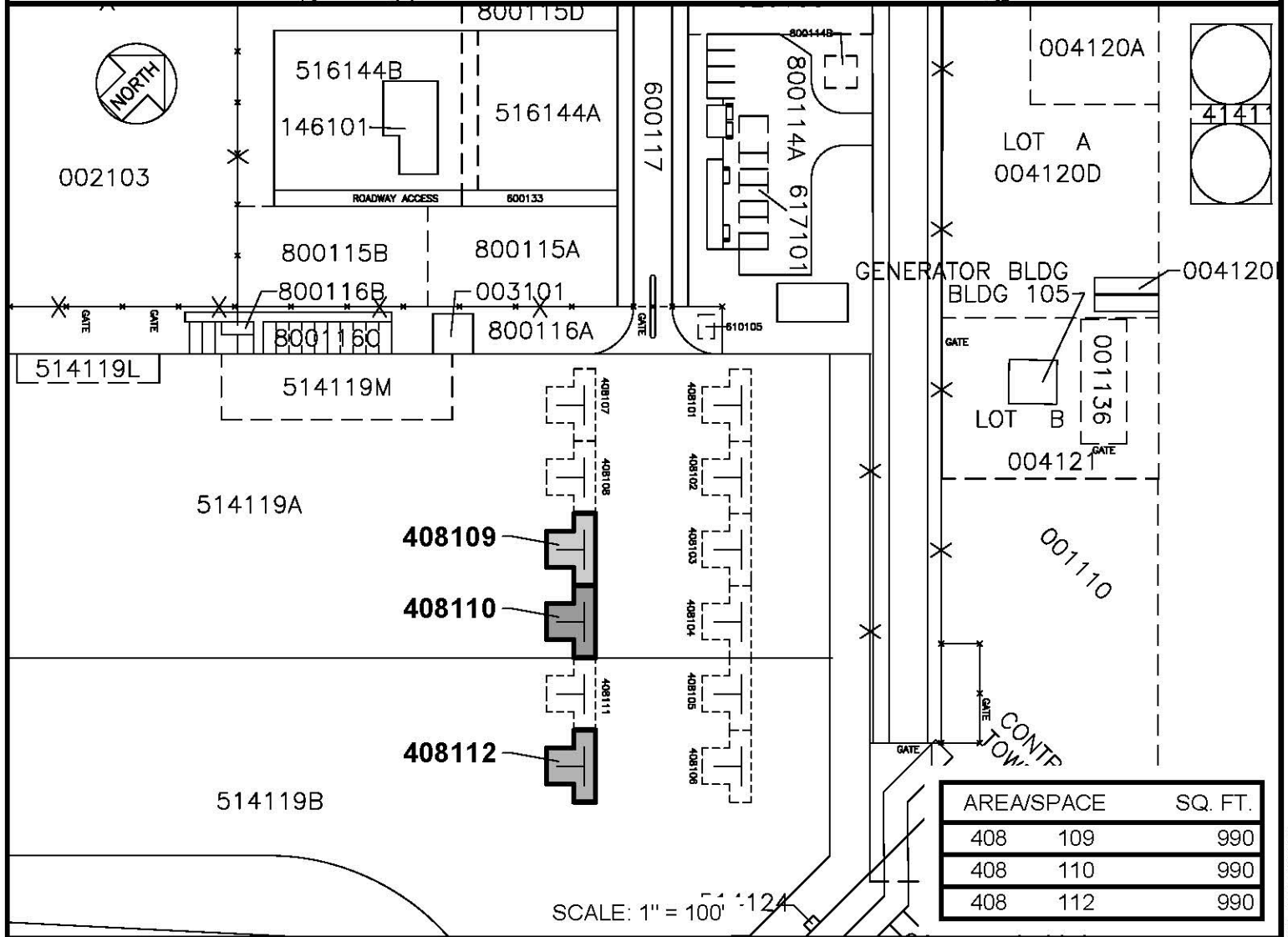

AREA/SPACE	SQ. FT.
408 109	990
408 110	990
408 112	990

SCALE: 1" = 100'

PP-26-K005 DATE: MAY 2026 EXHIBIT: A

	AIRPORTS	AIR VENTURES HAWAII, LLC	TIE-DOWNS	408109
				408110
				408112

LIHUE AIRPORT

N:\AIRPORTS\LIHUE\CAD\PP\LIHUE_408109-01.DWG