



**STATE OF HAWAII | KA MOKU'ĀINA 'O HAWAII'**  
**DEPARTMENT OF TRANSPORTATION | KA 'OIHANA ALAKAU**  
**AIRPORTS**  
400 RODGERS BOULEVARD, SUITE 700  
HONOLULU, HAWAII 96819-1880

AIR-PM 26.0410

July 2, 2026

DOT Land Matters  
State of Hawaii  
Honolulu, Hawaii

ISSUANCE OF A REVOCABLE PERMIT FOR IMPROVED, PAVED LAND AND  
IMPROVED, UNPAVED LAND FOR PARKING OF DELIVERY VEHICLES  
FLYING FOOD GROUP, LLC  
LIHUE AIRPORT  
TAX MAP KEY: (4) 3-5-001: PORTION OF 008

KAUAI

APPLICANT:

Flying Food Group, LLC (FFG), 324 Rodgers Boulevard, Suite C,  
Honolulu, Hawaii 96819.

LEGAL REFERENCE:

Hawaii Revised Statutes (HRS), Sections 261-7 and 171-2, as amended.

LOCATION AND TAX MAP KEY:

Portion of Lihue Airport (LIH), Lihue, Island of Kauai, identified by  
Tax Map Key: 4th Division, 3-5-001: Portion of 008.

AREA:

**IMPROVED, PAVED LAND**

Area/Space No. 610-104B, containing an area of approximately 252 square feet,  
Area/Space No. 610-104C, containing an area of approximately 252 square feet,  
Area/Space No. 610-104D, containing an area of approximately 252 square feet, and  
Area/Space No. 610-104E, containing an area of approximately 252 square feet, as  
shown and delineated on the attached map labeled Exhibit A.

ISSUANCE OF A REVOCABLE PERMIT FOR IMPROVED, PAVED LAND AND  
IMPROVED, UNPAVED LAND FOR PARKING OF DELIVERY VEHICLES  
FLYING FOOD GROUP, LLC

Page 2

**IMPROVED, UNPAVED LAND**

Area/Space No. 820-142, containing an area of approximately 5,250 square feet, as shown and delineated on the attached map labeled Exhibit B.

ZONING:

State Land Use District: Urban  
County of Kauai: Industrial General/Special Treatment-Public Use (IG/ST-P)

LAND TITLE STATUS:

Section 5(a) lands of the Hawaii Admission Act: Non-Ceded  
DHHL 30% entitlement lands pursuant to Hawaii Admission Act YES \_\_\_ NO X

CURRENT USE STATUS:

Land presently encumbered by Governor's Executive Order No. 4614, dated October 28, 2019, setting aside 883.583 acres designated as LIH to be under the control and management of the State of Hawaii Department of Transportation (HDOT) for Airport purposes.

CHARACTER OF USE:

FFG will use the space for parking of delivery vehicles as part of its in-flight catering operation at LIH.

COMMENCEMENT DATE:

To be determined by the Director of Transportation at a later date.

MONTHLY RENTAL:

\$1,267.00 (based on a rate of \$3.00 per square foot per annum for improved, paved land and \$2.32 per square foot per annum for improved, unpaved land, as determined from the HDOT schedule of rates and charges established by appraisal of Airports property statewide).

SECURITY DEPOSIT:

\$3,801.00, or three times the monthly rental in effect.

ISSUANCE OF A REVOCABLE PERMIT FOR IMPROVED, PAVED LAND AND  
IMPROVED, UNPAVED LAND FOR PARKING OF DELIVERY VEHICLES  
FLYING FOOD GROUP, LLC

Page 3

DCCA VERIFICATION:

Place of business registration confirmed:	YES <input checked="" type="checkbox"/>	NO <input type="checkbox"/>
Registered business name confirmed:	YES <input checked="" type="checkbox"/>	NO <input type="checkbox"/>
Good standing confirmed:	YES <input checked="" type="checkbox"/>	NO <input type="checkbox"/>

CHAPTER 343, HRS - ENVIRONMENTAL ASSESSMENT:

The HDOT has determined that the environmental impacts of the proposed tenant use for the subject land use is covered by the Lihue Airport Master Plan Environmental Impact Statement (EIS), published by the Environmental Quality Commission (EQC) in the August 8, 1976 and August 23, 1976, issues of EQC Bulletin and accepted by the Governor on April 26, 1977. Accordingly, all relevant mitigation from the EIS and best management practices will be implemented to address the minimum impacts of this action.

REMARKS:

The HDOT proposes to issue a month-to-month revocable permit to FFG for parking of delivery vehicles as part of its in-flight catering service operations at LIH.

RECOMMENDATION:

Based on this submittal, and testimony and facts presented, the HDOT recommends the Director of Transportation finds that approving the issuance of a month-to-month revocable permit to FFG, including its conditions and rent, will serve the best interests of the State.

Respectfully submitted,



CURT T. OTAGURO

Deputy Director of Transportation for Airports

Attachment



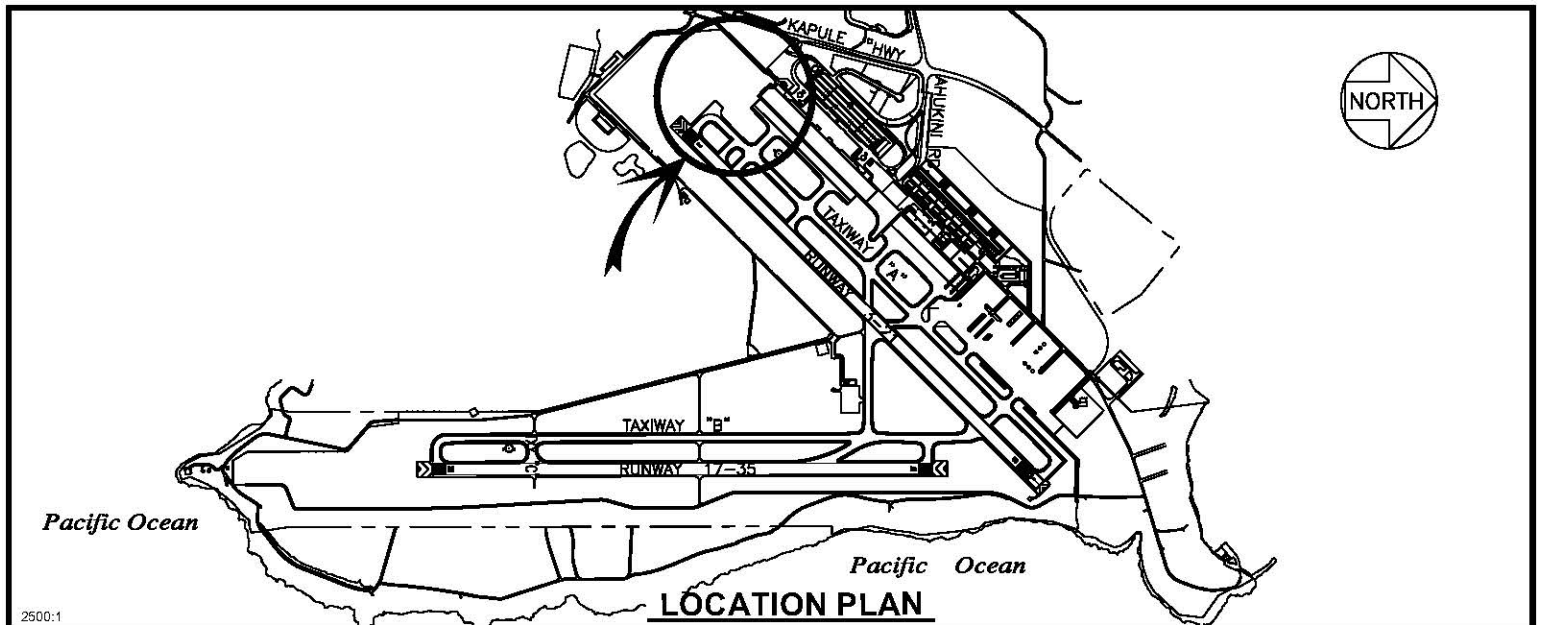

2500:1

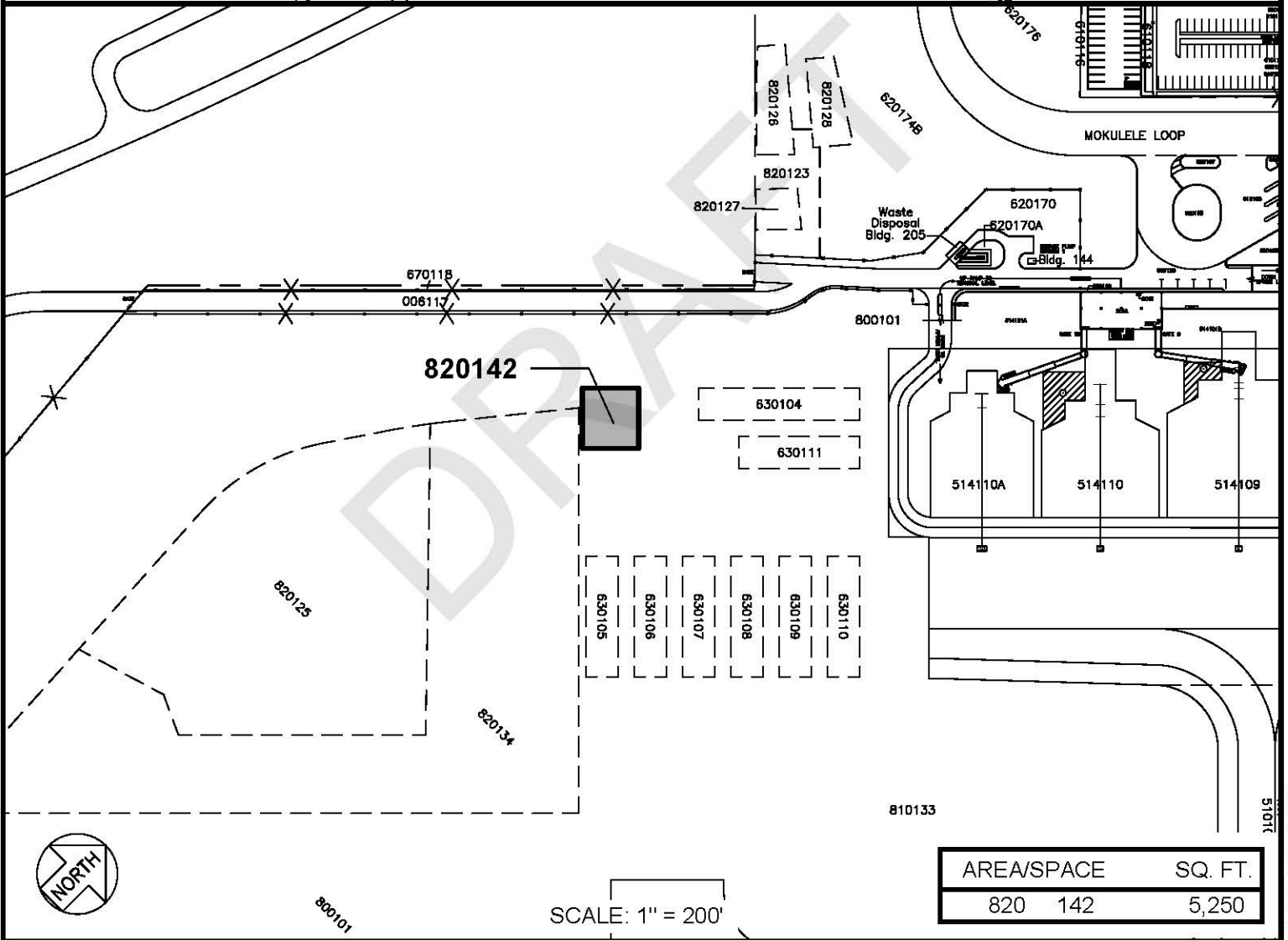

AREA/SPACE	SQ. FT.
820 142	5,250

DRAFT for RP-9811

DATE : APRIL 2026

EXHIBIT: **B**

<p><b>AIRPORTS</b></p>	<p><b>FLYING FOOD GROUP, LLC</b></p>	<p><b>LAND, UNIMPROVED, ASSIGNABLE</b></p>	<p><b>820142</b></p>
------------------------	--------------------------------------	--	----------------------

**LIHUE AIRPORT**

N:\AIRPORTS\LIHUE\CAD\PM\LIH\_820142-01\_DRAFT.DWG