

JOSH GREEN, M.D.
GOVERNOR
KE KIA'ĀINA



STATE OF HAWAII | KA MOKU'ĀINA 'O HAWAII'
DEPARTMENT OF TRANSPORTATION | KA 'OIHANA ALAKAU
AIRPORTS
400 RODGERS BOULEVARD, SUITE 700
HONOLULU, HAWAII 96819-1880

EDWIN H. SNIFFEN
DIRECTOR
KA LUNA HO'OKELE

Deputy Directors
Nā Hope Luna Ho'okele
DREANALEE K. KALILI
TAMMY L. LEE
CURT T. OTAGURO
ROBIN K. SHISHIDO

IN REPLY REFER TO:

AIR-PM 26.0412

July 2, 2026

DOT Land Matters
State of Hawaii
Honolulu, Hawaii

ISSUANCE OF A REVOCABLE PERMIT TO
THEOLA KAAE DBA PUA MELIA LEI STAND
DANIEL K. INOUE INTERNATIONAL AIRPORT
TAX MAP KEY: (1) 1-1-003:001 (PORTION)

OAHU

APPLICANT:

Theola Kaae dba Pua Melia Lei Stand, whose business address is
300 Rodgers Boulevard, Lei Stand #12, Honolulu, Hawaii 96819

LEGAL REFERENCE:

Hawaii Revised Statutes (HRS), Sections 102-2 and 26-19, as amended.

LOCATION AND TAX MAP KEY:

A portion of Building 302 of Daniel K. Inouye International Airport (Airport), Island of
Oahu, State of Hawaii, identified by Tax Map Key: 1st Division, 1-1-003:001 (Portion).

AREA:

Building/Room No. 302-105, containing an area of approximately 351 square feet,
Building/Room No. 302-115, containing an area of approximately 117 square feet, and
Building/Room No. 302-116, containing an area of approximately 64 square feet, as
shown and delineated on the attached maps labeled Exhibit A.

ZONING:

State Land Use District: Urban
City and County of Honolulu: Industrial (I-2)

ISSUANCE OF A REVOCABLE PERMIT TO
THEOLA KAAE DBA PUA MELIA LEI STAND
Page 2

LAND TITLE STATUS:

Section 5(a) lands of the Hawaii Admission Act: Non-Ceded
DHHL 30% entitlement lands pursuant to Hawaii Admission Act YES ___ NO X

CURRENT USE STATUS:

Land encumbered by Governor's Executive Order No. 3201, dated June 8, 1983, setting aside 3,152.177 acres designated as the Airport under the control and management of the State of Hawaii Department of Transportation (HDOT), for Airport purposes.

CHARACTER OF USE:

The premises will be used to sew and sell fresh flower leis and flowers.

COMMENCEMENT DATE:

To be determined by the Director of Transportation at a later date.

MONTHLY RENTAL:

Based on the HDOT Schedule of Rates and Charges.

Lei Stand: \$351.00 or 10% of the monthly gross receipts, whichever is greater.
Large Storage Fee: \$117.00
Small Storage Fee: \$ 64.00

Total Monthly Rent: \$468.00 for large storage or \$415.00 for small storage.

SECURITY DEPOSIT:

\$1,404.00 or three times the monthly rental in effect (large storage).
\$1,245.00 or three times the monthly rental in effect (small storage).

DCCA VERIFICATION:

Place of business registration confirmed: YES X NO ___
Registered business name confirmed: YES X NO ___
Good standing confirmed: YES X NO ___

ISSUANCE OF A REVOCABLE PERMIT TO
THEOLA KAAE DBA PUA MELIA LEI STAND
Page 3

CHAPTER 343, HRS - ENVIRONMENTAL ASSESSMENT:

The environmental impacts of the proposed action to the subject land area are covered by the Honolulu International Airport Master Plan Update and Noise Compatibility Program Environmental Assessment (EA), State Project No. AO1011-03. The EA is a joint State and Federal document, dated September 1989 and published on October 23, 1989, issue of the OEQC Bulletin. Accordingly, relevant mitigation from the EA and HDOT best environmental management practice will address minimal impacts from this action.

REMARKS:

The HDOT proposes to issue a month-to-month revocable permit to Theola Kaae dba Pua Melia Lei Stand, for the sale of fresh flower leis and flowers.

RECOMMENDATION:

Based on this submittal, and testimony and facts presented, the HDOT recommends that the Director of Transportation finds that approving the issuance of a month-to-month revocable permit to Theola Kaae dba Pua Melia Lei Stand, including its conditions and rent, will serve the best interests of the State.

Respectfully submitted,



CURT T. OTAGURO
Deputy Director of Transportation for Airports

Attachment

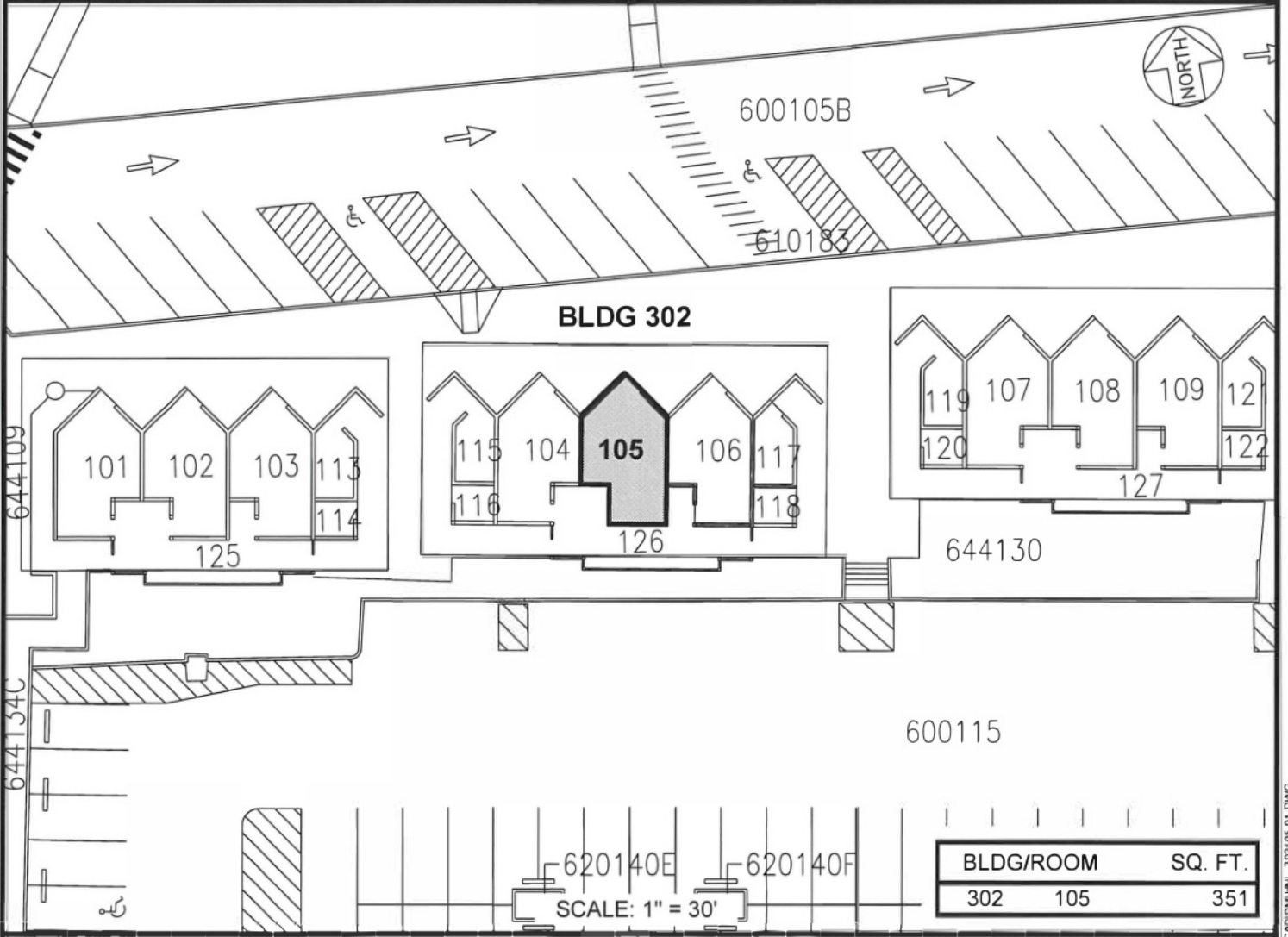
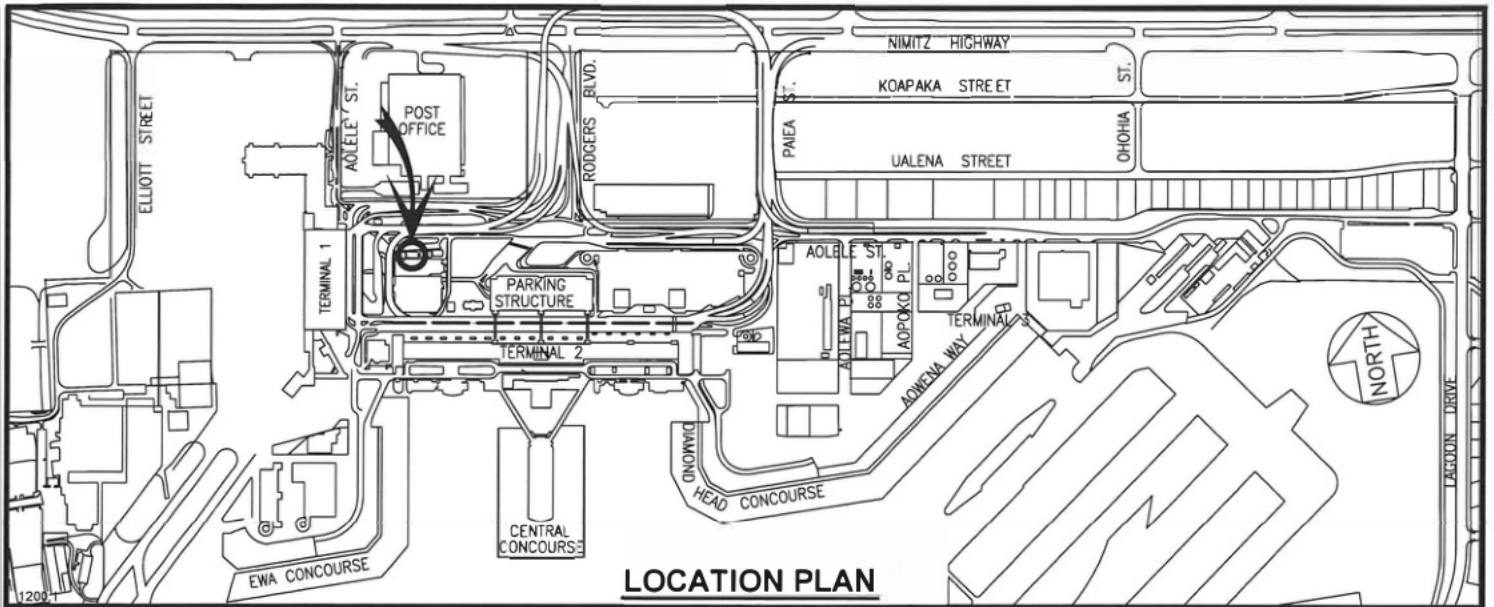

DATE : JUNE 2026

EXHIBIT: **A**



AIRPORTS

HNL LEI STANDS

BUILDING 302
LEI STAND
GROUND LEVEL

302105

DANIEL K. INOUE INTERNATIONAL AIRPORT

N:\AIRPORT\SHNL_HONOLULU\CD\PI\M\HNL_302105.01.DWG

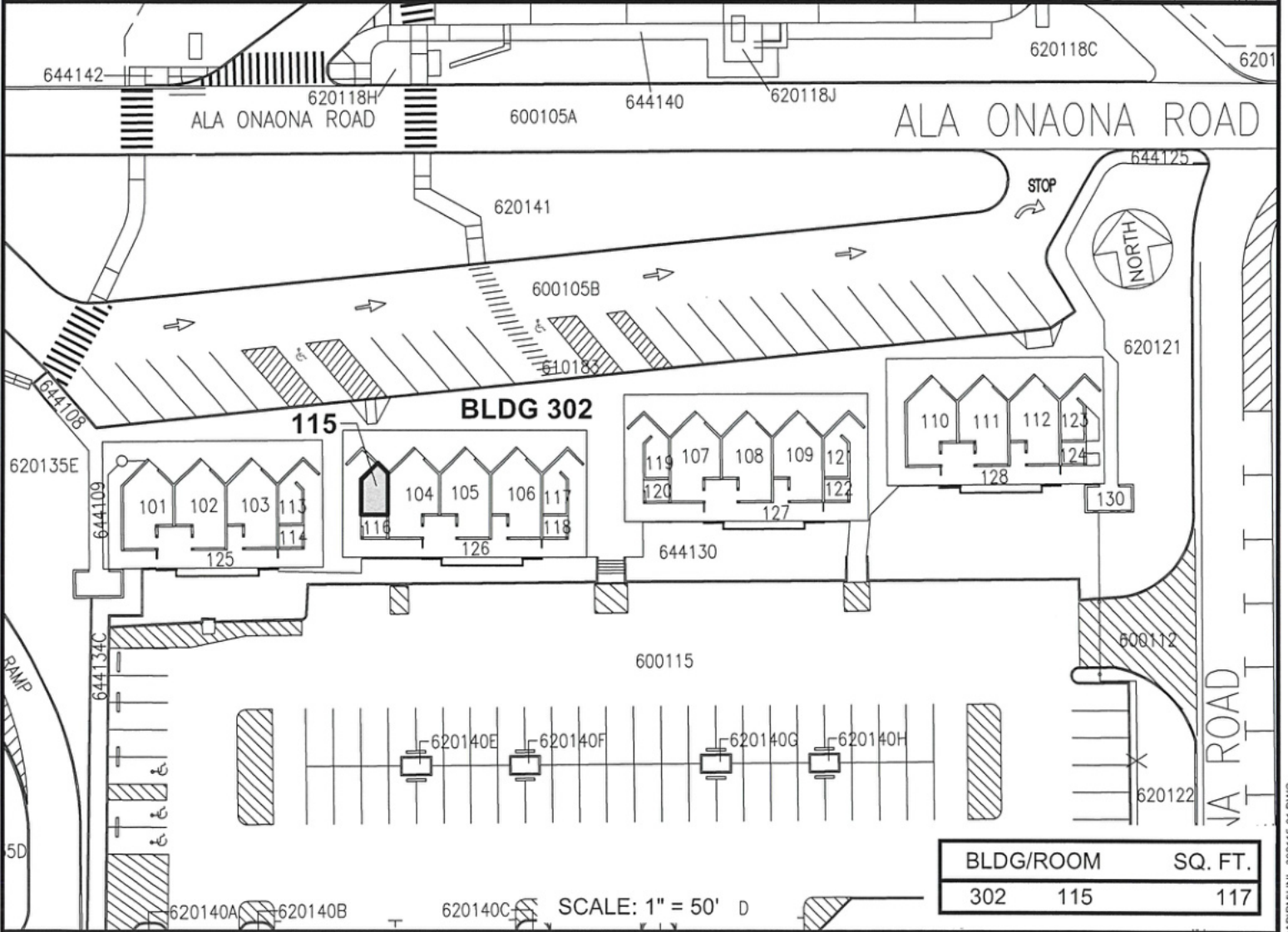
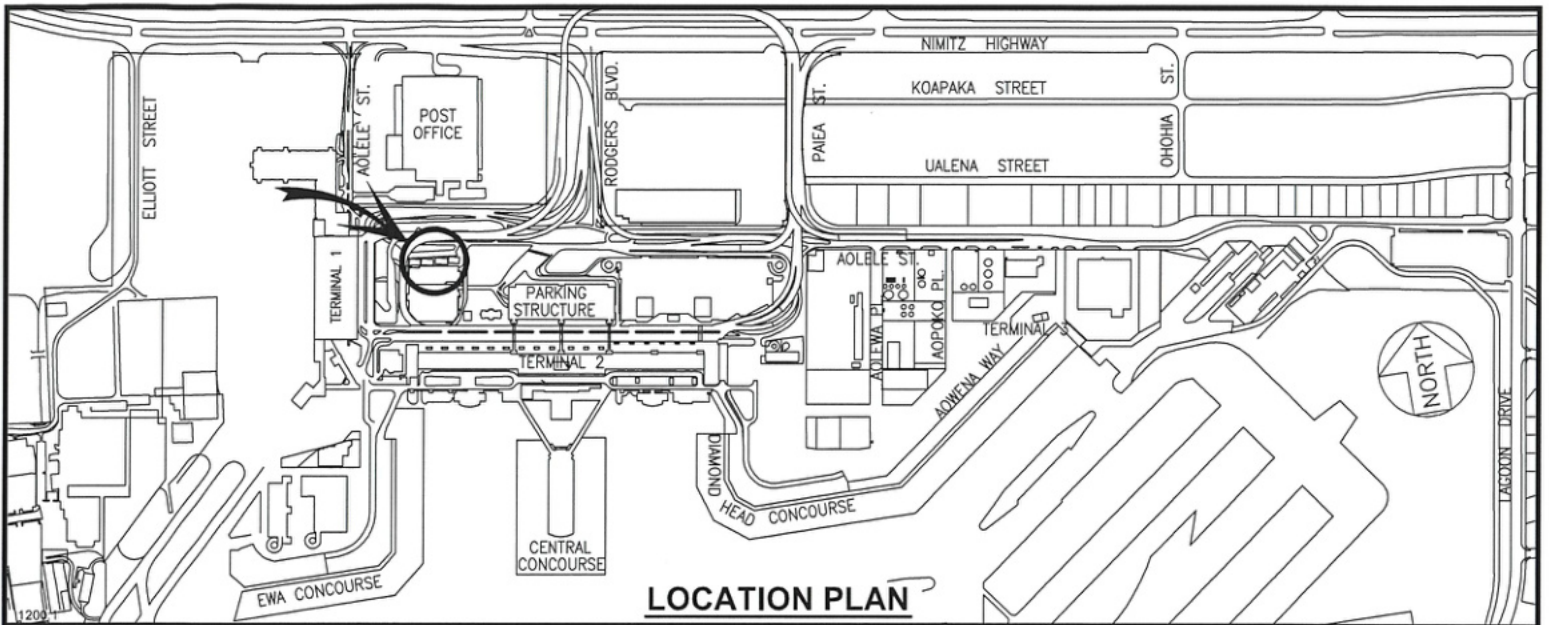

DATE : JUNE 2026

EXHIBIT: **A**



AIRPORTS

THEOLA KAAE DBA
PUA MELIA LEI STAND

BUILDING 302
LEI STAND
GROUND LEVEL

302115

DANIEL K. INOUE INTERNATIONAL AIRPORT

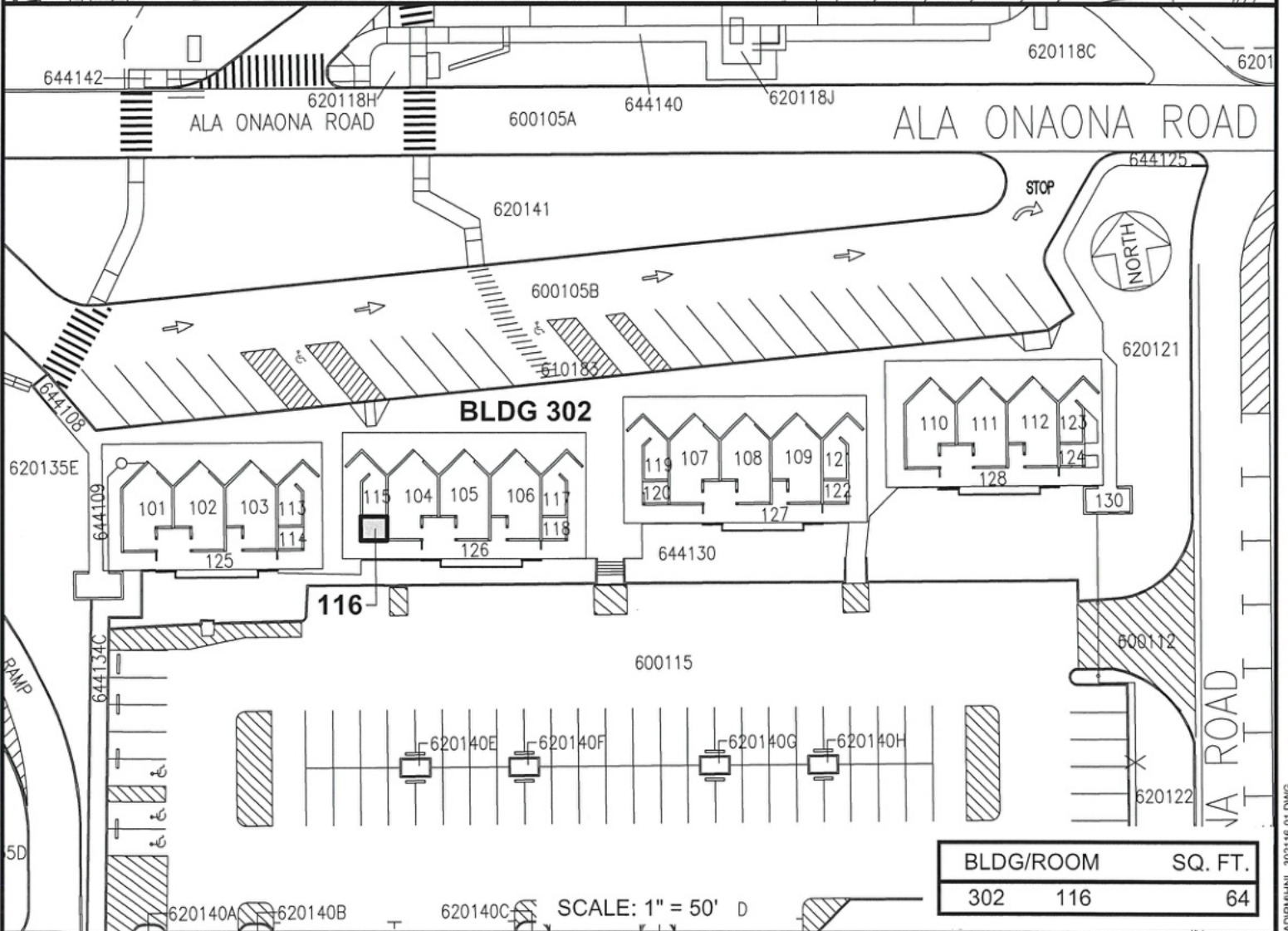
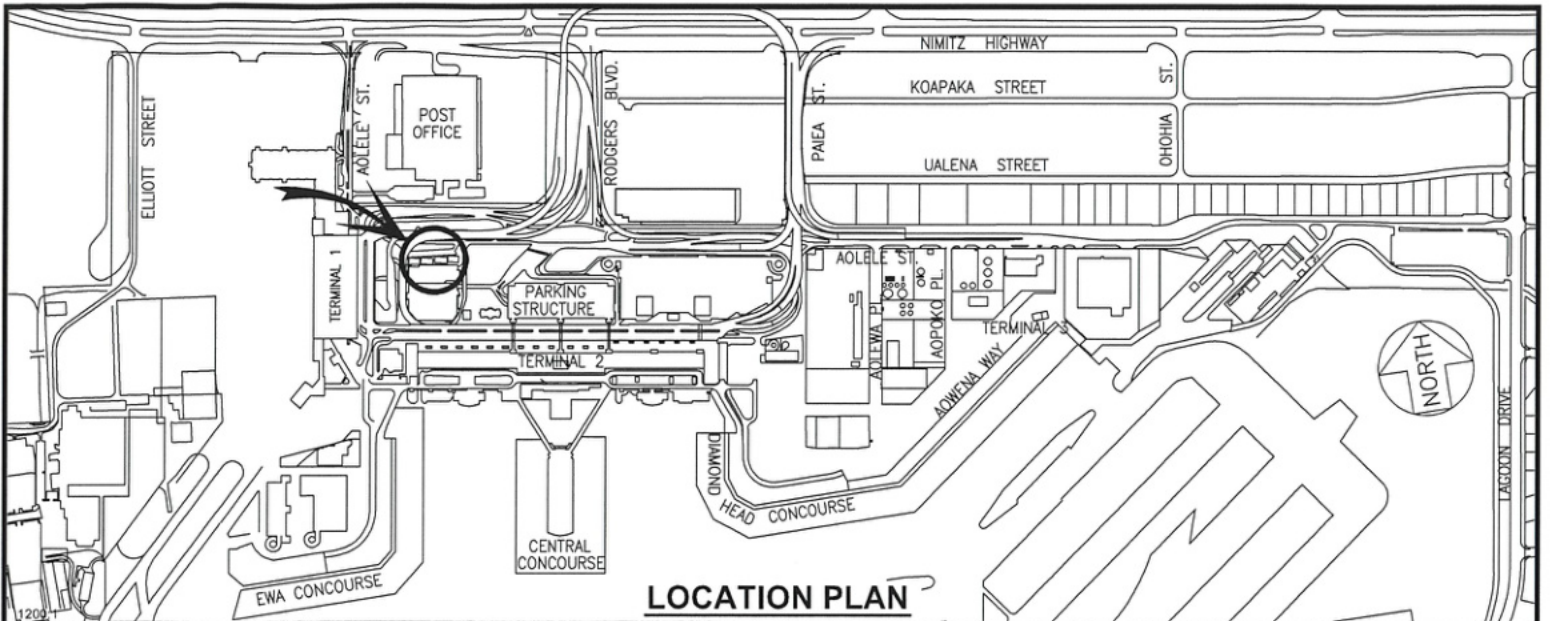

DATE : JUNE 2026

EXHIBIT: **A**



AIRPORTS

THEOLA KAAE DBA
PUA MELIA LEI STAND

BUILDING 302
LEI STAND
GROUND LEVEL

302116