

JOSH GREEN, M.D.
GOVERNOR
KE KIA'ĀINA



STATE OF HAWAII | KA MOKU'ĀINA 'O HAWAII'
DEPARTMENT OF TRANSPORTATION | KA 'OIHANA ALAKAU
AIRPORTS
400 RODGERS BOULEVARD, SUITE 700
HONOLULU, HAWAII 96819-1880

EDWIN H. SNIFFEN
DIRECTOR
KA LUNA HO'OKELE

Deputy Directors
Nā Hope Luna Ho'okele
DREANALEE K. KALILI
TAMMY L. LEE
CURT T. OTAGURO
ROBIN K. SHISHIDO

IN REPLY REFER TO:

AIR-PM 26.0413

July 2, 2026

DOT Land Matters
State of Hawaii
Honolulu, Hawaii

AMENDMENT NO. 1 TO CONCESSION AGREEMENT
NO. DOT-A-26-0004 FOR ADDITIONAL RETAIL SPACE
INTERNATIONAL SHOPPES HNL PARTNERS, LLC
DANIEL K. INOUE INTERNATIONAL AIRPORT
TAX MAP KEY: (1) 1-1-003:001 (PORTION)

OAHU

PURPOSE:

To amend the current Retail Concession Agreement No. DOT-A-26-0004 at Daniel K. Inouye International Airport to include space for a new retail store. Under Article III. (Premises) of the Concession Agreement, the specific area assigned or provided for the concession activity may be changed at the discretion of the Director of Transportation (DIR).

CONCESSIONAIRE:

International Shoppes HNL Partners, LLC, whose business address is 540 Rockaway Avenue, Valley Stream, New York 11581.

LEGAL REFERENCE:

Hawaii Revised Statutes (HRS), Sections 102-2 and 26-19, as amended.

LOCATION AND TAX MAP KEY:

A portion of Building 342, Central Concourse, Daniel K. Inouye International Airport (Airport), Island of Oahu, State of Hawaii, identified by Tax Map Key: 1st Division, 1-1-003:001 (Portion).

AMENDMENT NO. 1 TO CONCESSION AGREEMENT NO. DOT-A-26-0004 FOR
ADDITIONAL RETAIL SPACE, INTERNATIONAL SHOPPES HNL PARTNERS, LLC
Page 2

ZONING:

State Land Use District: Urban
City and County of Honolulu: Industrial (I-2)

LAND TITLE STATUS:

Section 5(a) lands of the Hawaii Admission Act: Non-Ceded
DHHL 30% entitlement lands pursuant to Hawaii Admission Act YES ___ NO X

TERM:

To run for the balance of the term of the existing Concession Agreement that expires on
March 31, 2036.

ADDITIONAL SPACE:

Building/Room No. 342-284A, containing an area of approximately 1,324 square feet,
as shown and delineated on the attached Exhibit L.

IMPROVEMENTS:

Concessionaires shall be responsible for any renovation, upgrade, remodeling, and
improvements to the additional space at their own cost and expense.

RENTAL:

All revenue generated by the additional premises shall be reported as gross receipts under
the Concession Agreement.

DCCA VERIFICATION:

Place of business registration confirmed: YES X NO ___
Registered business name confirmed: YES X NO ___
Good standing confirmed: YES X NO ___

CHAPTER 343, HRS - ENVIRONMENTAL ASSESSMENT:

The environmental impacts of the proposed action to the subject land area are covered by
the Honolulu International Airport Master Plan Update and Noise Compatibility Program
Environmental Assessment (EA), State Project No. AO1011-03. The EA is a joint State
and Federal document, dated September 1989 and published on October 23, 1989, issue
of the OEQC Bulletin. Accordingly, relevant mitigation from the EA and State of Hawaii
Department of Transportation (HDOT) best environmental management practice will
address minimal impacts from this action.

AMENDMENT NO. 1 TO CONCESSION AGREEMENT NO. DOT-A-26-0004 FOR
ADDITIONAL RETAIL SPACE, INTERNATIONAL SHOPPES HNL PARTNERS, LLC
Page 3

REMARKS:

HDOT and International Shoppes HNL Partners, LLC entered into Concession Agreement No. DOT-A-26-0004, dated March 12, 2026, for the Retail Concession at the Airport. The additional retail store offers travelers an expanded selection of merchandise.

RECOMMENDATION:

That the DIR approves and authorizes: (1) HDOT to amend Article III. (Premises) of the subject Concession Agreement as herein outlined, which are by reference incorporated herein; (2) such other terms and conditions as may be prescribed by the DIR to best serve the interests of the State; and (3) review and approval by the Department of the Attorney General.

Respectfully submitted,



CURT T. OTAGURO

Deputy Director of Transportation for Airports

Attachment

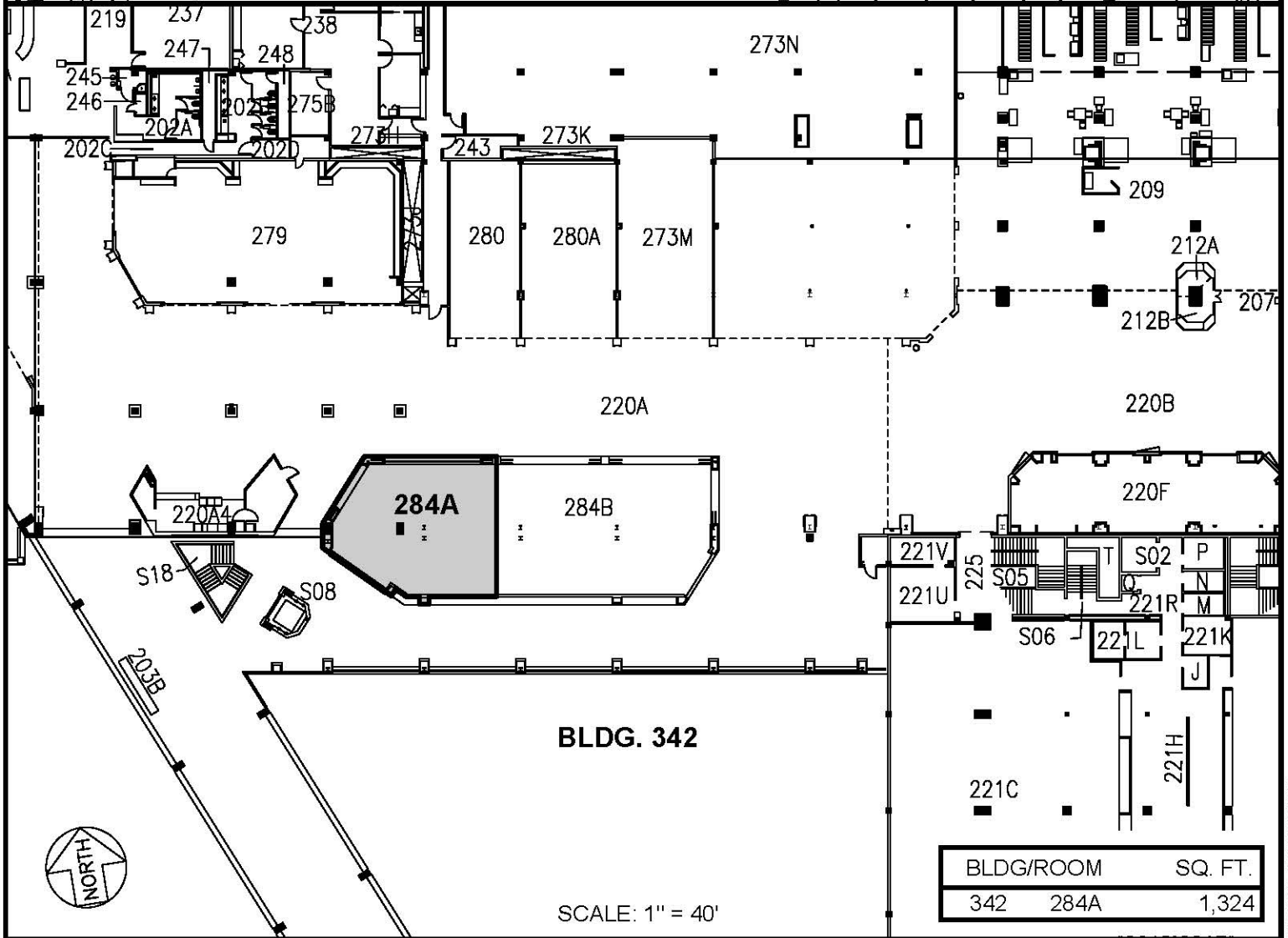
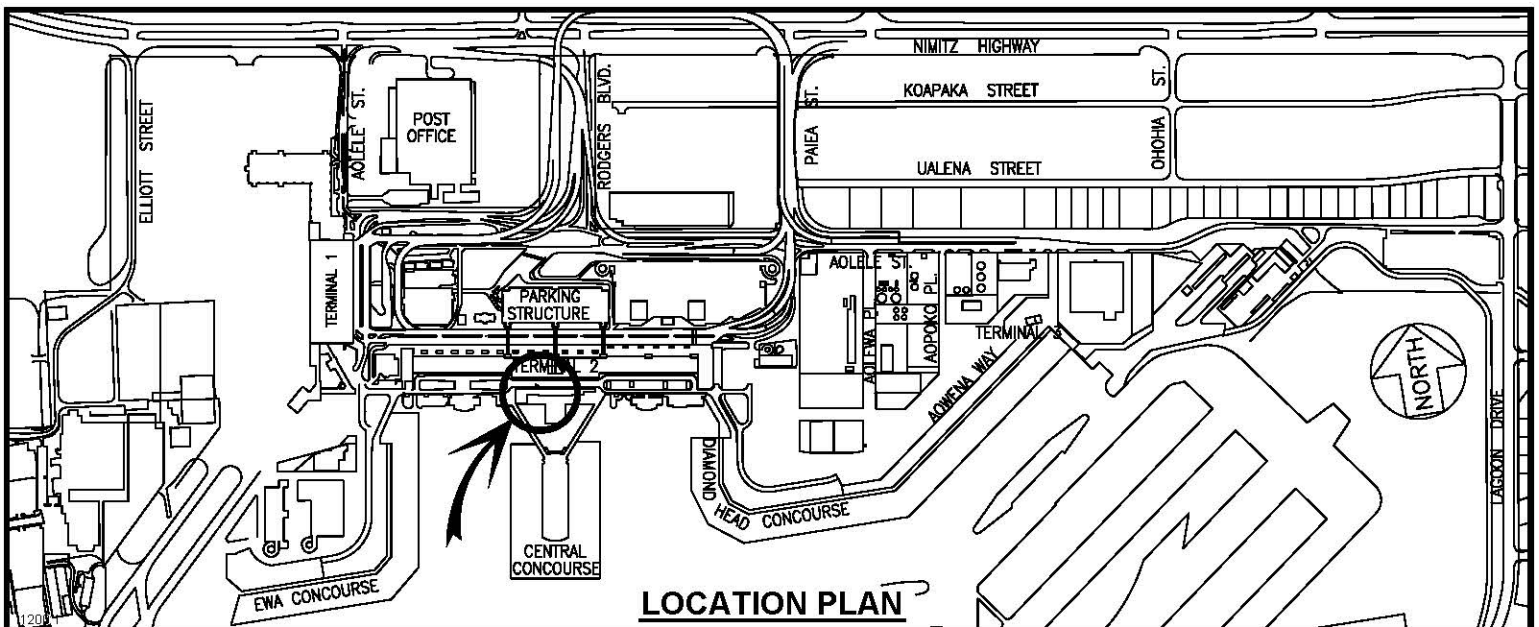

Amendment No. 1 to DOT-A-26-0004

DATE : JUNE 2026

EXHIBIT: L



AIRPORTS

**INTERNATIONAL SHOPPES
HNL PARTNERS, LLC.**

**BUILDING 342
WAITING LOBBY
SECOND LEVEL**

342284A

DANIEL K. INOUE INTERNATIONAL AIRPORT

N:\AIRPORTS\HNL_HONOLULU\CAD\PM\HNL_342284A-01.DWG