

Māmalahoa Trail
 appx. 10-ft wide
 with 30-ft buffers
 on each side

NOTE:
 Origin of Azimuths: "Kailua (North Meridian)" Δ
 Coordinates referred to: "Kailua (North Meridian)" Δ
 "Kailua Azimuth" = "Hawaii Plane Coordinate
 Grid System Zone 1" - 0° 10' 00"

Δ Denotes access permitted
 Δ Denotes no vehicle access permitted
 Δ Denotes no access permitted
 Δ Denotes limited access as noted on plan

NO.	REVISION	APPROVED	DATE
2	Parcel 10 revised	G.C.	7/17/02
1	Parcels 1 (Rev. 1) and 8 acquired under Project No. 19AB-02-97. Project No. 19AB-02-97 changed to: P.A.P. No. NH-019-1(15) as per memo Hwy-AL 3-7-03	G.C.	3/5/02

STATE OF HAWAII
 DEPARTMENT OF TRANSPORTATION
 HIGHWAYS DIVISION

RIGHT OF WAY MAP
QUEEN KAAHUMANU HIGHWAY WIDENING
KAILUA TO KEAHOLE
 P.A.P. PROJECT NO. 19AB-02-97-NH-019-1(15)
 AT KEAHOLO AND KEALAKEHE, NORTH KONA
 ISLAND OF HAWAII, HAWAII

HONOLULU, HAWAII
 MAY 13, 1998

SCALE: 1" = 100'

APPROVED: *James D. Con*
 CADASTRAL ENGINEER

APPROVED: *Larry Segandi*
 FOR: ADMINISTRATOR, HIGHWAYS DIVISION

SHEET NO. 5 OF 6 SHEETS

PROJ. ENGINEER: J. D. CON
 FIELD CHECK: L. D. ...
 CALC. FLOR.: ...
 COMPUTER: ...
 PLOTTED: ...
 DRAFTSMAN: J. WONG, A. LOHIE, S. L. OR ...
 C.D. BY: ...

**Māmalahoa Trail
appx. 10-ft wide
with 30-ft buffers
on each side**

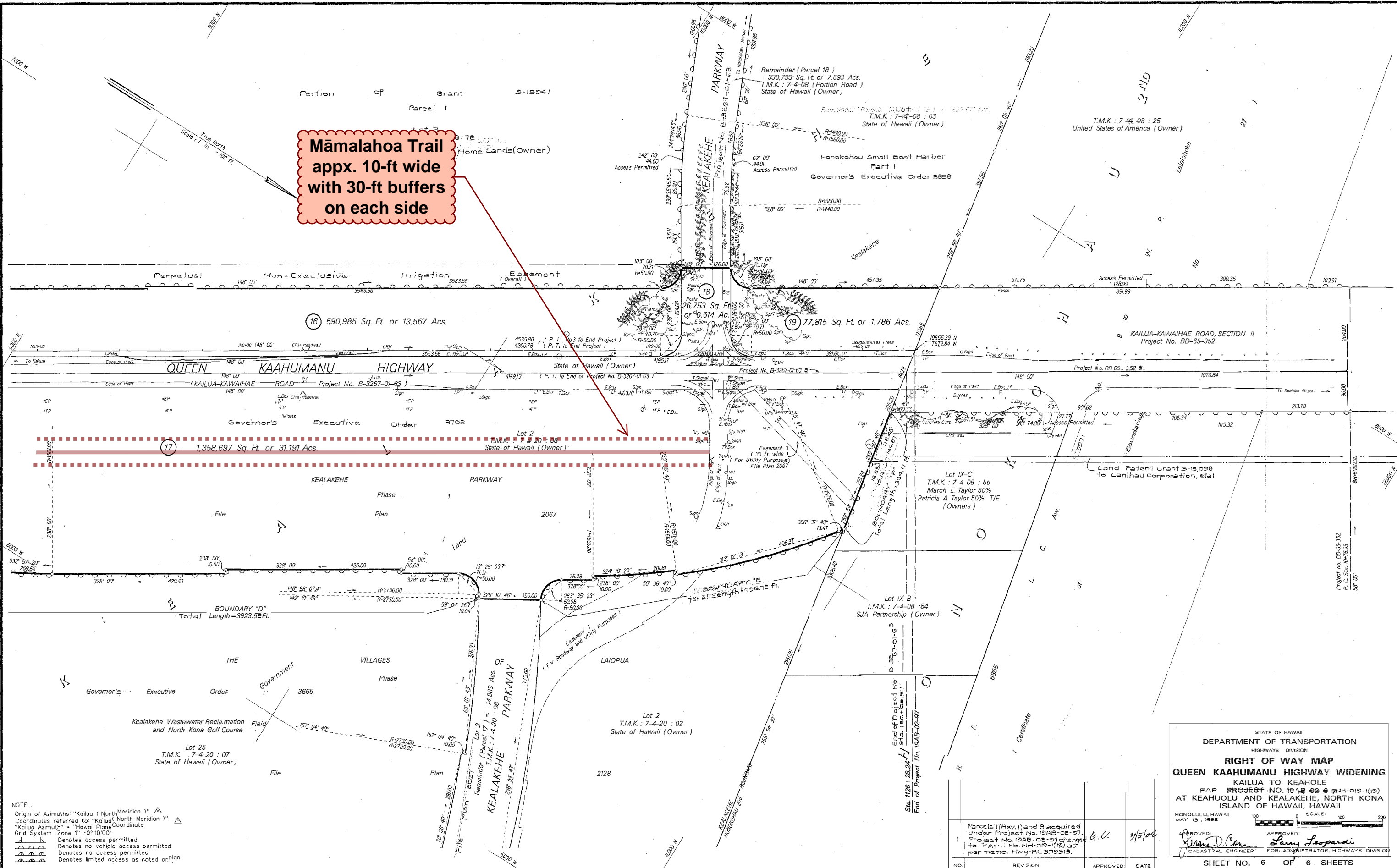

PROJ. ENGINEER: T.O. ...
 FIELD CHIEF: T.O. ...
 CALC. FLOR.: S.Y.A. ...
 COMPUTER: ...
 PLOTTED: ...
 DATE: ...

NOTE
 Origin of Azimuths: "Kailua (North Meridian)" Δ
 Coordinates referred to: "Kailua (North Meridian)" Δ
 "Kealahou Azimuth" - "Hawaii Plane Coordinate
 Grid System Zone 1" - 0° 10' 00"
 - - - - - Denotes access permitted
 - - - - - Denotes no vehicle access permitted
 - - - - - Denotes no access permitted
 - - - - - Denotes limited access as noted on plan

NO.	REVISION	APPROVED	DATE
1	Parcels 1 (Rev. 1) and 3 acquired under Project No. 19AB-02-97. Project No. 19AB-02-97 changed to FAP No. NH-019-1(10) as per memo. Hwy-PL 579313.	G.U.	3/5/02

STATE OF HAWAII
 DEPARTMENT OF TRANSPORTATION
 HIGHWAYS DIVISION
RIGHT OF WAY MAP
QUEEN KAAHUMANU HIGHWAY WIDENING
 KAILUA TO KEAHOLE
 FAP PROJECT NO. 19AB-02-97
 AT KEAHOLO AND KEALAKEHE, NORTH KONA ISLAND OF HAWAII, HAWAII

HONOLULU, HAWAII MAY 13, 1998

APPROVED: *Wm. D. Con* CADASTRAL ENGINEER
 APPROVED: *Larry Leopardi* FOR: ADMINISTRATOR, HIGHWAYS DIVISION

SHEET NO. 6 OF 6 SHEETS