

Daniel K. Inouye Highway (Saddle Road East Side)

Project Dedication Map

Directions:

From Hilo - Take Old Saddle Road/Kaumana Drive west to approximate mile marker 8 (intersection with the new Daniel K. Inouye Highway alignment). Please stay to the left where an officer from the Hawaii Police Department will verify invite. Please signal or use emergency hazards. When clear, please proceed to the left through the traffic barricades. Parking is approximately 1/2 mile to the east.

From Kona/Waimea/Waikoloa - Take the Daniel K. Inouye Highway east to approximate mile marker 8. Proceed through the temporary traffic control cone zone and turn out to the right where an officer from the Hawaii Police Department will be stationed and verify invite. Please signal or use emergency hazards when leaving the cone zone. Please proceed along the roadway shoulder past the traffic barricades. Parking is approximately 1/2 mile to the east.

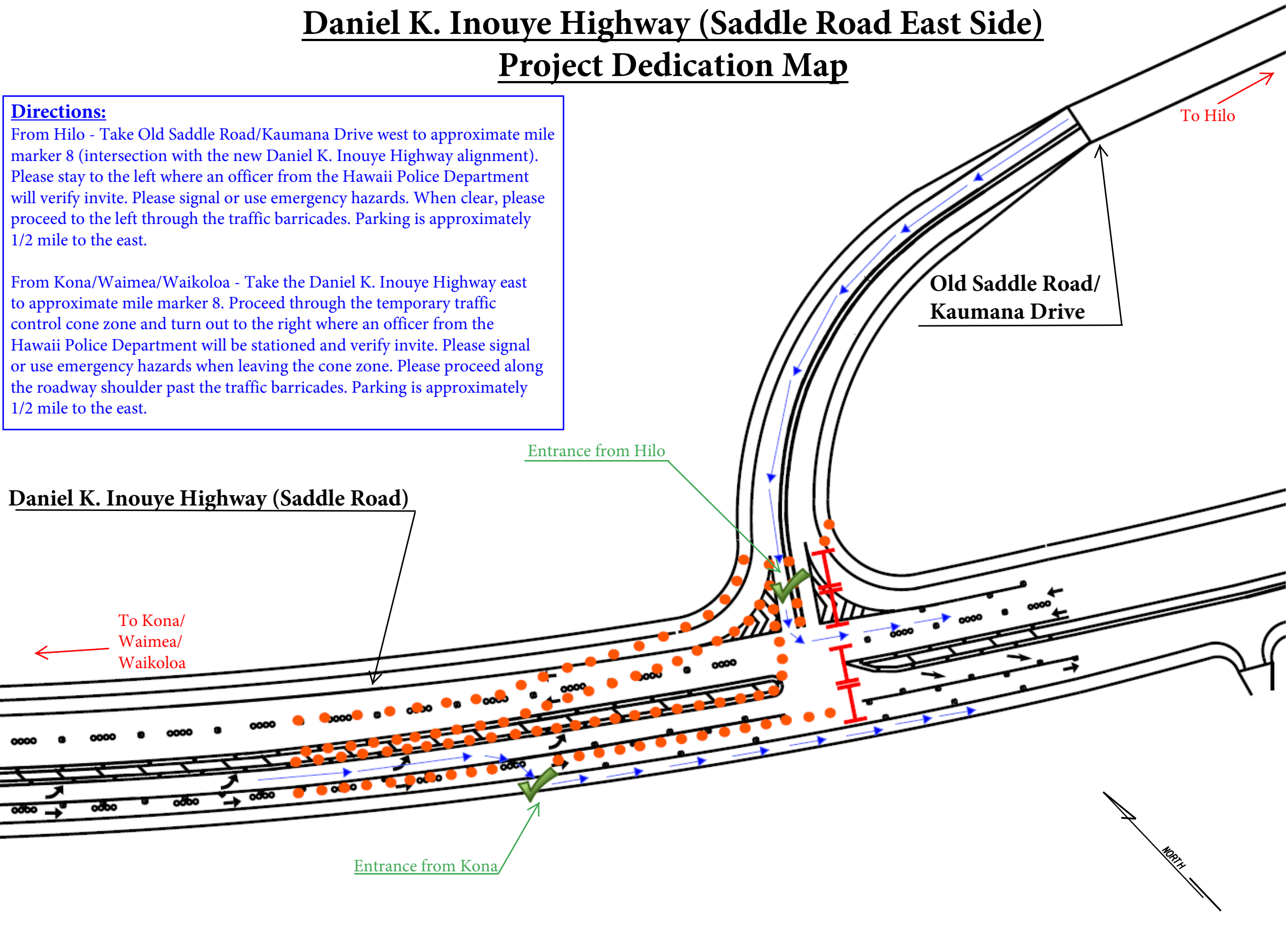

To Hilo

Old Saddle Road/
Kaumana Drive

Entrance from Hilo

Daniel K. Inouye Highway (Saddle Road)

To Kona/
Waimea/
Waikoloa

Entrance from Kona

NORTH