

An aerial photograph of Hāna Harbor on Maui. The harbor is a deep blue-green body of water with a long, narrow pier extending from the shore. The surrounding land is covered in dense, lush green forest. In the foreground, there are some buildings and a road, suggesting a residential or commercial area near the harbor.

Hāna Harbor Pier Improvement Environmental Assessment

Public Meeting

October 28, 2014 | Helene Hall | Hāna, Maui



Agenda

1. Meeting purpose
2. Project update
3. Clarify commercial use of the pier
4. Alternatives (rebuild, demolish)
5. Pier access, Wave attenuation project (DLNR DOBOR)
6. Q&A

Meeting Purpose

- Update the community on the status of the project
- Provide clarification on commercial use of the pier
- Identify potential impacts that should be studied in the EA



Project Update



- Funding
- Contract amendment
- Internal consensus on purpose and need, & commercial use of the pier

Purpose and Need

As identified in the development plan:

To provide an operational pier in times of emergency.

To provide an improved pier for local & commercial fishermen.

To provide an operational pier for the present and future community of Hāna.

DOT-Harbors Mission

The mission of the Harbors Division is to effectively manage and operate a statewide commercial harbors system that facilitates the efficient movement of commercial cargo, passenger and fishing vessels entering, leaving, or travelling within the State, and facilities and supporting services for loading, off-loading, and handling of cargo, passengers, and vessels. – HRS 266-1

Allowed uses

- Emergency calls – Emergency supplies, building materials
- Cargo – exporting produce, importing building materials, fuel
- Passenger - ferry service
- Cruise - smaller scale cruise operations
- Commercial Fishing



Limitations

- Remote location
- Rough conditions
- Lack of landside infrastructure
- Design – Height of the pier deck would prohibit smaller vessels from berthing
- Labor, security, staff (i.e. stevedores)



Alternatives

- Under current administrative rules & under DOT-Harbors' mission, commercial activity cannot be excluded, but can be limited by rules.
- Moving forward:
 - Improve the pier under commercial jurisdiction, allowing for commercial use as appropriate
 - Demolish



Boat Ramp and Wharf Improvements

- Boat ramp concrete slab replacement;
- New aluminum cantilevered loading dock;
- Demolition of the first two (2) sections of the Hāna Wharf;
- Installation of boulder revetment (wave buffer).



Phase II Project Status:

- Bids opened on June 12, 2014;
- Project awarded on July 25, 2014 to American Marine Corporation;
- Negotiated contract amount: \$1,203,900;
- Contract signed by Chairperson on October 22, 2014.

Tentative EA Schedule

| | |
|-------------------------------|--------------------------|
| Community Meeting #1 | <i>Summer 2013</i> |
| EA Early Consultation/Scoping | <i>Summer 2013 -2014</i> |
| Community Meeting #2 | <i>Fall 2014</i> |
| Draft EA Preparation | <i>Early 2015</i> |
| Draft EA Public Review | <i>Mid 2015</i> |
| Community Meeting #3 | <i>Mid 2015</i> |
| Final EA Publication | <i>Late 2015</i> |

Contacts

DOT-Harbors Planning Office

Sandra Rossetter, Project Manager

79 Nimitz Highway

Honolulu, HI 96813

(808) 587-1886

email: Sandra.C.Rossetter@hawaii.gov

Helber Hastert & Fee

Scott Ezer or Gail Renard

733 Bishop Street, Suite 2590

Honolulu, HI 96813

(808) 545-2055

Email: grenard@hhf.com

Project Scope

- EA Purpose, Process, Scope
- Alternatives to evaluate
- Primary environmental issues
 - Marine resources
 - Culture/Recreation
 - Historic
- Technical Studies
- USACE Permit

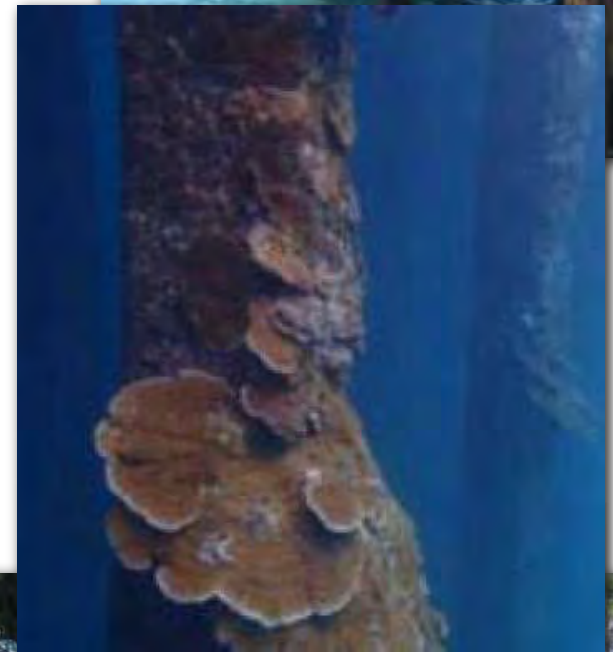

Conceptual Pier Repair Sections

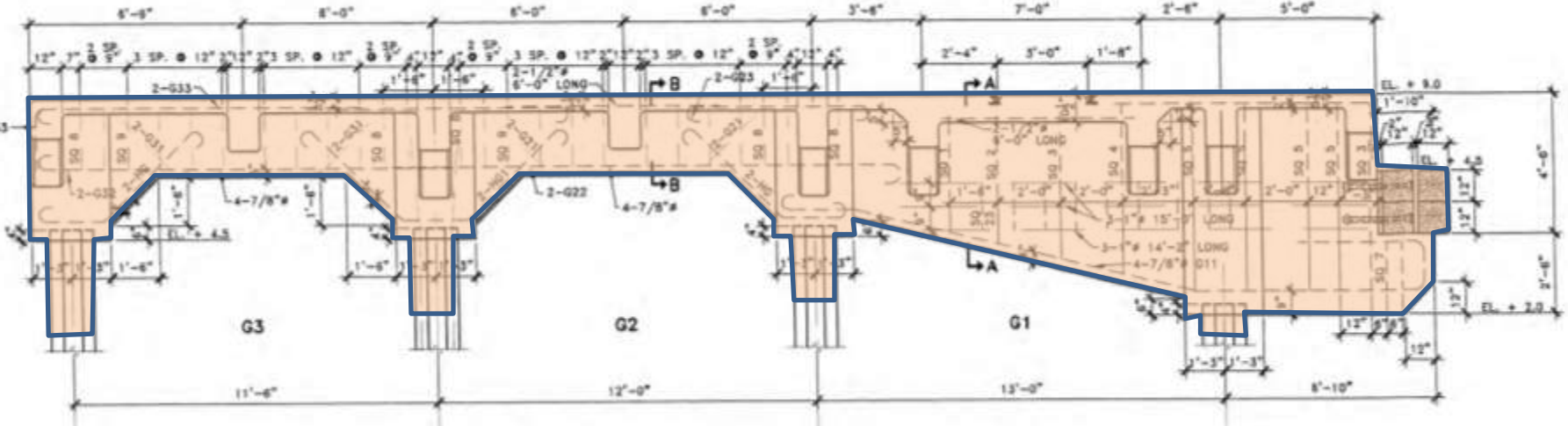

NEW CONCRETE PILE CAP, PRECAST DECK PLANKS, TOPPING SLAB

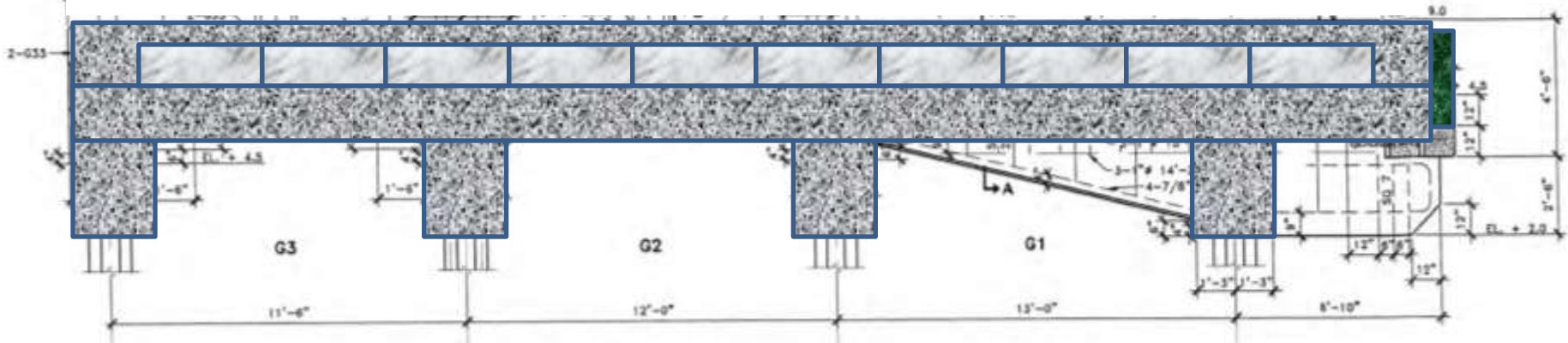

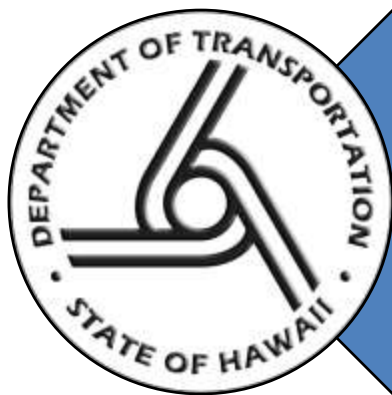

Questions?



Hana (HNM) Airport

Maui, Hawaii

Part 139 Improvements

Hana (HNM) Airport



New HNM ARFF Station



Existing Condition "Before"



RUNWAY 26

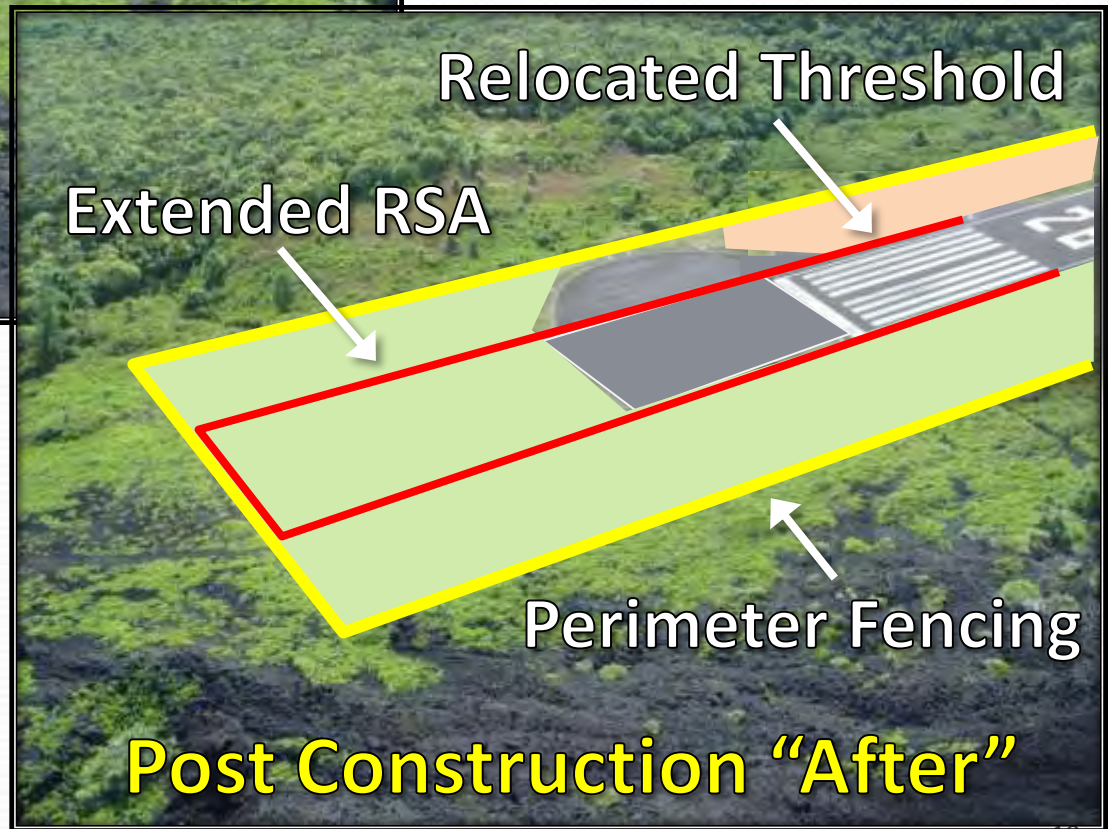

RUNWAY 8

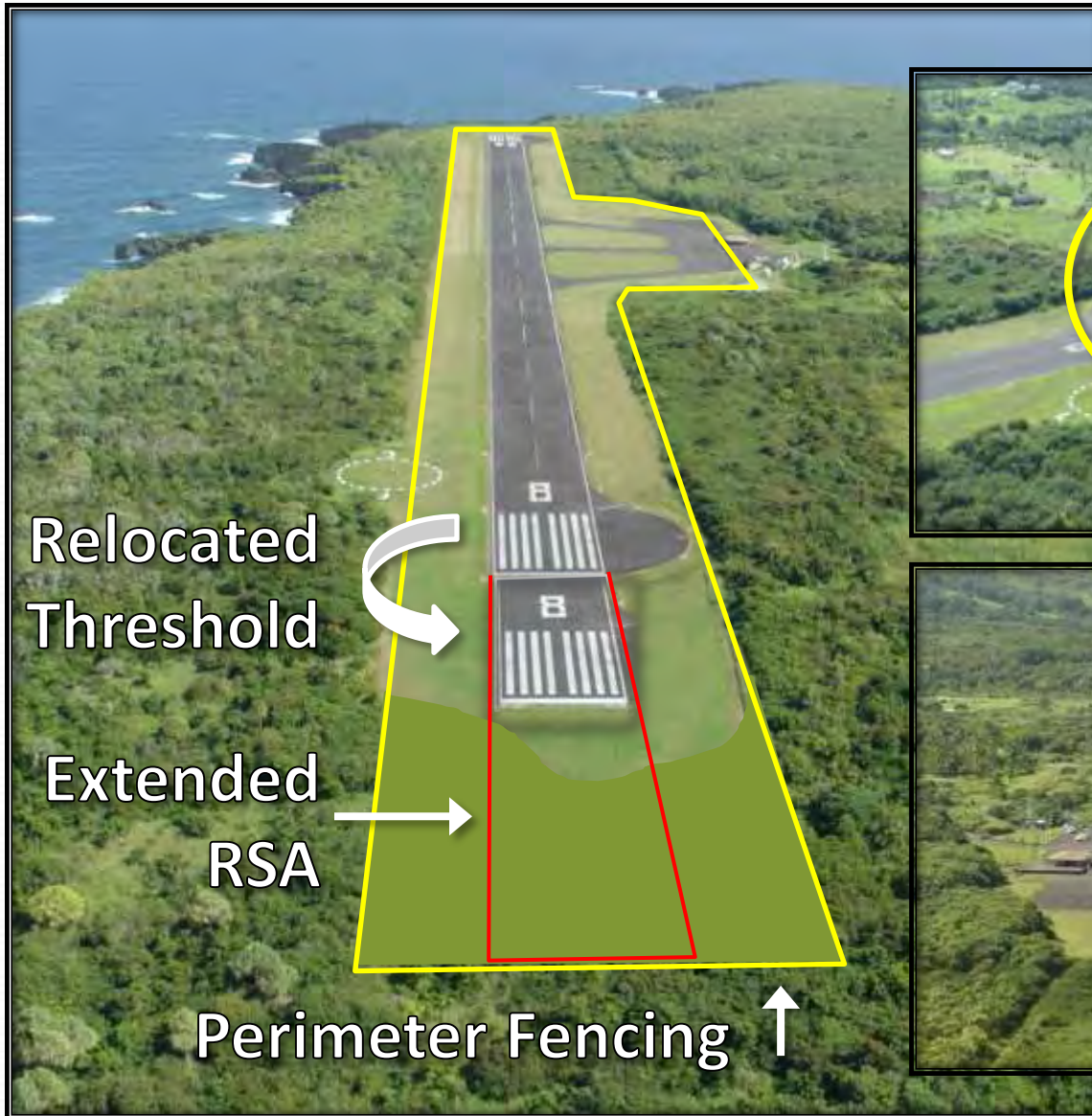

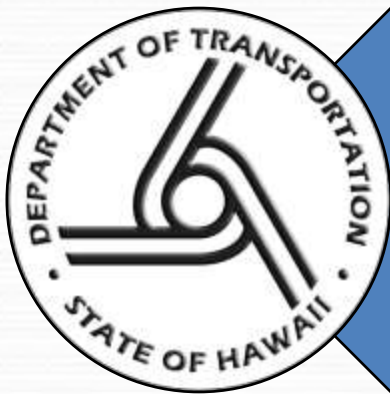

Questions?



State of Hawaii Department of Transportation
Hana Community Meeting
Highways Division Presentation
October 28, 2014

HIGHWAYS DIVISION

Aloha

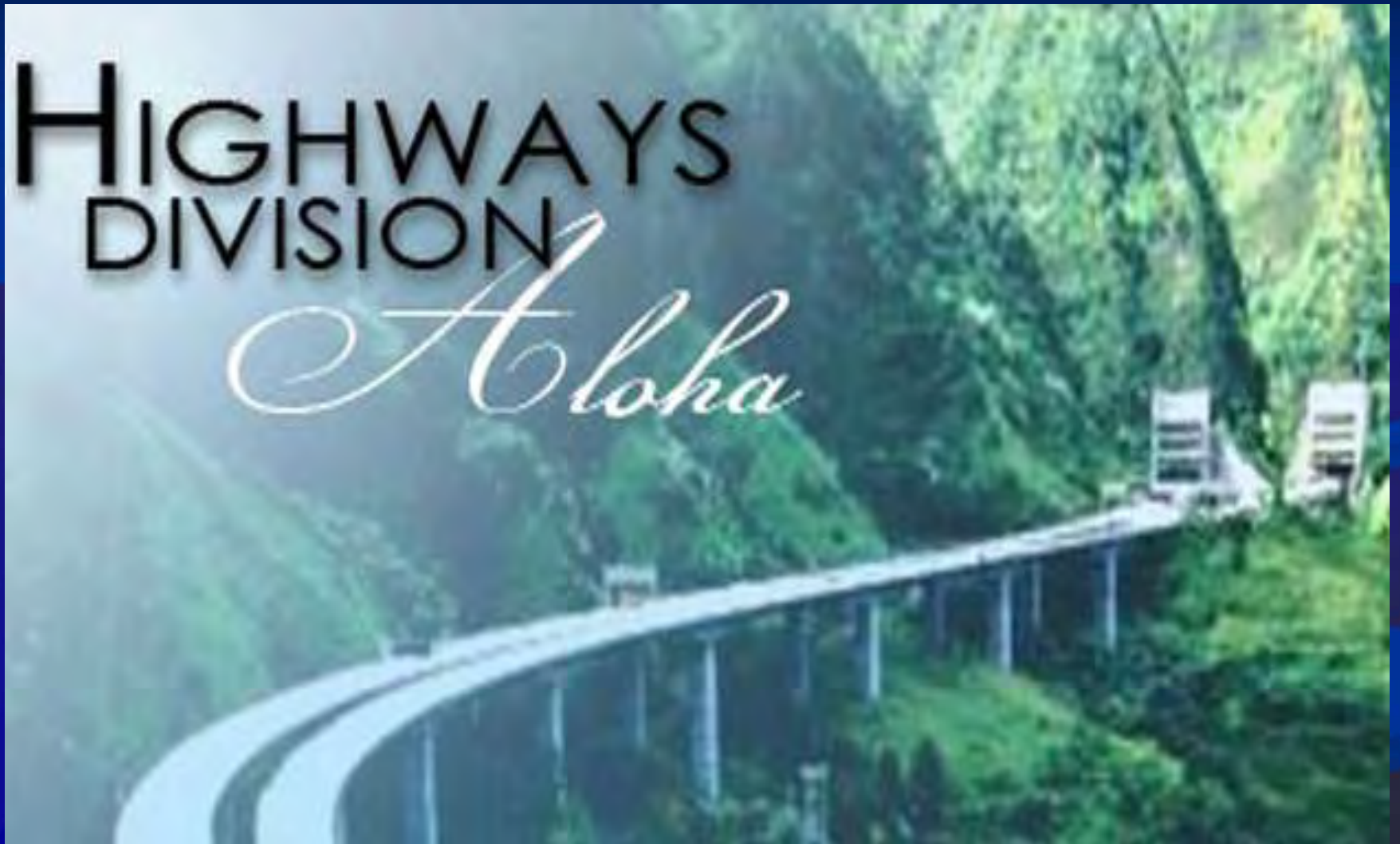



Hana Highway Emergency Slope Stabilization

Milepost 10.4, 14 and 16



SCOPE

Install anchored wired mesh system on eroded mauka and makai slopes.

COST

\$ 8.2M

SCHEDULE

Completed:
March 2014



Hana Highway Improvements Uakea Road to Keawa Place



SCOPE

Accommodate two way traffic; provide pedestrian path to address safety concerns for pedestrians along Hana Highway from Paaini Mai Park

COST: \$1.5 M

SCHEDULE

Completed:
September 2014



Hana Highway Resurfacing Vicinity of Waikani Bridge to Kapaula Bridge



SCOPE

Resurface existing road, new pavement markings & signing, guardrails, gutter, repair cracks & spalls on bridges, clean existing drainage culverts.

COST: \$2.5M

SCHEDULE

Construction Start: July 2014

Anticipated Completion:

End of November 2014





Hana Highway Resurfacing Vicinity of Honomanu Bridge to Waikani Bridge



SCOPE

Resurface existing road, new pavement markings & signing, guardrails & grated drain inlets, repair cracks & spall on bridges, clean existing drainage culverts.

COST: \$2.8M

SCHEDULE

Construction start:

August 2014

Anticipated Completion:

February 2015



Kahului Airport Access Road Vicinity of Puunene Avenue to Hana Highway



SCOPE

Construct portion of new access road to Kahului Airport from vicinity of Puunene Ave to Hana Hwy.

COST: \$21.8M

SCHEDULE

Anticipated Completion:
March 2015





Hana Highway Improvements (Multiple Phases)

Huelo to Hana

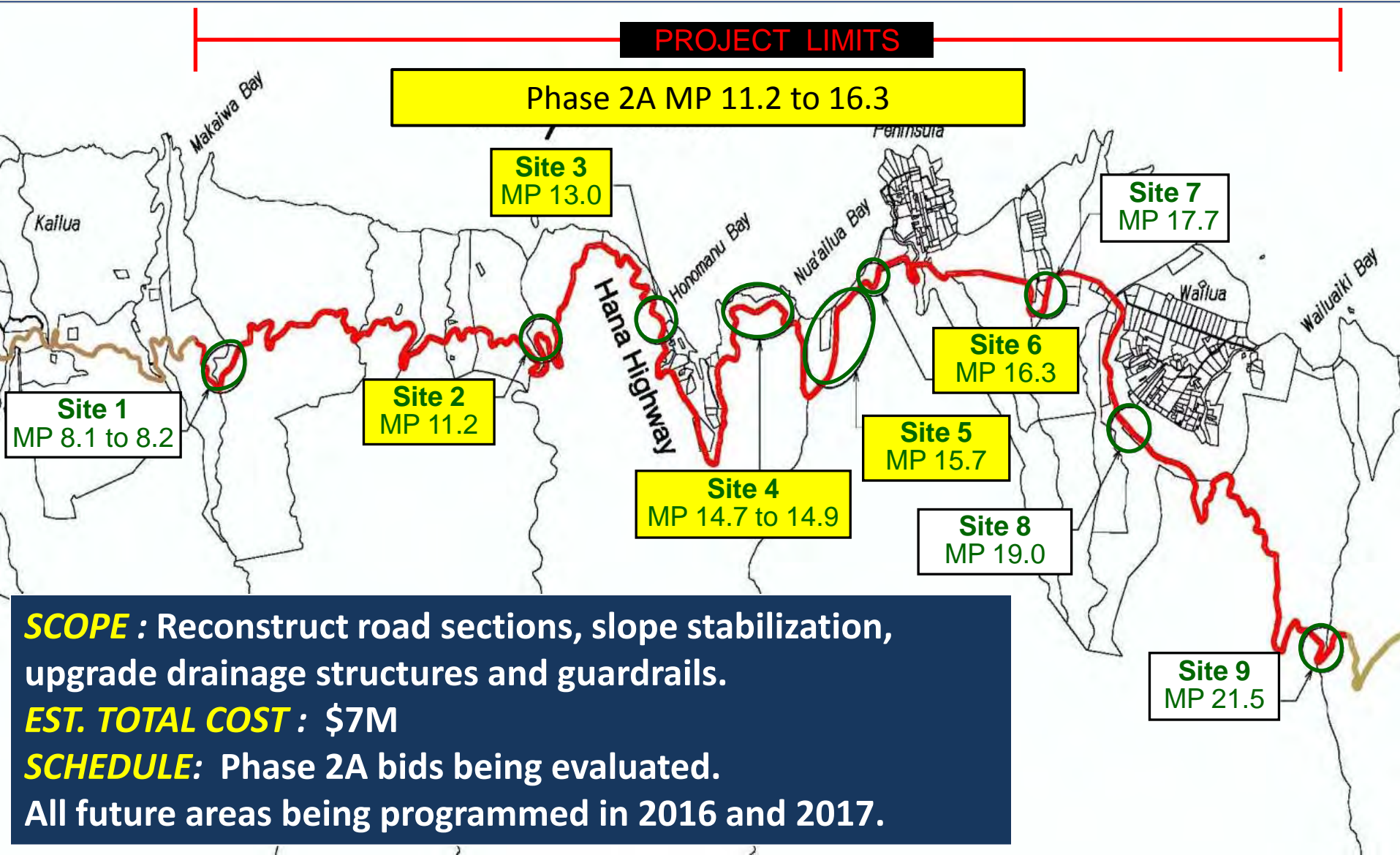



Hana Highway Resurfacing

Haleakala Hwy. to Paia; Paia to Hookipa Park

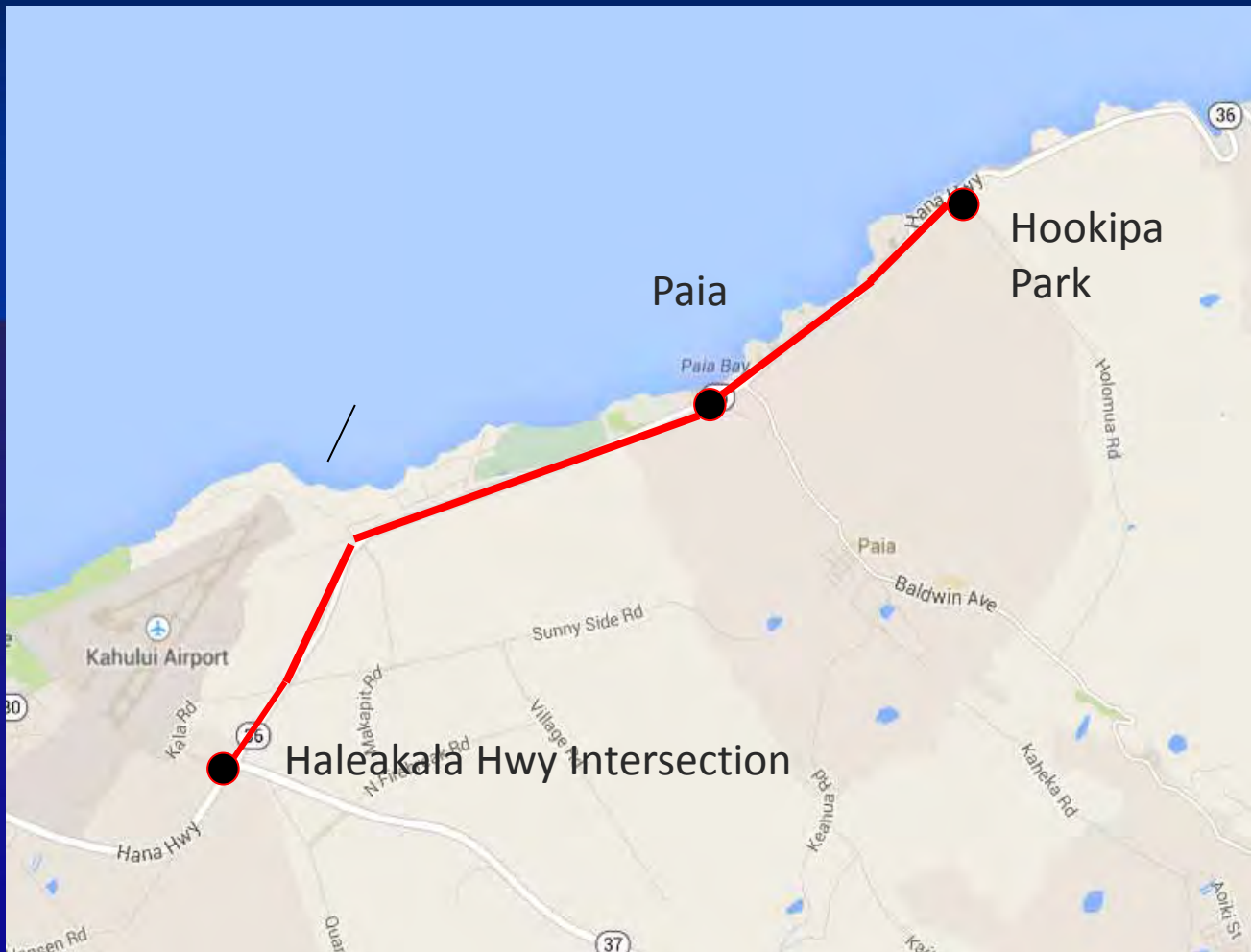

SCOPE

Cold planing,
resurface existing
pavement,
pavement markings
& signage,
reconstruct
weakened
pavement areas

EST. COST: \$6-7M

EST. SCHEDULE

Advertise:
Feb 2015



Hana Highway

Historic Bridge Preservation Plan



SCOPE

Develop a historic bridge preservation plan for Hana Highway Bridges, including a prioritized implementation plan based on needs and feasibility.

EST. COST: \$1.5M

SCHEDULE

Final Report
Estimated Sept. 2015



Hana Highway Resurfacing Milepost 0 to 4.15

SCOPE

Cold planing,
resurface existing
pavement,
pavement
markings &
signage,
reconstruct
weakened
pavement areas

EST. COST: \$ 4M

EST. SCHEDULE

Planned for
FY 2016



Hana Highway Rockfall Mitigation

Milepost 12



SCOPE

Address rock fall and landslide hazards between

- MP 12.06 to MP 12.12
- MP 12.49 to MP 12.57
- MP 12.59 to MP 12.69

EST. COST

\$ 4M

SCHEDULE

Construction funding
in 2016

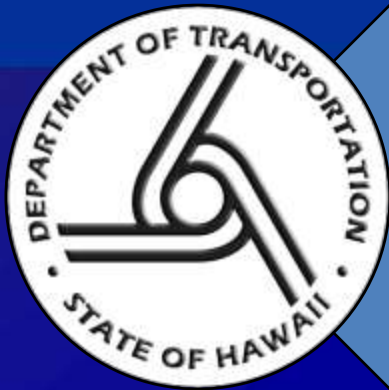

Questions?

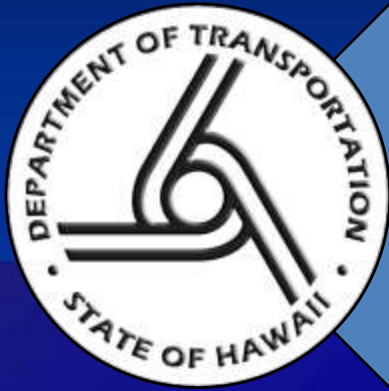

**Mahalo
for coming**

This presentation is available at
hidot.hawaii.gov/presentations