

# Town Hall – Waikiki Community Center

Hawai'i Department of Transportation Update

# Report maintenance concerns:

- State Routes:  
(808) 831-6714  
(808) 485-6200 After hours  
Email: [complainthighwayoahu@hawaii.gov](mailto:complainthighwayoahu@hawaii.gov)
- City Roads:  
3-1-1 app  
<https://honoluluhi.citysourced.com/default.aspx>

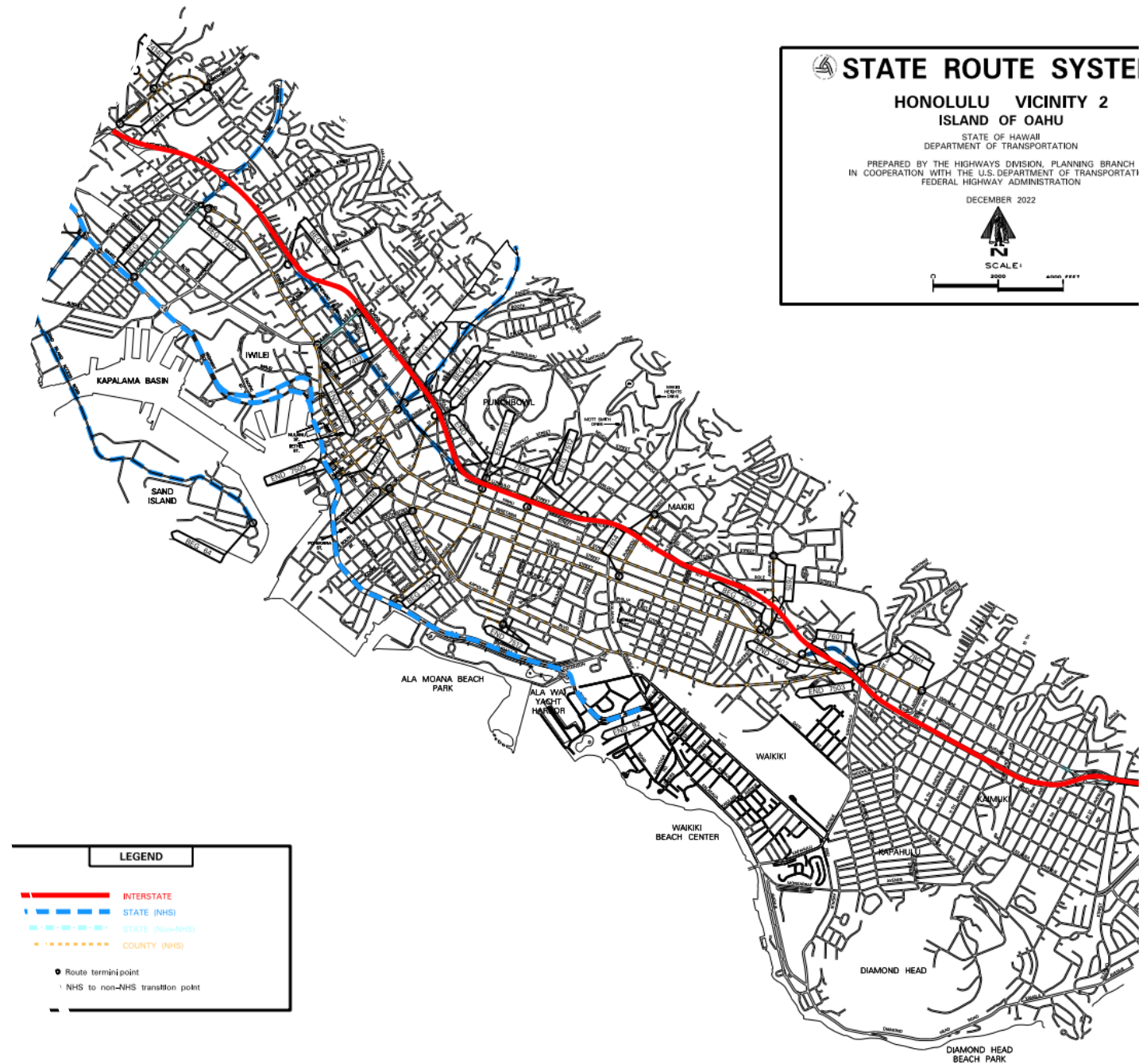

# Why is safety our priority?

*Hawai'i fatalities January 1 – September 27, 2023; (2022 data shown in parentheses)*

	Motor Vehicle Occupants	Pedestrians	M/C, Moped, Scooter Operators	Bicyclists	ATV Operators	TOTAL
<b>Hawaii</b>	6 (15)	3 (5)	2 (6)	0 (1)	1 (0)	12 (27)
<b>Maui</b>	4 (5)	5 (4)	1 (5)	2 *(1)	0 (0)	12 (15)
<b>Honolulu</b>	15 (13)	7 (10)	17 (10)	4 (4)	0 (0)	43 (37)
<b>Kauai</b>	0 (5)	2 (2)	1 (1)	0 (0)	0 (0)	3 (8)
<b>TOTAL</b>	25 (38)	15 (21)	21 (22)	6 (6)	1 (0)	70 (87)

## Actionable Intelligence for Safety

Determine highest priorities



Crash Severity &  
Hotspots



Factors & Patterns

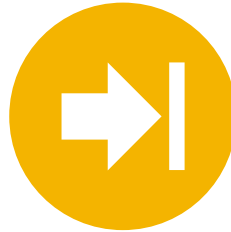

Real-time,  
Predictions &  
Decision Support

Take Action

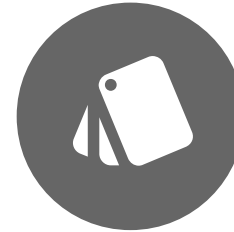

Counter Measures

Measure Impact



Performance  
Metrics

# Crash Data



**Hawai'i Highways**

Safety Analytics for Infrastructure



## Crash Data

Crash data provides information about motor vehicles crashes that occurred on public roadways. Title 23, of the United States Code, Section 407, states all reports, surveys, schedules, lists, or data compiled or collected for safety improvement or hazard elimination purposes is protected against discovery or admission into evidence. This data is provided for highway safety and educational purposes only. Use of this data constitutes agreement with this policy.

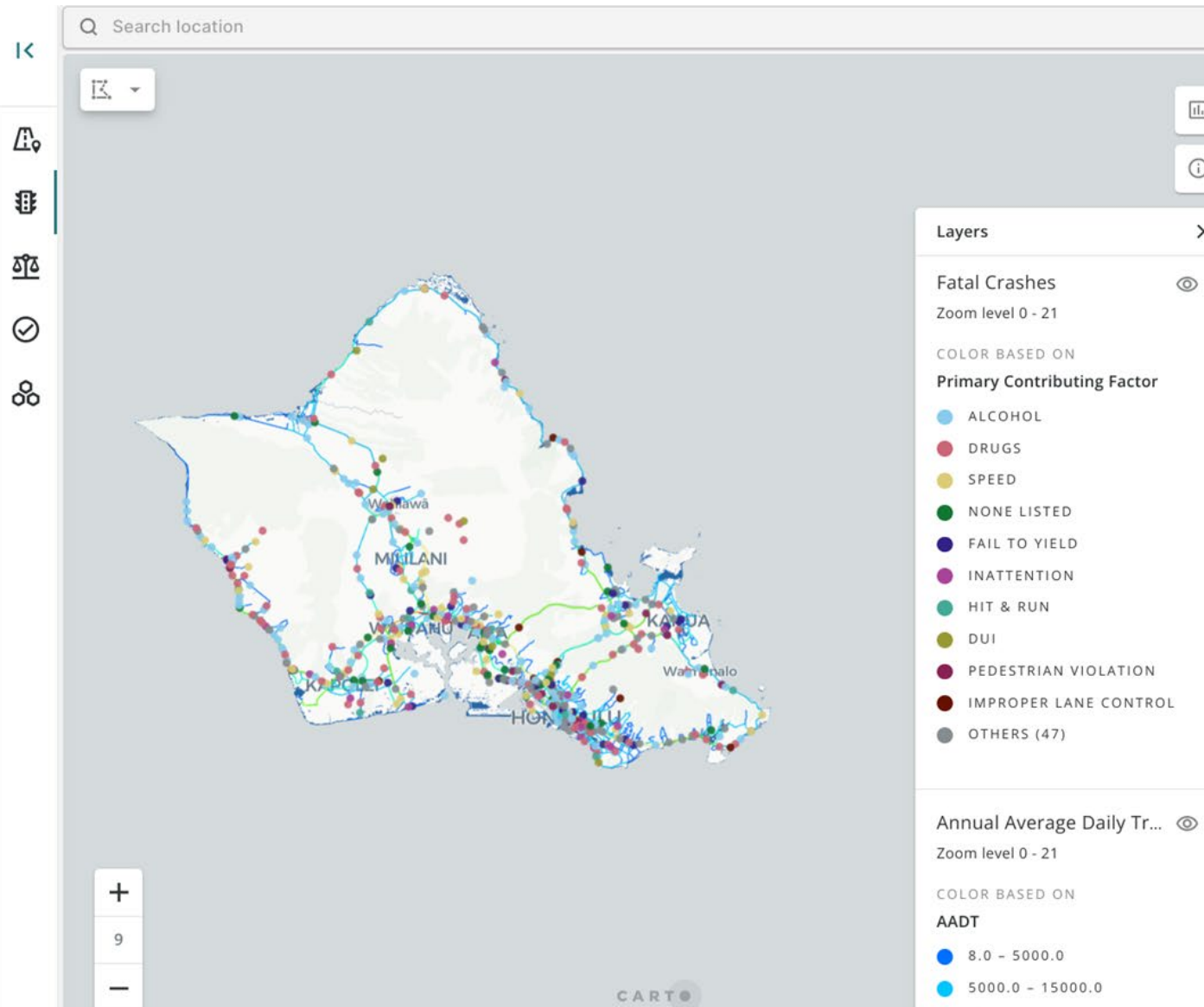

# Fatal Crashes: Speeding

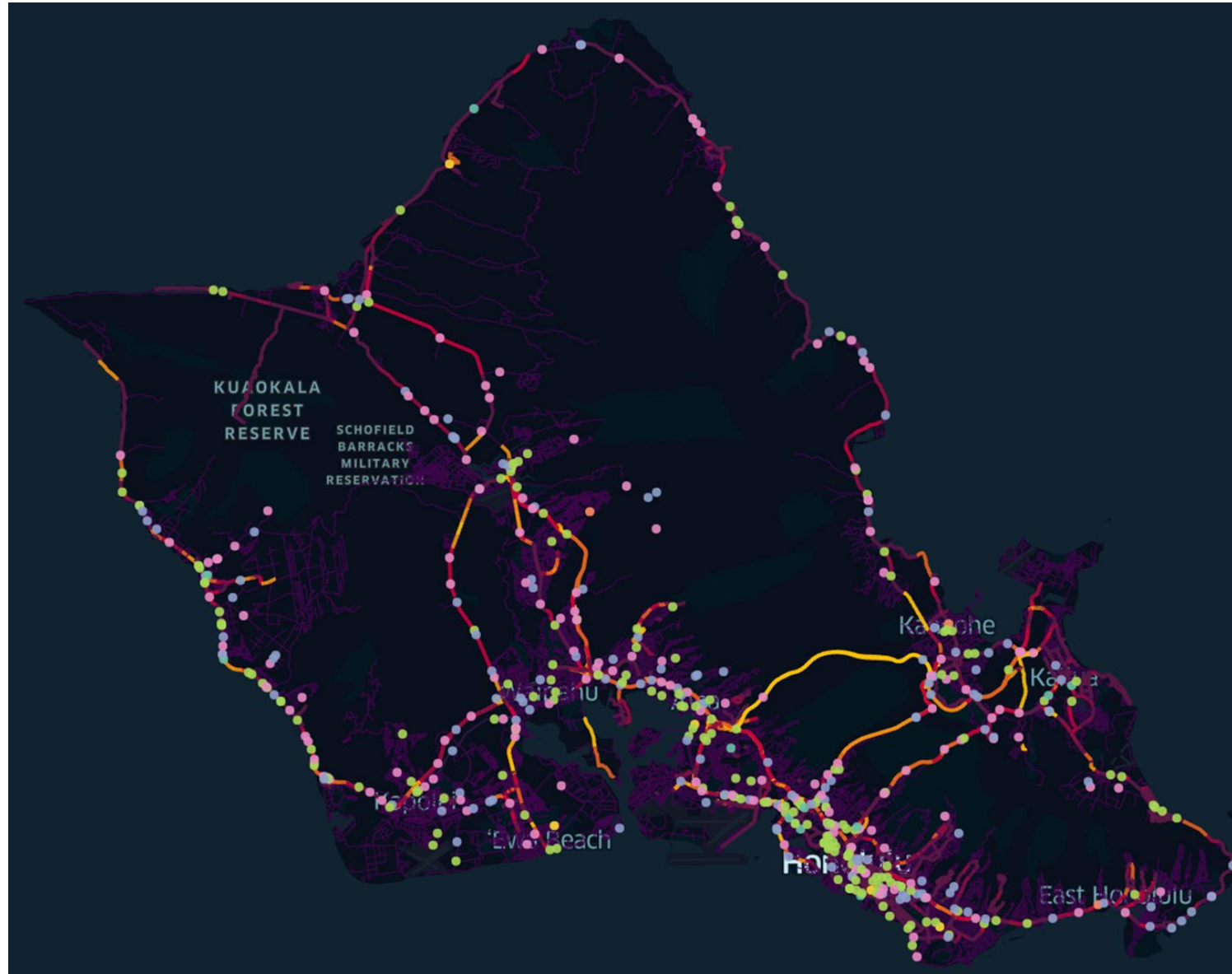
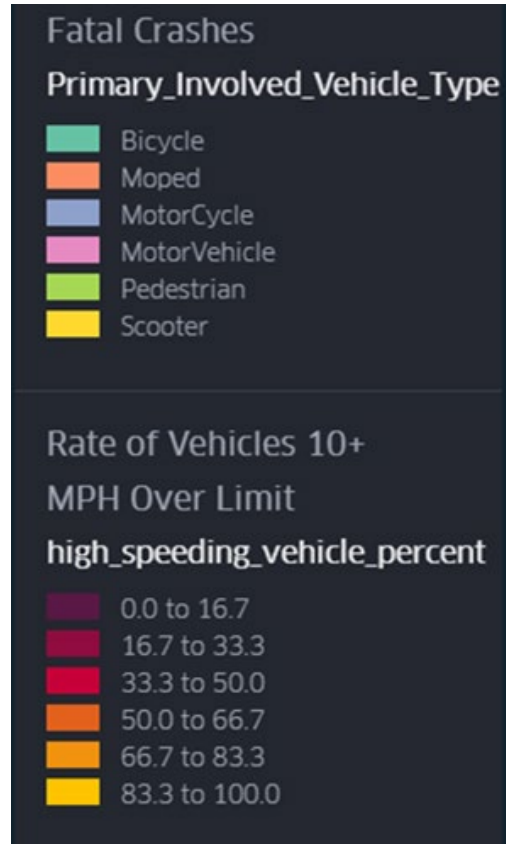



# Fatal Crashes: Hard Braking

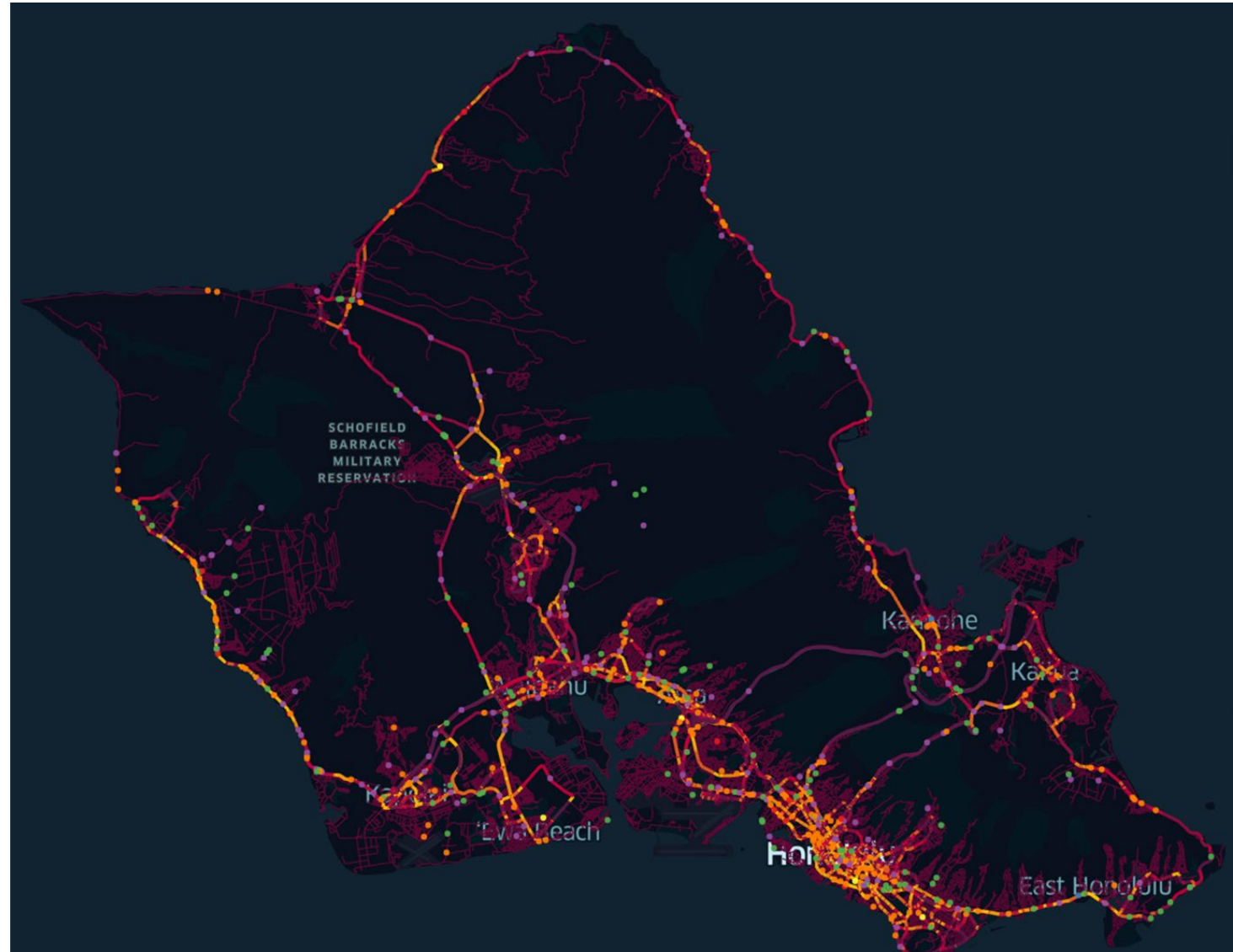
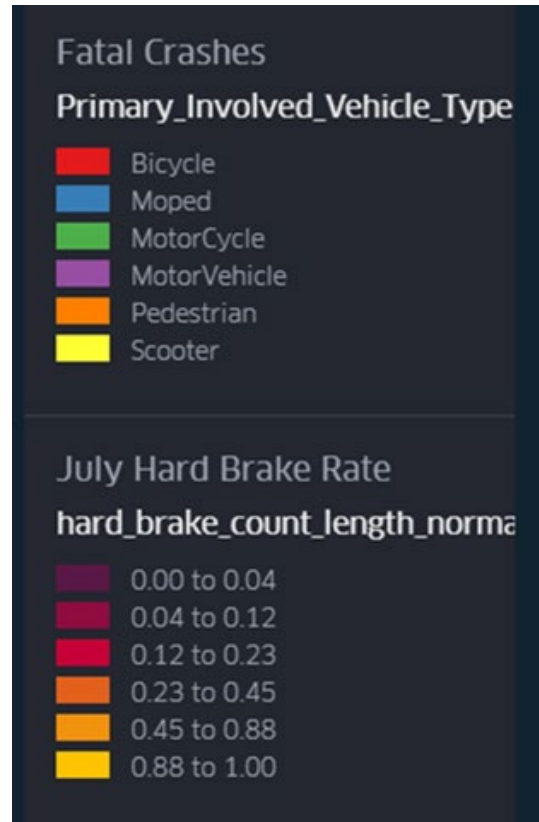

# Case Study: Pali Highway Raised Crosswalks

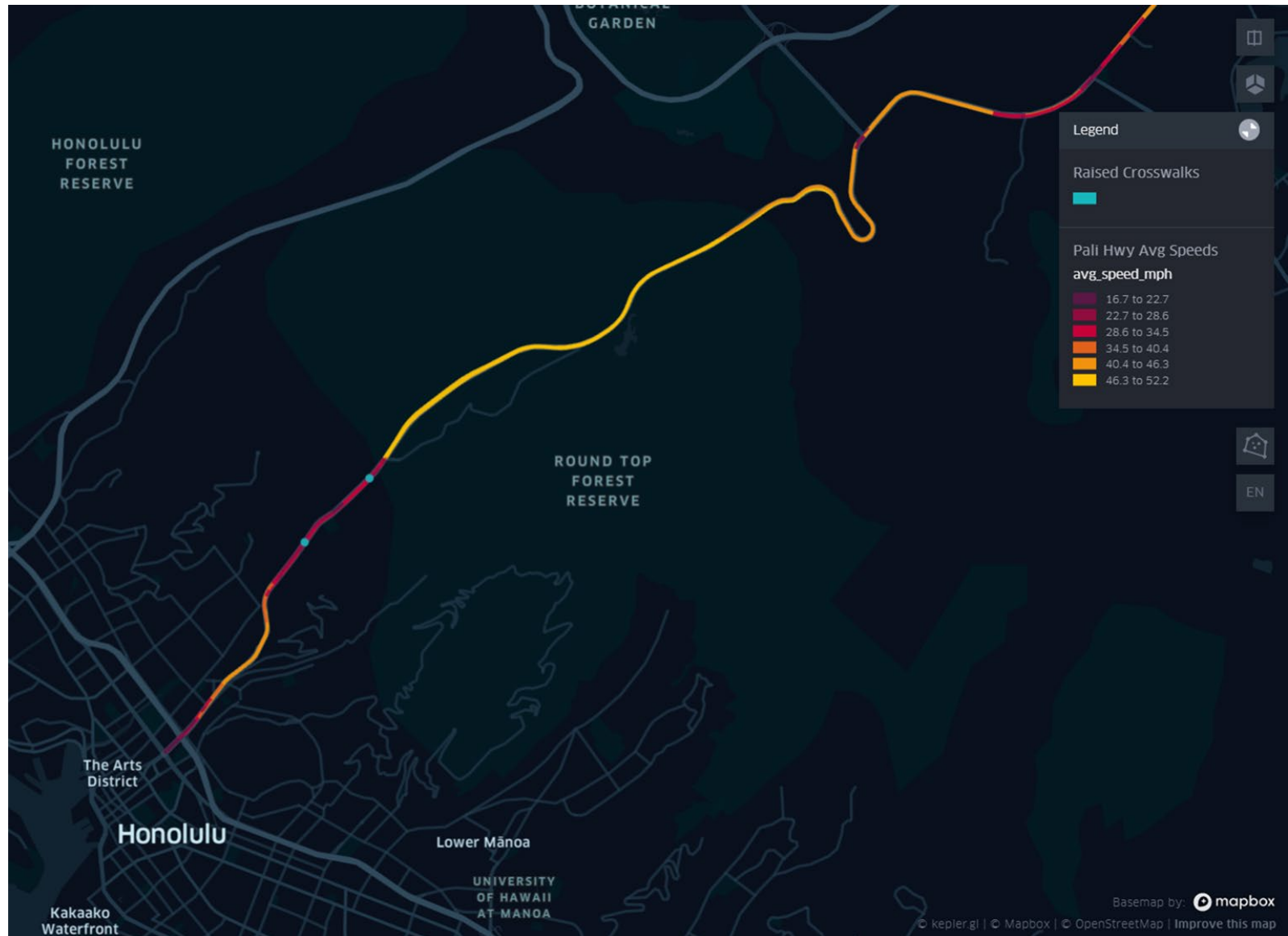



# Effectiveness of Applied Countermeasure

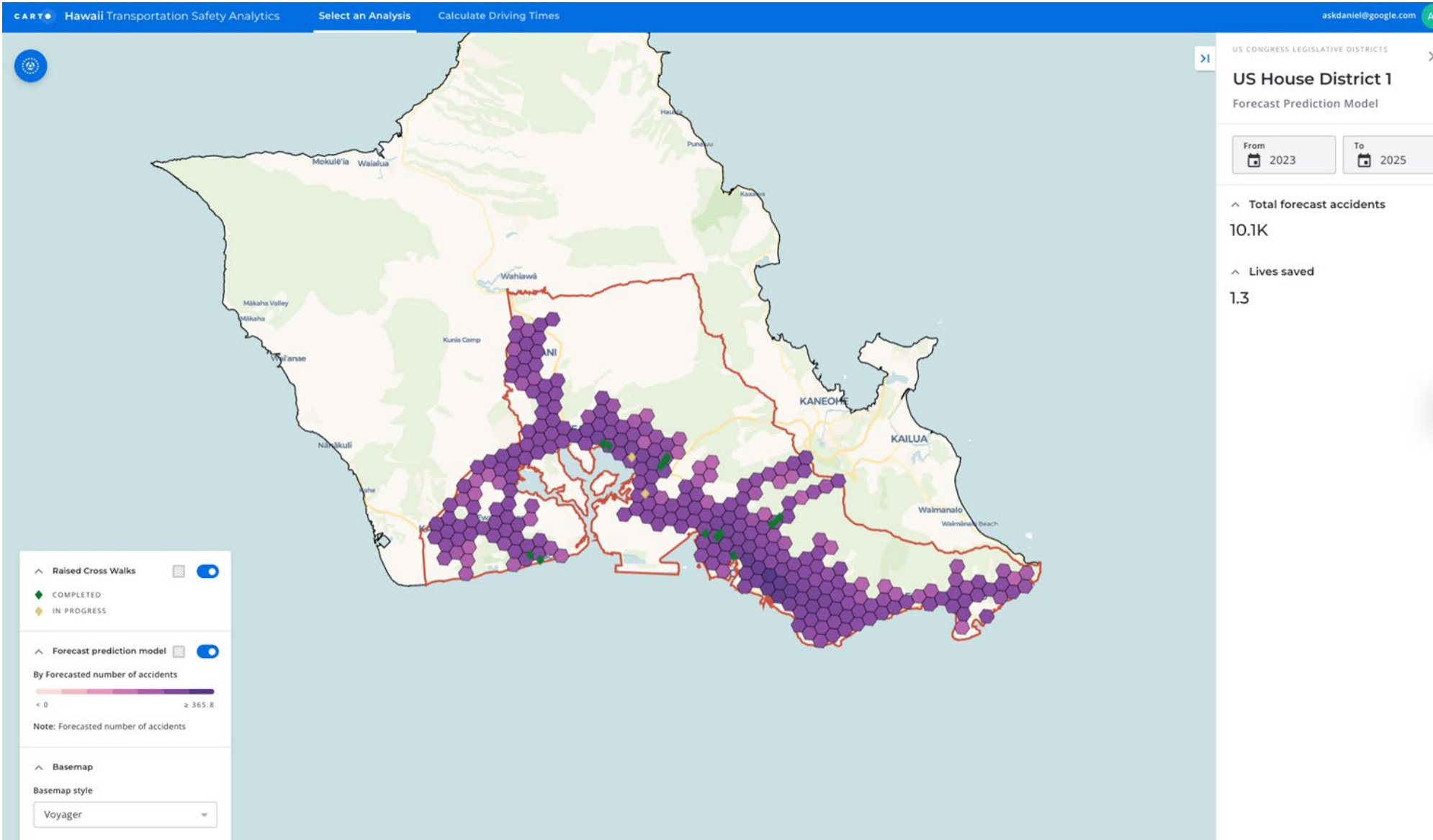

## Quick Build Safety



- Traffic Operations group implements proven tactics in hot spots
- Tactics include: No Right Turn On Red, Object Markers, No Parking in areas with crashes involving diversion, Pedestrian Countdown instructional decals, In-Lane Thermoplastic Rumble Bars, Gateway Treatments, Lane Separation, No Passing Zones



# No Right Turn On Red

STREET NAME	REFERENCE NAME	ROUTE	MP	# CRASHES	# DISREGARD TRAFFIC CONTROL	# PED INVOLVED CRASHES	# BC INVOLVED CRASHES	# FATALITIES	# SERIOUS INJURIES
ALA MOANA BLVD	ALA MOANA CTR (W)	92	8.3	2	0	0	0	0	0
ALA MOANA BLVD	HOBRON LN	92	8.9	21	3	8	3	0	1
ALA MOANA BLVD	KAHANAMOKU ST	92	9	8	0	1	0	0	0
ALA MOANA BLVD	ENA RD/KALIA RD	92	9.1	13	1	3	1	0	0
ALA MOANA BLVD	KALAKAUA AVE	92	9.3	21	2	7	4	0	2

# Speed Management

## Gateways



## Raised Crosswalks



## All-Way Ped Crossing



## Roundabouts





Remove Existing  
Regulatory Signs

Install New  
Regulatory Signs  
Onto Existing Post

BEGIN

(12"x6")

NO  
PARKING  
STOPPING  
STANDING  
LOADING  
UNLOADING

(12"x18")



R7-201P  
(12"x6")

Install New Lane  
Assignment And  
Regulatory Signs  
With New Post

(12"x18")

R7-201P  
(12"x6")



(36"x30")

NO  
PARKING  
STOPPING  
STANDING  
LOADING  
UNLOADING



existing  
regulatory  
signs

a



Install New  
Pavement Arrow

b



Install New  
Pavement Arrow

Hobron Lane

existing pavement  
marking arrow

New R16-4 Sign  
(Separate Work  
Order)

NO  
RIGHT  
TURN  
ON  
RED

existing pavement  
marking arrow

existing pavement  
marking arrow

Remove Existing  
Tow-Away Sign

Install New  
R7-201P Sign

R7-201P  
(12"x6")



existing regulatory signs

Remove Existing  
Regulatory Sign  
And Post



existing regulatory sign

Ala Moana Boulevard

To Ewa





existing regulatory signs

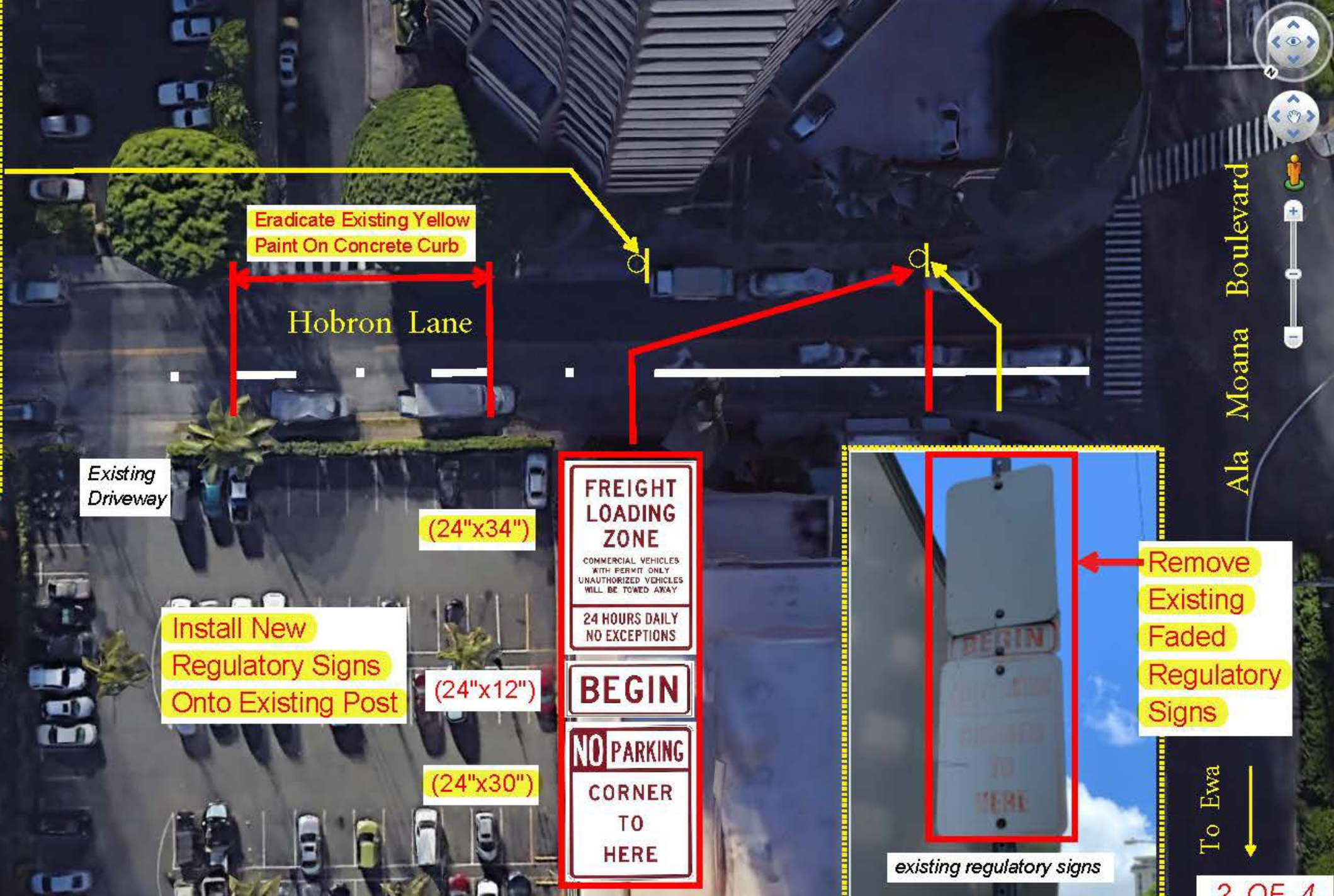

Eradicate Existing Yellow Paint On Concrete Curb

Hobron Lane

Existing Driveway

Install New Regulatory Signs Onto Existing Post

(24"x34")

(24"x12")

(24"x30")



Remove Existing Faded Regulatory Signs

existing regulatory signs

To Ewa

Ala Moana Boulevard

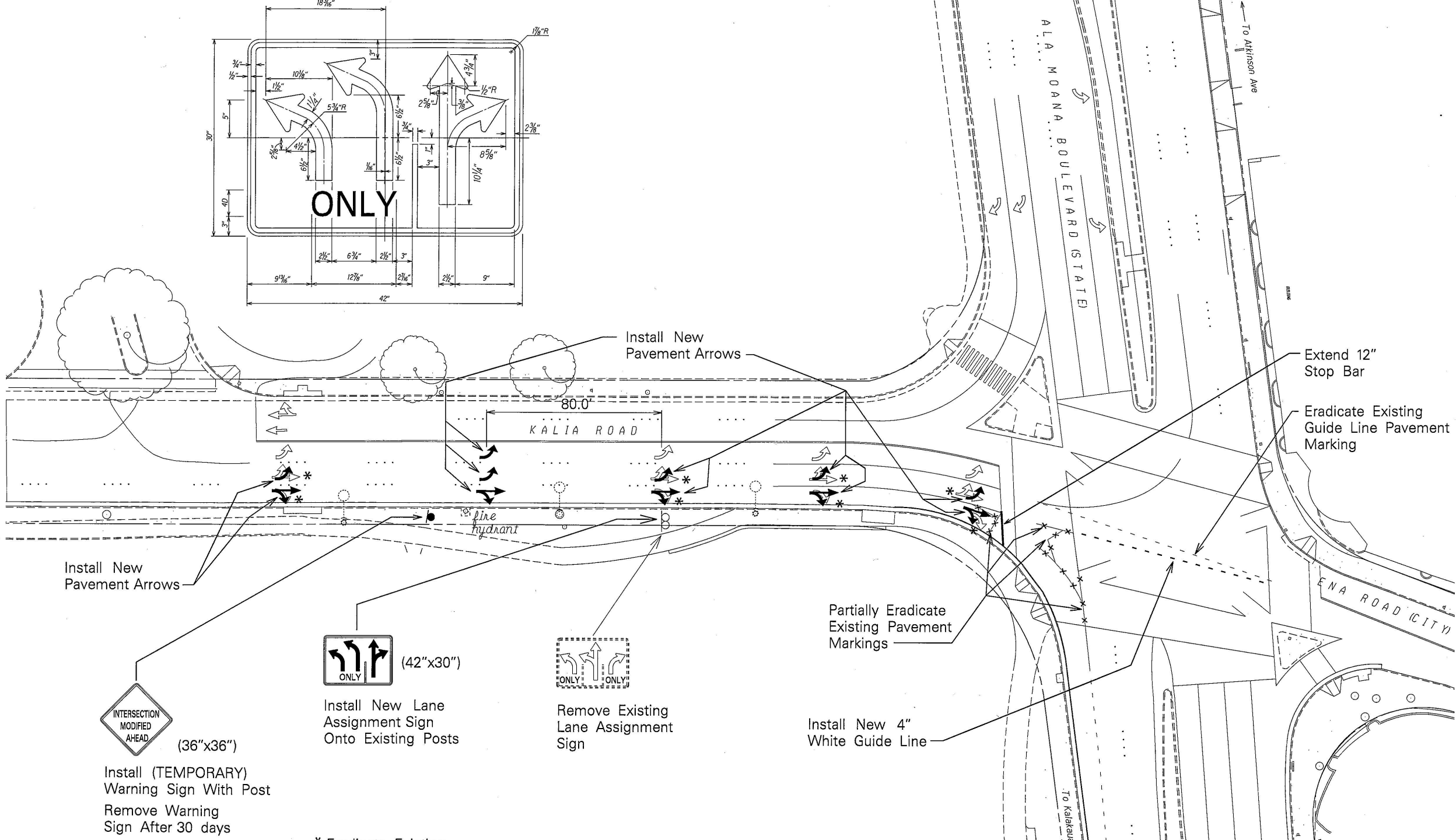



# Photo Enforcement

- First intersection activated in November 2022
- Goal is to reduce red-light running by changing driver behavior
- 10 intersections, 14 approaches selected for pilot
- At the seven “matured” sites we’re seeing average reduction in violations between 54% and 69%

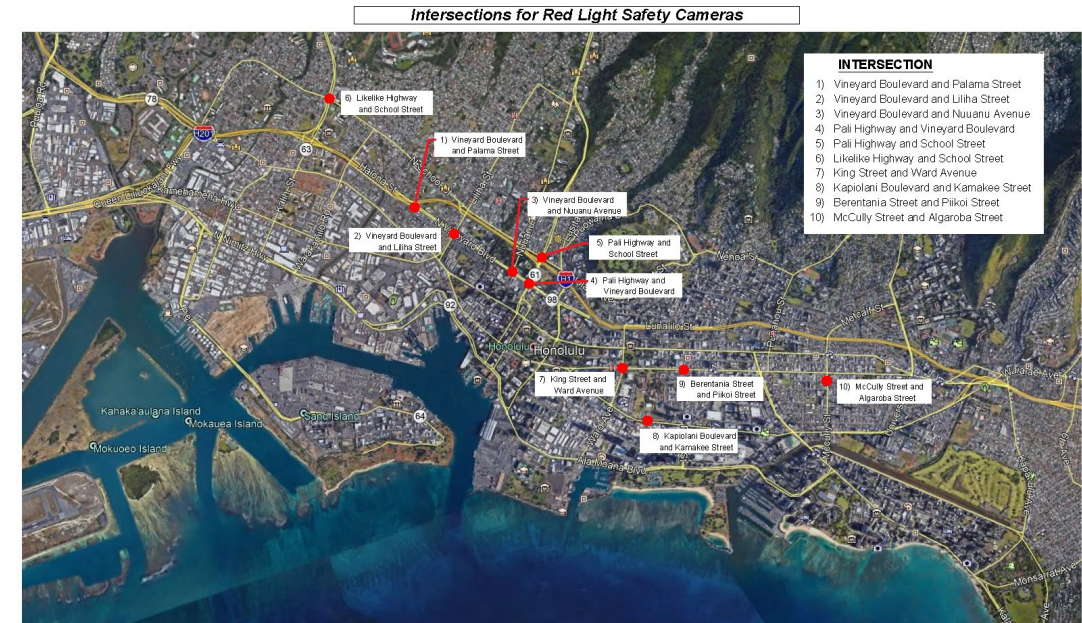





# Electric Bicycles

- No license required
- g) No person shall ride a bicycle equipped with a motor on any sidewalk. The counties may, by ordinance, post bicycle lanes and bicycle paths to prevent persons riding a bicycle equipped with a motor from using them. [https://www.capitol.hawaii.gov/hrscurrent/Vol05\\_Ch0261-0319/HRS0291C/HRS\\_0291C-0145.htm](https://www.capitol.hawaii.gov/hrscurrent/Vol05_Ch0261-0319/HRS0291C/HRS_0291C-0145.htm)